

NOTE: CHAINAGES SHOWN ARE ALONG CENTRE LINE OF ROW

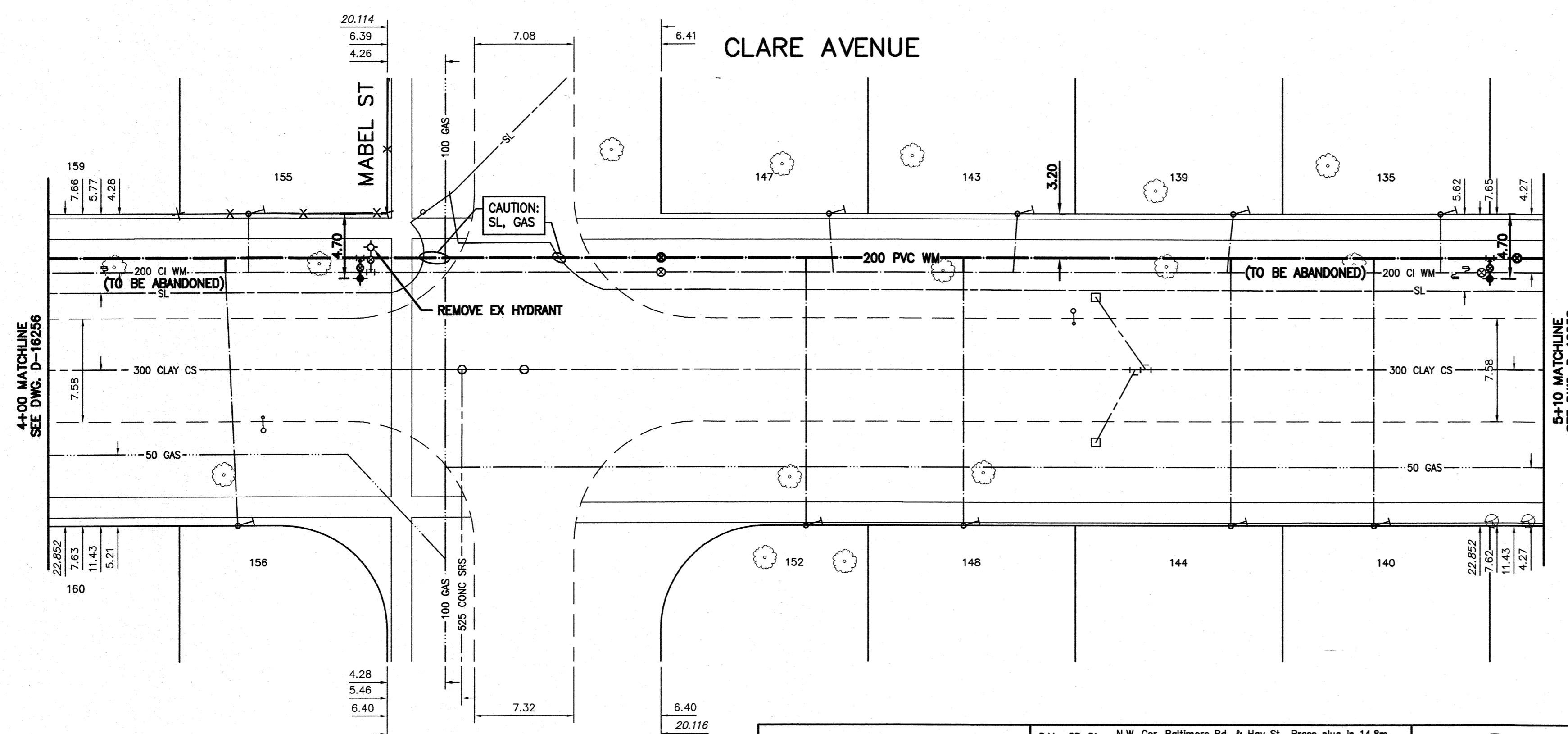

WATER SERVICE INFORMATION					
ADDRESS	PIPE SIZE & MATERIAL (STREET)	PIPE SIZE & MATERIAL (PROP.)	SHORT & LONG MEASUREMENT	CORP. LOCATION	REMARKS
156 CLARE AVE	CU	CU	8.50 NSL HSE	3.0 N S/C	RECONNECT SERVICE
RESIDENTIAL	20	20	464.00 EEL FISHER		
155 CLARE AVE	CU	CU	6.70 EWL HSE	OPP S/C	RECONNECT SERVICE
RESIDENTIAL	20	20	33.50 WWL MABEL		
152 CLARE AVE	CU	CU	2.5 WEL HSE	OPP S/C	RECONNECT SERVICE
RESIDENTIAL	20	20	35.00 EEL MABEL		
148 CLARE AVE	CU	CU	14.00 EWL HSE	OPP S/C	RECONNECT SERVICE
RESIDENTIAL	20	20	73.00 EEL MABEL		
147 CLARE AVE	CU	CU	3.00 WEL HSE	1.0 E S/C	RECONNECT SERVICE
RESIDENTIAL	20	20	459.50 WWL ECCLES		
144 CLARE AVE	CU	CU	24.5 W OF WL	OPP S/C	RECONNECT SERVICE
RESIDENTIAL	20	20	137.50 EEL MABEL		
143 CLARE AVE	CU	CU	7.00 WEL HSE	1.0 W S/C	RECONNECT SERVICE
RESIDENTIAL	20	20	86.00 EEL MABEL		
140 CLARE AVE	CU	CU	11.50 EWL HSE	OPP S/C	RECONNECT SERVICE
RESIDENTIAL	20	20	172.00 EEL MABEL		
139 CLARE AVE	CU	CU	4.00 WEL HSE	1.5 W S/C	RECONNECT SERVICE
RESIDENTIAL	20	20	362.00 WWL ECCLES		
135 CLARE AVE	CU	CU	3.00 WEL HSE	OPP S/C	RECONNECT SERVICE
RESIDENTIAL	20	20	312.00 WWL ECCLES		

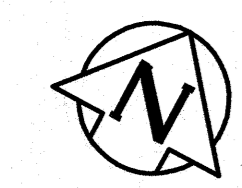
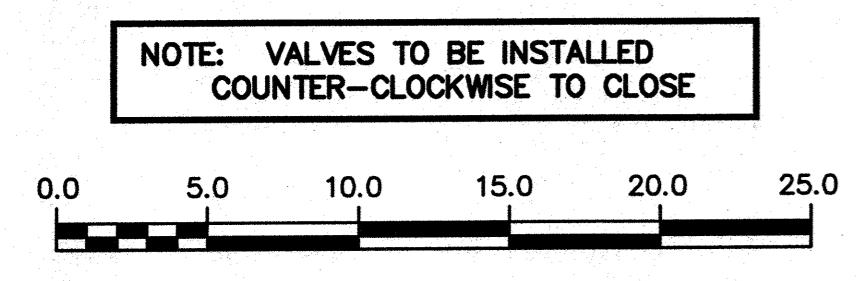

NOTE: VALVES TO BE INSTALLED COUNTER-CLOCKWISE TO CLOSE

FOR INDEX SEE D-16245

METRIC
WHOLE NUMBERS INDICATE MILLIMETRES
DECIMALIZED NUMBERS INDICATE METRES

ENGINEERS GEOSCIENTISTS MANITOBA
Certificate of Authorization
Stantec Consulting Ltd.
No. 1301

LOCATION APPROVED UNDERGROUND STRUCTURES

SUPV. U/G STRUCTURES COMMITTEE DATE

NOTE:
LOCATION OF UNDERGROUND STRUCTURES AS SHOWN ARE BASED ON THE BEST INFORMATION AVAILABLE BUT NO GUARANTEE IS GIVEN THAT ALL EXISTING UTILITIES ARE SHOWN OR THAT THE GIVEN LOCATIONS ARE EXACT. CONFIRMATION OF EXISTENCE AND EXACT LOCATION OF ALL UTILITIES MUST BE OBTAINED FROM THE INDIVIDUAL UTILITIES BEFORE PROCEEDING WITH CONSTRUCTION.

B.M. 53-31 N.W. Cor. Baltimore Rd. & Hoy St., Brass plug in 14.8m Conc. pile, 2.4m E. of W.L. Hoy St., 2.4m S. of N.L. ELEV. 232.097

NO.	ISSUED FOR TENDER	DATE	2022.04.22	RS
01	ISSUED FOR TENDER	DATE	2022.03.01	RS

Stantec

DESIGNED BY: RS
DRAWN BY: OS

CHECKED BY: RS
APPROVED BY: RS

SCALE:
HORIZONTAL: 1:250
VERTICAL: 1:50

RELEASED FOR CONSTRUCTION
DATE: 2022.03.01

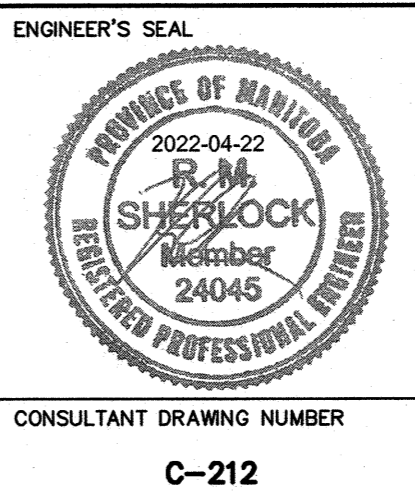

THE CITY OF WINNIPEG
WATER AND WASTE DEPARTMENT
ENGINEERING DIVISION

2022 WATERMAIN RENEWALS
CONTRACT 5
CLARE AVENUE
24.9 W OF MABEL STREET TO
64.9 E OF MABEL STREET

ENGINEER'S SEAL
CONSULTANT DRAWING NUMBER: C-212

TENDER NUMBER: 189-2022
CONTRACT NUMBER: 5

SHEET 14 OF 16
CITY DRAWING NUMBER: D-16257