

PRELIMINARY
NOT FOR CONSTRUCTION
Date: 05/26/22

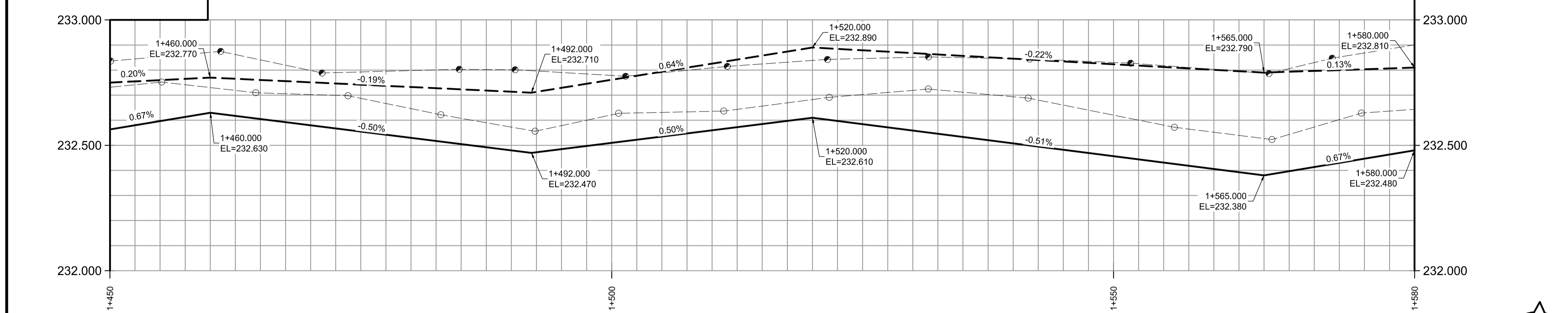

ITEM	RIM ELEV.	INVERT					CONNECTION	LEAD
		EAST	WEST	NORTH	SOUTH	SEWER		
CB10	232.690			231.09±		228.200±	600 LDS	250-1.1m @262.7%
CB11	232.120		230.52±			229.975±	MANHOLE	250-27.2m @2.0%
CB12	232.160		230.56±			230.000±	MANHOLE	250-28.0m @2.0%
CB13	232.380		230.78±			230.395±	MANHOLE	250-19.2m @2.0%
CB14	232.710			231.11±		231.075±	MANHOLE	250-1.6m @2.0%

- REFERENCE NOTES:**
- PAVEMENT DIMENSIONS ARE TO BACK OF CURB
 - BASELINE IS CENTRE LINE ROADWAY
 - PROPERTY LINES OBTAINED FROM CITY OF WINNIPEG L.B.I.S., AND NO SCALE FACTOR WAS APPLIED
 - REFER TO AECOM FIELD BOOK NO. 5086
- CONSTRUCTION NOTES:**
- REMOVE EXISTING PAVEMENT AND CONSTRUCT NEW 250mm PLAIN DOWELED CONCRETE PAVEMENT
 - CONSTRUCT NEW BARRIER CURB (180mm HT. INTEGRAL)
 - CONSTRUCT NEW MODIFIED BARRIER CURB (180mm HT. INTERGRAL)
 - CONSTRUCT NEW MODIFIED BARRIER CURB (75mm REVEAL HT. GUTTER, 180mm REVEAL HT. MEDIAN)
 - CONSTRUCT NEW CURB RAMP (10-12mm REVEAL HT. INTEGRAL)
 - CONSTRUCT NEW CURB RAMP (10-12mm REVEAL HT. MONOLITHIC)
 - CONSTRUCT NEW 100mm CONCRETE SIDEWALK
 - CONSTRUCT NEW SAFETY MEDIAN
 - CONSTRUCT NEW MONOLITHIC MEDIAN SLAB (180mm CURB HT.)
 - CONSTRUCT NEW BULLNOSE (INTERGRAL)
 - CONSTRUCT NEW ASPHALT PATHWAY (REFER TO TYPICAL CROSS SECTIONS)
 - CONSTRUCT NEW 200mm REINFORCED CONCRETE PAVEMENT
 - CONSTRUCT NEW 100mm MONOLITHIC CURB AND SIDEWALK c/w PAVING BAND (DOWELLED 100mm REVEAL)
 - RENEW EXISTING 200mm REINFORCED CONCRETE PAVEMENT
 - INSTALL DETECTABLE WARNING TILE
 - INSTALL CONCRETE BARRIER CURB (DOWELLED 150mm REVEAL)
 - INSTALL CONCRETE BARRIER CURB (SEPARATE SD-203B 75mm REVEAL)
 - INSTALL 150mm SUBDRAIN 6.0m ON EACH SIDE OF CATCHBASIN
 - INSTALL NEW CURB AND GUTTER INLET c/w CATCHBASIN (SD-024) AND CONNECT NEW 250mm LEAD TO EXISTING LEAD, MAINLINE LDS SEWER AND/OR MANHOLE
 - INSTALL NEW CAST IRON RISER RING
 - REMOVE EXISTING ASPHALT PAVEMENT AND PLACE TYPE 1A ASPHALT PAVEMENT 80mm THICK
 - PLACE TYPE 1A ASPHALT PAVEMENT
 - REMOVE EXISTING MONOLITHIC CONCRETE MEDIAN SLAB
 - REMOVE EXISTING SPLASH STRIP
 - REMOVE CONCRETE BARRIER CURB
 - REMOVE EXISTING CONCRETE SIDEWALK
 - REMOVE EXISTING CATCHBASIN/CATCHPIT AND ABANDON EXISTING LEAD
 - REMOVE EXISTING FRAME AND COVER AND PLACE NEW FRAME AND COVER (AP-006/AP-007) AND ADJUST EXISTING MANHOLE/CATCHBASIN TO GRADE
 - ADJUST EXISTING WATER VALVE TO GRADE
 - RELOCATE EXISTING HYDRANT ASSEMBLY
 - RELOCATE EXISTING HYDRO STREET LIGHT
 - REMOVE EXISTING HYDRO POLE (BY OTHERS)
 - REMOVE EXISTING ASPHALT AND PLACE NEW ASPHALT PAVEMENT TYPE1A
 - RELOCATE EXISTING TRAFFIC SIGNAL POLE
 - REMOVE EXISTING TREES
 - REMOVE EXISTING CONCRETE PAVEMENT
 - RENEW EXISTING CONCRETE BARRIER CURB
 - ADJUST EXISTING PATIO BLOCKS
 - REMOVE AND REINSTALL BUS SHELTER (BY OTHERS)
 - INSULATE EXISTING WATER SERVICE UNDER PAVEMENT
 - INSTALL BUS STOP FLAG FOUNDATION
 - REPLACE TOP 0.8m OF MANHOLE RISER (MH60013869)
 - REPLACE TOP 0.6m OF MANHOLE RISER (MH60013871)
 - REPLACE TOP 0.6m OF MANHOLE RISER (MH60013883)
 - REPLACE TOP 0.8m OF MANHOLE RISER (MH60013884)

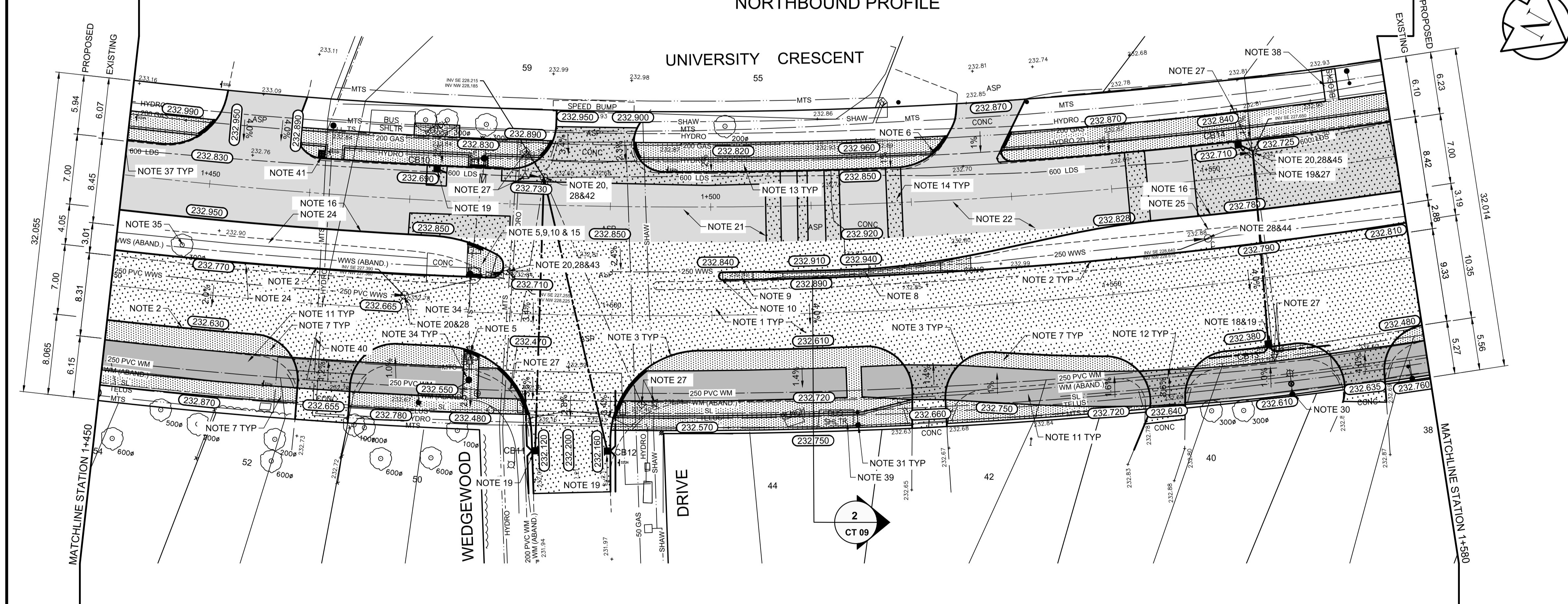

ENGINEERS GEOSCIENTISTS MANITOBA
Certificate of Authorization
AECOM Canada Ltd.
No. 4671 Date: 05/26/22

METRIC
WHOLE NUMBERS INDICATE MILLIMETRES
DECIMALIZED NUMBERS INDICATE METRES

150 mm W.M.	150 mm W.M.	300mm L.D.S.	250mm W.W.S.	HYDRO	PROFILE
HYDRANT	VALVE	LAND DRAINAGE SEWER	WASTEWATER SEWER	M.T.S.	EAST GUTTER
CONCRETE	ASPHALT	PROPERTY LINE	SURVEY BAR	ELEVATION (235.750)	EAST MEDIAN GUTTER
TREE	SIDEWALK RAMP	CONCRETE SIDEWALK	FENCE	WEST GUTTER	WEST GUTTER
CONCRETE SIDEWALK	FENCE			WEST MEDIAN GUTTER	E PROPERTY LINE
					W PROPERTY LINE

LOCATION APPROVED UNDERGROUND STRUCTURES

SUPV. U/G STRUCTURES COMMITTEE DATE

NOTE:
LOCATION OF UNDERGROUND STRUCTURES AS SHOWN ARE BASED ON THE BEST INFORMATION AVAILABLE, BUT NO GUARANTEE IS GIVEN THAT ALL EXISTING UTILITIES ARE SHOWN OR THAT THE GIVEN LOCATIONS ARE EXACT. CONFIRMATION OF EXISTENCE AND EXACT LOCATION OF ALL SERVICES MUST BE OBTAINED FROM THE INDIVIDUAL UTILITIES BEFORE PROCEEDING WITH CONSTRUCTION.

B.M. ELEV. 74M574 - Tbt. in W. wall of Conc. parking garage of No. 77 University Cres. E. of Pembina Hwy., 0.9 m N. of S.W. cor. of garage, & 2.6 m below recreation deck.
ELEVATION: 234.128

AECOM

DESIGNED BY	JT	CHECKED BY	BC
DRAWN BY	JT	APPROVED BY	RC
HOR. SCALE:	1:250	ORIGINAL SIGNED BY:	
VERTICAL:	1:10	DATE	05/11/22

ENGINEER'S SEAL

CONSULTANT DRAWING NO. CT-07

THE CITY OF WINNIPEG
PUBLIC WORKS DEPARTMENT
ENGINEERING DIVISION

2022 REGIONAL STREET RENEWAL PROGRAM
UNIVERSITY CRESCENT FROM THATCHER DRIVE TO PEMBINA HIGHWAY

CONCRETE PAVEMENT RECONSTRUCTION & REHABILITATION
STATION 1+450 TO STATION 1+580
PLAN-PROFILE

CITY DRAWING NUMBER P-3559-07
SHEET 07 OF 11