

DETAIL "A"
CONNECTION AT BISSETT CR
SCALE N.T.S.

REFER TO D-16334 FOR CONSTRUCTION NOTES

NOTE: CHAINAGES SHOWN ARE ALONG N. \perp OF VOYAGEUR AVE

FOR INDEX SEE D-16334

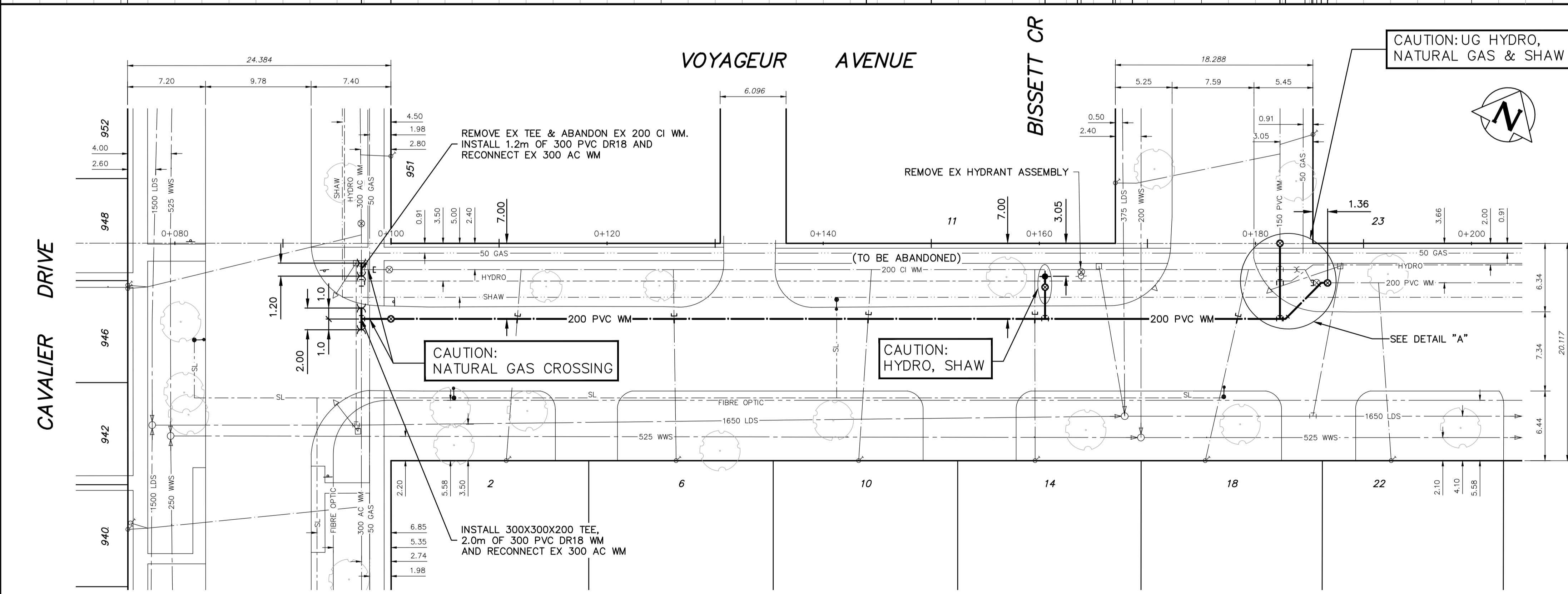

WATER SERVICE INFORMATION

ADDRESS	SIZE (mm) MATERIAL (STREET)	SIZE (mm) MATERIAL (PROP.)	SHORT & LONG MEASUREMENT	CORP. LOCATION	REMARKS
2 VOYAGEUR AVE RESIDENTIAL	20 CU	20 CU	7.6 W OF ELL	1.4 E OF S/C	-
6 VOYAGEUR AVE RESIDENTIAL	20 CU	20 CU	10.7 E OF EL CAVALIER DR	0.3 W OF S/C	-
10 VOYAGEUR AVE RESIDENTIAL	20 CU	20 CU	8.1 E OF WLL	1.2 E OF S/C	-
14 VOYAGEUR AVE RESIDENTIAL	20 CU	20 CU	26.4 E OF EL CAVALIER DR	0.3 W OF S/C	-
18 VOYAGEUR AVE RESIDENTIAL	20 CU	20 CU	7.9 E OF WLL	1.2 E OF S/C	-
			23.7 W OF WL BISSETT CR		
			7.7 E OF WLL	OPP S/C	-
			6.9 W OF WL BISSETT CR		
			5.9 E OF WLL	4.0 E OF S/C	-
			8.0 E OF WL BISSETT CR		

ENGINEERS GEOSCIENTISTS
MANITOBA
Certificate of Authorization
Tetra Tech Canada Inc.
No. 6499

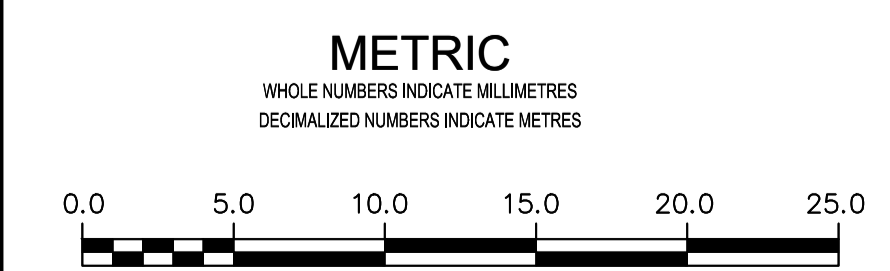

WARNING
IF POWER EQUIPMENT OR EXPLOSIVES ARE TO BE USED FOR EXCAVATION ON THIS PROJECT THE CONTRACTOR MUST:
1) NOTIFY THE GAS COMPANY OF THE PROPOSED LOCATION OF EXCAVATION.
2) TAKE PRECAUTION TO AVOID DAMAGE TO GAS COMPANY INSTALLATIONS.
SEE PROVINCIAL REGULATION 210/72 FOR DETAILS

LOCATION APPROVED UNDERGROUND STRUCTURES
SUPV. U/G STRUCTURES COMMITTEE DATE
NOTE:
LOCATION OF UNDERGROUND STRUCTURES AS SHOWN ARE BASED ON THE BEST INFORMATION AVAILABLE BUT NO GUARANTEE IS GIVEN THAT ALL EXISTING UTILITIES ARE SHOWN OR THAT THE GIVEN LOCATIONS ARE EXACT. CONFIRMATION OF EXISTENCE AND EXACT LOCATION OF ALL SERVICES MUST BE OBTAINED FROM THE INDIVIDUAL UTILITIES BEFORE PROCEEDING WITH CONSTRUCTION.

B.M. ELEV.
CONSTRUCTION COMPLETION DATE:

NO.	ISSUED FOR TENDER	DATE	BY	DATE
0	ISSUED FOR TENDER	22/05/25	IJM	
NO.	REVISIONS	DATE	BY	DATE

TETRA TECH

DESIGNED BY: SJR
DRAWN BY: NL
SCALE: HORIZONTAL 1:250, VERTICAL 1:50

CHECKED BY: IJM
APPROVED BY: IJM
RELEASED FOR CONSTRUCTION

DATE: 2022 05 25

ENGINEER'S SEAL
CONSULTANT DRAWING NUMBER
2200120200-DWG-C0010

THE CITY OF WINNIPEG
WATER AND WASTE DEPARTMENT
ENGINEERING DIVISION

2022 WATERMAIN RENEWALS
CONTRACT 10
VOYAGEUR AVENUE
CAVALIER DRIVE TO
BISSETT CRESCENT

SHEET 10 OF 12
CITY DRAWING NUMBER
D-16342