

DETAIL "A"  
RECONNECTION AT QUAIL RIDGE (E LEG)  
SCALE N.T.S.

REFER TO D-16334 FOR CONSTRUCTION NOTES

NOTE: CHAINAGES SHOWN ARE ALONG  
E. P. OF QUAIL RIDGE RD E. LEG

FOR INDEX SEE D-16334

QUAIL RIDGE ROAD (EAST LEG)

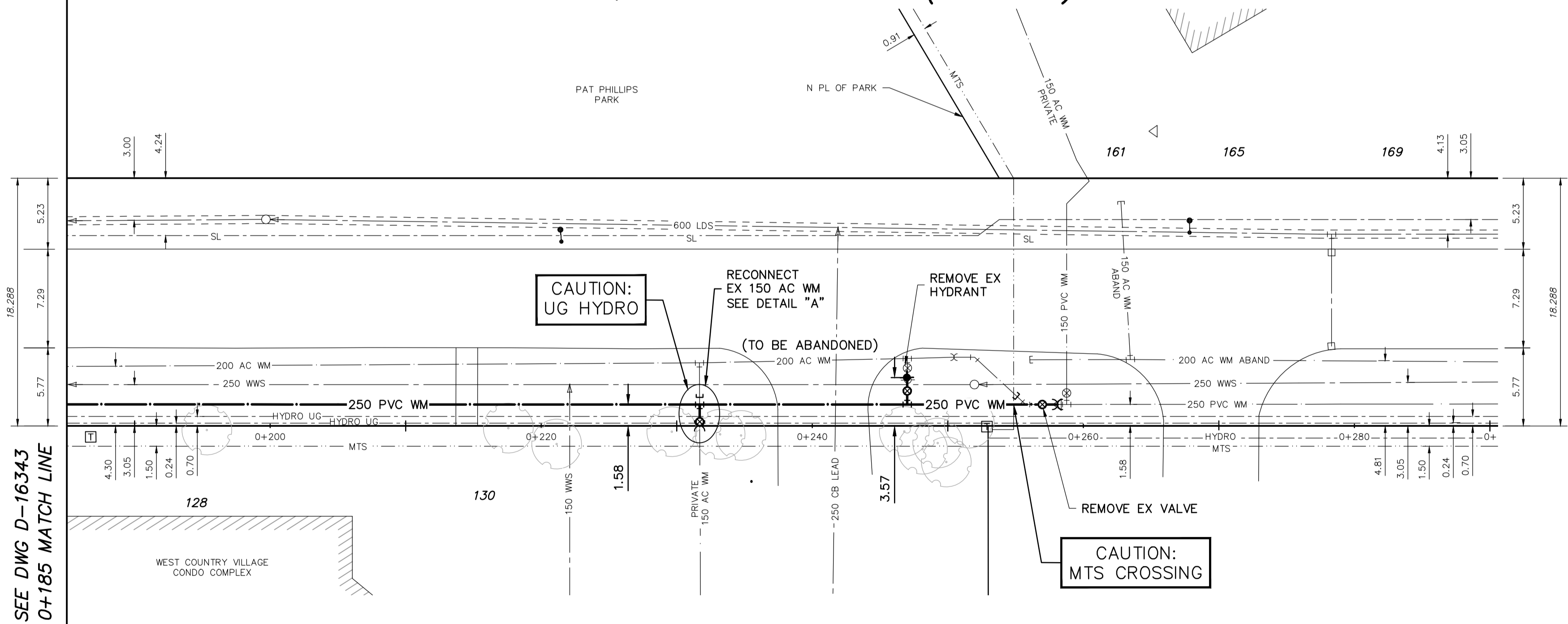

WATER SERVICE INFORMATION

ADDRESS	SIZE (mm) MATERIAL (STREET)	SIZE (mm) MATERIAL (PROP.)	SHORT & LONG MEASUREMENT	CORP. LOCATION	REMARKS
128 QUAIL RIDGE ROAD	UNK	UNK	UNK	UNK	SERVICED OFF OF PRIVATE 150 WM
RESIDENTIAL	UNK	UNK	UNK	UNK	
130 QUAIL RIDGE ROAD	UNK	UNK	UNK	UNK	SERVICED OFF OF PRIVATE 150 WM
RESIDENTIAL	UNK	UNK	UNK	UNK	

NOTE: ALL VALVES TO BE INSTALLED  
CLOCKWISE TO CLOSE  
(BLACK OPERATING NUT)

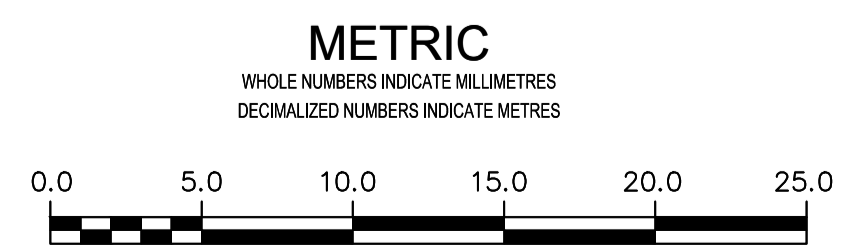

<p><b>WARNING</b></p> <p>IF POWER EQUIPMENT OR EXPLOSIVES ARE TO BE USED FOR EXCAVATION ON THIS PROJECT THE CONTRACTOR MUST:</p> <p>1) NOTIFY THE GAS COMPANY OF THE PROPOSED LOCATION OF EXCAVATION.</p> <p>2) TAKE PRECAUTION TO AVOID DAMAGE TO GAS COMPANY INSTALLATIONS.</p> <p>SEE PROVINCIAL REGULATION 210/72 FOR DETAILS</p>	<p>LOCATION APPROVED UNDERGROUND STRUCTURES</p> <p>SUPV. U/G STRUCTURES COMMITTEE DATE</p> <p>NOTE: LOCATION OF UNDERGROUND STRUCTURES AS SHOWN ARE BASED ON THE BEST INFORMATION AVAILABLE BUT NO GUARANTEE IS GIVEN THAT ALL EXISTING UTILITIES ARE SHOWN OR THAT THE GIVEN LOCATIONS ARE EXACT. CONFIRMATION OF EXISTENCE AND EXACT LOCATION OF ALL SERVICES MUST BE OBTAINED FROM THE INDIVIDUAL UTILITIES BEFORE PROCEEDING WITH CONSTRUCTION.</p>	<p>B.M. ELEV.</p> <p>CONSTRUCTION COMPLETION DATE:</p>	<p><b>TETRA TECH</b></p>	ENGINEER'S SEAL	<p><b>THE CITY OF WINNIPEG</b> WATER AND WASTE DEPARTMENT ENGINEERING DIVISION</p> <p>2022 WATERMAIN RENEWALS CONTRACT 10 <b>QUAIL RIDGE ROAD (EAST LEG)</b> 85 m NORTH OF QUAIL RIDGE ROAD (SOUTH LEG) TO 175m NORTH</p>	<p>SHEET 12 OF 12 CITY DRAWING NUMBER <b>D-16344</b></p>
				<p>DESIGNED BY SR</p> <p>CHECKED BY IJM</p> <p>DRAWN BY NL</p> <p>APPROVED BY IJM</p> <p>SCALE: HORIZONTAL 1:250 VERTICAL 1:50</p> <p>RELEASED FOR CONSTRUCTION</p>		