

REFLECTED CEILING PLAN
SCALE: 3/8"=1'-0"

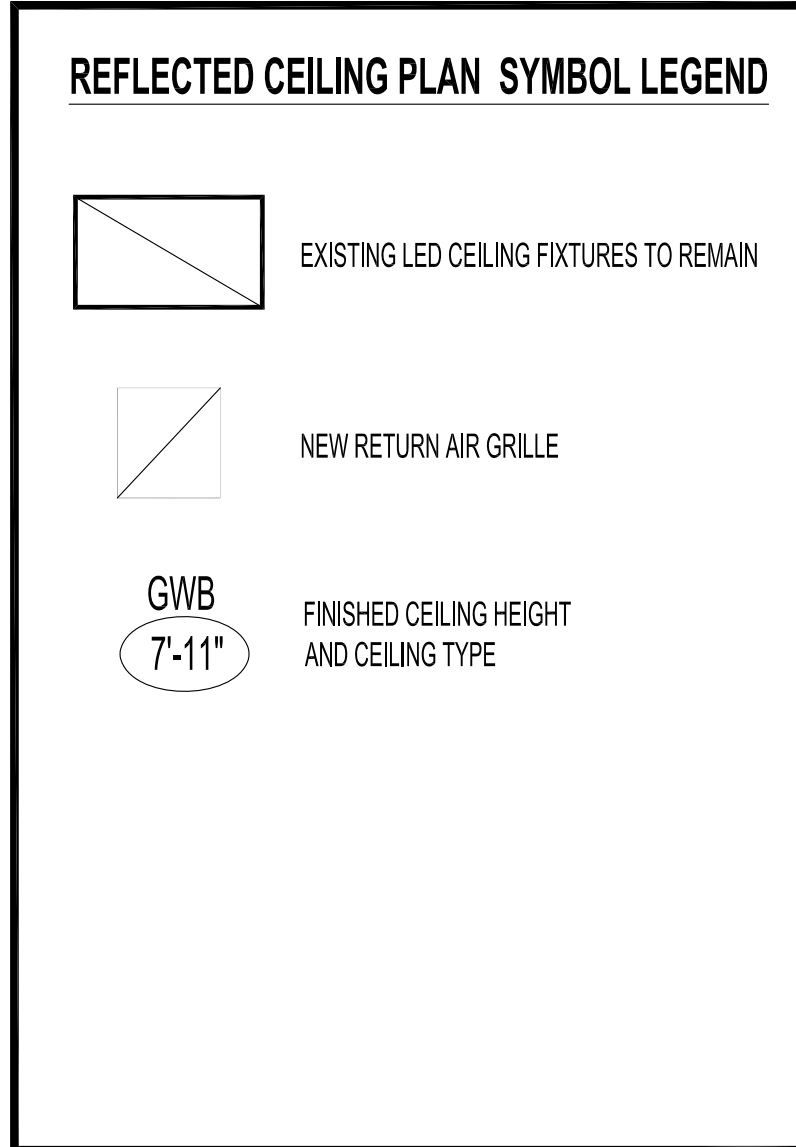

- DRAWING NOTES**
- EXISTING CEILING HEIGHT SHOWN IS APPROXIMATE. SITE CONFIRM AND ADVISE DESIGNER.
 - WHERE SOUTH WALL SHUTTER REMOVED, INFILL RECESSED CEILING WITH 1/2" DRYWALL & MAKE FLUSH W/ MAIN CEILING HEIGHT. PATCH AND PREPARE TO RECEIVE PAINT.
 - BUILD NEW BULKHEAD TO ACCOMMODATE DUCTING FOR RANGE HOOD. CONTRACTOR TO SITE CONFIRM AVAILABLE HEIGHT IN CEILING PLENUM AND ADVISE DESIGNER. REFER TO REFLECTED CEILING PLAN FOR DIMENSIONS.
 - SUPPLY AND INSTALL 10"x10" ACCESS HATCH IN BULKHEAD. REFER TO ELEVATIONS FOR LOCATION. PAINT TO MATCH BULKHEAD.

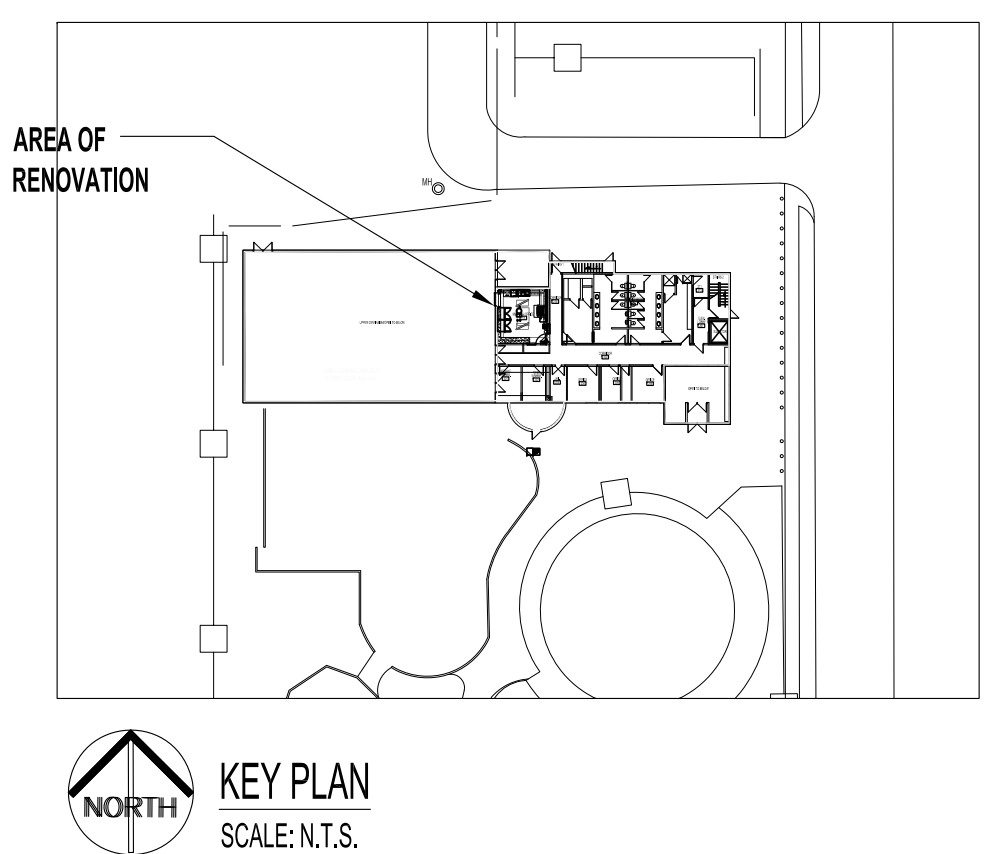

NOTES:
THESE DRAWINGS SHALL NOT BE SCALED. CONSULT WITH CONTRACT ADMINISTRATOR AND DESIGNER OF ANY CONCERNS.

SUBMISSION OF SITE MARK-UPS, AS-BUILTS, OPERATING AND MAINTENANCE MANUALS AND OTHER SUPPORTING DOCUMENTS TO CLIENT ARE MANDATORY AT THE COMPLETION OF THE PROJECT.

THE CONTRACTOR SHALL VISIT THE SITE AND SATISFY ONESELF ALL DIMENSIONS, DATUM, AND DETAILED INFORMATION SHOWN ARE CORRECT.

THE CONTRACTOR IS TO REVIEW AND COORDINATE ALL ARCHITECTURAL, MECHANICAL, ELECTRICAL AND STRUCTURAL DRAWINGS FOR ADDITIONAL OPENINGS THROUGH FLOORS, WALLS, AND CEILINGS FOR DUCT, PIPE & ELECTRICAL AND ALL OPENINGS NOT SHOWN ON DRAWINGS.

THE CONTRACTOR IS RESPONSIBLE FOR ENSURING THAT ALL OF HIS SUBTRADES ARE MADE AWARE OF AND FOLLOW THE BUILDING GUIDELINES FOR CONSTRUCTION. CONFIRM HOURS OF OPERATION FOR DEMOLITION/CONSTRUCTION WITH CITY PROJECT ADMINISTRATOR PRIOR TO UNDERTAKING WORK AS OUTLINED ON DRAWINGS.

AS THE TENANT WILL CONTINUE TO CONDUCT BUSINESS DURING THE DEMOLITION /CONSTRUCTION PERIOD, ALL WORK MUST BE COORDINATED WITH CITY PROJECT ADMINISTRATOR AND/OR OFFICE MANAGER.

CARE TO BE TAKEN TO KEEP ALL COMMON CORRIDOR AND EXIT AREAS CLEAR OF DEBRIS AND OBSTRUCTIONS DURING DEMOLITION/CONSTRUCTION.

ALL OPENINGS THROUGH FIRE ASSEMBLIES ARE TO BE FIRE STOPPED AND SEALED WITH ULC APPROVED FIRE STOPPING TO MAINTAIN THE INTEGRITY OF THE FIRE SEPARATION, AND PROVIDE A SMOKE-TIGHT BARRIER.

ALL PRODUCTS AND MATERIALS TO BE USED AND INSTALLED SHALL CONFORM WITH MANUFACTURER'S SPECIFICATIONS & APPLICABLE CODES.

THE CONTRACTOR SHALL BE RESPONSIBLE TO PATCH AND MAKE GOOD ALL EXISTING CONSTRUCTION AFFECTED BY THE REMOVAL OF ALL ITEMS FORMING THE PART OF THE RENOVATION WORK.

WHERE NEW FLOORING AND BASE IS TO BE INSTALLED IN EXISTING AREAS (REFER TO FLOOR PLAN AND ROOM SCHEDULE) THE EXISTING FLOORING SURFACE AND BASE MUST BE REMOVED, UNLESS OTHERWISE NOTED. ALL FLOOR SURFACES SHALL BE PREPARED IN ACCORDANCE TO MANUFACTURER'S RECOMMENDATIONS FOR INSTALLATION OF NEW FLOOR.

WHERE PAINTING OF EXISTING WALLS IS INDICATED ON THE ROOM SCHEDULE, THESE WALLS MUST BE CLEANED OF ANY EXISTING WALL COVERING, PATCHED & PREPARED TO ACCEPT NEW MATERIAL, UNLESS OTHERWISE NOTED.

CONTRACTOR TO PROVIDE HOARDING WHERE REQ'D TO MAINTAIN HEALTH AND SAFETY. ALL ACCESS TO EXITS TO BE MAINTAINED THROUGHOUT CONSTRUCTION. REFUSE TO BE REMOVED DAILY.

CONTRACTOR TO ATTEMPT TO RECYCLE ALL ITEMS REMOVED IN AN ENVIRONMENTALLY FRIENDLY MANNER.

ALL NEW LIGHTING FIXTURES & NEW RECEPTACLES TO BE CONNECTED TO APPROPRIATE PANELS.

GENERAL DUTY RECEPTACLES SHALL BE WHITE & CSA APPROVED. CW STAINLESS STEEL TRIM PLATES MOUNTED 18" ABOVE FINISHED FLOOR OR OTHERWISE NOTED.

THERMOSTATS, FIRE ALARM PULL STATIONS & OCCUPANCY LIGHT SWITCHES SHALL BE MOUNTED 47" ABOVE FINISHED FLOOR OR OTHERWISE NOTED.

ALL ABANDONED ELECTRICAL FIXTURES, COMPONENTS, RECEPTACLE & DATA WIRING SHALL BE REMOVED BACK TO SOURCE & TERMINATED AS PER APPLICABLE CODES. IF APPLICABLE, THIS INCLUDES WIRING CONTAINED IN HEADER DUCTS IN-FLOOR.

STAR (*) PRECEDING DIMENSION DENOTES CRITICAL DIMENSION MUST BE MET.

| No. | REVISION/DESCRIPTION | BY | DATE |
|-----|------------------------------|-----|--------------|
| 0 | ISSUED FOR CONSTRUCTION | CEA | SEPT 13 2022 |
| 0 | ISSUED FOR ESTIMATING | CEA | JUNE 11 2022 |
| 0 | ISSUED FOR 99% CLIENT REVIEW | CEA | MAY 20 2022 |
| 0 | ISSUED FOR 30% CLIENT REVIEW | SFC | JUNE 19 2019 |

| DATE | DATE | DATE | DATE |
|------------|------------|------------|------------|
| 2022.06.11 | 2022.06.11 | 2022.06.11 | 2022.06.11 |

THE CITY OF WINNIPEG
ASSETS & PROJECT MANAGEMENT
DEPARTMENT
MUNICIPAL ACCOMMODATIONS DIVISION
3-65 GARRY STREET, R3C 4K4

PROJECT
MAGNUS ELIASON RECREATION CENTRE
KITCHEN RENOVATION

430 LANGSIDE

SHEET TITLE
REFLECTED CEILING PLAN

SCALE: AS SHOWN PROJECT No: 2019-077 SHEET No: A2.2