

PARTIAL MAIN FLOOR PLAN - MECHANICAL RENOVATION
SCALE: 3/8" = 1'-0"

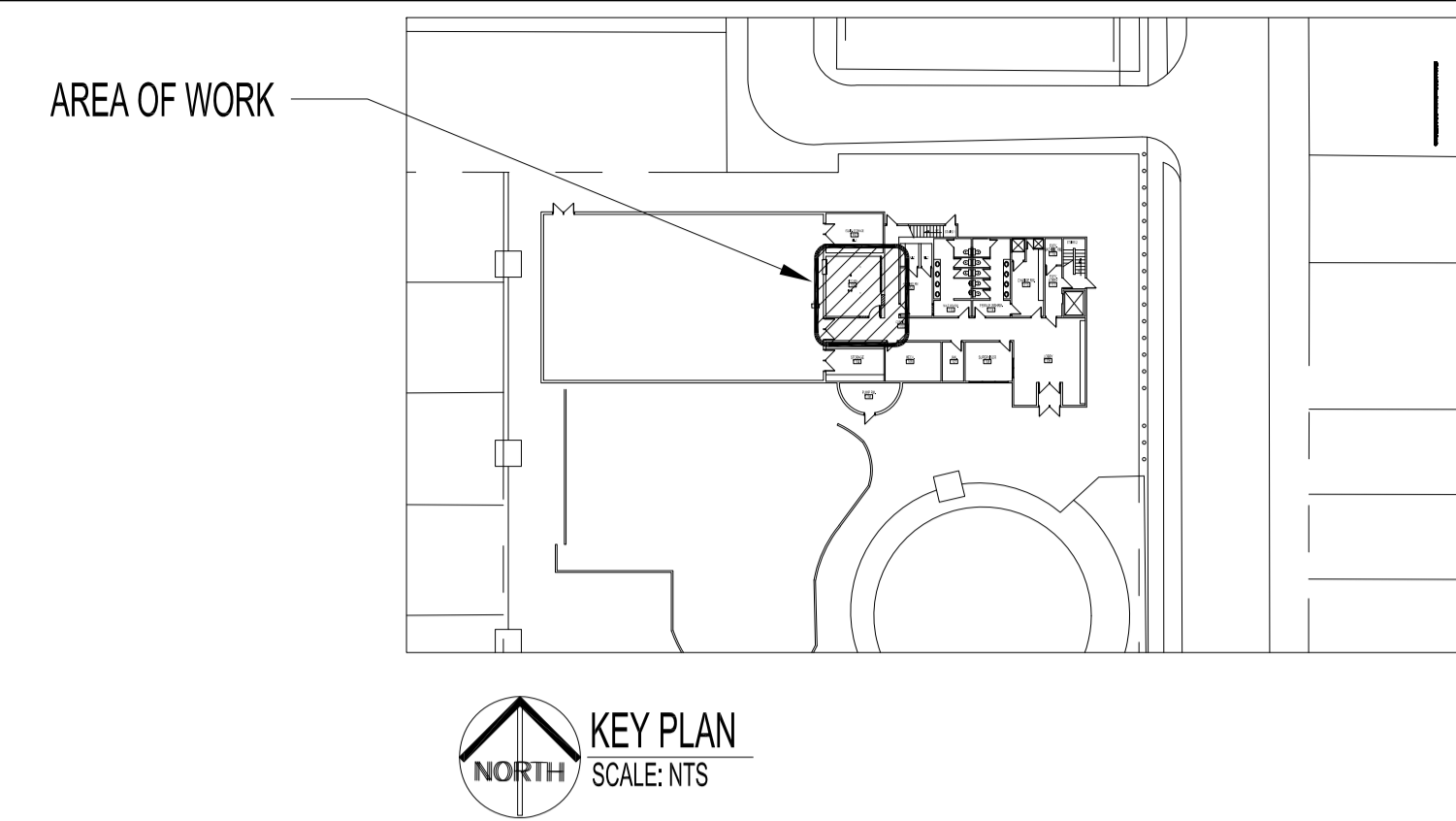

NOTES:

THESE DRAWINGS SHALL NOT BE SCALED.

THIS DRAWING IS DIAGRAMMATIC ONLY. CONTRACTOR TO COORDINATE EXACT LOCATIONS OF AND ROUTING ON SITE WITH ALL NEW AND EXISTING SYSTEM.

THE CONTRACTOR SHALL VISIT THE SITE AND SATISFY ONESELF ALL DIMENSIONS, DATUM, AND DETAILED INFORMATION SHOWN ARE CORRECT.

THE CONTRACTOR IS TO REVIEW AND COORDINATE ALL ARCHITECTURAL, MECHANICAL, ELECTRICAL AND STRUCTURAL DRAWINGS FOR ADDITIONAL OPENINGS THROUGH FLOORS, WALLS, AND CEILINGS FOR DUCT, PIPE & ELECTRICAL RISERS AND ALL OPENINGS NOT SHOWN ON DRAWINGS.

ALL OPENINGS THROUGH FIRE ASSEMBLIES ARE TO BE FIRE STOPPED AND SEALED WITH ULC APPROVED FIRE STOPPING TO MAINTAIN THE INTEGRITY OF THE FIRE SEPARATION, AND PROVIDE A SMOKE-TIGHT BARRIER.

ALL PRODUCTS AND MATERIALS TO BE USED AND INSTALLED SHALL CONFORM WITH MANUFACTURER'S SPECIFICATIONS & APPLICABLE CODES.

NEW DUCT SHALL BE CONSTRUCTED AS RECOMMENDED BY SMACNA.

THE CONTRACTOR SHALL BE RESPONSIBLE TO PATCH AND MAKE GOOD ALL EXISTING CONSTRUCTION AFFECTED BY THE REMOVAL OF ALL ITEMS FORMING THE PART OF THE RENOVATION WORK.

PLUMBING INSTALLATION SHALL CONFORM TO NATIONAL PLUMBING CODE OF CANADA.

THE CONTRACTOR IS RESPONSIBLE FOR INSTALLING RISERS, SWING JOINTS AND DEEP CUP ESCUTCHEONS AS REQUIRED.

ELECTRICAL WIRING SHALL BE PERFORMED BY A QUALIFIED ELECTRICAL SUBTRADE.

PROVIDE MILCOR ACCESS DOORS IN DRYWALL CEILINGS AND WALLS FOR ACCESS TO MECHANICAL EQUIPMENT. MINIMUM SIZE 24" X 18".

MECHANICAL RENOVATION NOTES:

- 1 NEW DISHWASHER. PROVIDE HOT WATER TO NEW DISHWASHER AND CONNECT THE DISHWASHER DRAIN TO THE ADJACENT SINK TRAP.
- 2 NEW KITCHEN SINK (SK-1 PROVIDED BY GENERAL CONTRACTOR), RECONNECT THE NEW SINK TO THE EXISTING PLUMBING LINES, INCLUDING HOT WATER LINE, DRAIN AND VENT LINE.
- 3 NEW GREASE INTERCEPTOR (GI-1 PROVIDED BY MECHANICAL CONTRACTOR), LOCATED UNDERNEATH THE COUNTER, COORDINATE WITH ARCHITECTURAL FOR EXACT LOCATION.
- 4 NEW RANGE HOOD (RH-1 PROVIDED BY GENERAL CONTRACTOR), PROVIDE AND INSTALL 12"x10" EXHAUST DUCT FROM THE NEW RANGE HOOD UP TO THE ROOF TOP NEW EXHAUST FAN (EF-5). ALL KITCHEN HOOD EXHAUST DUCTWORK TO BE IN ACCORDANCE WITH NPFA 96. CONTRACTOR IS RESPONSIBLE FOR ALL CLEARANCES REQUIRED IN ACCORDANCE WITH NFPA96.
- 5 NEW MAKE-UP AIR UNIT (MAU-1) SUSPENDED FROM STRUCTURE.
- 6 NEW CEILING MOUNTED SUPPLY AIR DIFFUSER, RE-CONNECT TO EXISTING SUPPLY AIR DUCT.
- 7 NEW CEILING MOUNTED RETURN AIR GRILLE.
- 8 NEW EXHAUST FAN (EF-5) LOCATED ON ROOF TOP. INTERLOCK EF-5 WITH THE NEW MAU-1.
- 9 NEW HANDWASH SINK (SK-2)
- 10 NEW PLUMBING VENT LINE. CONNECT TO EXISTING VENT LINE.
- 11 NEW 1/2" DOMESTIC COLD WATER AND 1/2" DOMESTIC HOT WATER LINE IN CRAWLSPACE.
- 12 NEW 1 1/2" SANITARY LINE IN THE CRAWLSPACE. CONNECT TO EXISTING SANITARY LINE.
- 13 NEW 8" x 8" DUCT ACCESS.

0	ISSUED FOR CONSTRUCTION	EAG	SEPT 09 2022
00	ISSUED FOR 30% CLIENT REVIEW	EAG	MAY 20 2022
No.	REVISION/DESCRIPTION	BY	DATE

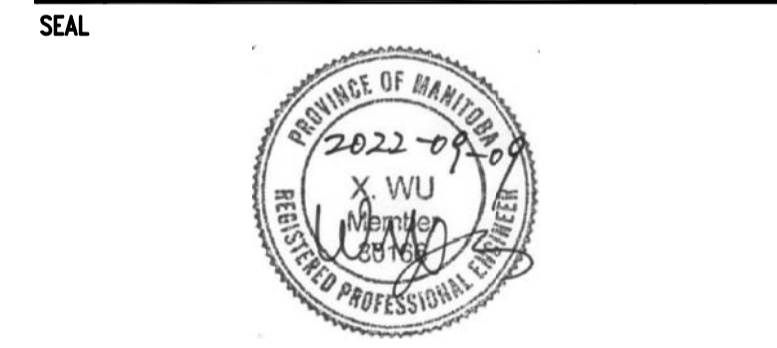

DRAWN	EAG	CHECKED	DESIGNED	XFW	APPROVED
DATE	2022.05.02	USER APPROVAL			

THE CITY OF WINNIPEG
PLANNING, PROPERTY AND DEVELOPMENT DEPARTMENT
MUNICIPAL ACCOMMODATIONS DIVISION
3-65 GARRY STREET, R3C 4K4

PROJECT
MAGNUS ELIASON RECREATION CENTRE
KITCHEN RENOVATION

430 LANGSIDE ST.
SHEET TITLE

PARTIAL MAIN FLOOR PLAN
MECHANICAL RENOVATION

SCALE	PROJECT No:	SHEET No:
AS SHOWN	2019-077	M3