

ALLEY PAVEMENT PROFILE
SCALE: 1:250 HOR
1:10 VER

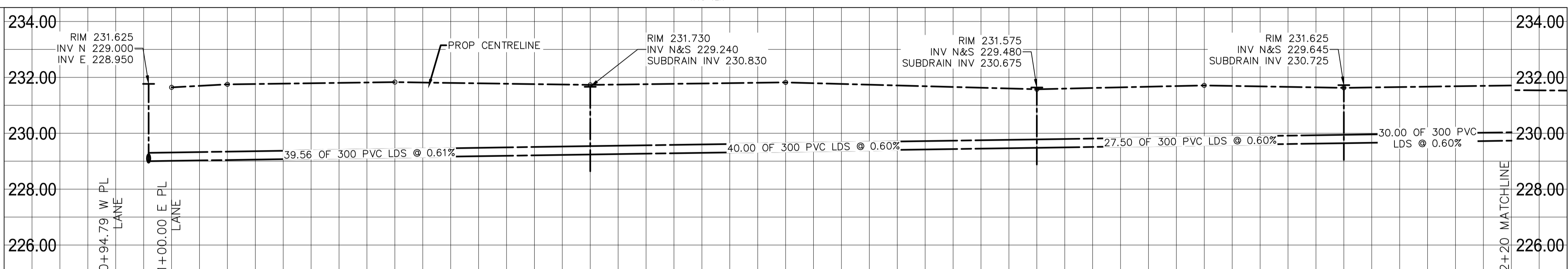

LAND DRAINAGE SEWER PROFILE
SCALE: 1:250 HOR
1:100 VER

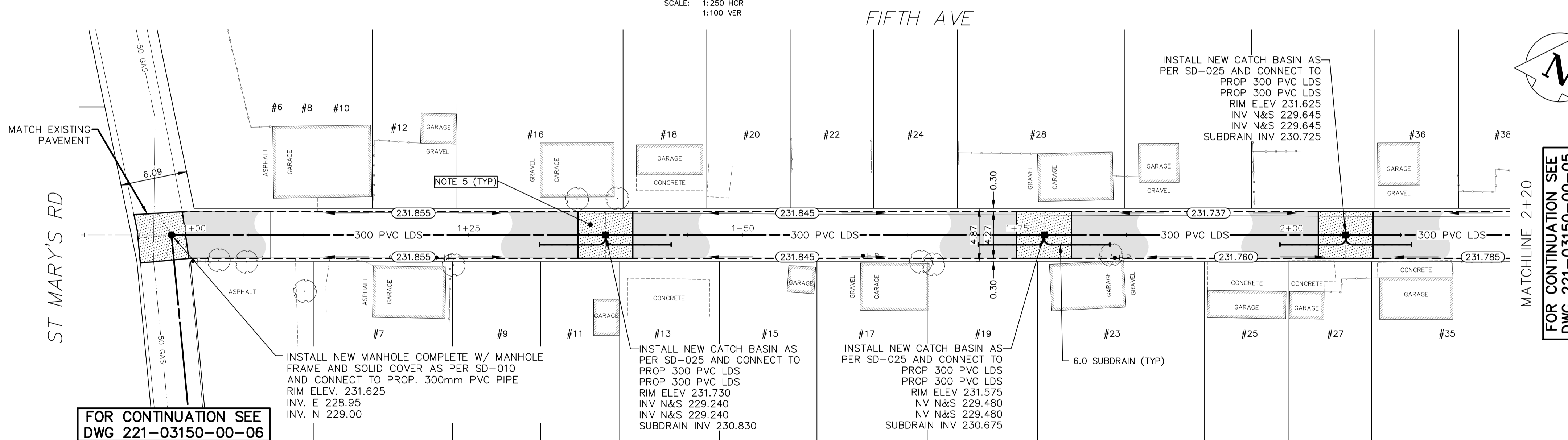

- NOTES:
1. ALL WORK AND MATERIALS TO BE IN ACCORDANCE WITH THE LATEST REVISION OF THE CITY OF WINNIPEG STANDARD CONSTRUCTION SPECIFICATIONS.
 2. CONTRACTOR TO CONFIRM THE LOCATION OF ALL UTILITIES/SERVICES IN THE FIELD PRIOR TO CONSTRUCTION.
 3. ALL ROADWAY DIMENSIONS SHOWN ARE TO BACK OF CURB.
 4. EXISTING ASPHALT TO BE PLANNED AS SHOWN OR AS DIRECTED BY CONTRACT ADMINISTRATOR.
 5. 150mm CONCRETE APRON, TEE AND MAIN APPROACHES AS DIRECTED BY CONTRACT ADMINISTRATOR.
 6. EXISTING SIDEWALK TO BE RENEWED AS PER SD-228A AND AS DIRECTED BY CONTRACT ADMINISTRATOR.
 7. PLANE/REMOVE EXISTING CURB AS DIRECTED BY CONTRACT ADMINISTRATOR.
 8. ALL PRIVATE WALKWAYS TO BE ADJUSTED TO NEW SIDEWALK OR TOP OF CURB ELEVATION, AS DIRECTED BY THE CONTRACT ADMINISTRATOR.
 9. PAVEMENT REPAIR FABRIC TO BE INSTALLED AS DIRECTED BY CONTRACT ADMINISTRATOR.
 10. ALL EXISTING PRIVATE APPROACHES TO BE RENEWED AS DIRECTED BY CONTRACT ADMINISTRATOR.
 11. INSTALLATION OF MOUNTABLE LIP CURBS AND THEIR LIMITS THROUGH PRIVATE APPROACHES TO BE DETERMINED BY CONTRACT ADMINISTRATOR.
 12. MODIFIED BARRIER CURB TO BE CONSTRUCTED AT ALL INTERSECTION RADI AND ALLEY RADI.
 13. CONTRACTORS TO TAKE PRECAUTIONARY STEPS TO PROTECT EXISTING TREES WITHIN THE LIMITS OF CONSTRUCTION FROM DAMAGE FROM CONSTRUCTION ACTIVITIES AS OUTLINED IN THE SPECIFICATIONS.
 14. LAMP STANDARDS, HYDRO POLES, AND ANCHORS THAT REQUIRE TEMPORARY SUPPORT, REMOVAL OR REPLACEMENT, TO BE DONE SO AT THE EXPENSE OF THE CONTRACTOR AS NECESSARY.
 15. WHERE UNSTABLE SUB GRADE ARE ENCOUNTERED, ADDITIONAL EXCAVATION AND PLACEMENT OF SUBBASE AS DIRECTED BY CONTRACT ADMINISTRATOR.
 16. ADJUSTMENTS TO PROPOSED CROSSFALL, WHERE REQUIRED, ARE TO BE DETERMINED BY CONTRACT ADMINISTRATOR TO SUIT EXISTING DRIVEWAYS, APPROACHES, GARAGE PADS AND YARDS.
 17. ALL BOULEVARDS TO BE SODDED UNLESS OTHERWISE NOTED.
 18. ADJUST ALL WATER VALVES, HYDRANTS, MANHOLES, AND CATCH BASINS IN WORK AREA TO GRADE.
 19. REMOVE, ADJUST AND SUPPLY PRECAST SIDEWALK BLOCKS AS DIRECTED BY CONTRACT ADMINISTRATOR.

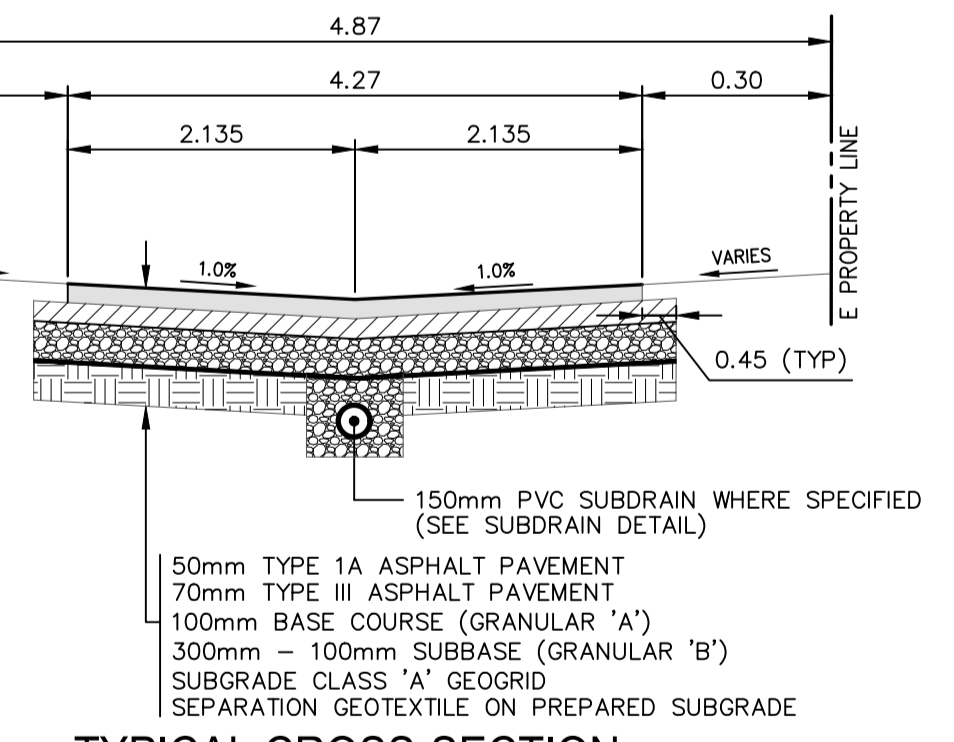
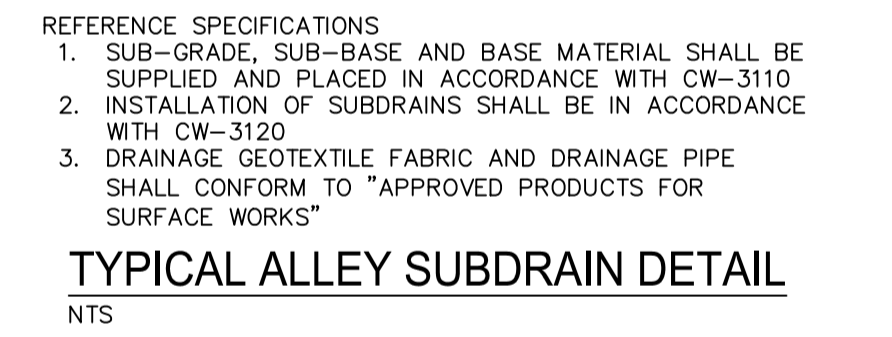
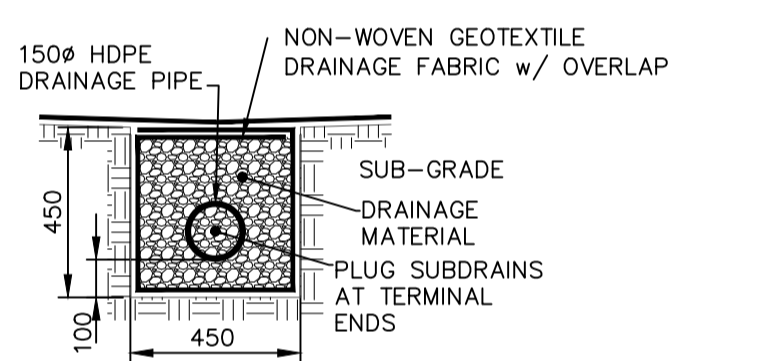
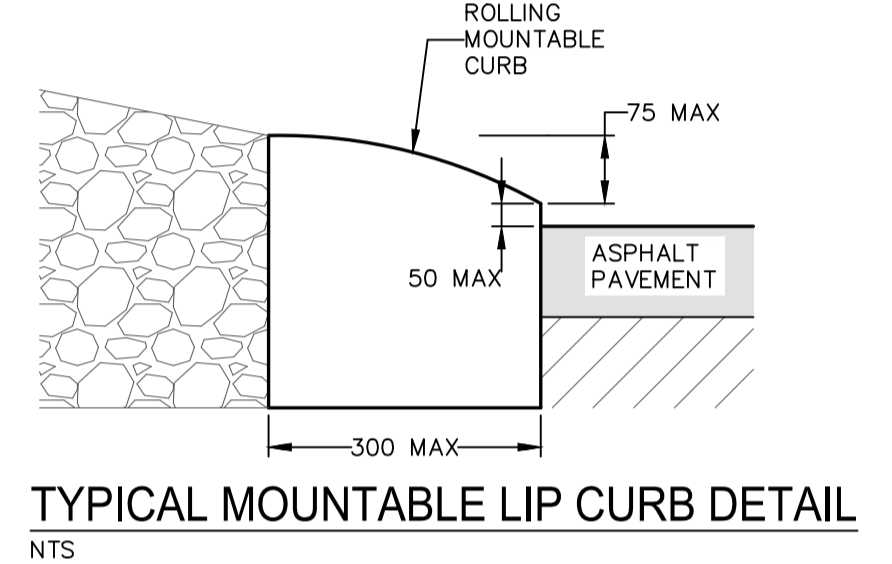
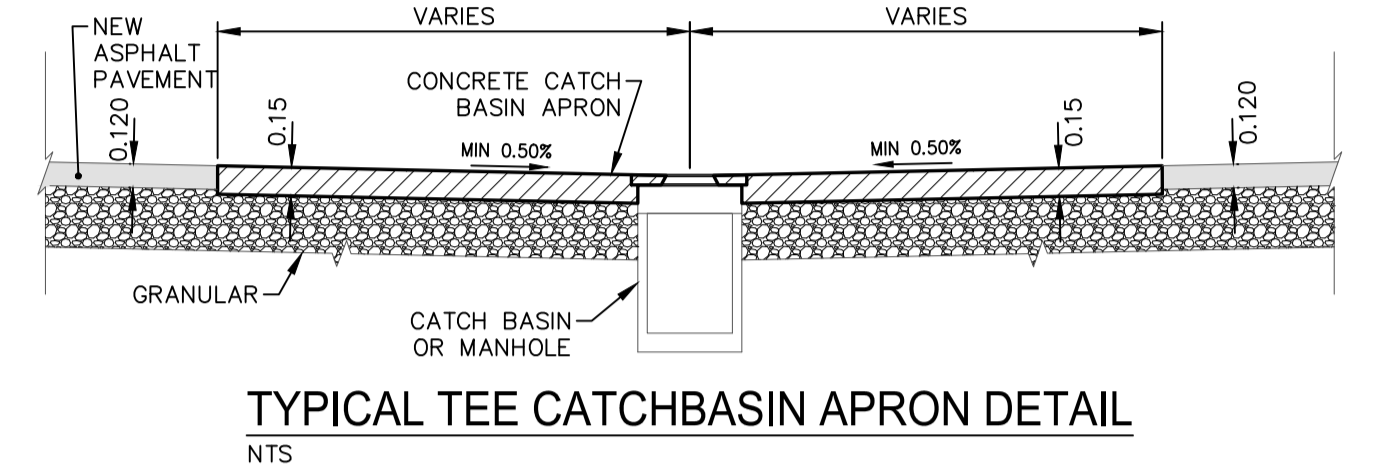

REFERENCE SPECIFICATIONS

1. SUB-GRADE, SUB-BASE AND BASE MATERIAL SHALL BE SUPPLIED AND PLACED IN ACCORDANCE WITH CW-3110
2. INSTALLATION OF SUBDRAINS SHALL BE IN ACCORDANCE WITH CW-3120
3. DRAINAGE GEOTEXTILE FABRIC AND DRAINAGE PIPE SHALL CONFORM TO *APPROVED PRODUCTS FOR SURFACE WORKS*

NOTE: CHAINAGES SHOWN ARE ALONG CL OF RIGHT-OF-WAY

LOCATIONS APPROVED UNDERGROUND STRUCTURES

SIGNED BY: _____ DATE: _____

NO. REVISIONS _____ DATE _____ BY _____

EXISTING	PROPOSED	EXISTING	PROPOSED	EXISTING	PROPOSED
WATER MAIN	---	IRON BAR	---		
LAND DRAINAGE SEWER	---	HYDRO POLE & LIGHT STANDARD	---		
WASTE WATER SEWER	---	LIGHT STANDARD OR TRAFFIC SIGNAL	---		
HYDRO	---	HYDRO POLE	---		
BELL/MTS	---	CURB RAMP	---		
GAS	---	DETECTABLE WARNING SURFACE TILE	---		
SIGNALS	---	EDGE OF SIDEWALK	---		
MANHOLE	---	FENCE	---		
CATCH BASIN	---	PROPERTY LINE	---		
CURB INLET	---	EDGE OF ASPHALT	---		
UTILITIES ADJUSTED	---	EDGE OF CONCRETE	---		
PLUG	---	MODIFIED BARRIER CURB	---		
HYDRANT	---	BARRIER CURB	---		
VALVE	---	BARRIER CURB AND GUTTER	---		
CURB STOP	---	CONC SIDEWALK	---		
GROUND GRADE (230.99)	---	CONCRETE SLAB	---		
PAVEMENT GRADE (231.00)	---	ASPHALT	---		
ANCHOR	---	MILLED SURFACE	---		
CIVIC ADDRESS #111	---	PAVEMENT REPAIR FABRIC	---		
LEGEND-PLAN	---	LEGEND-PROFILE	---		

METRIC FOR TENDER PURPOSES ONLY
WHOLE NUMBERS INDICATE MILLIMETRES
DECIMALIZED NUMBERS INDICATE METRES

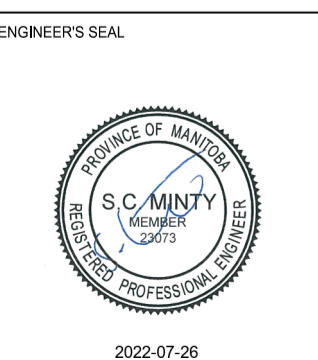

ENGINEERS GEOSCIENTISTS MANITOBA
Certificate of Authorization
WSP Canada Inc.
No. 5750

THE CITY OF WINNIPEG
PUBLIC WORKS DEPARTMENT
ENGINEERING SERVICES DIVISION

2022 TBO & LOCAL IMPROVEMENTS
FIFTH AVE/GUAY AVE ALLEY

ASPHALT ALLEY RECONSTRUCTION
STA. 0+94.79 TO STA. 2+20

CITY DRAWING NUMBER: ---04
SHEET 04 OF 12
TENDER NO. 541-2022

Jul 21, 2022 - 6:29pm
 P:\2022\221-03150-00-05\Highways_Bridges\1411.06_Dwg\03_Work_Dwg\221-03150-00-Fifth Ave_Guay Ave_Plan_Profile.dwg -tab:541-2022_Drawing_221-03150-00-04-RB