

NOTE: CHAINAGES SHOWN ARE ALONG CENTRE LINE OF ROW

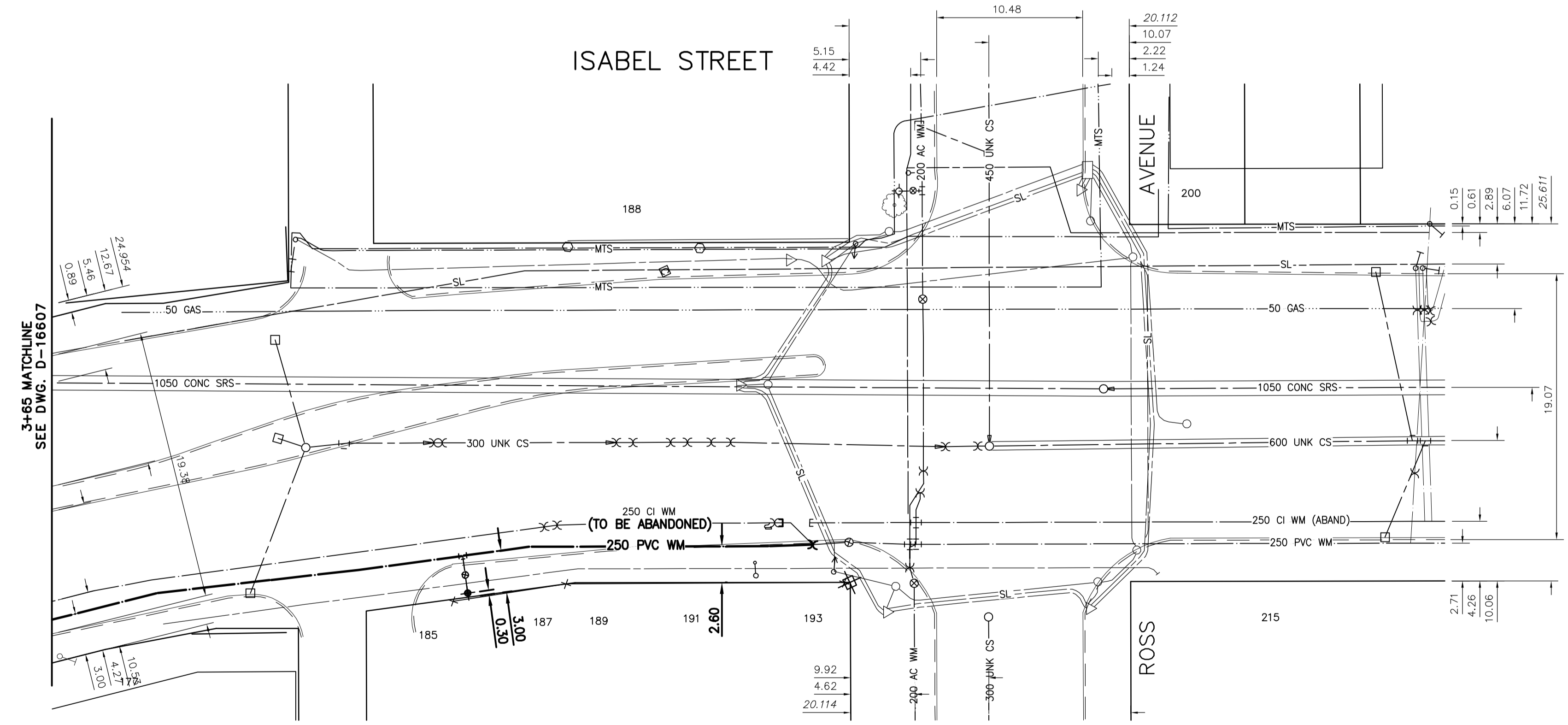
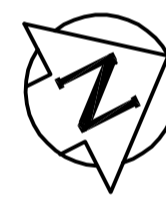

WATER SERVICE INFORMATION					
ADDRESS	PIPE SIZE & MATERIAL (STREET)	PIPE SIZE & MATERIAL (PROP.)	SHORT & LONG MEASUREMENT	CORP. LOCATION	REMARKS
177 ISABEL ST COMMERCIAL	CU 25	CU 25	3.05 WEL BUILDING	OPP S/C	OUTSIDE LIMIT OF WORK
188 ISABEL ST COMMERCIAL	CU 50	CU 50	18.29 EEL ISABEL	30.3 E/HYDT @ #188	OUTSIDE LIMIT OF WORK
185 ISABEL ST COMMERCIAL	CU 50	CU 50	5.49 WEL BUILDING	OPP S/C	OUTSIDE LIMIT OF WORK
187 ISABEL ST COMMERCIAL	CU 50	CU 50	32 EEL ISABEL	OPP S/C	OUTSIDE LIMIT OF WORK
189 ISABEL ST COMMERCIAL	CU 50	CU 50	5.49 WEL BUILDING	OPP S/C	OUTSIDE LIMIT OF WORK
191 ISABEL ST COMMERCIAL	CU 50	CU 50	32 EEL ISABEL	OPP S/C	OUTSIDE LIMIT OF WORK
193 ISABEL ST COMMERCIAL	CU 50	CU 50	5.49 WEL BUILDING	OPP S/C	OUTSIDE LIMIT OF WORK
200 ISABEL ST COMMERCIAL	CU 38	CU 38	21.6 NNL ROSS AV	1.5 S of S/C	OUTSIDE LIMIT OF WORK
			21.9 S of 1st HYD N of ROSS AV		

NOTE: VALVES TO BE INSTALLED COUNTER-CLOCKWISE TO CLOSE

FOR INDEX SEE D-16599

METRIC
WHOLE NUMBERS INDICATE MILLIMETRES
DECIMALIZED NUMBERS INDICATE METRES

ENGINEERS GEOSCIENTISTS MANITOBA
Certificate of Authorization
Stantec Consulting Ltd.
No. 1301

LOCATION APPROVED UNDERGROUND STRUCTURES

SUPV. U/G STRUCTURES COMMITTEE DATE

NOTE:
LOCATION OF UNDERGROUND STRUCTURES AS SHOWN ARE BASED ON THE BEST INFORMATION AVAILABLE BUT NO GUARANTEE IS GIVEN THAT ALL EXISTING UTILITIES ARE SHOWN OR THAT THE GIVEN LOCATIONS ARE EXACT. CONFIRMATION OF EXISTENCE AND EXACT LOCATION OF ALL SERVICES MUST BE OBTAINED FROM THE INDIVIDUAL UTILITIES BEFORE PROCEEDING WITH CONSTRUCTION.

B.M. 35-39 ELEV. 232.122m	N.W. Cor. Notre Dame Ave. & Ellen St., Tblt. in S. Conc. foundation No. 395 Notre Dame Ave., 1m W. & 0.05m below Tyndall Stone of S.E. Cor. of Bldg.		
00	ISSUED FOR TENDER	2023.04.05	RS
NO.	REVISIONS	DATE	BY

Stantec

DESIGNED BY: RS
CHECKED BY: RS
DRAWN BY: BP/OS
APPROVED BY: RS
SCALE: HORIZONTAL 1:250, VERTICAL 1:50
RELEASED FOR CONSTRUCTION: 2023.03.21
DATE: 2023.04.04

ENGINEER'S SEAL

CONSULTANT DRAWING NUMBER: C-209

THE CITY OF WINNIPEG
WATER AND WASTE DEPARTMENT
ENGINEERING DIVISION

2023 WATER MAIN RENEWALS
CONTRACT 8
ISABEL STREET
57.3 S OF ROSS AVENUE TO
22.6 N OF ROSS AVENUE

SHEET 11 OF 15
CITY DRAWING NUMBER: D-16608