

V:\112\active\11220782\0300_drawing\0300_sheet_files\02_civil\20782c-101.dwg C-101
2023/07/27 4:22 PM By: Kalmar Joe

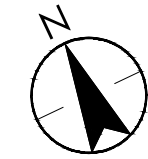
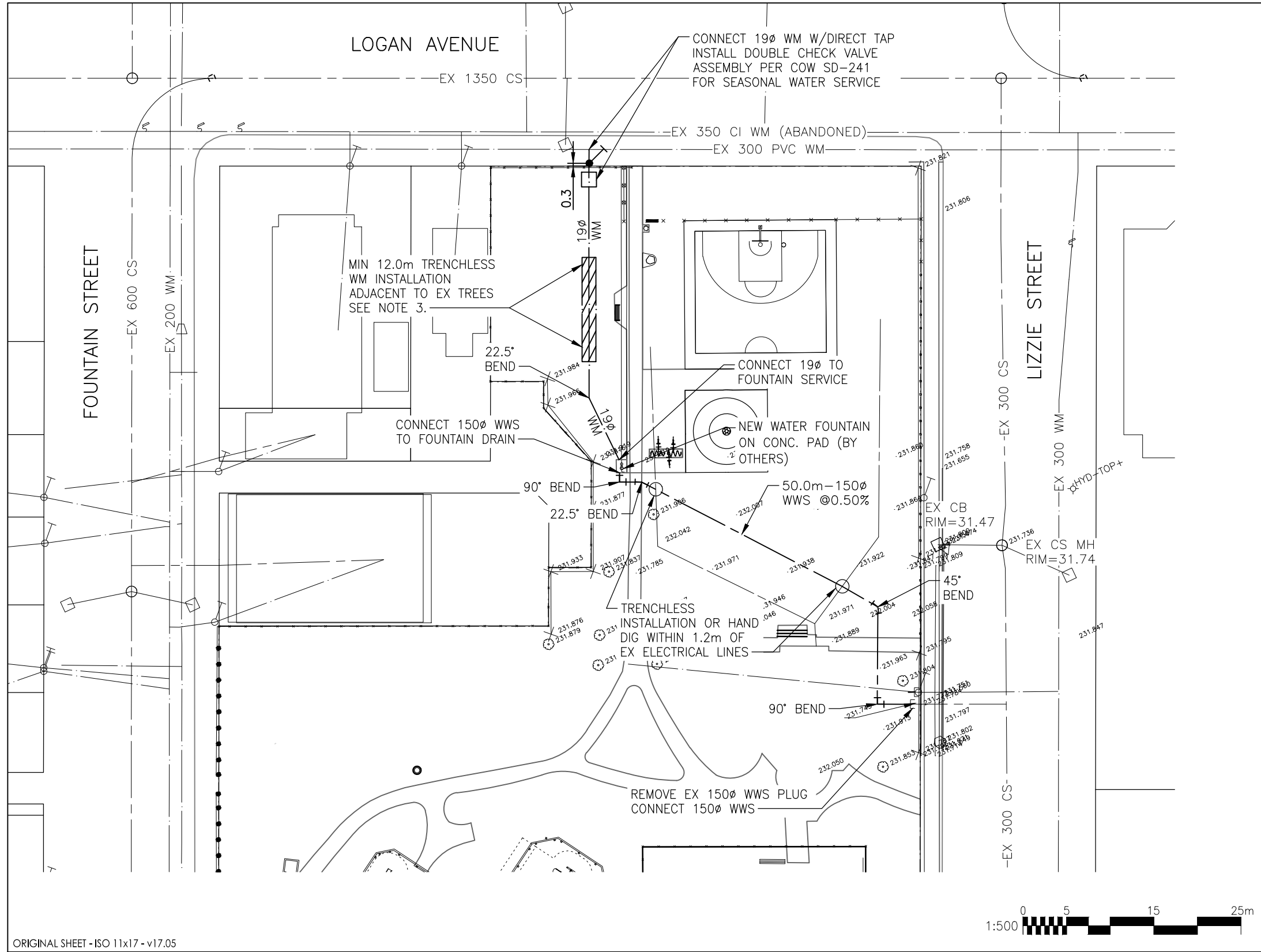

EXISTING	LEGEND - PLAN	PROPOSED
150 WM	WATERMAIN	150 WM
⊕	HYDRANT	⊕
⊗	VALVE	⊗
250 CS	COMBINED SEWER	250 CS
○	MAINTENANCE HOLE	
□	CATCH BASIN	■
▽	CURB INLET	▽
---	POWER	
---	SIDEWALK	

**ENGINEERS
GEOSCIENTISTS
MANITOBA**

Certificate of Authorization
Stantec Consulting Ltd.
No. 1301



WARNING

IF POWER EQUIPMENT OR EXPLOSIVES ARE TO BE USED FOR EXCAVATION ON THIS PROJECT THE CONTRACTOR MUST:

- 1) NOTIFY THE GAS COMPANY OF THE PROPOSED LOCATION OF EXCAVATION.
- 2) TAKE PRECAUTION TO AVOID DAMAGE TO GAS COMPANY INSTALLATIONS.

SEE PROVINCIAL REGULATION 140/92 FOR DETAILS

METRIC

WHOLE NUMBERS INDICATE MILLIMETRES
DECIMALIZED NUMBERS INDICATE METRES

2023-07-27
11220782

ORIGINAL SHEET - ISO 11x17 - v17.05



Stantec
Stantec Consulting Ltd.
Suite 500, 311 Portage Avenue
Winnipeg MB Canada R3B 2B9
Tel. 204.489.5900 Fax. 204.453.9012
www.stantec.com

Notes

1. CONTRACTOR TO VERIFY LOCATION, INVERTS AND TYPE OF ALL EXISTING BURIED UTILITIES PRIOR TO CONSTRUCTION AND NOTIFY ENGINEER OF ANY DISCREPANCIES.
2. ALL MATERIALS AND CONSTRUCTION SHALL BE IN ACCORDANCE WITH THE LATEST EDITION OF THE CITY OF WINNIPEG STANDARD CONSTRUCTION SPECIFICATION.
3. ALL WATER SERVICES TO HAVE A MINIMUM OF 2.5m COVER AND TO BE INSTALLED USING TRENCHLESS METHODS WHERE POSSIBLE.
4. ALL TRENCH BACKFILL FOR WATER, SEWER AND PVC CONDUIT INSTALLATIONS SHALL BE CLASS B SAND BEDDING WITH CLASS 2 BACKFILL WHEN WITHIN 1.0m OR UNDER NEW OR PROPOSED PAVEMENT AREAS AND CLASS 4 BACKFILL IN LANDSCAPED AREAS.

Client/Project
CITY OF WINNIPEG - PARKS DEPARTMENT
GIIZHIGOOWEYAABIWE PARK
PARK REDEVELOPMENT

Figure No.
C-101

Title
DRINKING FOUNTAIN/BOTTLE FILL STATION
242 LIZZIE STREET - WINNIPEG MB