

SECTIONAL PLAN

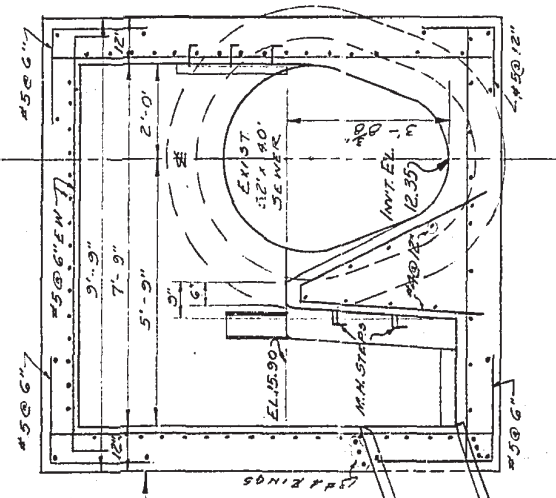

SECTION B-B

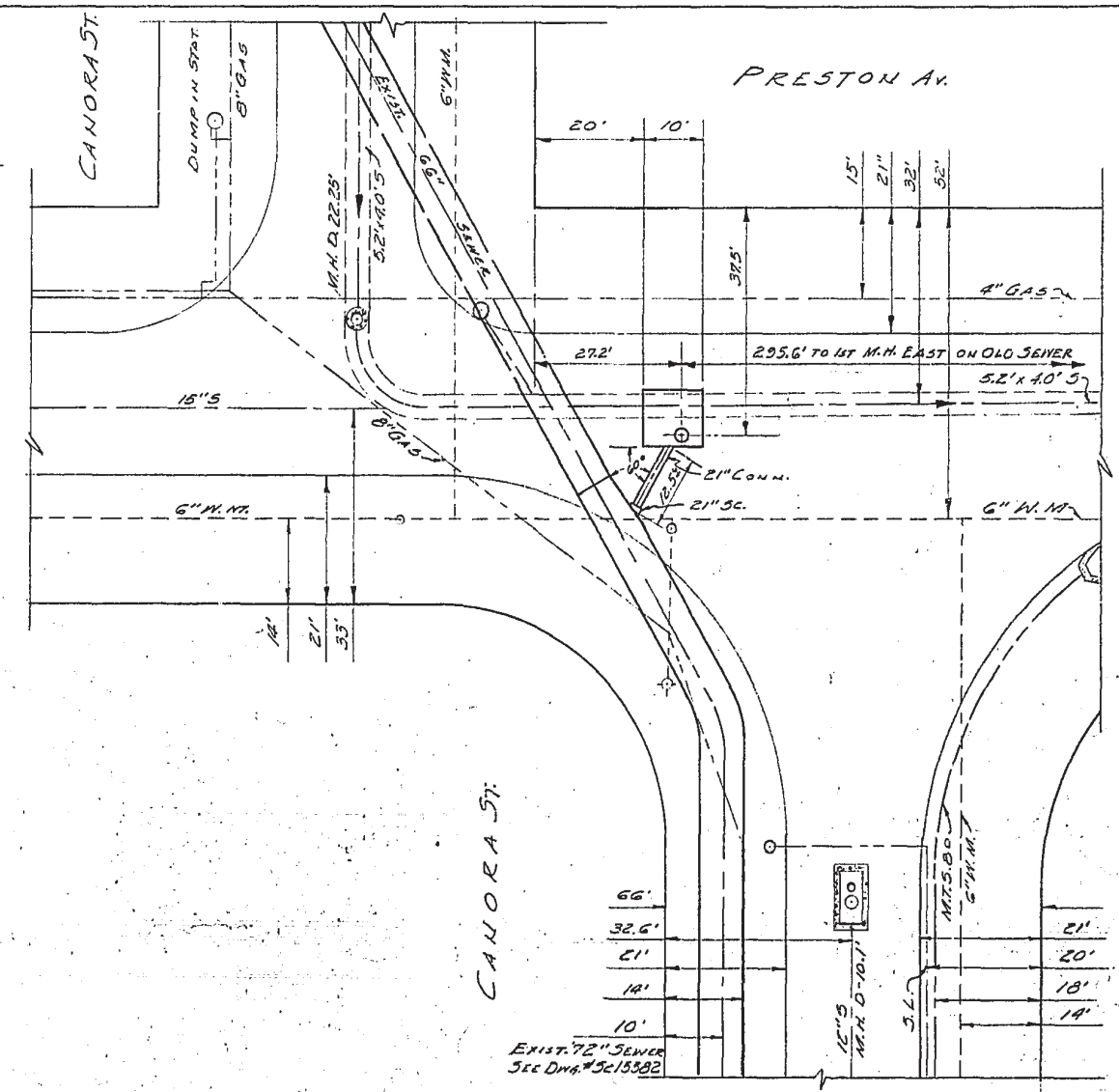

LOCATION PLAN
1" = 20'

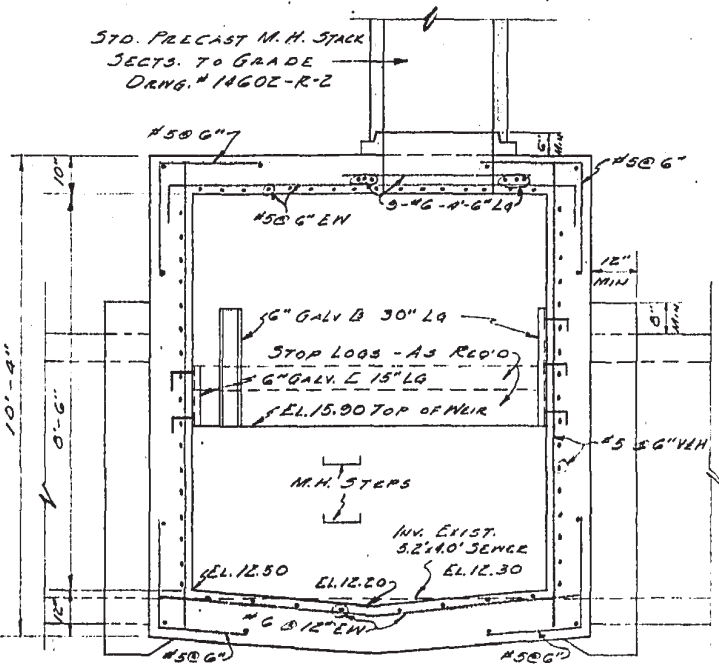

SECTION A-A

INVERT OF EXISTING SEWER
MUST BE CHECKED BEFORE
WORK IS STARTED ON THIS SEWER

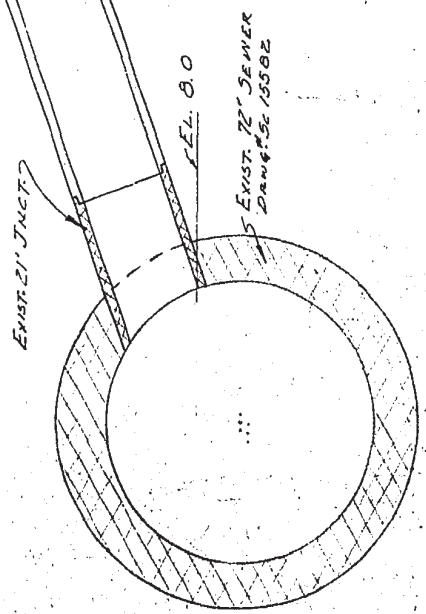

LOCATION OF UNDERGROUND STRUCTURES AS SHOWN
ARE BASED ON BEST INFORMATION AVAILABLE, BUT
EXACT LOCATION IS NOT GUARANTEED, AND MUST
BE CHECKED WITH UTILITY CONCERNED BEFORE
PROCEEDING WITH CONSTRUCTION.

LOCATION APPROVED
UNDERGROUND STRUCTURES COMMITTEE
22-1-64

REVISED AS
CONSTRUCTED
BY H.R. DATE 23-2-65
CHECKED BY: DATE

B.M. N.E. COR. LOWER CONC. STEP
#920 PALMERSTON W. EL. 33.99

W.O. #100-120-073
1554E0 9/7/64

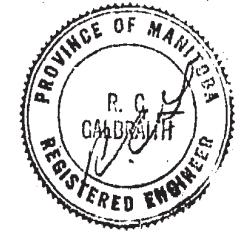

DETAILS RELIEF OVERFLOW
ON PRESTON AV. SEWER
AT CANORA ST.

CITY OF WINNIPEG ENGINEERING DEPARTMENT W. D. HURST, CITY ENGINEER J. B. STROWSKI, DEPUTY CITY ENGINEER	DRAWN BY H.R. DATE 17/1/64	SCALE 3/8" = 1'-0"
	TRACED BY	Drawing No.
	CHECKED BY	5C15591
APPROVED BY		