

**PLAN**  
Scale 1:500

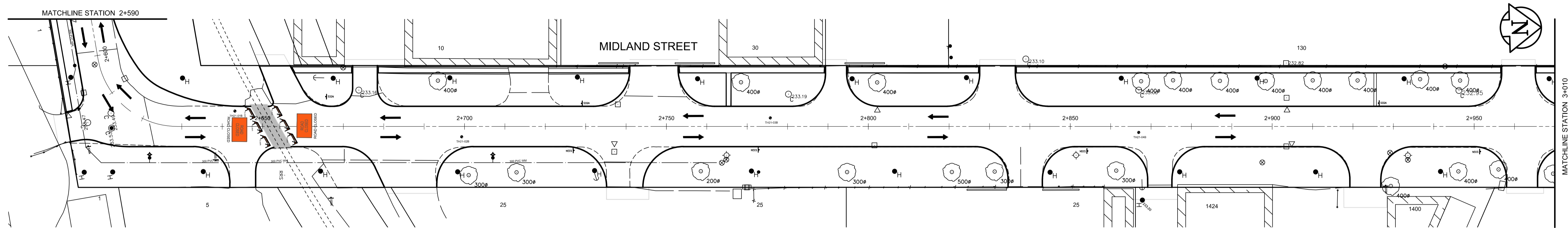

**PLAN**  
Scale 1:500

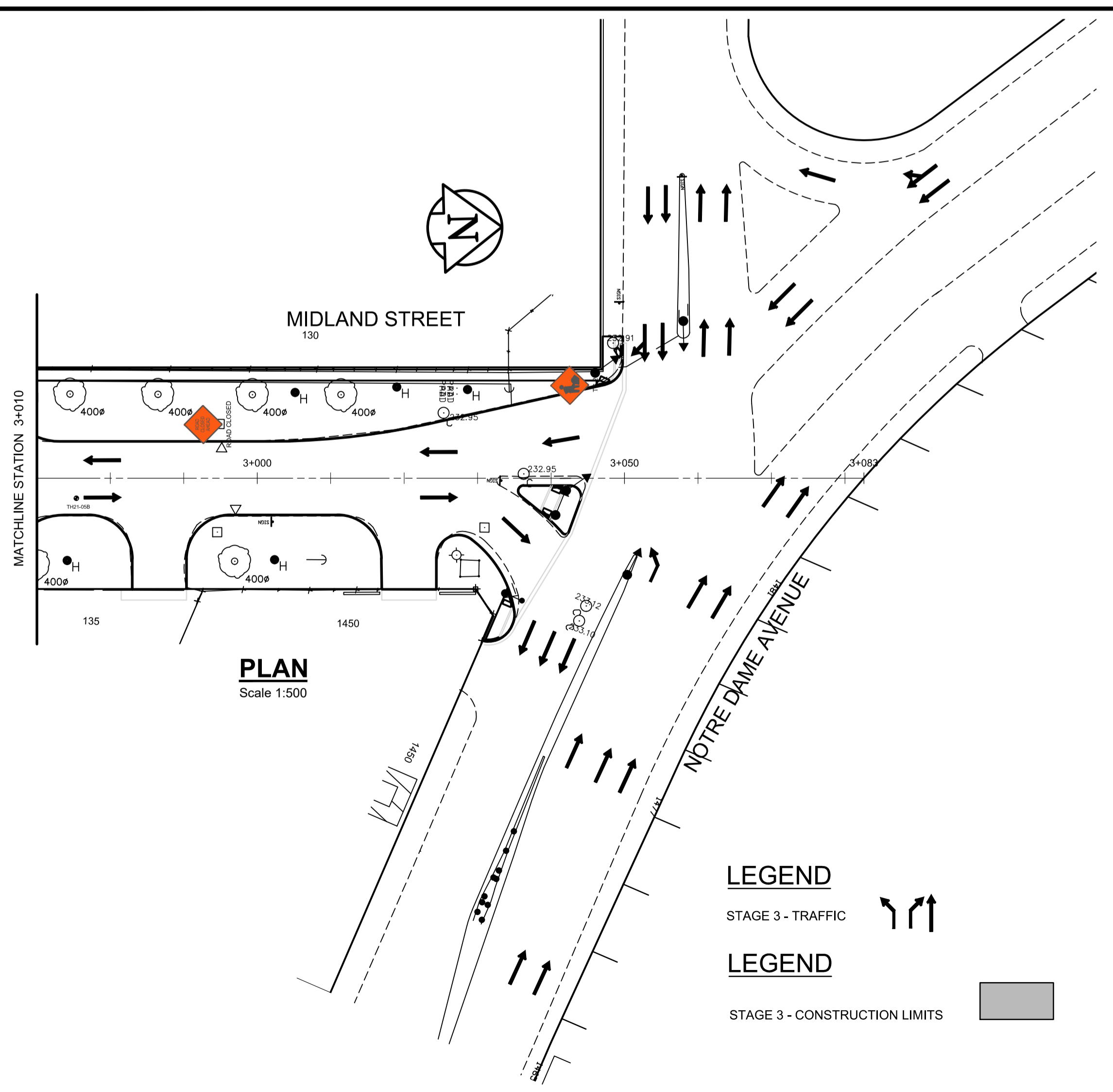

**PLAN**  
Scale 1:500

**LEGEND**  
STAGE 3 - TRAFFIC

**LEGEND**  
STAGE 3 - CONSTRUCTION LIMITS

**ENGINEERS**  
**GEOSCIENTISTS**  
**MANITOBA**

Certificate of Authorization  
AECOM Canada Ltd.  
No. 4671 Date: 02/26/24

**METRIC**  
WHOLE NUMBERS INDICATE MILLIMETRES  
DECIMALIZED NUMBERS INDICATE METRES

B.M. ELEV.					
0	ISSUED FOR TENDER	02/26/24	RC		
NO.	REVISIONS	DATE	BY	DATE	02/13/23

**AECOM**

DESIGNED BY	SS	CHECKED BY	BC
DRAWN BY	SS	APPROVED BY	RC
HOR. SCALE:	AS SHOWN	RELEASED FOR CONSTRUCTION BY:	
VERTICAL:			

ENGINEER'S SEAL

CONSULTANT DRAWING NO.  
CT-03

**THE CITY OF WINNIPEG**  
PUBLIC WORKS DEPARTMENT  
ENGINEERING DIVISION

2024 INDUSTRIAL STREET  
RENEWAL PROGRAM

MIDLAND STREET & SASKATCHEWAN AVENUE -  
EMPRESS STREET TO NOTRE DAME AVENUE  
CONCRETE PAVEMENT RECONSTRUCTION  
CONSTRUCTION STAGING AND TRAFFIC MANAGEMENT PLAN - STAGE 3

CITY DRAWING NUMBER  
SHEET 03 OF 11

- NOTES:
- ALL TEMPORARY SIGNAGE AND TRAFFIC CONTROL TO BE IN ACCORDANCE WITH THE LATEST EDITION OF THE MANUAL OF TEMPORARY TRAFFIC CONTROL ON CITY STREETS.
  - CONTRACTOR TO MAINTAIN VEHICULAR ACCESS TO ALL SIDE STREETS AND PRIVATE PROPERTIES AT ALL TIMES (INCLUDING LEFT TURNS UNLESS SHOWN ON THE DRAWINGS), ANY DISRUPTION TO BE APPROVED BY THE CONTRACT ADMINISTRATOR AND CONTRACTOR TO ADVISE OWNER.
  - TRAFFIC SERVICES TO PLACE ADVANCE WARNING SIGNAGE FOR THE FULL CLOSURE OF MIDLAND STREET FOR CP RAILWAY CROSSING REPLACEMENT AND ASSOCIATED ROADWORKS. FULL CLOSURE OF MIDLAND STREET TO BE SCHEDULED FOR SATURDAY/SUNDAY.