

PLAN VIEW: UNDERGROUND CONSTRUCTION
1:300

CONSTRUCTION NOTES:

- PROJECT SCOPE**
1. INSTALL CONDUIT, BASES AND PITS AS SHOWN.
 2. REBUILD SERVICE AND INSTALL GROUND ROD ON WOOD POLE #11 AS SHOWN. INSTALL MAST AND DISCONNECT ON NE QUADRANT. INSTALL WEATHER HEAD 150mm LOWER THAN THE LOWEST HYDRO WIRE. TOTAL LENGTH OF SERVICE CABLE: Xxm.
 3. INSTALL EQUIPMENT AS SHOWN. REMOVE SIGNALS EQUIPMENT FROM JOINT USE POLE #E1.
 4. TIMINGS REQUIRED.
- PROJECT COORDINATION**
1. COORDINATE WORK WITH RYAN CUNNINGHAM, (204) 792-6742.
 2. COORDINATE HYDRO SERVICE REBUILD WITH PHILLIP BRUCE, (204) 360-3073. RE: JUTA PERMIT No. B25680
 3. TWO WEEKS PRIOR TO CONSTRUCTION, COORDINATE REMOVAL OF SIGNALS EQUIPMENT FROM JOINT USE POLE #E1 WITH JENNIFER KARPIAK, (204) 794-7079, jkarpiak@winnipeg.ca.

DETECTION CONNECTION DETAILS			
SENSOR NO.	POLE NO.	DETECTION LOCATION	NOTES
MATRIX 1	5	SB LANES	

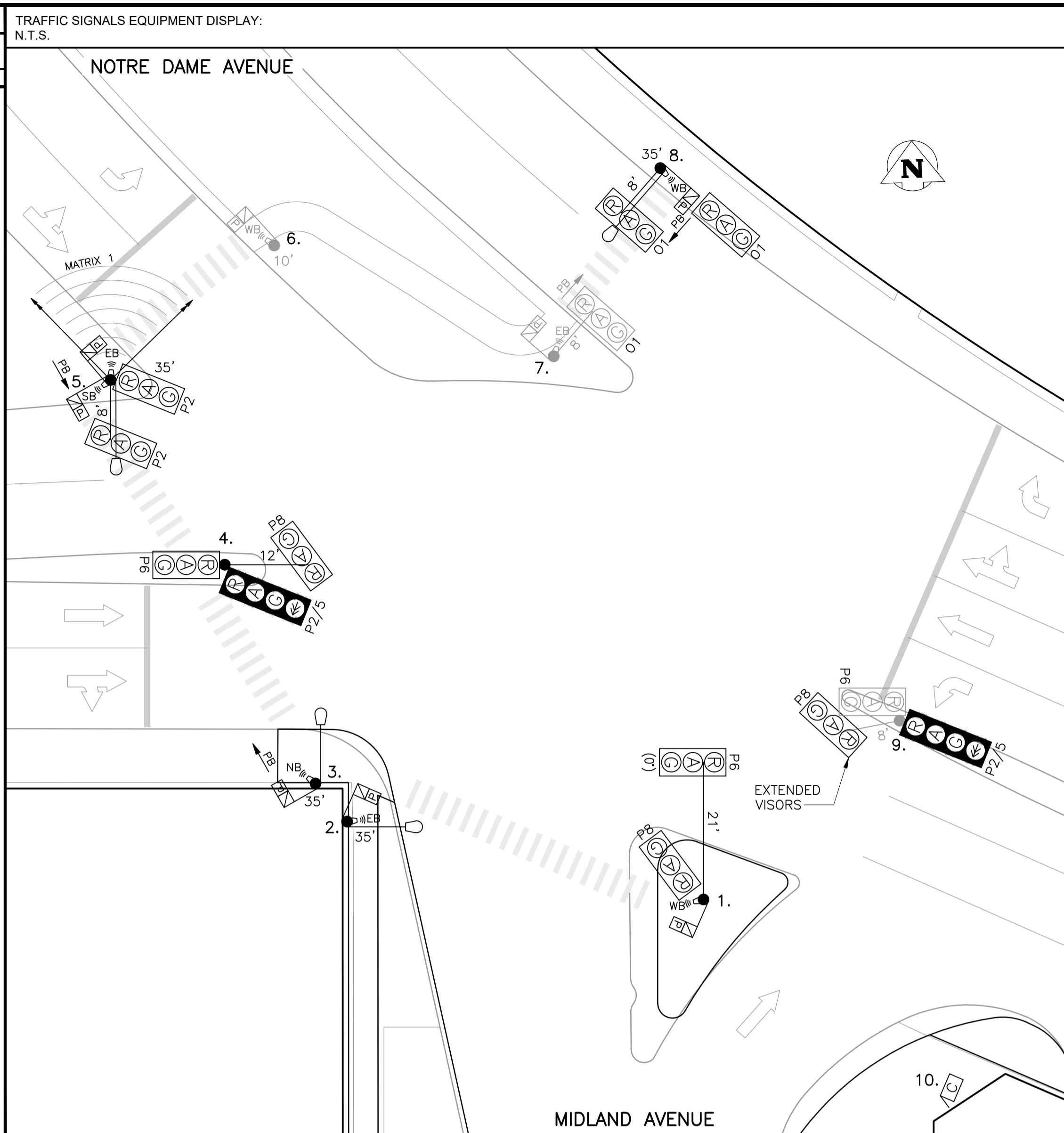

EQUIPMENT DISPLAY LEGEND				EQUIPMENT LIST				EQUIPMENT LIST			
EXISTING	PROPOSED (AS SHOWN BELOW)	NO.	EQUIPMENT LIST	ARM	BASE	B.B.	NO.	EQUIPMENT LIST	ARM	BASE	B.B.
	PEDESTRIAN HEAD WITH PCS	1.	CANTILEVER	21'	G	FIXED	9.	DAVIT	B'	A	AD
	PEDESTRIAN CORRIDOR BOX	2.	35' SIGNAL FOR 150 WATT (15000 LUMEN) LUMINAIRE		G	GD	10.	332 CABINET/2070 CONTROLLER			
	RRFB (PHASE 'A' OR 'B')	3.	35' SIGNAL FOR 150 WATT (15000 LUMEN) LUMINAIRE		G	GD	11.	HYDRO WOOD #0044832 SERVICE:			
	VEHICLE DETECTION AREA	4.	DAVIT	12'	A	AD	E1.	45' SIGNAL	F		
	PUSH BUTTON & DIRECTION (APB + AUDIBLE PB)	5.	35' SIGNAL FOR 150 WATT (15000 LUMEN) LUMINAIRE	8'	A	AD					
	APS SINGLE DIRECTION	6.	10' SIGNAL		A	A					
	APS DUAL DIRECTION (2 SEPARATE SPEAKERS)	7.	DAVIT	8'	A	AD					
	TRAFFIC SIGNAL HEAD	8.	35' SIGNAL FOR 150 WATT (15000 LUMEN) LUMINAIRE	8'	A	AD					

TRAFFIC SIGNALS UNDERGROUND LEGEND				SIGNAL BASE BOLT SQUARE TYPES				
EXISTING	ABANDONED	PROPOSED (AS SHOWN BELOW)	DISCONNECTED (LOOPS ONLY)	BOLT SQUARE (B.S.) DIA.				
1 1/2" PE CONDUIT		POLE BASE		TYPE "A" - 8 1/8"	TYPE "B" - 6 3/4"			
2" PE CONDUIT		WOOD POST		TYPE "C" - 8 1/8" SCREW TYPE	TYPE "D" - 12 3/4", 1 1/4" DIA. BOLTS, 24" DIA.			
4" PVC CONDUIT		CONTROLLER BASE		TYPE "OD" - 12 3/4", 1 1/4" DIA. BOLTS, 28" DIA.	TYPE "POD" - 12 3/4", PRECAST, 1 1/4" DIA. BOLTS, 28" DIA.			
AERIAL / BURIED CABLE		PEDESTAL BASE		TYPE "E" - 9 9/16" SCREW TYPE	TYPE "F" - 9 9/16"			
CONDUIT STUB		TERMINAL BASE		TYPE "G" - 8 1/8", 1 1/4" DIA. BOLTS, 89mm PROJ.	TYPE "GS" - 8 1/8", 1 1/4" DIA. BOLTS, 76mm PROJ.			
BREAK-IN		SERVICE BOX (PIT)		TYPE "H" - 9 7/8" SCREW TYPE	TYPE "I" - 7 3/4"			
SPICE		24" PRECAST PIT		TYPE "J" - 10 5/8", 1 1/4" DIA. BOLTS	TYPE "K" - 10 5/8", PRECAST, 1 1/4" DIA. BOLTS			
SAW-CUT LOOPS		36" PRECAST PIT		TYPE "L" - 6", 5/8" DIA. BOLTS	TYPE "PM" - 8 1/8", PRECAST, 5/8" DIA. BOLTS			
PERFORMED LOOPS		REMOVAL						

UGS REVIEW NOTES

GENERAL:

1. INSTALL NEW CONDUITS MINIMUM 1.0m BELOW EXISTING GRADE
2. EXCAVATION PERMITS REQUIRED PRIOR TO CONSTRUCTION
3. CONTACT "CLICK BEFORE YOU DIG MANITOBA" AT ClickBeforeYouDigMB.com THREE FULL WORKING DAYS PRIOR TO CONSTRUCTION FOR LOCATION OF EXISTING WATER, WASTEWATER AND LAND DRAINAGE UTILITIES.

WATER AND WASTE DEPARTMENT:

A MINIMUM CLEARANCE OF 1.0 METER MUST BE PROVIDED BETWEEN THE UNDERSIDE OF ANY EXISTING WATERMAIN OR SEWERMAIN PIPE AND THE TOP OF THE PROPOSED WORKS. THIS INSTALLATION BY TRENCHLESS METHOD ONLY.

A MINIMUM CLEARANCE OF 0.5 METERS MUST BE PROVIDED BETWEEN THE UNDERSIDE OF THE PROPOSED WORKS AND THE TOP OF ANY EXISTING WATERMAIN OR SEWERMAIN.

A MINIMUM LATERAL CLEARANCE OF 1.0 METER MUST BE PROVIDED BETWEEN ANY EXISTING WATERMAIN OR SEWERMAIN PIPE AND THE PROPOSED WORKS, BUT 2.0 METERS IS RECOMMENDED.

A SHAFT MUST BE EXCAVATED BY SOFT DIG METHODS 4.0 METERS FROM THE CENTRELINE OF THE EXISTING WATERMAIN OR SEWERMAIN PIPE TO CONFIRM THE ALIGNMENT AND ELEVATION OF THE DRILLING ROD BEFORE IT CROSSES OVER OR UNDER THE EXISTING WATERMAIN OR SEWERMAIN PIPE. THIS CONFIRMATION MUST BE WITNESSED BY A CITY REPRESENTATIVE.

CLEARANCE FOR STANDARD FIRE HYDRANT ASSEMBLY (STANDARD DETAIL SD-006)

A MINIMUM CLEARANCE OF 3.0 METERS MUST BE PROVIDED BETWEEN THE NEAREST EDGE OF THE WORK AND THE CENTRE OF ANY EXISTING HYDRANT ASSEMBLY. DO NOT CROSS HYDRANT BRANCH WITH THE PROPOSED WORK.

EXISTING	LEGEND	PROPOSED	EXISTING	LEGEND	PROPOSED	EXISTING	LEGEND	PROPOSED
150 WM	WATERMAIN	150 WM	PROPERTY LINE	TELEPHONE	TELEPHONE	TELEPHONE	TELEPHONE	TELEPHONE
Hydrant	HYDRANT	Valve	ROADWAY	COMMUNICATION	COMMUNICATION	COMMUNICATION	COMMUNICATION	COMMUNICATION
Shutoff Valve	SHUTOFF VALVE	Sewer	SIDEWALK	WOOD POLE	WOOD POLE	WOOD POLE	WOOD POLE	WOOD POLE
300 Sewer	SEWER	Manhole	CURB & CURB RAMP	STREET LIGHT	STREET LIGHT	STREET LIGHT	STREET LIGHT	STREET LIGHT
Manhole	MANHOLE	Catch Basin	WARNING TILE	BANNER POLE	BANNER POLE	BANNER POLE	BANNER POLE	BANNER POLE
Catch Basin	CATCH BASIN	Curb Inlet	CULVERT	RAILWAY POLE	RAILWAY POLE	RAILWAY POLE	RAILWAY POLE	RAILWAY POLE
Curb Inlet	CURB INLET	Hydro	BUILDING	GUY-WIRE	GUY-WIRE	GUY-WIRE	GUY-WIRE	GUY-WIRE
Hydro	HYDRO	100 Gas	TREE	FENCE	FENCE	FENCE	FENCE	FENCE
100 Gas	100 GAS	Hydro	GAS	GUARDRAIL	GUARDRAIL	GUARDRAIL	GUARDRAIL	GUARDRAIL

UNDERGROUND STRUCTURES		CONSTRUCTION REVISIONS	
UNDERGROUND STRUCTURES ID	DATE (YYYY/MM/DD)	NO.	REVISION
2023350	2023/05/09		
2023W0344			
WATER & WASTE REVIEW ID			

NO.	REVISION	DATE (YYYY/MM/DD)	BY	APPROVED BY
A	PRELIMINARY DESIGN	2023/12/11	R.S.	
2	RE-ISSUED FOR UGS APPROVAL	2023/04/17	R.S.	
1	ISSUED FOR CONSTRUCTION	2023/01/10	L.G.	
0	ISSUED FOR UGS APPROVAL	2022/06/06	R.S.	

DESIGNED BY	R.S.
DRAWN BY	R.S.
CHECKED BY	C.H.
APPROVED BY	

ACCOUNTS:
18202312WT

ENGINEER'S SEAL:

PRELIMINARY

NOT FOR CONSTRUCTION

THE CITY OF WINNIPEG
PUBLIC WORKS DEPARTMENT
TRANSPORTATION DIVISION

TRAFFIC SIGNALS
DUBLIN AVE. & MIDLAND ST. &
NOTRE DAME AVE.

UNITS:
ALL DIMENSIONS ARE IN METERS
UNLESS OTHERWISE NOTED

DRAWING NUMBER:
S-1420

V:\Traffic Signals\18202312WT - Intersection\Dublin & Midland & Notre Dame - S-1420\02 - Design\Current - Dublin & Midland & Notre Dame