

# ASBESTOS INVENTORY CONTROL



Assets & Project Management Department  
Municipal Accommodations Division  
4th Floor - 185 King Street • Winnipeg, MB • R3B 1J1

<b>Building Name:</b>	Seven Oaks Indoor Pool & Bldg	<b>Inspection Date:</b>	December 7, 2022
<b>Building Code:</b>	PI-01	<b>Inspected By:</b>	A Brodbeck & N Richardson
<b>Building Address:</b>	444 Adsum Drive	<b>Construction Date:</b>	1977

## NOTES:

- Asbestos inspections and inventory updates are conducted annually.
- There may be asbestos containing materials present that were not located during asbestos inspections.
- Floor tile and sheet flooring installed before 1990 may contain asbestos and must be treated as an asbestos containing material.
- Vermiculite insulation may contain pockets of asbestos. All vermiculite insulation must be treated as an asbestos containing material.
- For asbestos related inquiries, call Central Control at 986-2382**

# PI-01

Material Location	Material Description	Drawing Label	Material Condition	Testing Status	Lab Report #	Date M/Y	Test %	Est. %
	Drywall Compound throughout may contain asbestos	DC					1-5	
<b>Main Floor</b>								
Men/Women Washroom(s)	Stipple Texture Ceiling (3 Samples Taken)( Lobby Area - Removed by others)	ST	Removed	TESTED	193753	Oct'17	3	
Men/Women Sauna(s)	Cement Board (3 Samples)		Good	TESTED	198835	Mar'18	0	
	Potential Plaster Above Cedar?	PL						
Pool Deck	Drywall Compound Ceiling (above cedar planks-CONFIRM)	DC	Good					1-5
<b>Mezzanine</b>								
Mechanical Room	Pipe Fitting Insulation	PF	Good	TESTED			0	
	Duct Insulation - Mastic Only (Interior)(serpentine)	MA	Good	TESTED	L1923761	May'17	10-25	
	Pipe Fitting Insulation (3 samples)	PF	Good	TESTED	195081	Dec'17	0	
	Duct Mastic - 6" x 6" duct - (3 Samples)	MA	Good	TESTED	204239	Jun'18	5	
	Duct sealant (red/brown - serpentine )	MA	Good	TESTED		May'17	1-10	
	Insulation black, fibrous (3 samples)	DI	Needs Repair	TESTED	b190457	May'18	0	
	Black mastic / tar 3 (on black insulation)	MA	Good	TESTED	b190457	May'18	25	
	Insulation - Grey, Fibrous and wrap (3 samples)	DI	Good	TESTED	b190457	May'18	0	
	Gasket			TESTED		May'18	0	
Office(s)	24x48 Ceiling Tile	C48	Good	TESTED			0	
	Drywall Compound (3 Samples)	DC	Good	TESTED	198835	Mar'18	0	
Storage Room	Drywall Compound (3 Samples)	DC	Good	TESTED	198835	Mar'18	0	

Material Location	Material Description	Drawing Label	Material Condition	Testing Status	Lab Report #	Date M/Y	Test %	Est. %
Balcony	Drywall Compound-Ceiling above cedar planks (serpentine)	DC	Removed	TESTED		May'17	1-5	
	Drywall			TESTED		May'17	0	
	Drywall Compound (above window frame)	DC	Needs Repair					1-5
Viewing Gallery	Drywall Compound (behind cedar planks upper wall)	DC	Good					1-5
<b>Basement</b>								
Staff Room	Pipe Fitting Insulation	PF	Good					0
	Pipe Insulation	PI	Good					0
Entrance to Women's Locker Room	Pipe Fitting Insulation	PF	Good	TESTED	102055	Jul/'11	0	
	Pipe Insulation	PI	Good					0
Women's Locker Room	Pipe Fitting Insulation	PF	Good					0
	Pipe Insulation	PI	Good					0
Men's Locker Room	Pipe Fitting Insulation	PF	Good	TESTED			0	
	Pipe Insulation	PI	Good	TESTED			0	
Corridor	Pipe Fitting Insulation	PF	Good					0
	Pipe Insulation	PI	Good					0
Engineers Office	Pipe Fitting Insulation	PF	Good	TESTED	88018	Jun/'10	0	
	Pipe Insulation	PI	Good					0
Filter Tank Area	Pipe Fitting Insulation (yellow)	PF	Good	TESTED	148171	Oct/'14	0	
	Pipe Fitting Insulation (white)	PF	Good	TESTED	148171	Oct/'14	0	
	Pipe Insulation	PI	Good					0
	Mastic - Duct (Brown/ Red)	MA	Good					1-10
Near Water Meter	Pipe Fitting Insulation	PF	Good	TESTED	88018	Jun/'10	0	
	Pipe Insulation	PI	Good	TESTED	88018	Jun/'10	0	
Work Area	Pipe Fitting Insulation	PF	Good					0
	Pipe Insulation	PI	Good					0
Boiler Area	Pipe Fitting Insulation	PF	Good	TESTED			0	
	Pipe Insulation	PI	Good	TESTED			0	
	Tank Insulation	TI	Good	TESTED			0	
Wall near Electrical panel	Cementious product - at wall calling it solid mastic (MA)	MA	Removed'18	TESTED	b173237	July'17	1-5	
Ductwork next to tunnel	Asbestos Fabric - Isolation Gasket	AF	Good					
Tunnel # 3	Pipe Fitting Insulation	PF	Good	TESTED			0	
	Black Mastic	MA		TESTED				

Material Location	Material Description	Drawing Label	Material Condition	Testing Status	Lab Report #	Date M/Y	Test %	Est. %
Tunnel # 2	Pipe Insulation	PI	Good	TESTED			0	
	Pipe Fitting Insulation	PF	Good					0
	Pipe Insulation	PI	Good					0
Tunnel # 1	Pipe Fitting Insulation	PF	Good					0
	Pipe Insulation	PI	Good					0
<b>West Tunnel Area</b>								
West Tunnel Area	Pipe Fitting Insulation	PF	Good	TESTED	102055	Jul/'11	0	
	Pipe Insulation	PI	Good					0
Glycol Pipes (Lines)	Pipe Elbow Insulation (3 Samples)	PF		TESTED	204239	Jun/'18	0	
	Pipe Insulation (2 Samples)	PI		TESTED	204239	Jun/'18	0	
	Pipe Gasket (Brown) (2 Samples)	GA	Good	TESTED	204302	Jun/'18	0	
	Pipe Gasket (Black) (1 Sample)	GA		TESTED	204302	Jun/'18	0	
	Pipe Gasket (at Valve) (Grey) (1 Sample)	GA	Removed'18	TESTED	204302	Jun/'18	65	
Air Handling Units	Duct Insulation - Mastic Only ( Interior )	MA	Removed'18	TESTED		Jul/'11	10	
	Mastic ( Interior on supply ductwork coating )	MA	Removed'18	TESTED	b190457	May'18	10-25	
<b>Exterior</b>								
South Columns	Parging (3 Samples Taken)	PA	Needs Repair	TESTED	242752	Sep/'20	0	
East Basement Stairs	Parging (Gray Stucco)	PA	Needs Repair	TESTED	242752	Sep/'20	0	

#### NOTES:

1. Asbestos inspections and inventory updates are conducted annually.
2. There may be asbestos containing materials present that were not located during asbestos inspections.
3. Floor tile and sheet flooring installed before 1990 may contain asbestos and must be treated as an asbestos containing material.
4. Vermiculite insulation may contain pockets of asbestos. All vermiculite insulation must be treated as an asbestos containing material.
5. For asbestos related inquiries, call Central Control at 986-2382

# PI-01

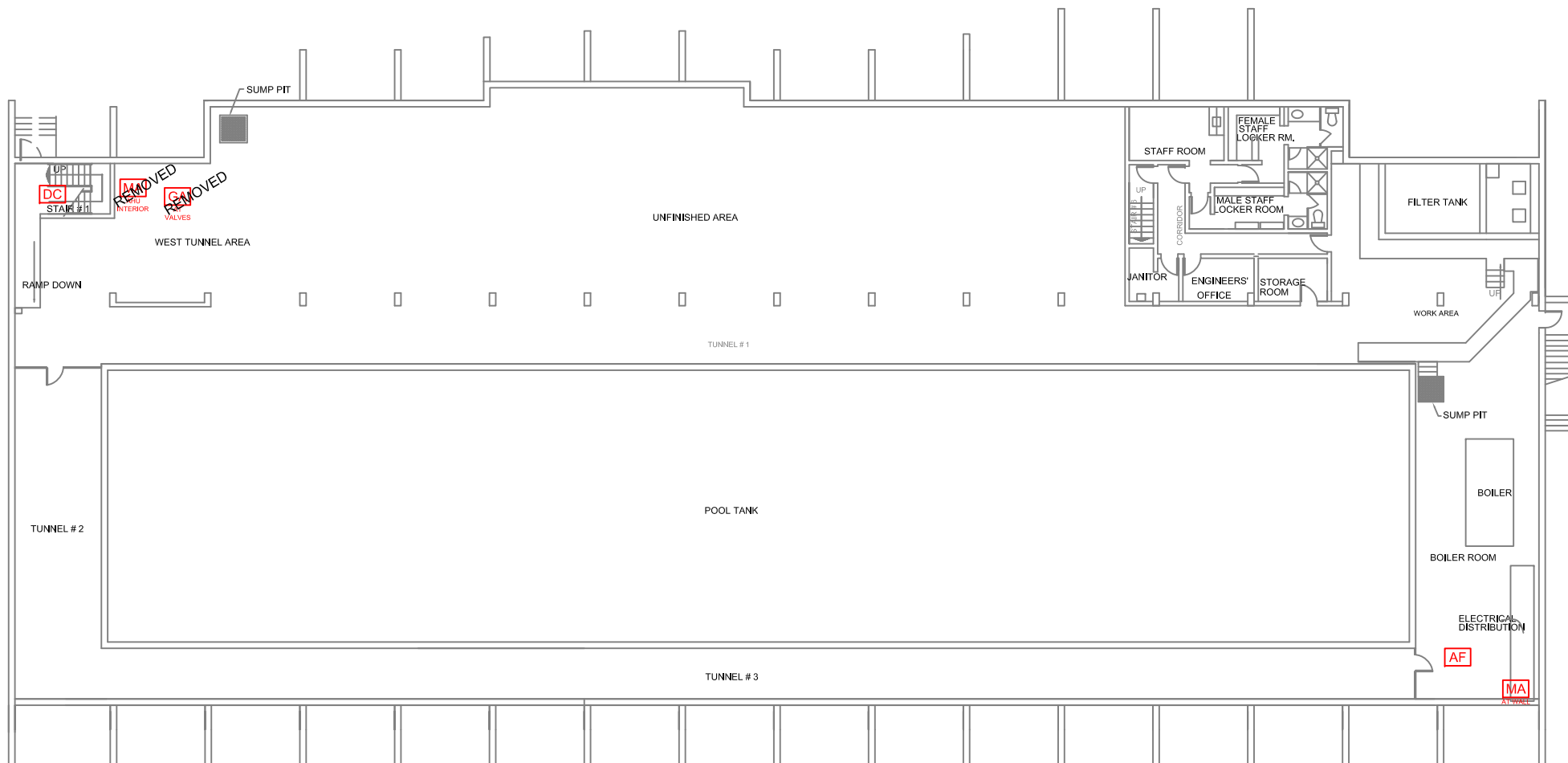

## BASEMENT

DRYWALL COMPOUND THROUGHOUT CONTAINS ASBESTOS



## LEGEND

GENERAL  
LABELS

ON  
CEILING

ABOVE  
CEILING

UNDER  
FLOORING

WALL  
DETAIL

ENCAPSULATED  
ASBESTOS

?? =



AF: ASBESTOS FABRIC  
BR: BOILER REFRACTORY  
CA: CAULKING  
C12: 12X12 CEILING TILE  
C24: 24X24 CEILING TILE  
C48: 24X48 CEILING TILE  
DC: DRYWALL COMPOUND  
DI: DUCT INSULATION  
FS: SHEET FLOORING

F9: 9X9 FLOOR TILE  
F12: 12X12 FLOOR TILE  
HB: HARDBOARD  
MA: MASTIC  
PF: PIPE FITTING INSULATION  
PI: PIPE INSULATION  
PL: PLASTER  
RD: ROOF DRAIN  
SC: STIPPLE CEILING

SO: SPRAY ON  
ST: STUCCO  
TI: TANK INSULATION  
TP: TRANSITE PIPE  
VE: VERMICULITE

## NOTES:

1. THERE MAY BE ASBESTOS CONTAINING MATERIALS PRESENT THAT WERE NOT LOCATED DURING BUILDING INSPECTIONS
2. REFER TO THE ASBESTOS INVENTORY SURVEY SHEET FOR MORE INFORMATION
3. DO NOT DISTURB ASBESTOS. FOR HANDLING PROCEDURES CALL CENTRAL CONTROL AT 986-2382

## ASBESTOS LOCATIONS

BUILDING: PI-01  
SEVEN OAKS INDOOR POOL & BUILDING  
444 ADSUM DRIVE  
WINNIPEG, MANITOBA

REVISED BY:  
AB

DATE:  
JUNE 2018

SCALE:  
N.T.S.

SHEET #:  
1/3



*Embrace the Spirit - Vivez l'esprit*

## CITY OF WINNIPEG

ASSETS & PROJECT MANAGEMENT  
DEPARTMENT  
MUNICIPAL ACCOMMODATIONS DIVISION  
4th FLOOR - 185 KING STREET  
WINNIPEG, MANITOBA R3B 1J1  
PHONE: (204) 986-7266  
FAX: (204) 986-7311

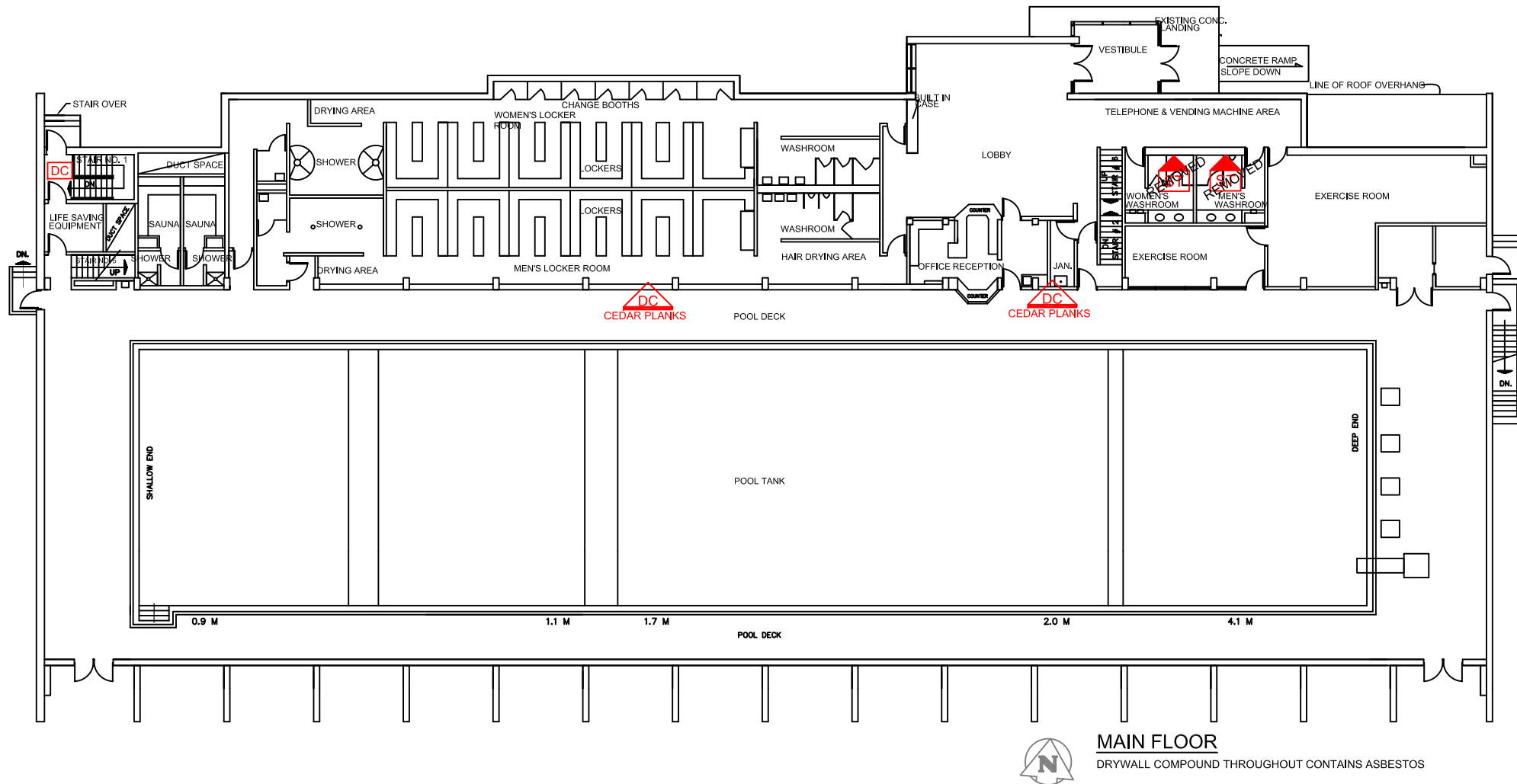

## LEGEND

GENERAL LABELS

ON CEILING

ABOVE CEILING

UNDER FLOORING

WALL DETAIL

ENCAPSULATED ASBESTOS

?? =

??

??

??

??

??

??

AF: ASBESTOS FABRIC  
BR: BOILER REFRACTORY  
CA: CAULKING  
C12: 12X12 CEILING TILE  
C24: 24X24 CEILING TILE  
C48: 24X48 CEILING TILE  
DC: DRYWALL COMPOUND  
DI: DUCT INSULATION  
FS: SHEET FLOORING

F9: 9X9 FLOOR TILE  
F12: 12X12 FLOOR TILE  
HB: HARDBOARD  
MA: MASTIC  
PF: PIPE FITTING INSULATION  
PI: PIPE INSULATION  
PL: PLASTER  
RD: ROOF DRAIN  
SC: STIPPLE CEILING

SO: SPRAY ON  
ST: STUCCO  
TI: TANK INSULATION  
TP: TRANSITE PIPE  
VE: VERMICULITE

## NOTES:

1. THERE MAY BE ASBESTOS CONTAINING MATERIALS PRESENT THAT WERE NOT LOCATED DURING BUILDING INSPECTIONS
2. REFER TO THE ASBESTOS INVENTORY SURVEY SHEET FOR MORE INFORMATION
3. DO NOT DISTURB ASBESTOS. FOR HANDLING PROCEDURES CALL CENTRAL CONTROL AT 986-2382

## ASBESTOS LOCATIONS

BUILDING: PI-01  
SEVEN OAKS INDOOR POOL & BUILDING  
444 ADSUM DRIVE  
WINNIPEG, MANITOBA

REVISED BY:  
A.B.

DATE:  
JUNE 2018

SCALE:  
N.T.S.

SHEET #:  
2/3



## CITY OF WINNIPEG

ASSETS & PROJECT MANAGEMENT  
DEPARTMENT  
MUNICIPAL ACCOMMODATIONS DIVISION  
4th FLOOR - 185 KING STREET  
WINNIPEG, MANITOBA R3B 1J1  
PHONE: (204) 986-7266  
FAX: (204) 986-7311

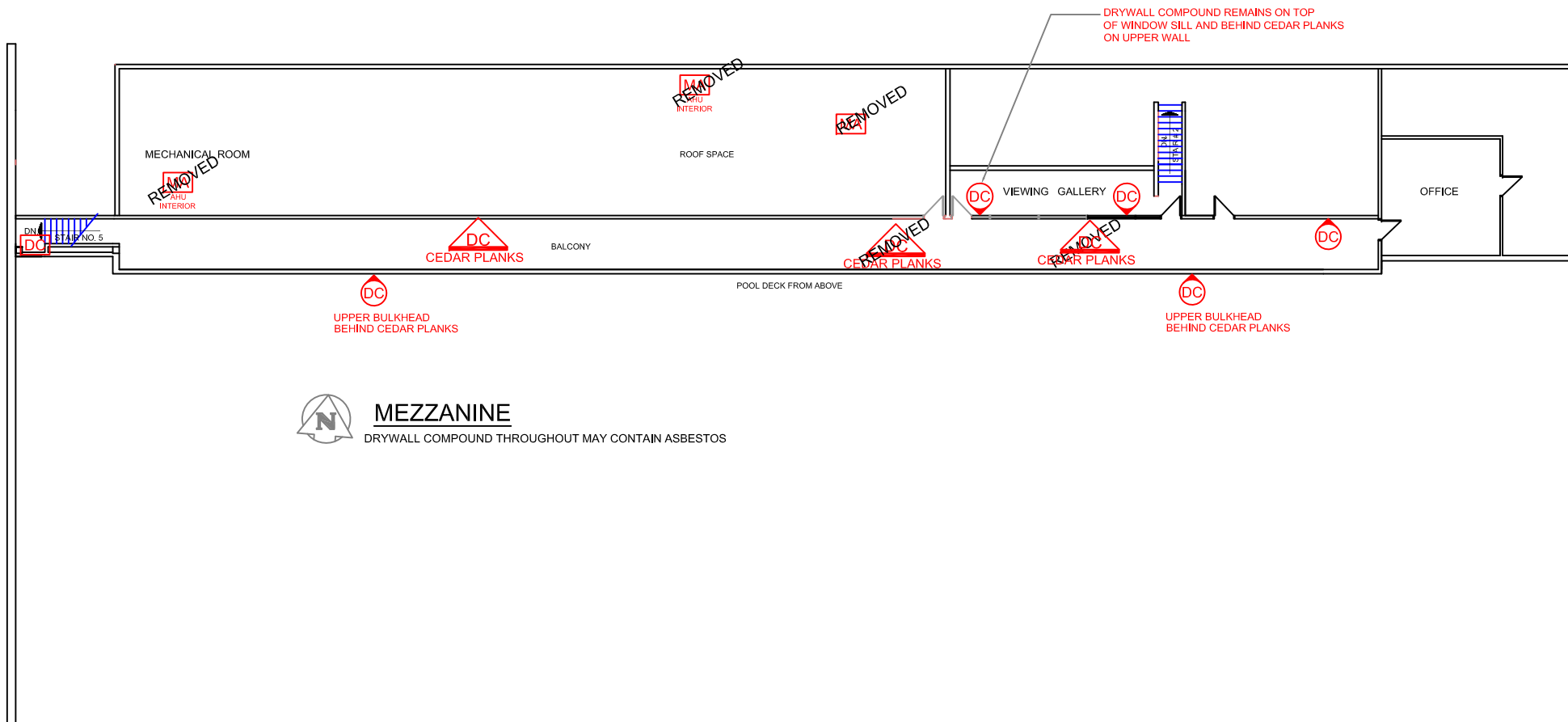

## LEGEND

GENERAL LABELS

ON CEILING

ABOVE CEILING

UNDER FLOORING

WALL DETAIL

ENCAPSULATED ASBESTOS

?? =

??

??

??

??

??

??

AF: ASBESTOS FABRIC  
BR: BOILER REFRACTORY  
CA: CAULKING  
C12: 12X12 CEILING TILE  
C24: 24X24 CEILING TILE  
C48: 24X48 CEILING TILE  
DC: DRYWALL COMPOUND  
DI: DUCT INSULATION  
FS: SHEET FLOORING

F9: 9X9 FLOOR TILE  
F12: 12X12 FLOOR TILE  
HB: HARDBOARD  
MA: MASTIC  
PF: PIPE FITTING INSULATION  
PI: PIPE INSULATION  
PL: PLASTER  
RD: ROOF DRAIN  
SC: STIPPLE CEILING

SO: SPRAY ON  
ST: STUCCO  
TI: TANK INSULATION  
TP: TRANSITE PIPE  
VE: VERMICULITE

## NOTES:

1. THERE MAY BE ASBESTOS CONTAINING MATERIALS PRESENT THAT WERE NOT LOCATED DURING BUILDING INSPECTIONS
2. REFER TO THE ASBESTOS INVENTORY SURVEY SHEET FOR MORE INFORMATION
3. DO NOT DISTURB ASBESTOS. FOR HANDLING PROCEDURES CALL CENTRAL CONTROL AT 986-2382

## ASBESTOS LOCATIONS

BUILDING: PI-01  
SEVEN OAKS INDOOR POOL & BUILDING  
444 ADSUM DRIVE  
WINNIPEG, MANITOBA

REVISED BY:  
A.B.

DATE:  
JUNE 2018

SCALE:  
N.T.S.

SHEET #:  
3/3



*Embrace the Spirit • Vivez l'esprit*

## CITY OF WINNIPEG

ASSETS & PROJECT MANAGEMENT  
DEPARTMENT  
MUNICIPAL ACCOMMODATIONS DIVISION  
4th FLOOR - 185 KING STREET  
WINNIPEG, MANITOBA R3B 1J1  
PHONE: (204) 986-7266  
FAX: (204) 986-7311