

CONSTRUCTION NOTES:

- ISOLATE MISCELLANEOUS ITEMS IN NEW CONCRETE WORKS AS PER SD-228C.
- ALL WORK AND MATERIALS TO BE IN ACCORDANCE WITH LATEST REVISION OF THE CITY OF WINNIPEG STANDARD CONSTRUCTION SPECIFICATIONS.
- LEGAL PLAN AND UNDERGROUND INFORMATION FROM CITY OF WINNIPEG LBIS. CONTRACTOR TO VERIFY ALL UNDERGROUNDS IN THE FIELD.
- CONTRACTOR TO TAKE PRECAUTIONARY STEPS TO AVOID DAMAGE FROM CONSTRUCTION ACTIVITIES TO TREES WITHIN THE LIMITS OF CONSTRUCTION.
- LOCATION OF EXISTING UTILITIES/SERVICES TO BE CONFIRMED IN THE FIELD BY THE CONTRACTOR.
- INSTALL CB LEADS AT MIN. 1.0% SLOPE OR AS DIRECTED BY THE CONTRACT ADMINISTRATOR.
- CONTRACTOR TO CONFIRM EXISTING LEAD INVERT ELEVATIONS PRIOR TO INSTALLATION.
- ALL DIMENSIONS ARE TO BACK OF CURB.
- LIMITS OF CURB AND SIDEWALK RECONSTRUCTION TO BE FINALIZED IN THE FIELD BY THE CONTRACT ADMINISTRATOR.
- ADJUST ALL WATER VALVES, MANHOLES, CATCH BASINS, CATCH PITS AND WATER SHUT OFF VALVES TO GRADE.
- ALL PRIVATE WALKWAYS TO BE ADJUSTED TO NEW SIDEWALK OR TOP OF CURB ELEVATION, AS REQUIRED.
- STREET LIGHT STANDARDS, HYDRO POLES AND ANCHORS THAT REQUIRE TEMPORARY SUPPORT, REMOVAL OR REPLACEMENT, ARE TO BE DONE AT THE EXPENSE OF THE CONTRACTOR, AS NECESSARY.
- FOR ROAD RECONSTRUCTIONS, INSTALL 6 m OF 150 mm SUBDRAIN TO CATCH BASINS IN BOTH DIRECTIONS PARALLEL TO ROADWAY AS PER SD-245 AND CAP ENDS.
- FOR ROAD RECONSTRUCTIONS, ALL WATER MAINS AND SERVICES NEED TO BE INSULATED, ADDITIONALLY, ALL CATCH BASINS, MANHOLES AND LEAD PIPES LOCATED WITHIN 2.0 m OF A RESIDENTIAL SERVICE MUST BE INSULATED TO PROTECT THE SERVICE FROM POTENTIAL FUTURE FREEZING.
- FOR ROAD RECONSTRUCTIONS, CURB REVEAL SHALL BE 180 mm UNLESS NOTED OTHERWISE. FOR ROAD REHABILITATIONS, CURB REVEAL SHALL BE 150 mm UNLESS NOTED OTHERWISE.

CURB LEGEND

- BARRIER CURB FOR ASPHALT PAVEMENT (SD-200A)
- BARRIER CURB FOR CONC. PAVEMENT (SD-205)
- MODIFIED BARRIER CURB FOR ASPHALT PAVEMENT (SD-200B)
- MODIFIED BARRIER CURB FOR CONC. PAVEMENT (SD-203B)
- MODIFIED LIP CURB (SD-202C)
- CURB RAMP FOR ASPHALT PAVEMENT (SD-200D)
- REMOVALS / RELOCATES
- REMOVALS / RELOCATES (BY OTHERS)
- ADJUSTMENTS
- ADJUSTMENTS (BY OTHERS)

ABBREVIATIONS:

- CONC CONCRETE
- ASP ASPHALT
- TYP TYPICAL
- EX EXISTING
- MH MANHOLE
- WV WATER VALVE
- EL ELEVATION
- CB CATCH BASIN
- CP CATCH PIT
- CI CURB INLET
- CL CONTROL LINE
- SL STREET LIGHT
- TS TRAFFIC SIGNAL

SYMBOLS:

- HYDRO MANHOLE
- TELEPHONE MANHOLE
- TRAFFIC SIGNAL SPLICE PIT
- WATER VALVE
- HYDRANT
- CURB STOP
- GAS VALVE
- HYDRO POLE
- HYDRO POLE WITH LIGHT
- STREET LIGHT
- TRAFFIC SIGNAL
- SIGNAL CONTROL BOX
- BELLMITS PEDESTAL
- TREE
- IRON PROPERTY BAR
- HYDRO GUY ANCHOR

METRIC

WHOLE NUMBERS INDICATE MILLIMETRES
DECIMALIZED NUMBERS INDICATE METRES

WARNING

IF POWER EQUIPMENT OR EXPLOSIVES ARE TO BE USED FOR EXCAVATION ON THIS PROJECT THE CONTRACTOR MUST:

- NOTIFY THE GAS COMPANY OF THE PROPOSED LOCATION OF EXCAVATION.
- TAKE PRECAUTION TO AVOID DAMAGE TO GAS COMPANY INSTALLATIONS SEE PROVINCIAL REGULATION 210/72 FOR DETAILS.
- OBTAIN EXCAVATION PERMITS PRIOR TO CONSTRUCTION.

**PRELIMINARY ONLY
NOT FOR CONSTRUCTION**

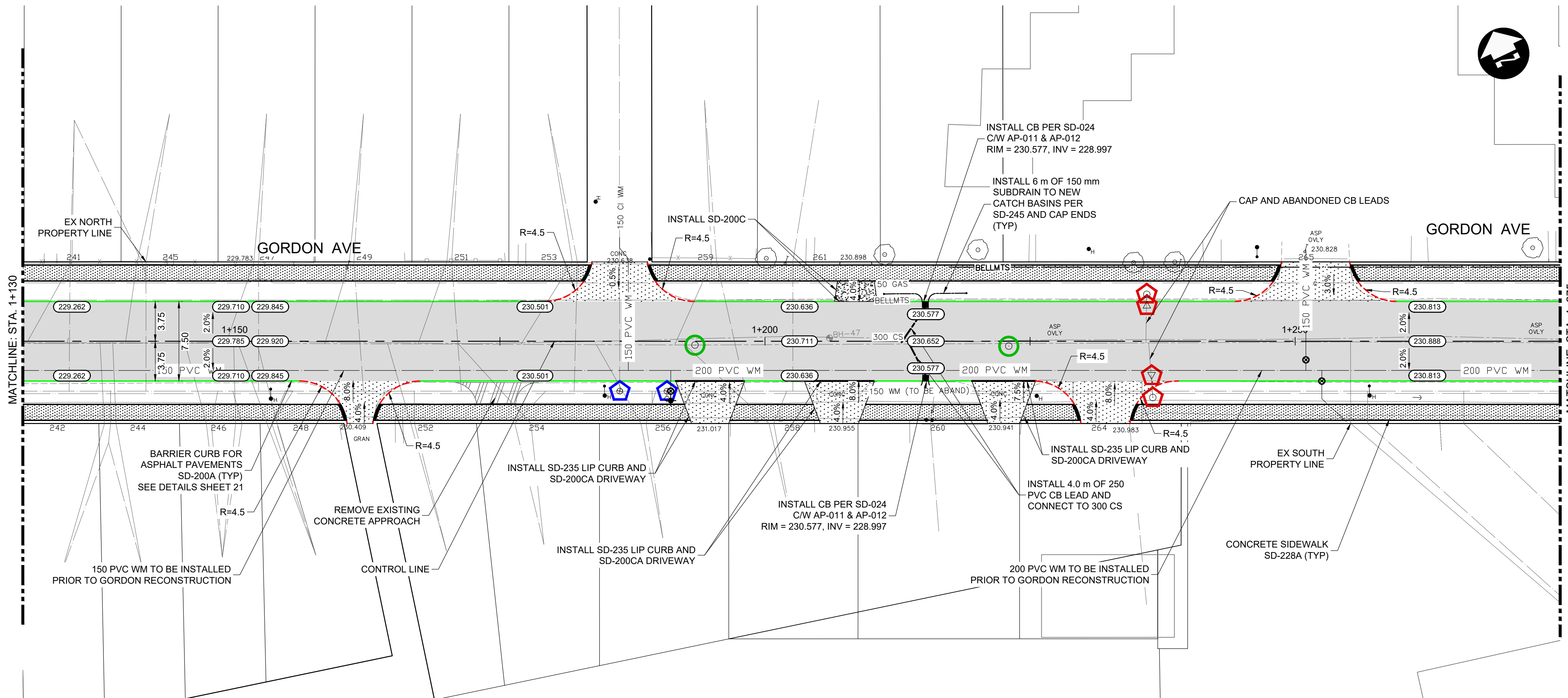

C:\w\working_directory\projects_2023\dillon_40pmw\dms6376\237231-GOR-CT-CON-PP.dwg

EXISTING	LEGEND-PLAN	PROPOSED	EXISTING	LEGEND-PLAN	PROPOSED	EXISTING	LEGEND-PROFILE	PROPOSED
150 WM	WATERMAIN	150 WM	CONCRETE ROAD		CONCRETE ROAD			CONCRETE ROAD
300 LDS	LAND DRAINAGE SEWER	300 LDS	ASPHALT ROAD		ASPHALT ROAD			ASPHALT ROAD
250 WWS	WASTE WATER SEWER	250 WWS	CONC ROAD W/ASP OVERLAY		CONC ROAD W/ASP OVERLAY			CONC ROAD W/ASP OVERLAY
HYDRO	HYDRO	HYDRO	CONCRETE SIDEWALK		CONCRETE SIDEWALK			CONCRETE SIDEWALK
BELLMITS	BELLMITS	BELLMITS	ASPHALT PATH		ASPHALT PATH			ASPHALT PATH
100 GAS	GAS	100 GAS	REMOVALS		REMOVALS			REMOVALS
T.S.	TRAFFIC SIGNALS	T.S.	PAVEMENT REPAIR FABRIC		PAVEMENT REPAIR FABRIC			PAVEMENT REPAIR FABRIC
S.L.	STREET LIGHTS	S.L.	ELEVATION		ELEVATION			ELEVATION
○	MANHOLE	○	PROPERTY LINE		PROPERTY LINE			PROPERTY LINE
□	CATCH BASIN	□	CURB RAMP		CURB RAMP			CURB RAMP
▽	CATCH PIT	▽	DETECTABLE TILE		DETECTABLE TILE			DETECTABLE TILE

UNDERGROUND STRUCTURES	
SUPV. U/G STRUCTURES	DATE

B.M. ELEV.	DESIGNED BY	PMW

DRAWN BY	DC/LK

CHECKED BY	AJF

APPROVED BY	DBW

HOR. SCALE	1:250

VERTICAL	1:10

ISSUED FOR TENDER	24-06-13	DBW

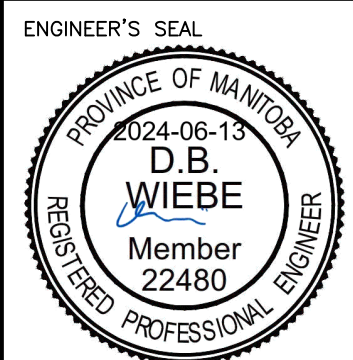

2024 LOCAL STREETS RENEWALS 24-R-02 CONTRACT 1 (180-2024)		CITY DRAWING NUMBER

GORDON AVE - STADACONA ST-BRAZIER ST PLAN (STA. 1+110 TO STA. 1+275)	CONSULTANT DRAWING NUMBER