

- CONSTRUCTION NOTES:**
- ISOLATE MISCELLANEOUS ITEMS IN NEW CONCRETE WORKS AS PER SD-228C.
  - ALL WORK AND MATERIALS TO BE IN ACCORDANCE WITH LATEST REVISION OF THE CITY OF WINNIPEG STANDARD CONSTRUCTION SPECIFICATIONS.
  - LEGAL PLAN AND UNDERGROUND INFORMATION FROM CITY OF WINNIPEG LBIS. CONTRACTOR TO VERIFY ALL UNDERGROUNDS IN THE FIELD.
  - CONTRACTOR TO TAKE PRECAUTIONARY STEPS TO AVOID DAMAGE FROM CONSTRUCTION ACTIVITIES TO TREES WITHIN THE LIMITS OF CONSTRUCTION.
  - LOCATION OF EXISTING UTILITIES/SERVICES TO BE CONFIRMED IN THE FIELD BY THE CONTRACTOR.
  - INSTALL CB LEADS AT MIN. 1.0% SLOPE OR AS DIRECTED BY THE CONTRACT ADMINISTRATOR.
  - CONTRACTOR TO CONFIRM EXISTING LEAD INVERT ELEVATIONS PRIOR TO INSTALLATION.
  - ALL DIMENSIONS ARE TO BACK OF CURB.
  - LIMITS OF CURB AND SIDEWALK RECONSTRUCTION TO BE FINALIZED IN THE FIELD BY THE CONTRACT ADMINISTRATOR.
  - ADJUST ALL WATER VALVES, MANHOLES, CATCH BASINS, CATCH PITS AND WATER SHUT OFF VALVES TO GRADE.
  - ALL PRIVATE WALKWAYS TO BE ADJUSTED TO NEW SIDEWALK OR TOP OF CURB ELEVATION, AS REQUIRED.
  - STREET LIGHT STANDARDS, HYDRO POLES AND ANCHORS THAT REQUIRE TEMPORARY SUPPORT, REMOVAL OR REPLACEMENT, ARE TO BE DONE AT THE EXPENSE OF THE CONTRACTOR, AS NECESSARY.
  - FOR ROAD RECONSTRUCTIONS, INSTALL 6 m OF 150 mm SUBDRAIN TO CATCH BASINS IN BOTH DIRECTIONS PARALLEL TO ROADWAY AS PER SD-245 AND CAP ENDS.
  - FOR ROAD RECONSTRUCTIONS, ALL WATER MAINS AND SERVICES NEED TO BE INSULATED, ADDITIONALLY, ALL CATCH BASINS, MANHOLES AND LEAD PIPES LOCATED WITHIN 2.0 m OF A RESIDENTIAL SERVICE MUST BE INSULATED TO PROTECT THE SERVICE FROM POTENTIAL FUTURE FREEZING.
  - FOR ROAD RECONSTRUCTIONS, CURB REVEAL SHALL BE 180 mm UNLESS NOTED OTHERWISE. FOR ROAD REHABILITATIONS, CURB REVEAL SHALL BE 150 mm UNLESS NOTED OTHERWISE.
- CURB LEGEND**
- BARRIER CURB FOR ASPHALT PAVEMENT (SD-200A)
  - BARRIER CURB FOR CONC. PAVEMENT (SD-205)
  - MODIFIED BARRIER CURB FOR ASPHALT PAVEMENT (SD-200B)
  - MODIFIED BARRIER CURB FOR CON. PAVEMENT (SD-203B)
  - MODIFIED LIP CURB (SD-202C)
  - CURB RAMP FOR ASPHALT PAVEMENT (SD-200D)
- REMOVALS / RELOCATES
- REMOVALS / RELOCATES (BY OTHERS)
- ADJUSTMENTS
- ADJUSTMENTS (BY OTHERS)

- ABBREVIATIONS:**
- |      |                |
|------|----------------|
| CONC | CONCRETE       |
| ASP  | ASPHALT        |
| TYP  | TYPICAL        |
| EX   | EXISTING       |
| MH   | MANHOLE        |
| WV   | WATER VALVE    |
| EL   | ELEVATION      |
| CB   | CATCH BASIN    |
| CP   | CATCH PIT      |
| CI   | CURB INLET     |
| CL   | CONTROL LINE   |
| SL   | STREET LIGHT   |
| TS   | TRAFFIC SIGNAL |
- SYMBOLS:**
- |   |                           |
|---|---------------------------|
| ○ | HYDRO MANHOLE             |
| ○ | TELEPHONE MANHOLE         |
| ○ | TRAFFIC SIGNAL SPLICE PIT |
| ○ | WATER VALVE               |
| ○ | HYDRANT                   |
| ○ | CURB STOP                 |
| ○ | GAS VALVE                 |
| ○ | CATCH PIT                 |
| ○ | HYDRO POLE                |
| ○ | HYDRO POLE WITH LIGHT     |
| ○ | STREET LIGHT              |
| ○ | TRAFFIC SIGNAL            |
| ○ | SIGNAL CONTROL BOX        |
| ○ | BELLMITS PEDESTAL         |
| ○ | TREE                      |
| ○ | IRON PROPERTY BAR         |
| ○ | HYDRO GUY ANCHOR          |

- METRIC**
- WHOLE NUMBERS INDICATE MILLIMETRES  
DECIMALIZED NUMBERS INDICATE METRES
- WARNING**
- IF POWER EQUIPMENT OR EXPLOSIVES ARE TO BE USED FOR EXCAVATION ON THIS PROJECT THE CONTRACTOR MUST:
- NOTIFY THE GAS COMPANY OF THE PROPOSED LOCATION OF EXCAVATION.
  - TAKE PRECAUTION TO AVOID DAMAGE TO GAS COMPANY INSTALLATIONS SEE PROVINCIAL REGULATION 210/72 FOR DETAILS.
  - OBTAIN EXCAVATION PERMITS PRIOR TO CONSTRUCTION.

**PRELIMINARY ONLY  
NOT FOR CONSTRUCTION**

C:\w\working\_directory\projects\_2023\dillon\_40pmw\dms6376\237231-MCA-CT-CON-PP.dwg

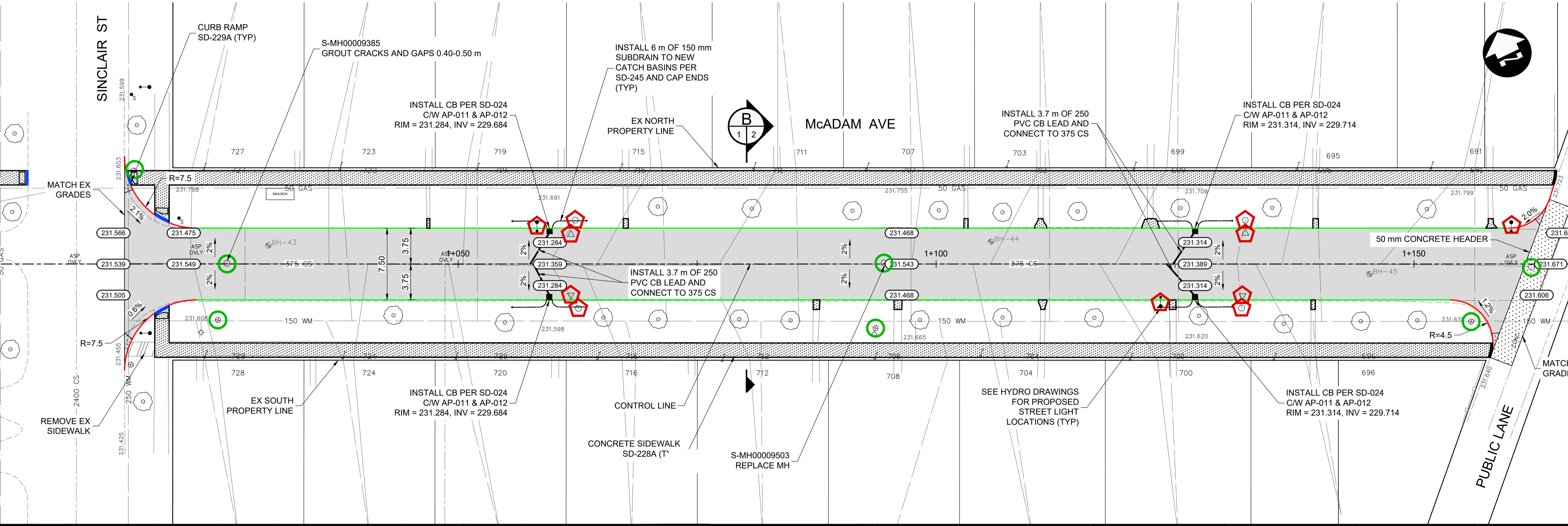

|          |                     |          |                         |                        |                       |   |                |             |            |                 |      |                           |      |  |  |   |             |     |
|----------|---------------------|----------|-------------------------|------------------------|-----------------------|---|----------------|-------------|------------|-----------------|------|---------------------------|------|--|--|---|-------------|-----|
| 150 WM   | WATERMAIN           | 150 WM   | CONCRETE ROAD           | C PROFILE              | NORTH/WEST GUTTER     | UNDERGROUND STRUCTURES  | B.M. ELEV.     | DESIGNED BY | PMW        | ENGINEER'S SEAL |      |                           |      | <b>THE CITY OF WINNIPEG</b><br>PUBLIC WORKS DEPARTMENT | 2024 LOCAL STREETS RENEWALS 24-R-02<br>CONTRACT 2 (181-2024) | CITY DRAWING NUMBER<br>SHEET <b>06</b> OF <b>18</b> |             |     |
| 300 LDS  | LAND DRAINAGE SEWER | 300 LDS  | ASPHALT ROAD            | SOUTH/EAST GUTTER      | SUPPLY U/G STRUCTURES | DATE  | DRAWN BY       | DC          | CHECKED BY | AJF             |      |                           |      |  |  |   | APPROVED BY | DBW |
| 250 WWS  | WASTE WATER SEWER   | 250 WWS  | CONC ROAD W/ASP OVERLAY | NORTH/WEST MED. GUTTER |                       | LOCATION OF UNDERGROUND STRUCTURES AS SHOWN ARE BASED ON THE BEST INFORMATION AVAILABLE BUT NO GUARANTEE IS GIVEN THAT ALL EXISTING UTILITIES ARE SHOWN OR THAT THE GIVEN LOCATIONS ARE EXACT. CONFIRMATION OF EXISTENCE AND EXACT LOCATION OF ALL SERVICES MUST BE OBTAINED FROM THE INDIVIDUAL UTILITIES BEFORE PROCEEDING WITH CONSTRUCTION. |                | HOR. SCALE  | 1:250      | VERTICAL        | 1:10 | RELEASED FOR CONSTRUCTION | DATE |  |  |   |             |     |
| HYDRO    | HYDRO               | HYDRO    | CONCRETE SIDEWALK       | SOUTH/EAST MED. GUTTER |                       |   |                |             |            |                 |      |                           |      |  |  |   |             |     |
| BELLMITS | BELLMITS            | BELLMITS | ASPHALT PATH            | NORTH/WEST DITCH       |                       |   |                |             |            |                 |      |                           |      |  |  |   |             |     |
| 100 GAS  | GAS                 | 100 GAS  | REMOVALS                | SOUTH/EAST DITCH       |                       |   |                |             |            |                 |      |                           |      |  |  |   |             |     |
| T.S.     | TRAFFIC SIGNALS     | T.S.     | PAVEMENT REPAIR FABRIC  | NORTH/WEST SIDEWALK    |                       |   |                |             |            |                 |      |                           |      |  |  |   |             |     |
| S.L.     | STREET LIGHTS       | S.L.     | ELEVATION               | SOUTH/EAST SIDEWALK    |                       |   |                |             |            |                 |      |                           |      |  |  |   |             |     |
| ○        | MANHOLE             | ○        | PROPERTY LINE           |                        |                       |   |                |             |            |                 |      |                           |      |  |  |   |             |     |
| ○        | CATCH BASIN         | ○        | CURB RAMP               |                        |                       |   |                |             |            |                 |      |                           |      |  |  |   |             |     |
| ○        | CATCH PIT           | ○        | DETECTABLE TILE         |                        |                       |   |                |             |            |                 |      |                           |      |  |  |   |             |     |
| EXISTING | LEGEND-PLAN         | PROPOSED | EXISTING                | LEGEND-PLAN            | PROPOSED              | EXISTING  | LEGEND-PROFILE | PROPOSED    |            |                 |      |                           |      |  |  |   |             |     |