

NOTES :

- CONSTRUCTION STANDARDS
- TO BE CONSTRUCTED IN ACCORDANCE WITH MANITOBA HYDRO DISTRIBUTION AND SUBTRANSMISSION STANDARDS, LATEST EDITION.
- NO MAJOR CHANGE SHALL BE MADE WITHOUT APPROVAL OF THE DESIGN ENGINEER OR DELEGATE.
- INSTALL NEW STREET LIGHTS AND CABLE ON ALIGNMENT AS SHOWN.**
- INSTALL NEW GROUND RODS AS PER CD 50-5**
- ALL STREET LIGHT CABLE TO BE INSTALLED IN 2" CONDUIT**
- UPON DISCONNECTION BY MB HYDRO THE CONTRACTOR SHALL INSTALL TEMPORARY #6 OVERHEAD FEED IN ORDER TO MAINTAIN LIGHTING DURING CONSTRUCTION. AT THE END OF CONSTRUCTION TEMPORARY OVERHEAD SHALL BE DISCONNECTED BY THE CONTRACTOR.**
- U/G SL CABLE TO BE MINIMUM 1.0m AWAY FROM ALL OTHER UTILITIES UNLESS OTHERWISE NOTED**
- MB HYDRO SHALL CUT, CAP AND ABANDON ORIGINAL FEED TO THE STREET LIGHTS PRIOR TO REMOVAL, ALL FINAL CONNECTIONS WILL BE COMPLETED BY MB HYDRO.**

CONTACT	NAME	PHONE NUMBER	E-MAIL ADDRESS
DESIGN	DAVID BSBACHUK	204-369-7811	DSBACHUK@HYDRO.MB.CA
DESIGN ENGINEER	KEVIN VANDENBERGH	431-334-9777	KVANDENBERGH@HYDRO.MB.CA
PORTFOLIO PM	DAIRN WACH	204-481-2811	DWACH@HYDRO.MB.CA
PROPERTY REPRESENTATIVE	RYAN AUBRY	204-369-7821	RAUBRY@HYDRO.MB.CA
U/G CONSTRUCTION	JEFF BREAKLEY	204-471-2202	JBREAKLEY@HYDRO.MB.CA
OH CONSTRUCTION	BRYAN SANDSTER	204-481-4401	BSANDSTER@HYDRO.MB.CA
HYDRO GAS			
SHAW/ROGERS			
BELLMTS			
DISTRICT REPRESENTATIVE			
DISTRICT ENG TECH	PHILIP BRUCE	204-369-3074	PBRUCE@HYDRO.MB.CA

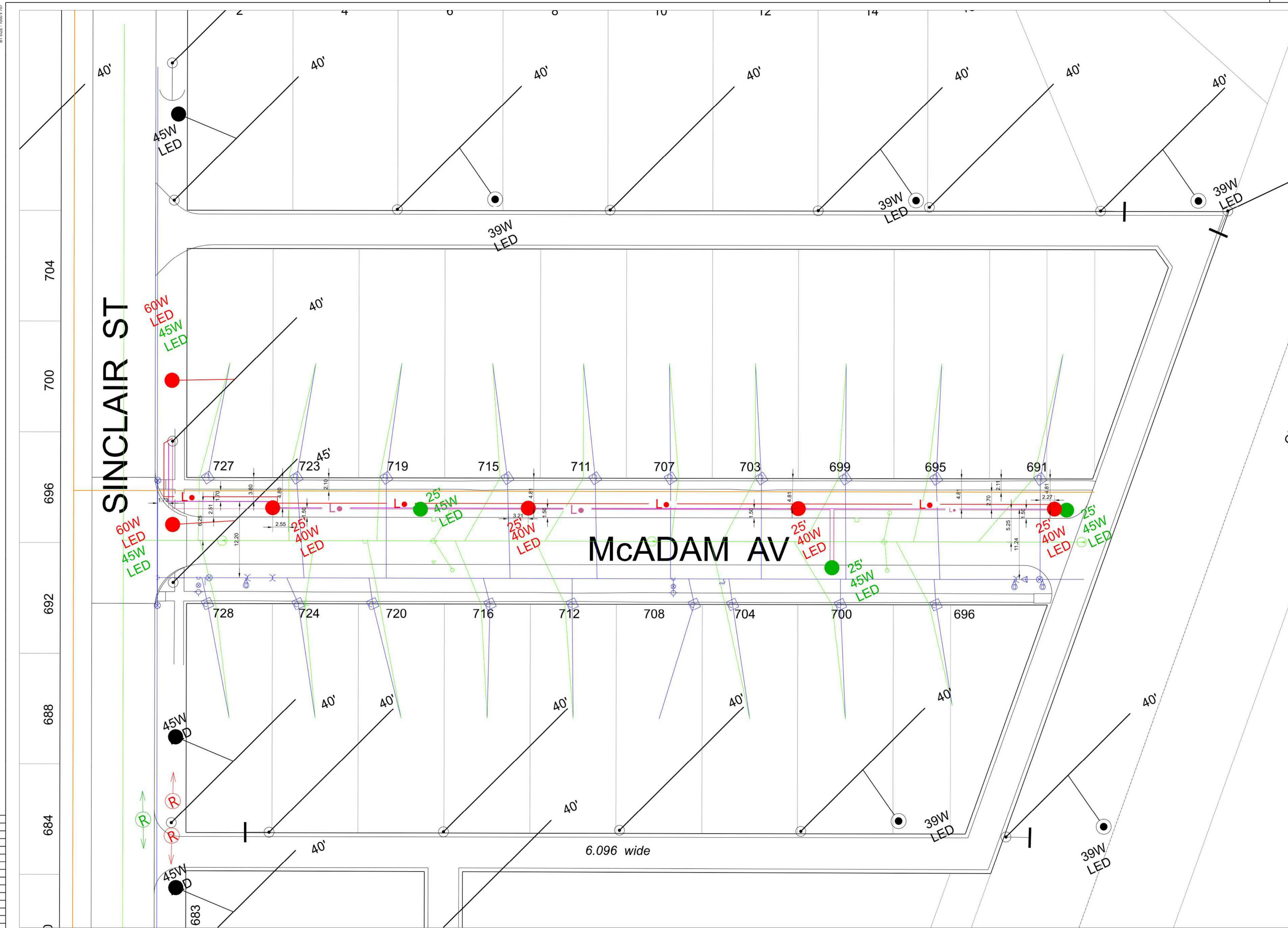

CONTACT "CLICK BEFORE YOU DIG MANITOBA" AT ClickBeforeYouDigMB.com
THREE FULL WORKING DAYS
 PRIOR TO CONSTRUCTION FOR LOCATION OF WATER, WASTEWATER, LAND DRAINAGE UTILITIES AND MANITOBA HYDRO UTILITIES

PRELIMINARY NOT TO BE USED FOR CONSTRUCTION

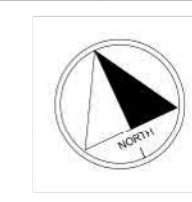

NO.	DATE	REVISIONS	BY	CHKD.	APP.

DRAWING NUMBER	REFERENCE DRAWINGS	DRAW	D.R.
CHECK	SCALE	DATE	2024 05 30
SCALE	1:250		

AREA	5101	MANITOBA HYDRO
STATION NUMBER	N/A	WOW P-40061 NETWORK # 4308467
FEEDER NUMBER	N/A	CSC: CITY CENTRE
		COW - MCADAM (SINCLAIR TO ARLINGTON)
		CUSTOMER SERVICE PROJECT
		SALVAGE 3-25' STREET LIGHTS AND INSTALL 4-25' STREET LIGHTS
SYSTEM VOLTAGE	120 V	