

- CONSTRUCTION NOTES:**
- ISOLATE MISCELLANEOUS ITEMS IN NEW CONCRETE WORKS AS PER SD-228C.
 - ALL WORK AND MATERIALS TO BE IN ACCORDANCE WITH LATEST REVISION OF THE CITY OF WINNIPEG STANDARD CONSTRUCTION SPECIFICATIONS.
 - LEGAL PLAN AND UNDERGROUND INFORMATION FROM CITY OF WINNIPEG LBIS. CONTRACTOR TO VERIFY ALL UNDERGROUNDS IN THE FIELD.
 - CONTRACTOR TO TAKE PRECAUTIONARY STEPS TO AVOID DAMAGE FROM CONSTRUCTION ACTIVITIES TO TREES WITHIN THE LIMITS OF CONSTRUCTION.
 - LOCATION OF EXISTING SLOPE TO BE CONFIRMED IN THE FIELD BY THE CONTRACTOR.
 - INSTALL CB LEADS AT MIN. 1.0% SLOPE OR AS DIRECTED BY THE CONTRACT ADMINISTRATOR.
 - CONTRACTOR TO CONFIRM EXISTING LEAD INVERT ELEVATIONS PRIOR TO INSTALLATION.
 - ALL DIMENSIONS ARE TO BACK OF CURB.
 - LIMITS OF CURB AND SIDEWALK RECONSTRUCTION TO BE FINALIZED IN THE FIELD BY THE CONTRACT ADMINISTRATOR.
 - ADJUST ALL WATER VALVES, MANHOLES, CATCH BASINS, CATCH PITS AND WATER SHUT OFF VALVES TO GRADE.
 - ALL PRIVATE WALKWAYS TO BE ADJUSTED TO NEW SIDEWALK OR TOP OF CURB ELEVATION, AS REQUIRED.
 - STREET LIGHT STANDARDS, HYDRO POLES AND ANCHORS THAT REQUIRE TEMPORARY SUPPORT, REMOVAL OR REPLACEMENT, ARE TO BE DONE AT THE EXPENSE OF THE CONTRACTOR, AS NECESSARY.
 - FOR ROAD RECONSTRUCTIONS, INSTALL 6 m OF 150 mm SUBDRAIN TO CATCH BASINS IN BOTH DIRECTIONS PARALLEL TO ROADWAY AS PER SD-245 AND CAP ENDS.
 - FOR ROAD RECONSTRUCTIONS, ALL WATER MAIN SERVICES NEED TO BE INSULATED. ADDITIONALLY, ALL CATCH BASINS, MANHOLES AND LEAD PIPES LOCATED WITHIN 2.0 m OF A RESIDENTIAL SERVICE MUST BE INSULATED TO PROTECT THE SERVICE FROM POTENTIAL FUTURE FREEZING.
 - FOR ROAD RECONSTRUCTIONS, CURB REVEAL SHALL BE 180 mm UNLESS NOTED OTHERWISE. FOR ROAD REHABILITATIONS, CURB REVEAL SHALL BE 150 mm UNLESS NOTED OTHERWISE.
 - CONSTRUCT MODIFIED BARRIER CURB (SD-203B) AT RADII.
- REMOVALS / RELOCATES** (Red pentagon symbol)
REMOVALS / RELOCATES (BY OTHERS) (Blue pentagon symbol)
ADJUSTMENTS (Green circle symbol)
ADJUSTMENTS (BY OTHERS) (Orange circle symbol)
- ABBREVIATIONS:**
- | | |
|------|----------------|
| CONC | CONCRETE |
| ASP | ASPHALT |
| TYP | TYPICAL |
| EX | EXISTING |
| MH | MANHOLE |
| WV | WATER VALVE |
| EL | ELEVATION |
| CB | CATCH BASIN |
| CP | CATCH PIT |
| CI | CURB INLET |
| CL | CONTROL LINE |
| SL | STREET LIGHT |
| TS | TRAFFIC SIGNAL |
- SYMBOLS:**
- | | |
|---|---------------------------|
| ○ | HYDRO MANHOLE |
| ○ | TELEPHONE MANHOLE |
| ○ | TRAFFIC SIGNAL SPLICE PIT |
| ○ | WATER VALVE |
| ○ | HYDRANT |
| ○ | CURB STOP |
| ○ | GAS VALVE |
| ○ | CATCH BASIN |
| ○ | HYDRO POLE |
| ○ | HYDRO POLE WITH LIGHT |
| ○ | STREET LIGHT |
| ○ | TRAFFIC SIGNAL |
| ○ | SIGNAL CONTROL BOX |
| ○ | BELLMETS PEDESTAL |
| ○ | TREE |
| ○ | IRON PROPERTY BAR |
| ○ | HYDRO GUY ANCHOR |

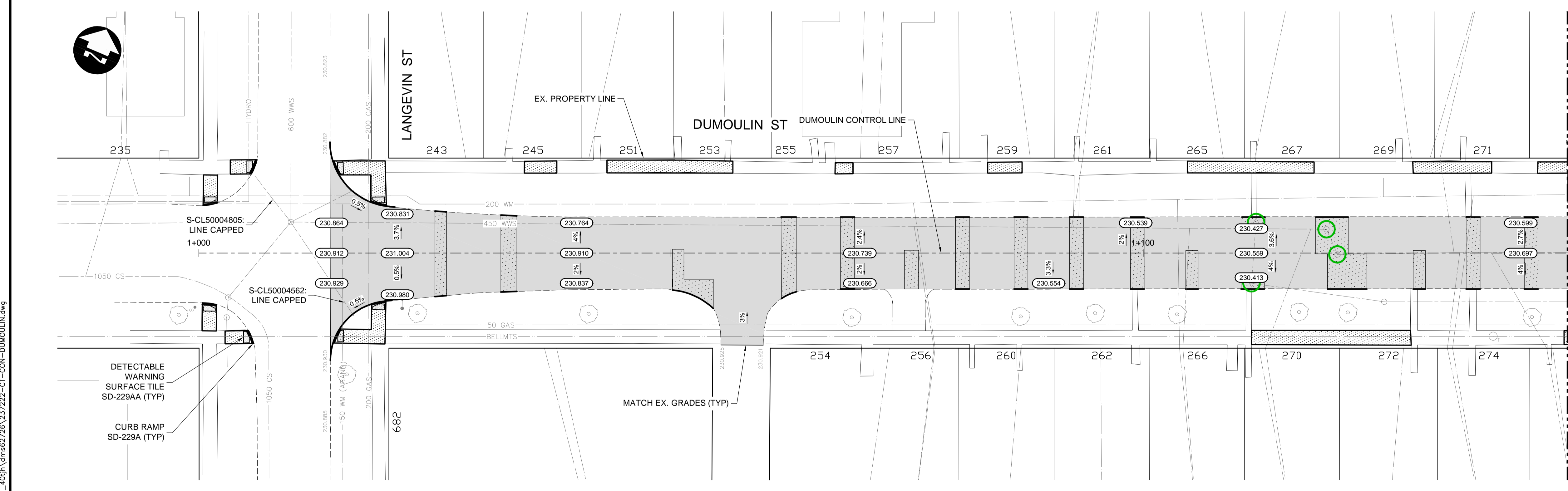

- METRIC**
- WHOLE NUMBERS INDICATE MILLIMETRES
 DECIMALIZED NUMBERS INDICATE METRES
- WARNING**
- IF POWER EQUIPMENT OR EXPLOSIVES ARE TO BE USED FOR EXCAVATION ON THIS PROJECT THE CONTRACTOR MUST:
- NOTIFY THE GAS COMPANY OF THE PROPOSED LOCATION OF EXCAVATION.
 - TAKE PRECAUTION TO AVOID DAMAGE TO GAS COMPANY INSTALLATIONS SEE PROVINCIAL REGULATION 210/72 FOR DETAILS.
 - OBTAIN EXCAVATION PERMITS PRIOR TO CONSTRUCTION.
- ES ENGINEERS GEOSCIENTISTS MANITOBA**
 Certificate of Authorization
Dillon Consulting Limited (MB)
 No. 1789 Date: 2024/05/10

150 WWS	WATERMAIN	150 WWS	CONCRETE ROAD	PROFILE	UNDERGROUND STRUCTURES	B.M. ELEV.	DESIGNED BY	TJH/MRD			THE CITY OF WINNIPEG PUBLIC WORKS DEPARTMENT 2024 LOCAL STREETS RENEWAL PROGRAM DUMOULIN AVENUE AND VARIOUS OTHER LOCATIONS DUMOULIN STREET (START TO STA. 1+145)	CITY DRAWING NUMBER	
300 LDS	LAND DRAINAGE SEWER	300 LDS	ASPHALT ROAD	NORTH/WEST GUTTER	SUPPLY, U/G STRUCTURES	DATE	DRAWN BY	TJH				SHEET	OF
250 WWS	WASTE WATER SEWER	250 WWS	CONC ROAD W/ASP OVERLAY	SOUTH/EAST GUTTER			CHECKED BY	MRD				05	10
HYDRO	HYDRO	BELLMETS	CONCRETE SIDEWALK	NORTH/WEST MED. GUTTER			APPROVED BY	TJP				CONSULTANT DRAWING NUMBER	
100 GAS	GAS	100 GAS	ASPHALT PATH	SOUTH/EAST MED. GUTTER			HOR. SCALE	1:250	23-7222				
T.S.	TRAFFIC SIGNALS	T.S.	LANDSCAPING FEATURE	NORTH/WEST DITCH			VERTICAL	1:10					
S.L.	STREET LIGHTS	S.L.	GRASS/SOD	SOUTH/EAST DITCH			RELEASED FOR CONSTRUCTION						
○	MANHOLE	●	ELEVATION	NORTH/WEST SIDEWALK			DATE						
○	CATCH BASIN	■	(232.000)	SOUTH/EAST SIDEWALK			NO.						
○	CATCH PIT	▼	PROPERTY LINE				ISSUED FOR TENDER	24/05/10	MRD				
○		○	CURB RAMP				NO. REVISIONS						
○		○	DETECTABLE TILE				DATE						
EXISTING	LEGEND-PLAN	PROPOSED	EXISTING	LEGEND-PLAN	PROPOSED	EXISTING	LEGEND-PROFILE	PROPOSED					

C:\pwworking\directory\projects\2023\dillon_403\h\dms62726\237222-CT-CON-DUMOULIN.dwg