

ARLINGTON STREET

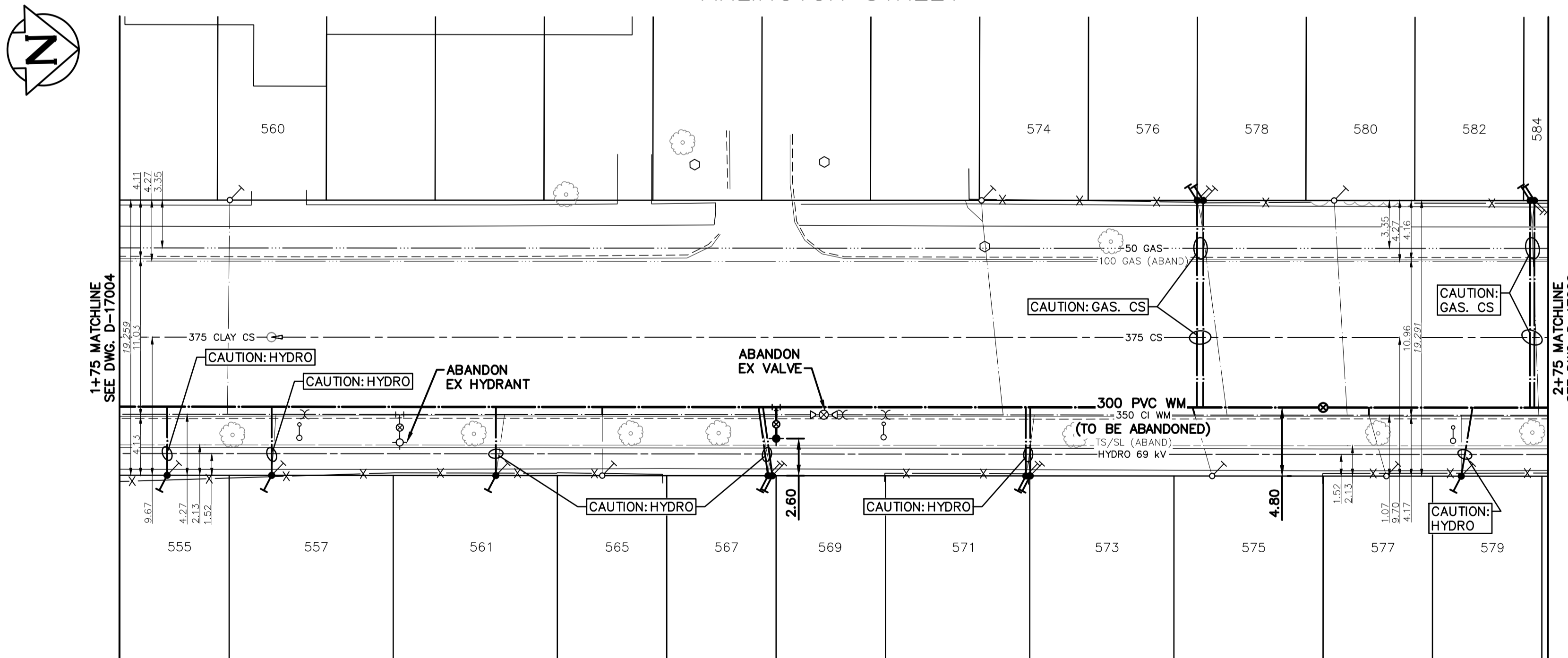

WATER SERVICE INFORMATION					
ADDRESS	PIPE SIZE & MATERIAL (STREET)	PIPE SIZE & MATERIAL (PROPERTY)	STOP COCK LOCATION SHORT & LONG MEASUREMENT	CORP. LOCATION	REMARKS
* 555 ARLINGTON AV	12 LEAD	12 LEAD	7' NSHL & 257'>NNL ELLICE	OPP SC	RENEW SERVICE
* 557 ARLINGTON AV	20 LEAD	20 LEAD	3' NSHL & 281'>NNL ELLICE	1' N SC	RENEW SERVICE
560 ARLINGTON AV	25 CU	12 CU	26' NSBL	0.5' S SC	RECONNECT SERVICE
* 561 ARLINGTON AV	20 LEAD	20 LEAD	11.5' SNHL & 332.5'>NNL ELLICE AV	2' N SC	RENEW SERVICE
565 ARLINGTON AV	20 CU	20 CU	8' NSHL & 45' N HYD OPP 561 ARLINGTON ST	OPP SC	RECONNECT SERVICE
* 567 ARLINGTON AV		12 LEAD	1.2' SNHL & 395'>NNL ELLICE AV	2' S SC	RENEW TO PL W/20 CU WYED W/569 (SEPARATE SERVICES)
* 569 ARLINGTON AV		12 LEAD	1.2' SNHL #567 ARLINGTON ST & 395'>NNL ELLICE AV	2' S SC	RENEW TO PL W/20 CU WYED W/567 (SEPARATE SERVICES)
* 571 ARLINGTON AV		12 LEAD	2' NNHL & 453.8'>NNL ELLICE AV	2' N SC	RENEW TO PL W/20 CU WYED W/573 (SEPARATE SERVICES)
* 573 ARLINGTON AV		12 LEAD	2.4' NNHL #571 ARLINGTON ST & 454.2'>NNL ELLICE AV	2' N SC	RENEW TO PL W/20 CU WYED W/571 (SEPARATE SERVICES)
574 ARLINGTON AV		20 CU	OPP SHL & 178' S HYD OPP 585 ARLINGTON ST	5' N SC	RECONNECT SERVICE
575 ARLINGTON AV	12 CU	12 LEAD	6.5' NSHL & 497'>NNL ELLICE AV	4' S SC	RECONNECT SERVICE
* 576 ARLINGTON AV		12 LEAD	1' SSSL #578 ARLINGTON ST & 503'>NNL ELLICE AV	6' N SC	RENEW TO PL W/20 CU WYED W/578 (SEPARATE SERVICES)
577 ARLINGTON AV	12 CU	12 LEAD	9' NSHL & 537'>NNL ELLICE AV	4' N SC	RECONNECT SERVICE
* 578 ARLINGTON AV		12 LEAD	1' SSSL & 503'>NNL ELLICE AV	6' N SC	RENEW TO PL W/20 CU WYED W/576 (SEPARATE SERVICES)
* 579 ARLINGTON AV	12 LEAD	12 LEAD	5' NSHL & 554.2'>NNL ELLICE AV	OPP SC	RENEW SERVICE
580 ARLINGTON AV	12 CU	12 LEAD	4' NSHL & 525'>NNL ELLICE AV	3' N SC	RECONNECT SERVICE
* 582 ARLINGTON ST		12 LEAD	3' SSSL #584 ARLINGTON ST & 570'>NNL ELLICE AV	2' N SC	RENEW TO PL W/20 CU WYED W/584 (SEPARATE SERVICES)
* 584 ARLINGTON ST		12 LEAD	3' SSSL & 570'>NNL ELLICE AV	2' N SC	RENEW TO PL W/20 CU WYED W/582 (SEPARATE SERVICES)

* SERVICES TO BE RENEWED TO PL

BENCHMARK: 37-031
 ELEV=232.472m
 N.E. COR. ST. MATTHEWS AVE. & SIMCOE ST., TBLT. IN S. CONC.
 FOUNDATION NO. 345 SIMCOE ST., 0.5m E. & 1m BELOW TYNDALL
 STONE OF S.W. COR. OF BLDG.

NOTE: CHAINAGES SHOWN ARE ALONG CENTERLINE OF ROW

NOTE: VALVES TO BE INSTALLED COUNTER-CLOCKWISE TO CLOSE

FOR INDEX SEE D-16994



METRIC
 WHOLE NUMBERS INDICATE MILLIMETRES
 DECIMALIZED NUMBERS INDICATE METRES

ENGINEERS
GEOSCIENTISTS
MANITOBA
 Certificate of Authorization
 Stantec Consulting Ltd.
 No. 1301

LOCATION APPROVED
 UNDERGROUND STRUCTURES

SUPV. U/G STRUCTURES COMMITTEE DATE

NOTE:
 LOCATION OF UNDERGROUND STRUCTURES AS SHOWN ARE BASED ON THE BEST INFORMATION AVAILABLE BUT NO GUARANTEE IS GIVEN THAT ALL EXISTING UTILITIES ARE SHOWN OR THAT THE GIVEN LOCATIONS ARE EXACT. CONFIRMATION OF EXISTENCE AND EXACT LOCATION OF ALL UTILITIES MUST BE OBTAINED FROM THE INDIVIDUAL UTILITIES BEFORE PROCEEDING WITH CONSTRUCTION.

VERTICAL DATUM: CGVD28 (HT2.0 Geoid)
 HORIZONTAL DATUM: NAD83 (June 1990), Zone 14

NO.	ISSUED FOR TENDER	DATE	BY
00	ISSUED FOR TENDER	2024.04.18	RS



DESIGNED BY	RS	CHECKED BY	WB
DRAWN BY	LA	APPROVED BY	RS
SCALE:		RELEASED FOR CONSTRUCTION	SC
HORIZONTAL	1:250		
VERTICAL	1:50		
DATE	2024.04.18	DATE	2024.04.18

ENGINEER'S SEAL



THE CITY OF WINNIPEG
 WATER AND WASTE DEPARTMENT
 ENGINEERING DIVISION

2024 WATER MAIN RENEWALS
 CONTRACT 9
 ARLINGTON STREET
 75.0 N OF ELLICE AVENUE TO
 175.0 N OF ELLICE AVENUE

SHEET 13 OF 15
 CITY DRAWING NUMBER

D-17005

TENDER NUMBER: 194-2024

FILE PATH: u:\111220853\0300_drawing\0302_sheet_files\02_civil\20853c-210

PLOT DATE: 2024 04 18