

**MATERIALS**

- 1. WOOD SLATS: 89x89mm COMPOSITE BOARDS W/ CEDAR TONE FINISH
- 2. FRAME: WELDED STEEL W/ GALVANIZED OR BLACK FINISH

Drawing Title:

**TACHE BENCH COMPOSITE WITH ARMS**

Drawing No:

**SCD-121A**

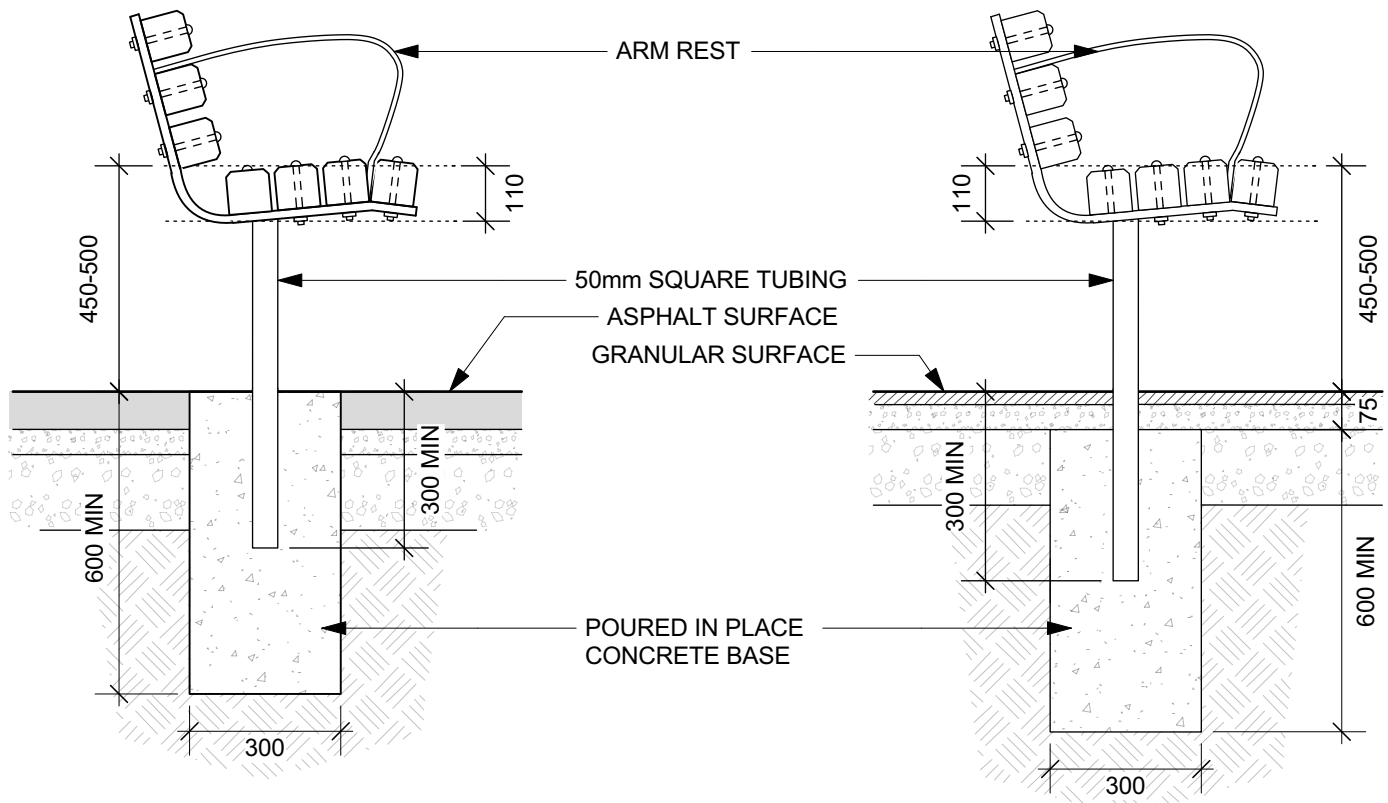
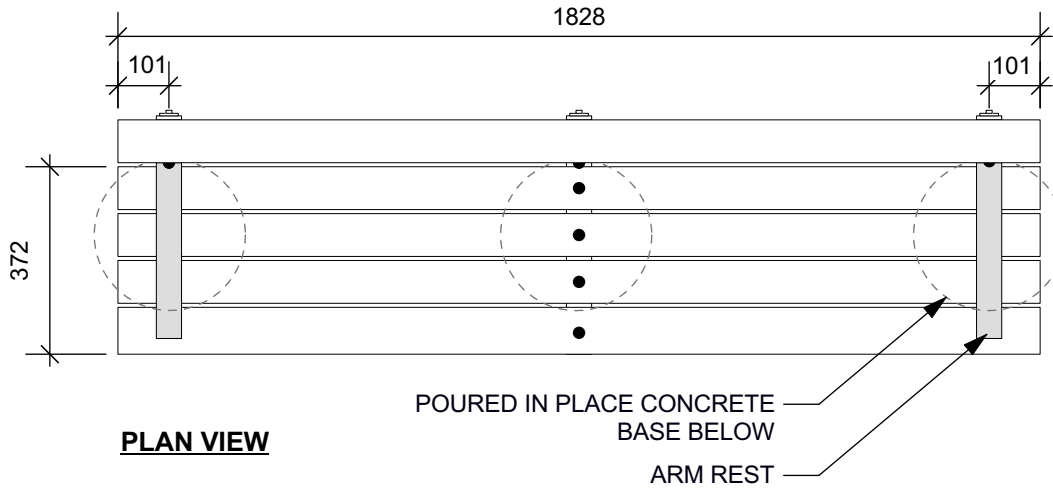

**SIDE ELEVATION - ASPHALT**

**SIDE ELEVATION - GRANULAR**

DIMENSIONS SHOWN ARE IN MILLIMETRES UNLESS OTHERWISE SPECIFIED

REVISION: 5  
DATE: March 2024  
SCALE: NTS  
DRAWN BY: MG

The City of Winnipeg  
Planning, Property and Development Department  
Planning and Land Use Division  
Unit 15 - 30 Fort Street, Winnipeg, MB, R3C 4X5

