

SOUTHBOUND DITCH AND SIDEWALK PROFILE

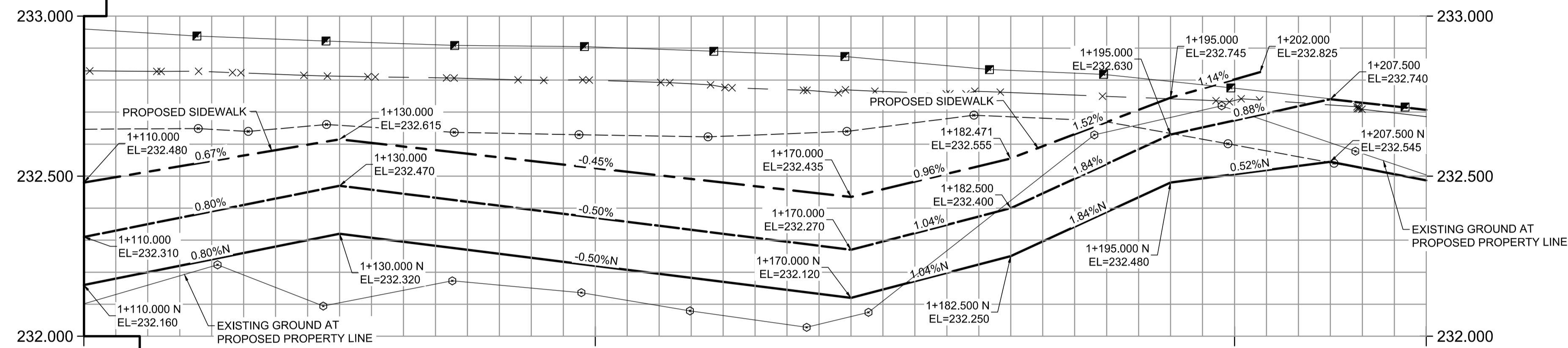

NORTHBOUND PROFILE
UNIVERSITY CRESCENT

REFERENCE NOTES:

- A. PAVEMENT DIMENSIONS ARE TO BACK OF CURB
- B. PROPERTY LINES OBTAINED FROM CITY OF WINNIPEG L.B.I.S., AND NO SCALE FACTOR WAS APPLIED
- C. REFER TO AECOM FIELD BOOK NO. 5086

CONSTRUCTION NOTES:

1. REMOVE EXISTING PAVEMENT AND CONSTRUCT NEW 250mm PLAIN DOWELLED CONCRETE PAVEMENT
2. CONSTRUCT NEW BARRIER CURB (180mm HT. INTEGRAL)
3. CONSTRUCT NEW 100mm CONCRETE SIDEWALK
4. CONSTRUCT NEW ASPHALT PATHWAY (REFER TO CT-12 FOR TYPICAL CROSS SECTIONS)
5. REFER TO AECOM CU DRAWINGS FOR WATER MAIN DETAILS
6. REFER TO AECOM CU DRAWINGS FOR LDS DETAILS
7. ADJUST EXISTING WATER VALVE TO GRADE
8. ADJUST EXISTING MANHOLE / CATCH BASIN TO GRADE
9. CONSTRUCT NEW SAFETY CURB (330mm HT.) 36m IN LENGTH PLUS TWO 3m TRANSITIONS, START SAFETY CURB TRANSITION 5m FROM NORTH LIMIT
10. REMOVE EXISTING HYDRO POLE (BY OTHERS)
11. REMOVE EXISTING TREE
12. ABANDON EXISTING CULVERT
13. REMOVE EXISTING CULVERT
14. INSTALL NEW 300mm CULVERT
15. REGRADE EXISTING DITCH
16. CONSTRUCT NEW BULLNOSE (INTEGRAL)
17. CONSTRUCT NEW MONOLITHIC MEDIAN SLAB
18. CONSTRUCT NEW SAFETY MEDIAN

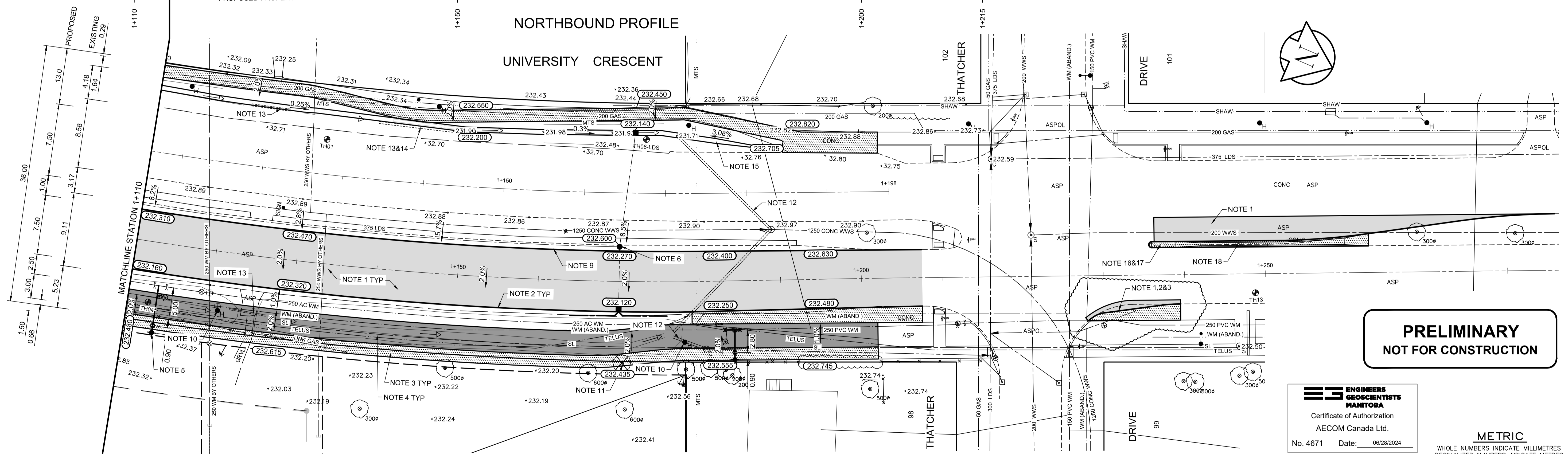

**PRELIMINARY
NOT FOR CONSTRUCTION**

**ENGINEERS
GEOSCIENTISTS
MANITOBA**
Certificate of Authorization
AECOM Canada Ltd.
No. 4671 Date: 06/28/2024

METRIC
WHOLE NUMBERS INDICATE MILLIMETRES
DECIMALIZED NUMBERS INDICATE METRES

150 mm W.M.	WATERMAIN	150 mm W.M.	HYDRO	150 mm W.M.	HYDRO	150 mm W.M.	HYDRO	150 mm W.M.	HYDRO
◇	HYDRANT	◆	M.T.S.	◆	M.T.S.	◆	M.T.S.	◆	M.T.S.
○	VALVE	○	CONCRETE	○	CONCRETE	○	CONCRETE	○	CONCRETE
□	LAND DRAINAGE SEWER	□	ASPHALT	□	ASPHALT	□	ASPHALT	□	ASPHALT
○	WASTEWATER SEWER	○	PROPERTY LINE	○	PROPERTY LINE	○	PROPERTY LINE	○	PROPERTY LINE
○	MANHOLE	○	SURVEY BAR	○	SURVEY BAR	○	SURVEY BAR	○	SURVEY BAR
□	CATCH BASIN	□	ELEVATION	□	ELEVATION	□	ELEVATION	□	ELEVATION
▽	CATCH PIT	▽	TREE	▽	TREE	▽	TREE	▽	TREE
○	JUNCTIONS	○	SIDEWALK RAMP	○	SIDEWALK RAMP	○	SIDEWALK RAMP	○	SIDEWALK RAMP
—	CULVERT	—	CONCRETE SIDEWALK	—	CONCRETE SIDEWALK	—	CONCRETE SIDEWALK	—	CONCRETE SIDEWALK
—	GAS	—	FENCE	—	FENCE	—	FENCE	—	FENCE
EXISTING	LEGEND - PLAN	PROPOSED	EXISTING	LEGEND - PLAN	PROPOSED	EXISTING	LEGEND - PROFILE	PROPOSED	EXISTING

LOCATION APPROVED UNDERGROUND STRUCTURES

—	WEST GUTTER	—	WEST MEDIAN GUTTER	—	WEST PROPOSED SIDEWALK	—	PROPERTY LINE	—	EAST GUTTER	—	EAST MEDIAN GUTTER	—	EAST PROPOSED SIDEWALK	—	E PROPERTY LINE	—	W PROPERTY LINE
—	WEST GUTTER	—	WEST MEDIAN GUTTER	—	WEST PROPOSED SIDEWALK	—	PROPERTY LINE	—	EAST GUTTER	—	EAST MEDIAN GUTTER	—	EAST PROPOSED SIDEWALK	—	E PROPERTY LINE	—	W PROPERTY LINE

1	ADDENDUM #1	06/28/2024	RC
0	ISSUED FOR TENDER	06/19/2024	RC
NO.	REVISIONS	DATE	BY

DESIGNED BY	JT	CHECKED BY	BC
DRAWN BY	JT	APPROVED BY	RC
HOR. SCALE:	1:250	RELEASED FOR CONSTRUCTION BY:	
VERTICAL:	1:10	DATE	06/19/2024

ENGINEER'S SEAL
CONSULTANT DRAWING NO. CT-11

THE CITY OF WINNIPEG
PUBLIC WORKS DEPARTMENT
ENGINEERING DIVISION

2024 REGIONAL STREET RENEWAL PROGRAM
UNIVERSITY CRESCENT

CONCRETE PAVEMENT RECONSTRUCTION
STATION 1+110 TO THATCHER DRIVE NORTH BOUND
PLAN-PROFILE

CITY DRAWING NUMBER P-3579-11
SHEET 11 OF 21