

PLAN
Scale 1:500

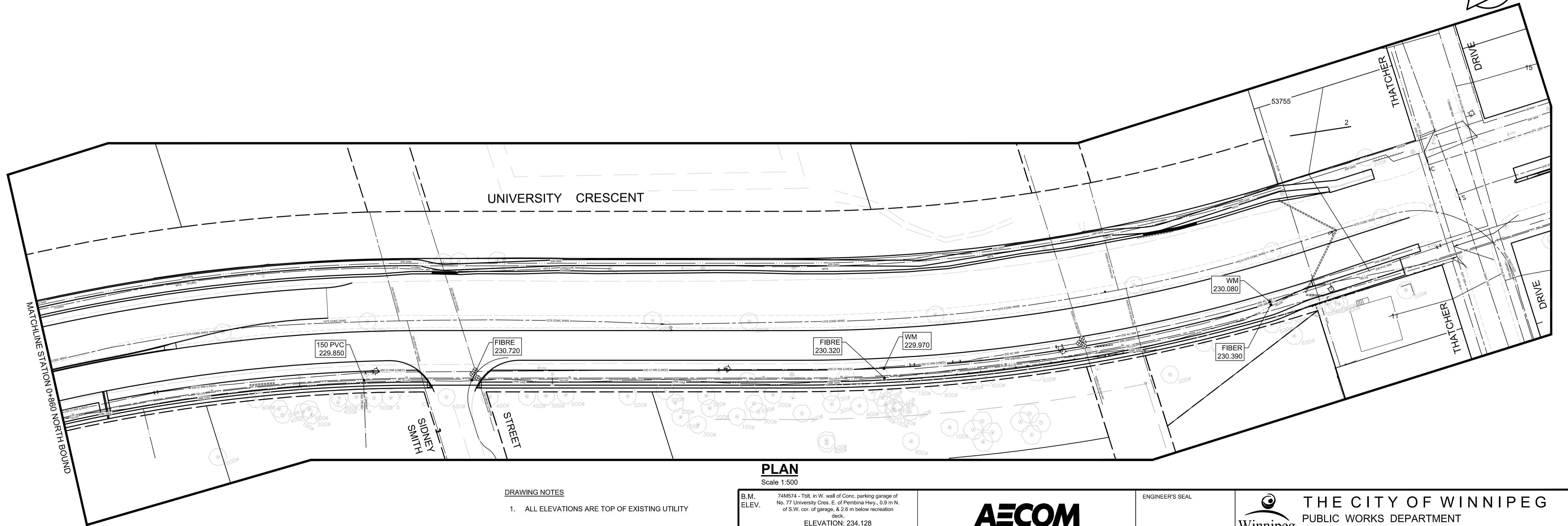

PLAN
Scale 1:500

- DRAWING NOTES**
- ALL ELEVATIONS ARE TOP OF EXISTING UTILITY

ISSUED FOR
INFORMATION
Date: 2024/06/06

**ENGINEERS
GEOSCIENTISTS
MANITOBA**
Certificate of Authorization
AECOM Canada Ltd.
No. 4671 Date: 06/06/2024

METRIC
WHOLE NUMBERS INDICATE MILLIMETRES
DECIMALIZED NUMBERS INDICATE METRES

| | | | |
|------------|--|------------|----|
| B.M. ELEV. | 74M574 - Tilt. in W. wall of Conc. parking garage of No. 77 University Cres. E. of Pembina Hwy., 0.9 m N. of S.W. cor. of garage, & 2.6 m below recreation deck. ELEVATION: 234.128 | | |
| NO. | REVISIONS | DATE | BY |
| 0 | ISSUED FOR INFORMATION | 06/06/2024 | RC |

AECOM

| | | |
|-------------|-------------------------------|------------|
| DESIGNED BY | CHECKED BY | RC |
| DRAWN BY | APPROVED BY | RC |
| HOR. SCALE: | AS SHOWN | |
| VERTICAL: | RELEASED FOR CONSTRUCTION BY: | |
| NO. | REVISIONS | DATE |
| 0 | ISSUED FOR INFORMATION | 06/06/2024 |

ENGINEER'S SEAL

THE CITY OF WINNIPEG
PUBLIC WORKS DEPARTMENT
ENGINEERING DIVISION

2024 REGIONAL STREET RENEWAL PROGRAM
UNIVERSITY CRESCENT

CITY DRAWING NUMBER

SHEET 01 OF 01

CONSULTANT DRAWING NO.
SK-01

UTILITY LOCATES
SIFTON ROAD TO THATCHER DRIVE
NORTHBOUND AND SOUTHBOUND UNIVERSITY CRESCENT