

SOUTHBOUND DITCH AND SIDEWALK PROFILE

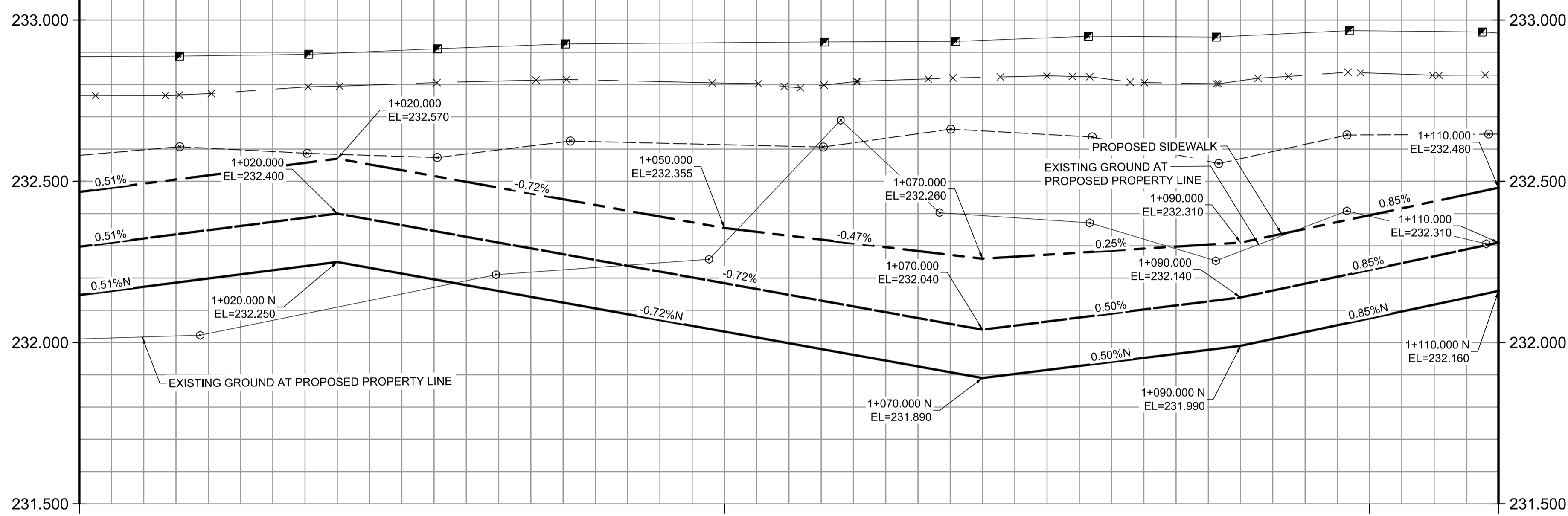

NORTHBOUND PROFILE

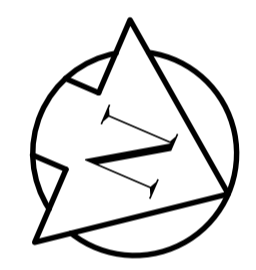
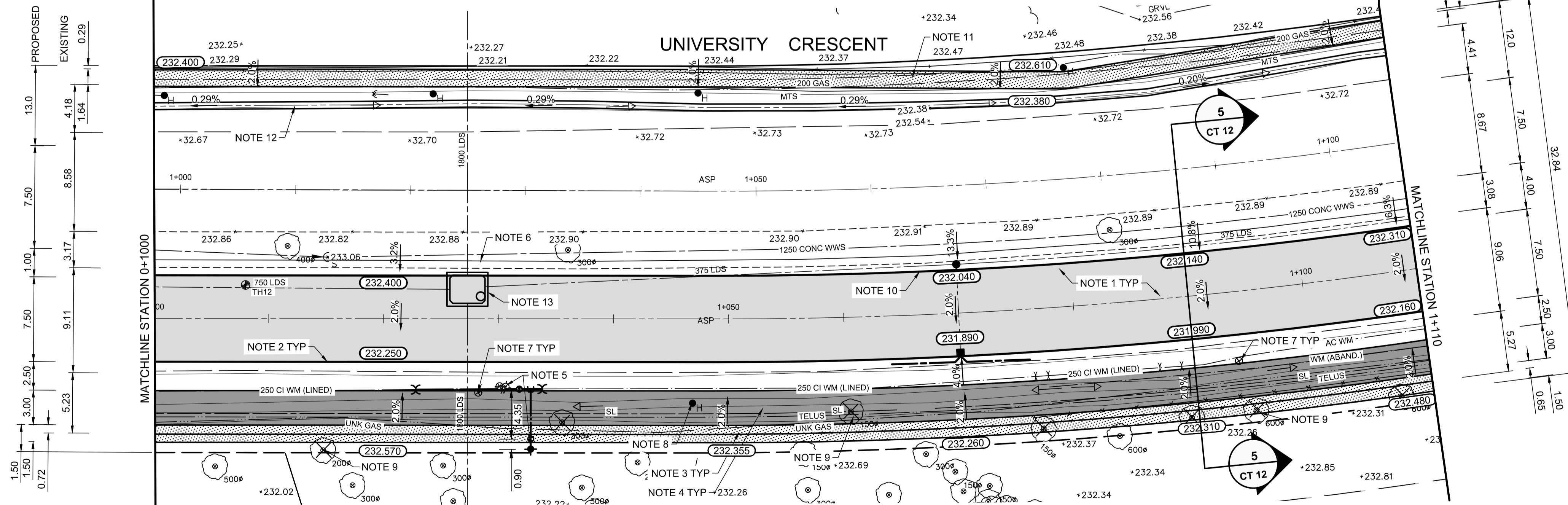

REFERENCE NOTES:

- A. PAVEMENT DIMENSIONS ARE TO BACK OF CURB
- B. PROPERTY LINES OBTAINED FROM CITY OF WINNIPEG L.B.I.S., AND NO SCALE FACTOR WAS APPLIED
- C. REFER TO AECOM FIELD BOOK NO. 5086

CONSTRUCTION NOTES:

1. REMOVE EXISTING PAVEMENT AND CONSTRUCT NEW 250mm PLAIN DOWELLED CONCRETE PAVEMENT
2. CONSTRUCT NEW BARRIER CURB (180mm HT. INTEGRAL)
3. CONSTRUCT NEW 100mm CONCRETE SIDEWALK
4. CONSTRUCT NEW ASPHALT PATHWAY (REFER TO CT-12 FOR TYPICAL CROSS SECTIONS)
5. REFER TO AECOM CU DRAWINGS FOR WATER MAIN DETAILS
6. REFER TO AECOM CU DRAWINGS FOR LDS DETAILS
7. ADJUST EXISTING WATER VALVE TO GRADE
8. REMOVE EXISTING HYDRO POLE (BY OTHERS)
9. REMOVE EXISTING TREE
10. CONSTRUCT NEW SAFETY CURB FROM STATION 0+1000 TO STATION 1+110
11. RENEW EXISTING 100mm CONCRETE SIDEWALK
12. REGRADE EXISTING DITCH
13. REMOVE EXISTING PAVEMENT AND CONSTRUCT NEW 250mm REINFORCED CONCRETE PAVEMENT OVER MANHOLE

**PRELIMINARY
NOT FOR CONSTRUCTION**

**ENGINEERS
GEOSCIENTISTS
MANITOBA**
Certificate of Authorization
AECOM Canada Ltd.
No. 4671 Date: 06/19/2024

METRIC
WHOLE NUMBERS INDICATE MILLIMETRES
DECIMALIZED NUMBERS INDICATE METRES

150 mm W.M.	WATERMAIN	150 mm W.M.	HYDRO	150 mm W.M.	HYDRO	150 mm W.M.	HYDRO
Hydrant symbol	HYDRANT	Hydrant symbol	M.T.S.	Hydrant symbol	M.T.S.	Hydrant symbol	M.T.S.
Valve symbol	VALVE	Valve symbol	CONCRETE	Valve symbol	CONCRETE	Valve symbol	CONCRETE
Land drainage sewer symbol	LAND DRAINAGE SEWER	Wastewater sewer symbol	ASPHALT	Property line symbol	PROPERTY LINE	Survey bar symbol	SURVEY BAR
Manhole symbol	MANHOLE	Manhole symbol	ELEVATION	Tree symbol	TREE	Sidewalk ramp symbol	SIDEWALK RAMP
Catch basin symbol	CATCH BASIN	Catch pit symbol	JUNCTIONS	Culvert symbol	CULVERT	Gas symbol	GAS
Existing symbol	EXISTING	Proposed symbol	Existing symbol	Proposed symbol	Existing symbol	Proposed symbol	Existing symbol

LOCATION APPROVED UNDERGROUND STRUCTURES

SUPV. UG STRUCTURES COMMITTEE DATE

NOTE:
LOCATION OF UNDERGROUND STRUCTURES AS SHOWN ARE BASED ON THE BEST INFORMATION AVAILABLE. BUT NO GUARANTEE IS GIVEN THAT ALL EXISTING UTILITIES ARE SHOWN OR THAT THE GIVEN LOCATIONS ARE EXACT. CONFIRMATION OF EXISTENCE AND EXACT LOCATION OF ALL SERVICES MUST BE OBTAINED FROM THE INDIVIDUAL UTILITIES BEFORE PROCEEDING WITH CONSTRUCTION.

B.M. ELEV. 74M574 - Tibt. in W. wall of Conc. parking garage of No. 77 University Cres. E. of Pembina Hwy. . 0.9 m N. of S.W. cor. of garage, & 2.6 m below recreation deck.
ELEVATION: 234.128
HORIZONTAL: Northing: 5519531.393, Easting: 632962.234

NO.	ISSUED FOR TENDER	06/19/2024	RC
NO.	REVISIONS	DATE	BY

AECOM

DESIGNED BY	JT	CHECKED BY	BC
DRAWN BY	JT	APPROVED BY	RC
HOR. SCALE:	1:250	RELEASED FOR CONSTRUCTION BY:	
VERTICAL:	1:10	DATE	06/19/2024

ENGINEER'S SEAL

THE CITY OF WINNIPEG
PUBLIC WORKS DEPARTMENT
ENGINEERING DIVISION

2024 REGIONAL STREET RENEWAL PROGRAM
UNIVERSITY CRESCENT

CITY DRAWING NUMBER P-3579-10
SHEET 10 OF 21

CONCRETE PAVEMENT RECONSTRUCTION
STATION 1+000 TO STATION 1+110 NORTH BOUND
PLAN-PROFILE

CONSULTANT DRAWING NO. CT-10