

SOUTHBOUND DITCH AND SIDEWALK PROFILE

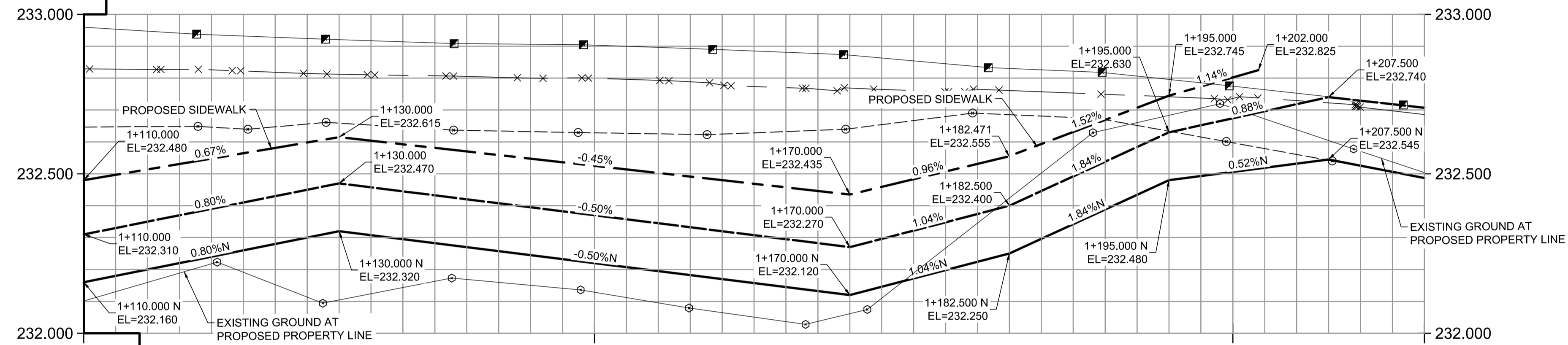

NORTHBOUND PROFILE
UNIVERSITY CRESCENT

REFERENCE NOTES:

- A. PAVEMENT DIMENSIONS ARE TO BACK OF CURB
- B. PROPERTY LINES OBTAINED FROM CITY OF WINNIPEG L.B.I.S., AND NO SCALE FACTOR WAS APPLIED
- C. REFER TO AECOM FIELD BOOK NO. 5086

CONSTRUCTION NOTES:

1. REMOVE EXISTING PAVEMENT AND CONSTRUCT NEW 250mm PLAIN DOWELLED CONCRETE PAVEMENT
2. CONSTRUCT NEW BARRIER CURB (180mm HT. INTEGRAL)
3. CONSTRUCT NEW 100mm CONCRETE SIDEWALK
4. CONSTRUCT NEW ASPHALT PATHWAY (REFER TO CT-12 FOR TYPICAL CROSS SECTIONS)
5. REFER TO AECOM CU DRAWINGS FOR WATER MAIN DETAILS
6. REFER TO AECOM CU DRAWINGS FOR LDS DETAILS
7. ADJUST EXISTING WATER VALVE TO GRADE
8. ADJUST EXISTING MANHOLE / CATCH BASIN TO GRADE
9. CONSTRUCT NEW SAFETY CURB (330mm HT.) 36m IN LENGTH PLUS TWO 3m TRANSITIONS, START SAFETY CURB TRANSITION 5m FROM NORTH LIMIT
10. REMOVE EXISTING HYDRO POLE (BY OTHERS)
11. REMOVE EXISTING TREE
12. ABANDON EXISTING CULVERT
13. REMOVE EXISTING CULVERT
14. INSTALL NEW 300mm CULVERT
15. REGRADE EXISTING DITCH
16. CONSTRUCT NEW BULLNOSE (INTEGRAL)
17. CONSTRUCT NEW MONOLITHIC MEDIAN SLAB
18. CONSTRUCT NEW SAFETY MEDIAN

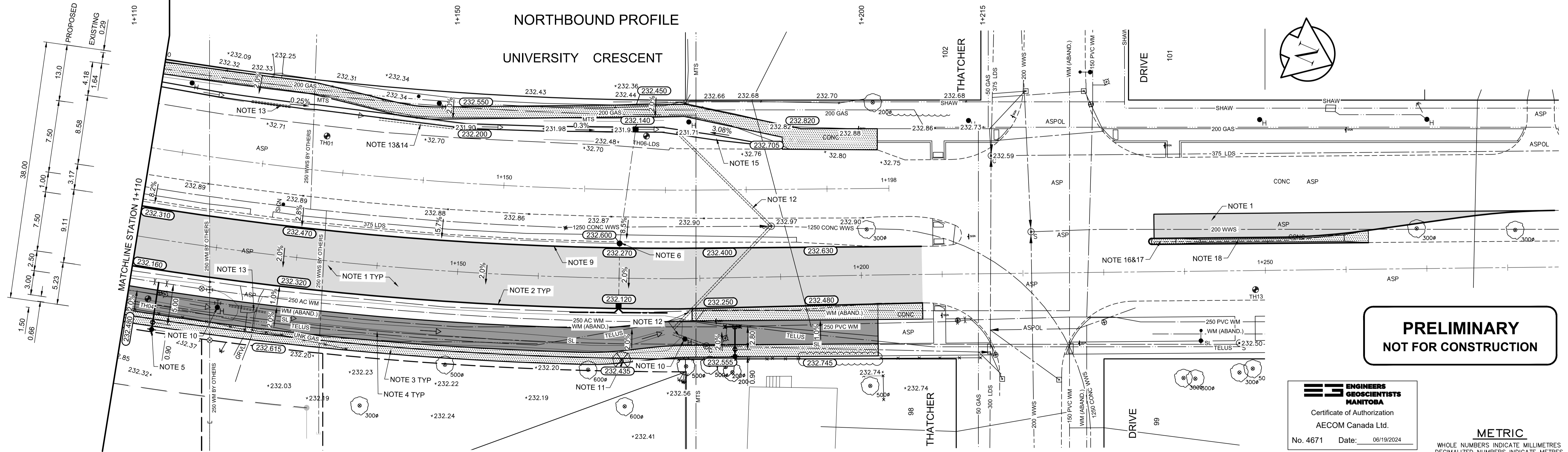

**PRELIMINARY
NOT FOR CONSTRUCTION**

**ENGINEERS
GEOSCIENTISTS
MANITOBA**
Certificate of Authorization
AECOM Canada Ltd.
No. 4671 Date: 06/19/2024

METRIC
WHOLE NUMBERS INDICATE MILLIMETRES
DECIMALIZED NUMBERS INDICATE METRES

150 mm W.M.	WATERMAIN	150 mm W.M.	HYDRO	150 mm W.M.	HYDRO	---	PROFILE	---
◇	HYDRANT	◆	M.T.S.	---	M.T.S.	---	WEST GUTTER	---
○	VALVE	○	CONCRETE	---	CONCRETE	---	WEST MEDIAN GUTTER	---
□	LAND DRAINAGE SEWER	□	ASPHALT	---	ASPHALT	---	WEST PROPOSED SIDEWALK	---
▭	WASTEWATER SEWER	▭	PROPERTY LINE	---	PROPERTY LINE	---	EAST GUTTER	---
○	MANHOLE	○	SURVEY BAR	---	SURVEY BAR	---	EAST MEDIAN GUTTER	---
□	CATCH BASIN	□	ELEVATION	---	ELEVATION (235.750)	---	EAST PROPOSED SIDEWALK	---
▽	CATCH PIT	▽	TREE	---	TREE	---	E PROPERTY LINE	---
+	JUNCTIONS	+	SIDEWALK RAMP	---	SIDEWALK RAMP	---	W PROPERTY LINE	---
▭	CULVERT	▭	CONCRETE SIDEWALK	---	CONCRETE SIDEWALK	---		
---	GAS	---	FENCE	---	FENCE	---		
---	EXISTING	---	LEGEND - PLAN	---	PROPOSED	---	EXISTING	---
---	LEGEND - PLAN	---	PROPOSED	---	EXISTING	---	LEGEND - PROFILE	---
---	PROPOSED	---	EXISTING	---	LEGEND - PLAN	---	PROPOSED	---

LOCATION APPROVED UNDERGROUND STRUCTURES

SUPV. U/G STRUCTURES COMMITTEE DATE
NOTE:
LOCATION OF UNDERGROUND STRUCTURES AS SHOWN ARE BASED ON THE BEST INFORMATION AVAILABLE, BUT NO GUARANTEE IS GIVEN THAT ALL EXISTING UTILITIES ARE SHOWN OR THAT THE GIVEN LOCATIONS ARE EXACT. CONFIRMATION OF EXISTENCE AND EXACT LOCATION OF ALL SERVICES MUST BE OBTAINED FROM THE INDIVIDUAL UTILITIES BEFORE PROCEEDING WITH CONSTRUCTION.

B.M. ELEV.	74M574 - Tibt. in W. wall of Conc. parking garage of No. 77 University Cres. E. of Pembina Hwy. . 0.9 m N. of S.W. cor. of garage, & 2.6 m below recreation deck.
	ELEVATION: 234.128
	HORIZONTAL: Northing: 5519531.393, Easting: 632962.234
0	ISSUED FOR TENDER
NO.	REVISIONS
	DATE
	BY
	DATE
	06/19/2024
	RC

AECOM	
DESIGNED BY	JT
CHECKED BY	BC
DRAWN BY	JT
APPROVED BY	RC
HOR. SCALE:	1:250
VERTICAL:	1:10
RELEASED FOR CONSTRUCTION BY:	
DATE	06/19/2024

ENGINEER'S SEAL	
CONSULTANT DRAWING NO.	CT-11

THE CITY OF WINNIPEG
PUBLIC WORKS DEPARTMENT
ENGINEERING DIVISION

2024 REGIONAL STREET RENEWAL PROGRAM
UNIVERSITY CRESCENT

CONCRETE PAVEMENT RECONSTRUCTION
STATION 1+110 TO THATCHER DRIVE NORTH BOUND
PLAN-PROFILE

CITY DRAWING NUMBER P-3579-11
SHEET 11 OF 21