

NOTE: REMOVE TOP 40mm WITH DIAMOND GRINDING AND THE REMAINING WITH HAND DEMOLITION TOOLS UNTIL SOUND CONCRETE IS REACHED. CONTRACTOR MAY USE HYDRO DEMOLITION IF ENCOUNTERING EXISTING REINFORCEMENT

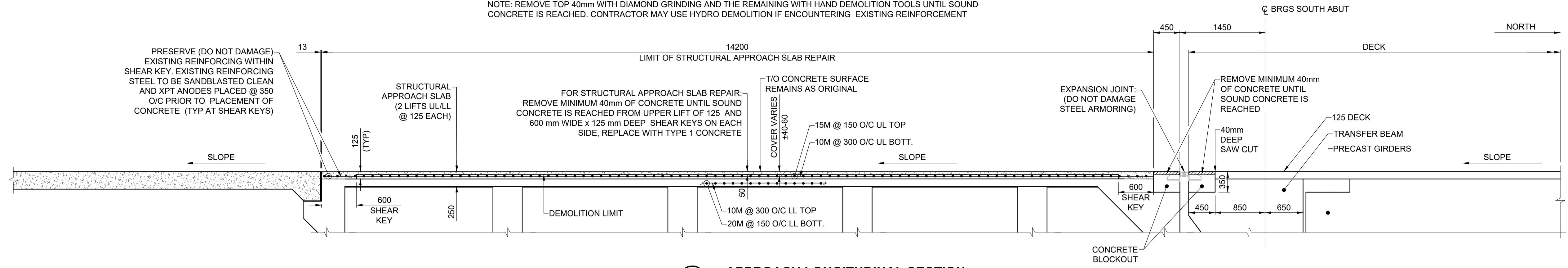

APPROACH LONGITUDINAL SECTION
STRUCTURAL SLAB REPAIR
SCALE 1:40

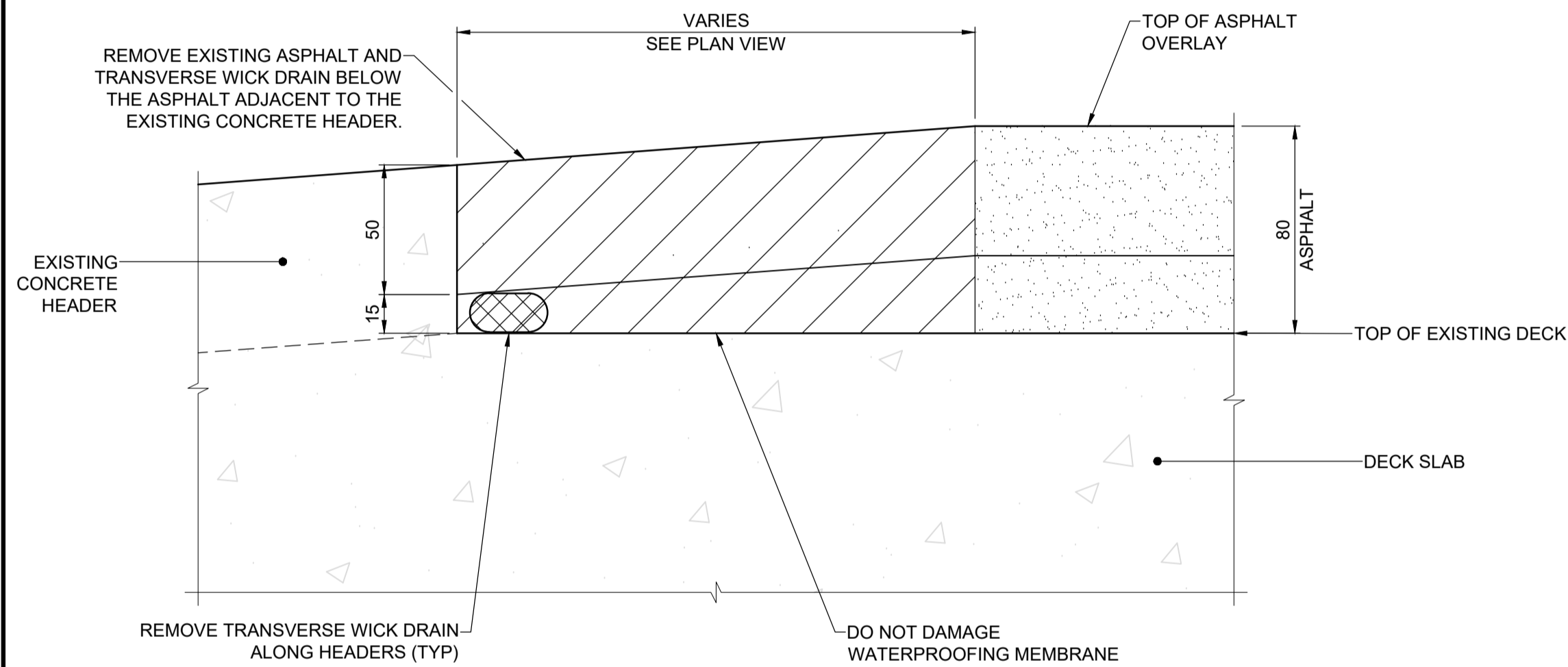

ASPHALT LONGITUDINAL SECTION
EXISTING CONDITION
SCALE: 1:2

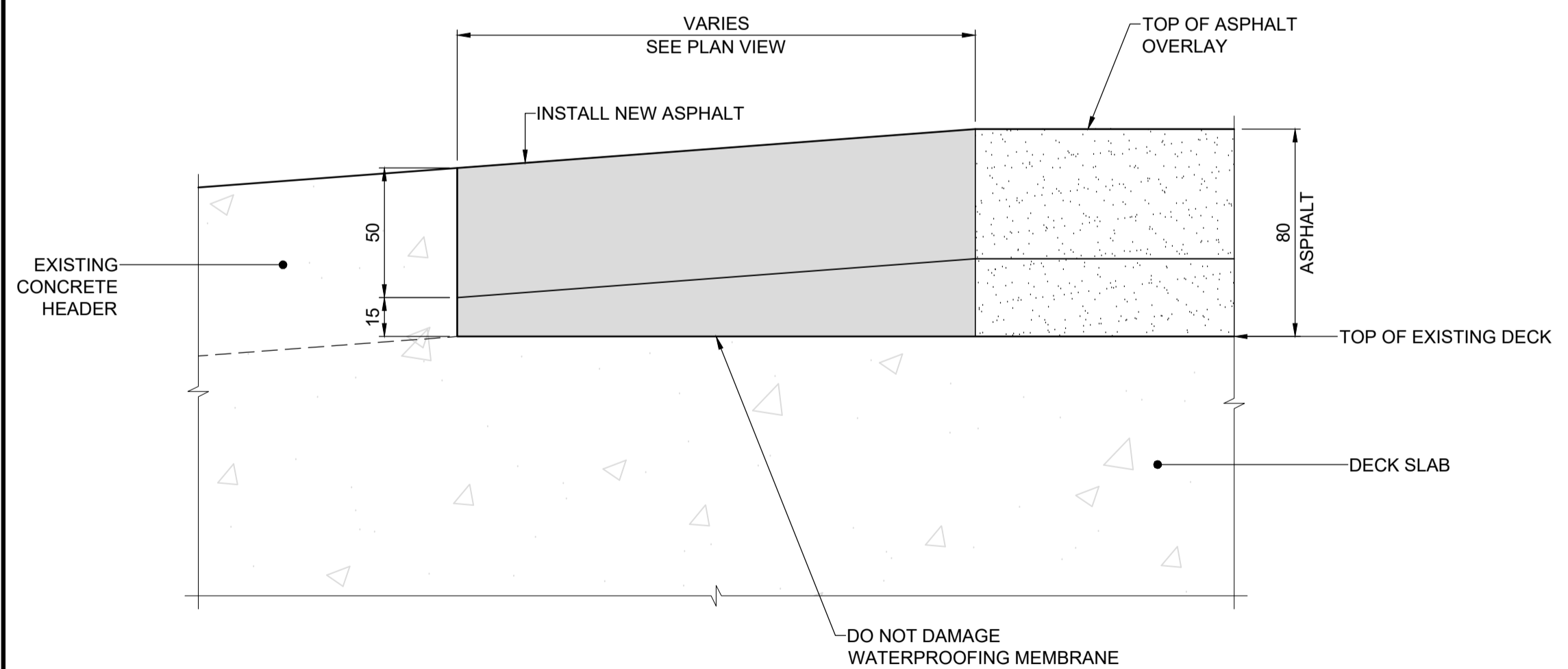

ASPHALT LONGITUDINAL SECTION
REPAIRS
SCALE: 1:2

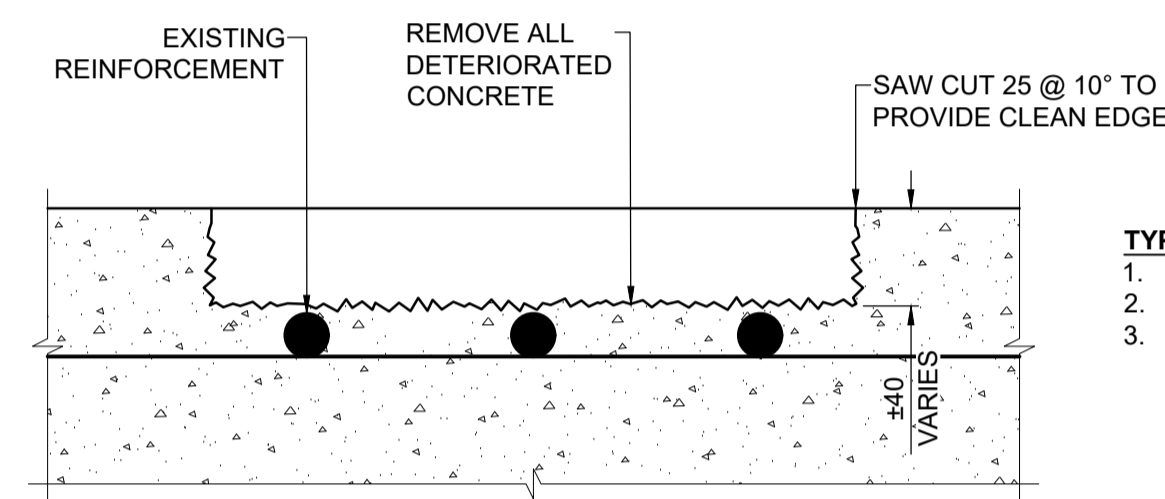

TYPICAL TYPE 1 CONCRETE
DELAMINATION REPAIR
ELEVATION
SCALE NTS

TYPE 1 REPAIR PROCEDURE (NO EXPOSED REBAR):
1. SAWCUT PERIPHERY OF REPAIR AREA TO 25 mm DEEP.
2. REMOVE ALL DETERIORATED CONCRETE.
3. PLACE NEW CONCRETE TO COMPLETE PATCH REPAIR.

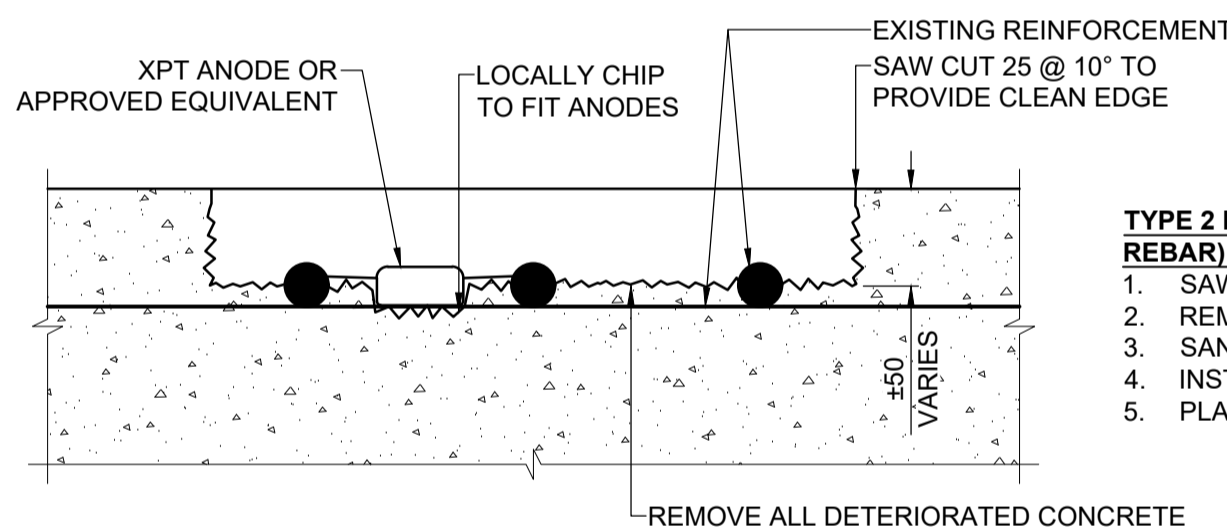

TYPICAL TYPE 2 CONCRETE
DELAMINATION REPAIR
ELEVATION
SCALE NTS

TYPE 2 REPAIR PROCEDURE (UP TO MIDDLE OF EXPOSED REBAR):
1. SAWCUT PERIPHERY OF REPAIR AREA TO 25 mm DEEP.
2. REMOVE ALL DETERIORATED CONCRETE.
3. SANDBLAST ALL EXPOSED REINFORCING STEEL.
4. INSTALL XPT ANODE.
5. PLACE NEW CONCRETE TO COMPLETE PATCH REPAIR.

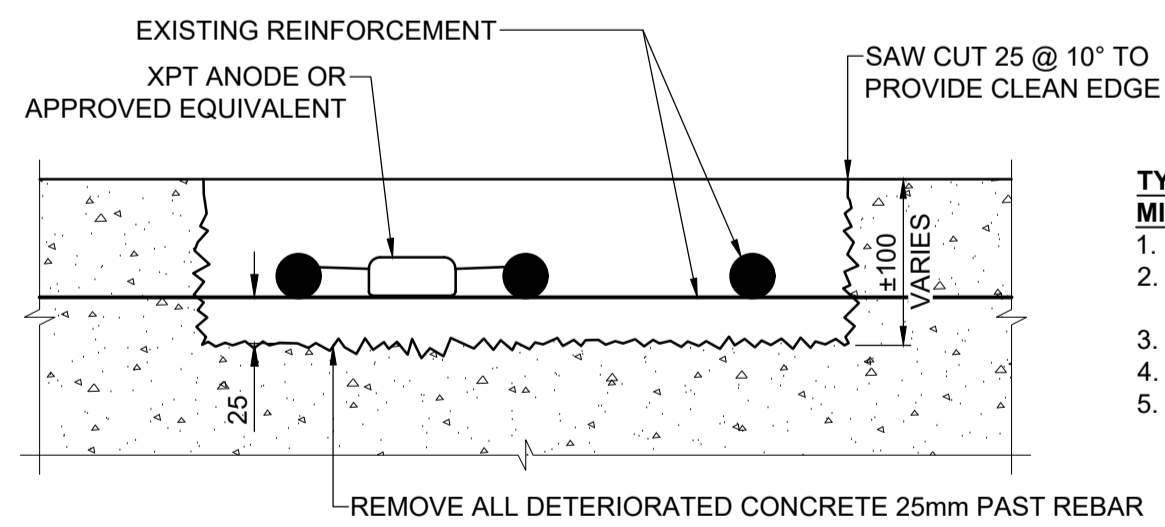

TYPICAL TYPE 3 CONCRETE
DELAMINATION REPAIR
ELEVATION
SCALE NTS

TYPE 3 REPAIR PROCEDURE (DELAMINATION EXTENDS PAST MIDDLE OF REBAR):
1. SAWCUT PERIPHERY OF REPAIR AREA TO 25 mm DEEP.
2. REMOVE ALL DETERIORATED CONCRETE 25 mm PAST REBAR.
3. SANDBLAST ALL EXPOSED REINFORCING STEEL.
4. INSTALL XPT ANODE.
5. PLACE NEW CONCRETE TO COMPLETE PATCH REPAIR.

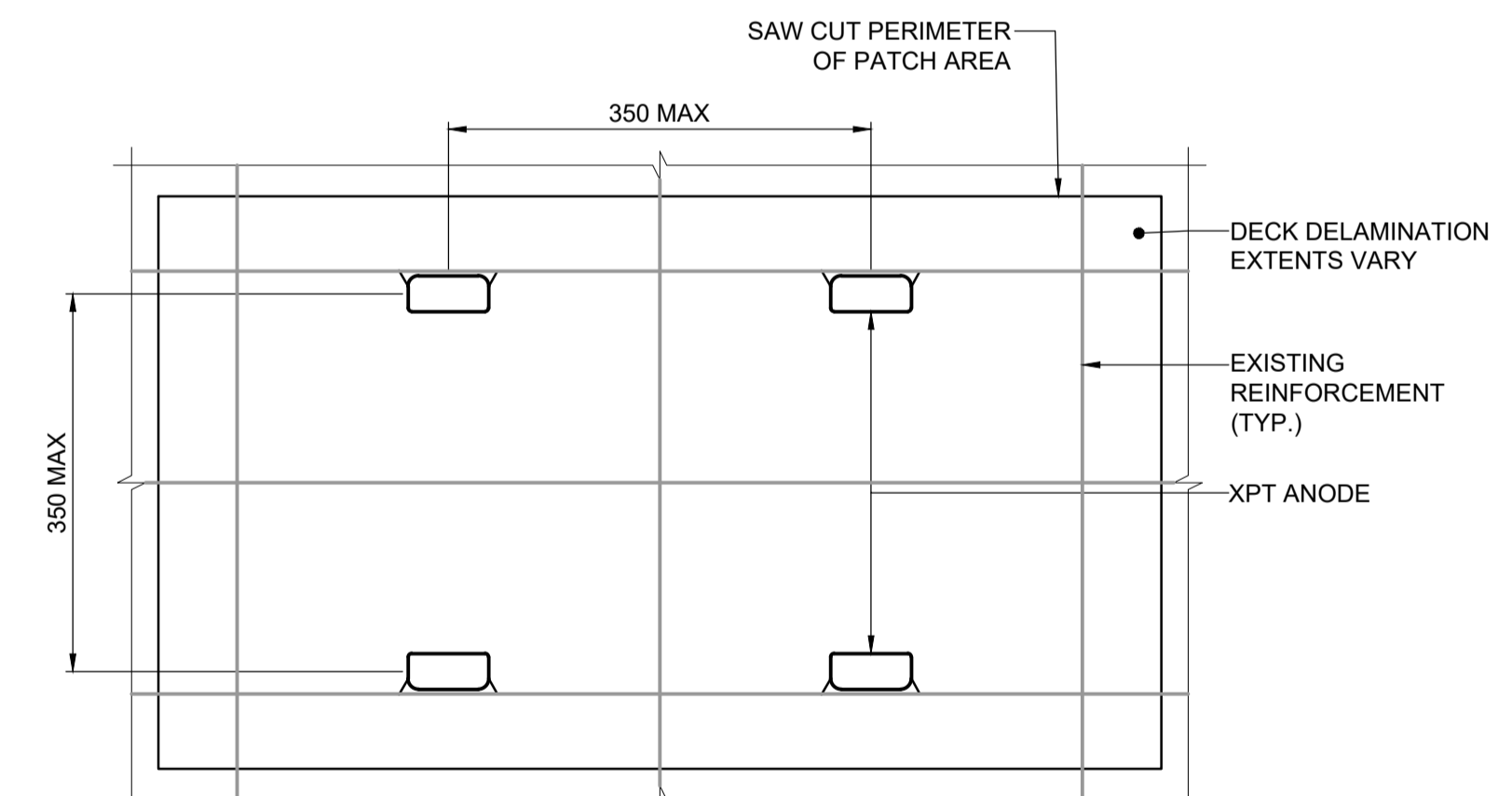

TYPICAL TYPE 2 & 3 CONCRETE
DELAMINATION REPAIR
PLAN
SCALE NTS

NOTES:
1. CONCRETE CRACKS >0.5mm WIDTH TO BE DISCUSSED WITH THE CONTRACT ADMINISTRATOR AND EPOXY INJECTED AS DETERMINED APPROPRIATE.

METRIC
WHOLE NUMBERS INDICATE MILLIMETRES
DECIMALIZED NUMBERS INDICATE METRES

LOCATION APPROVED UNDERGROUND STRUCTURES table with columns for SUPR, U/G STRUCTURES, DATE, and COMMITTEE.

Table with columns for BM, ELEV, and REVISIONS.

Table with columns for DESIGNED BY, DRAWN BY, HOR SCALE, VERT SCALE, and DATE.

Table with columns for PROFESSIONAL'S SEAL, CONSULTANT FILE NAME, and DATE.

THE CITY OF WINNIPEG PUBLIC WORKS DEPARTMENT ENGINEERING DIVISION. 2024 BRIDGE MAINTENANCE MAIN STREET AND NORWOOD BRIDGES. NORWOOD BRIDGE NORTHBOUND STRUCTURAL APPROACH SLAB & ASPHALT REPAIR DETAILS. SHEET 09 OF 23. DRAWING NUMBER 09.

ENGINEERS GEOSCIENTISTS MANITOBA Certificate of Authorization MORRISON HERSHFIELD No. 1736

TENDER No. 291-2024