

1 SITE PLAN
SCALE: 1:200

GENERAL NOTES:

- EMERGENCY STOP PUSHBUTTON HSS-720 SHALL DE-ENERGIZE SV-720 WHEN THE E-STOP IS PRESSED IN THE EVENT OF AN EMERGENCY. WHEN E-STOP IS PRESSED THE SOLENOID VALVE SHALL FAIL CLOSED AND STOP THE FLOW OF PROPANE INTO THE VAPORIZER. E-STOP AND SOLENOID VALVE SHALL BE POWERED FROM GENERATOR CONTROL CIRCUITRY. MOUNT E-STOP ON PEDESTAL LOCATED AT GENERATOR. REFER TO DETAIL G FOR WIRING DETAILS.
- BURRIED ARMoured CABLES PROVIDED FOR VALVE CHAMBER LIGHTS, SUMP PUMP, AIR HANDLING UNIT, EXHAUST FAN, DAMPER ACTUATORS, FLOAT SWITCH, AND TEMPERATURE TRANSMITTER.
- CONDUITS PROVIDED FOR LIGHTS AND FLOAT SWITCH.
- REFER TO DRAWING 1-0241L-E0006-001 FOR HAZARDOUS AREA REQUIREMENTS.
- PROVIDE CABLE CONDUIT SLEEVES THROUGH CONCRETE SLABS. PROVIDE EXTRA CABLE LENGTH (CABLE LOOP) WITHIN EQUIPMENT ENCLOSURES TO ALLOW FOR 150mm OF GROUND SETTLEMENT.
- GENERATOR CONTROL AND CIRCUIT BREAKERS STATUSES. SEE REFERENCE DRAWING 2.
- BELL MTS UNDERGROUND CONDUIT C/W PULL CORD. CONTRACTOR SHALL COORDINATE AND APPLY FOR ONE (1) TELEPHONE LINE SERVICE WITH BELL MTS.
- CONTRACTOR SHALL COORDINATE WITH MB HYDRO FOR THE INSTALLATION OF MB HYDRO ELECTRICAL SERVICE.
- CONDUIT PROVIDED FOR FLOAT SWITCH, REFER TO DETAIL E, ADJUST NUMBER OF CONDUITS AS REQUIRED.
- CONTRACTOR SHALL COORDINATE ALL WALL PENETRATIONS WITH KGS STRUCTURAL/ARCHITECTURAL.
- PROVIDE 4C, #6AWG, TECK90, 1KV FOR GENERATOR LOAD CENTER PANELBOARD.
- HOLD PENDING PROPANE SUPPLIER AND GENERATOR MANUFACTURER SHOP DRAWINGS.
- CABLES TO ENTER SUPERSTRUCTURE THROUGH PVC CONDUIT SLEEVE. REMOVE INTERLOCKING ARMOUR AS REQUIRED. WHERE INTERLOCKING ARMOUR IS REMOVED, CABLE SHALL CONTINUE IN CONDUIT UNTIL TERMINATED.

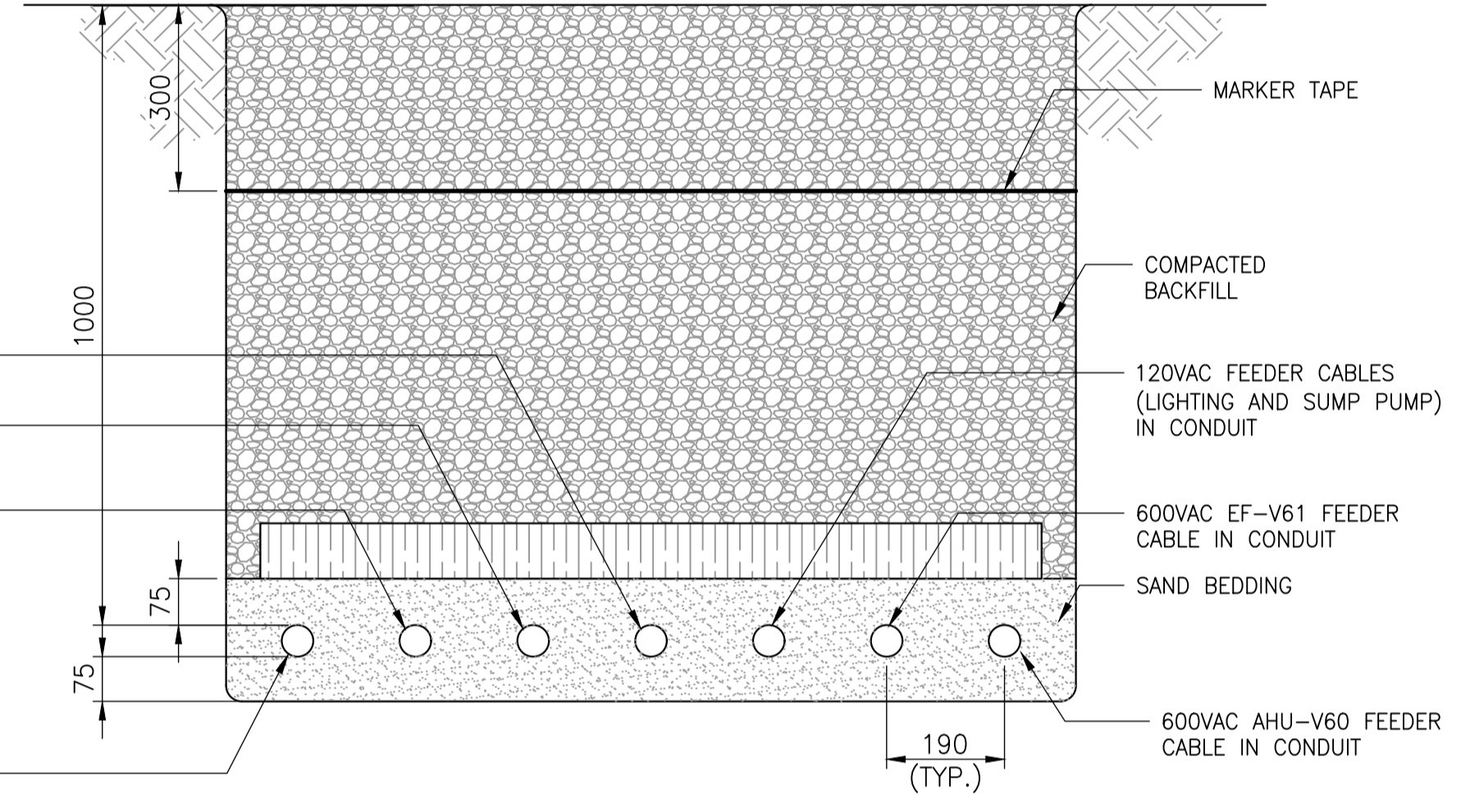

F CABLE TRENCH DETAIL
SCALE: N.T.S.

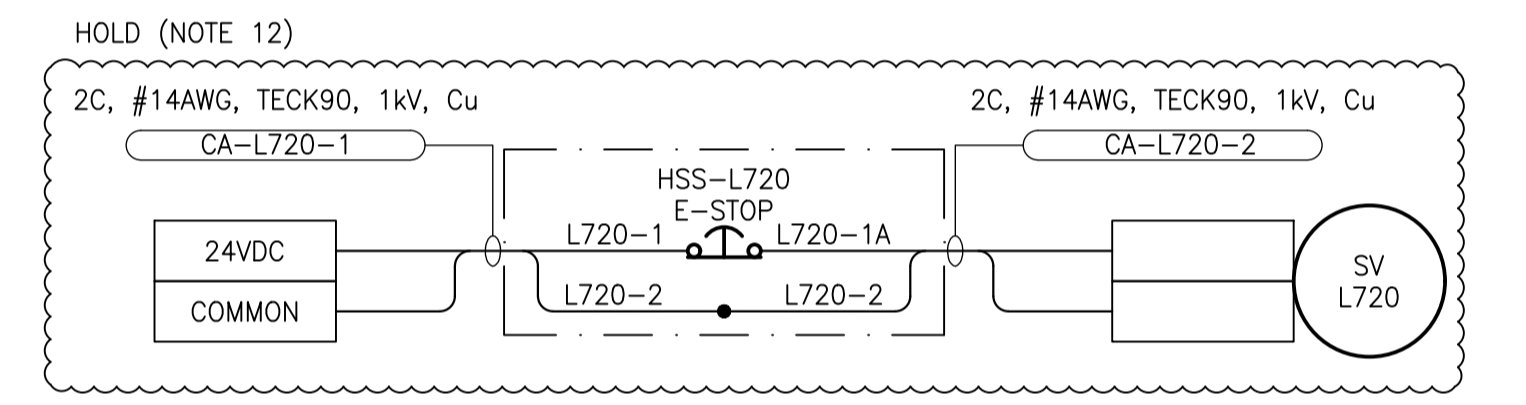

G PROPANE TANK/GENERATOR EMERGENCY STOP DETAIL
SCALE: N.T.S.

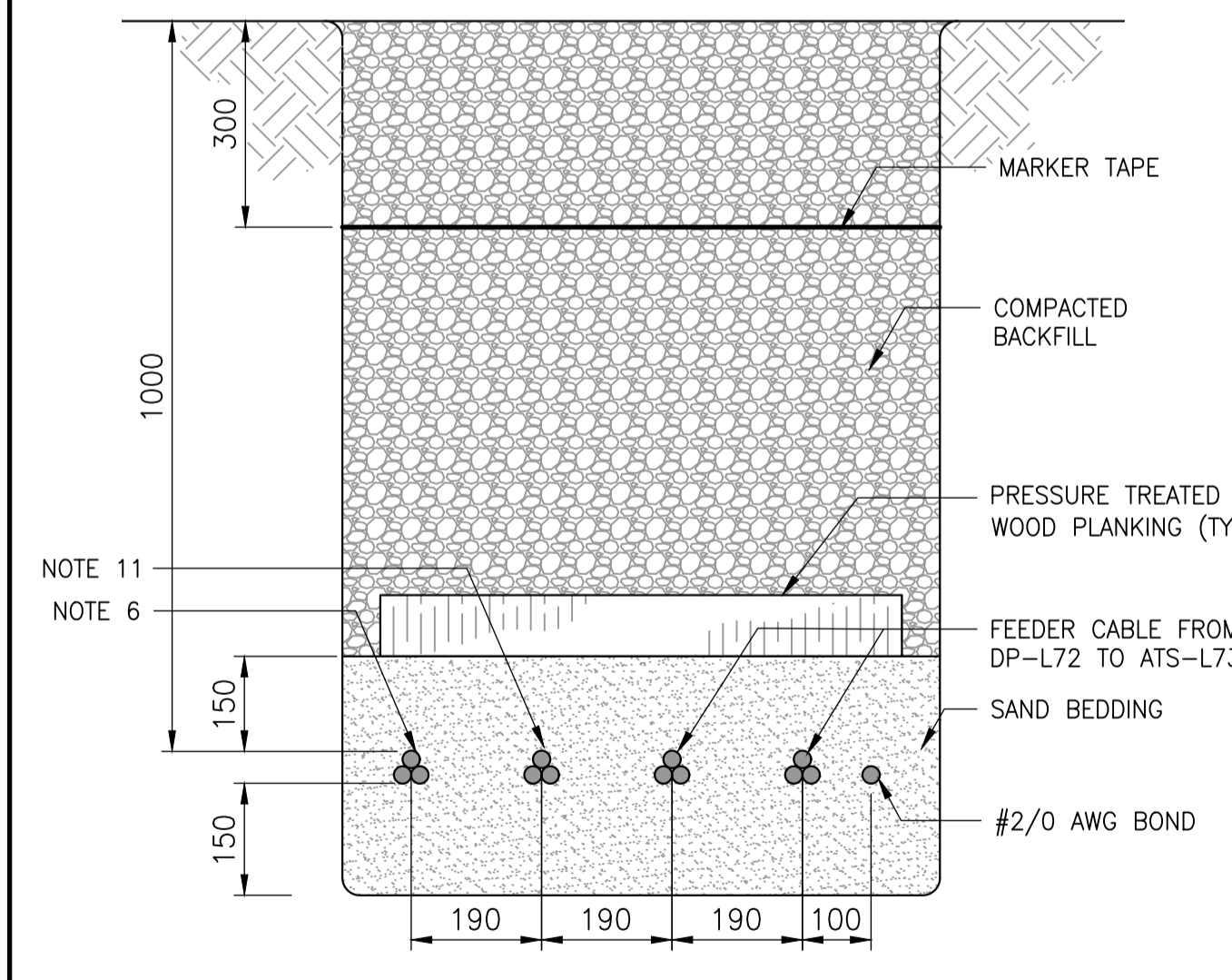

B CABLE TRENCH DETAIL
SCALE: N.T.S.

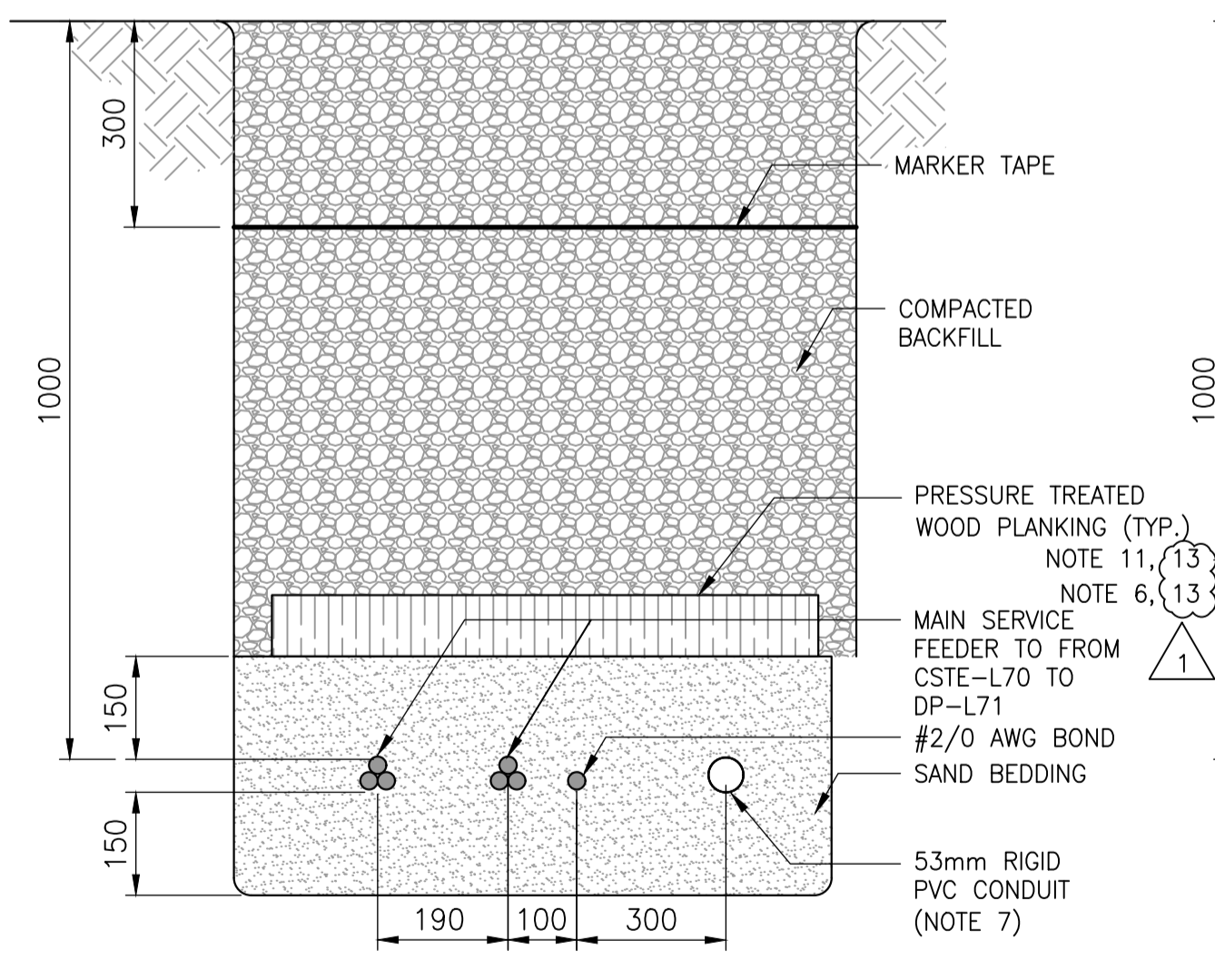

C CABLE TRENCH DETAIL
SCALE: N.T.S.

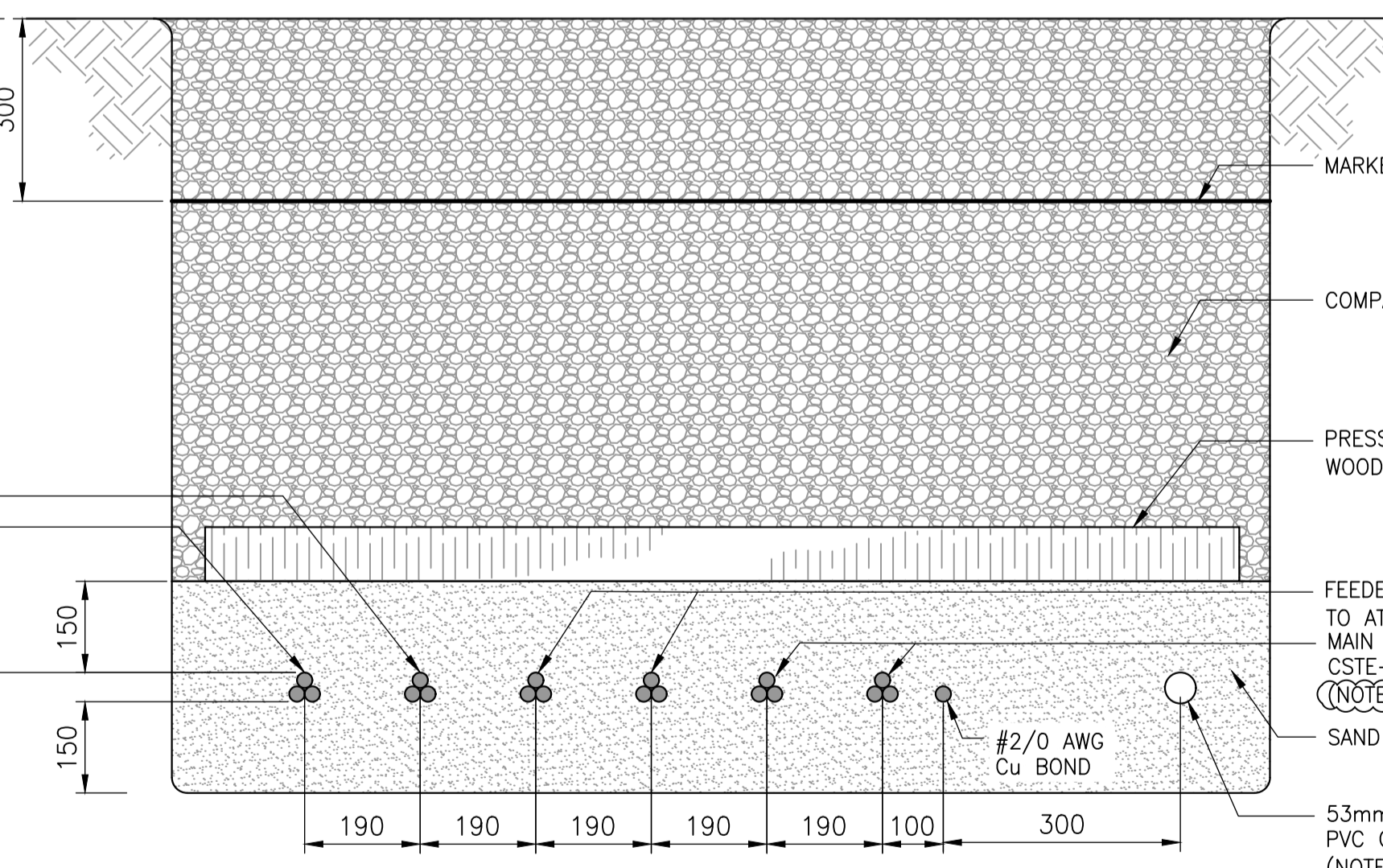

D CABLE TRENCH DETAIL
SCALE: N.T.S.

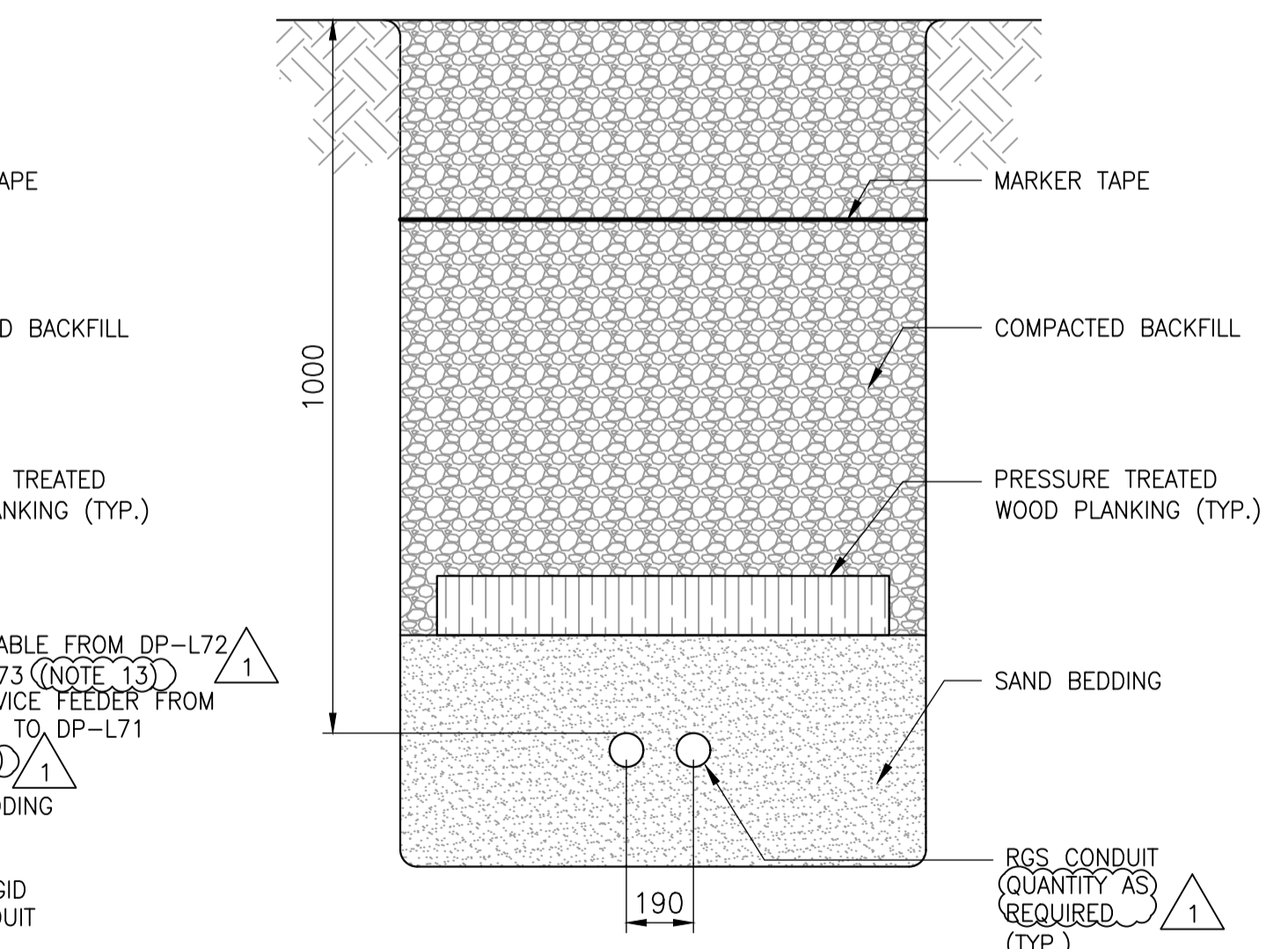

E CONDUIT TRENCH DETAIL (TYPICAL) (NOTE 3.4)
SCALE: N.T.S.

10		
9		
8		
7		
6		
5		
4		
3		
2	1-0241L-A0038-001	LOOP DRAWING - GEN-L72 & DP-L72 STATUSES
1	1-0241L-E0003-001	LIGHTING AND PLAN LAYOUT - MAIN FLOORS, VALVE CHAMBER AND WELLS AREA
NO.	DRAWING NUMBER	REFERENCE DRAWING TITLE
REFERENCE DRAWINGS		

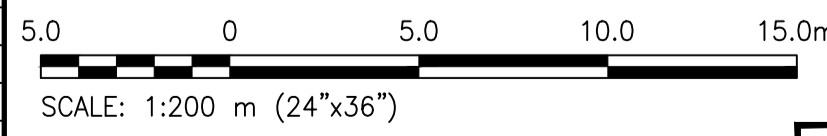

FOR TENDER ONLY
NOT TO BE USED FOR CONSTRUCTION

ENGINEERS
GEOSCIENTISTS
MANITOBA
Certificate of Authorization
KGS Group
No. 245

B.M. ELEV.			
CONSTRUCTION COMPLETION DATE: YYYY MM DD			
DESIGNED BY	C. ROBINSON	CHECKED BY	D. WILSON
DRAWN BY	D. SHABATAEV	APPROVED BY	D. WILSON
SCALE:	AS SHOWN	RELEASED FOR CONSTRUCTION	
DATE	2024 01 29	DATE	
PLOT DATE:	2024 07 12		
NO.	REVISIONS	DATE	BY
1	ISSUED FOR ADDENDUM 2	2024 07 12	DDW
0	ISSUED FOR TENDER	2024 06 20	DDW

KGS GROUP

ENGINEER'S SEAL

CONSULTANT DRAWING NUMBER
23-0107-009_E2.1

THE CITY OF WINNIPEG
WATER AND WASTE DEPARTMENT
ENGINEERING DIVISION

CONSTRUCTION OF A NEW WASTEWATER LIFT STATION - CENTREPORT SOUTH REGIONAL WATER AND WASTEWATER SERVICING PHASE 1A (CONTRACT 1A)
ELECTRICAL
SITE PLAN
OVERALL

CITY DRAWING NUMBER
1-0241L-E0002-001

SHEET 1 OF 1

