

**1 COURT LAYOUT DETAIL**  
Scale: 1:200

**NOTES:**  
 1. ALL LINES 50mm IN WIDTH  
 2. PICKLEBALL COURT LINES TO BE DIFFERENT COLOR THAN TENNIS AND BASKETBALL LINES.

TENNIS COURT AND NET SPACING C/W PICKLEBALL LINE PAINTING AS PER SCD-340

PICKLEBALL COURT LINE PAINTING AS PER SCD-342 (3 COURTS SPACED EVENLY OVER BASKETBALL COURT)

BASKETBALL COURT LINE AND POST SPACING AS PER SCD-320

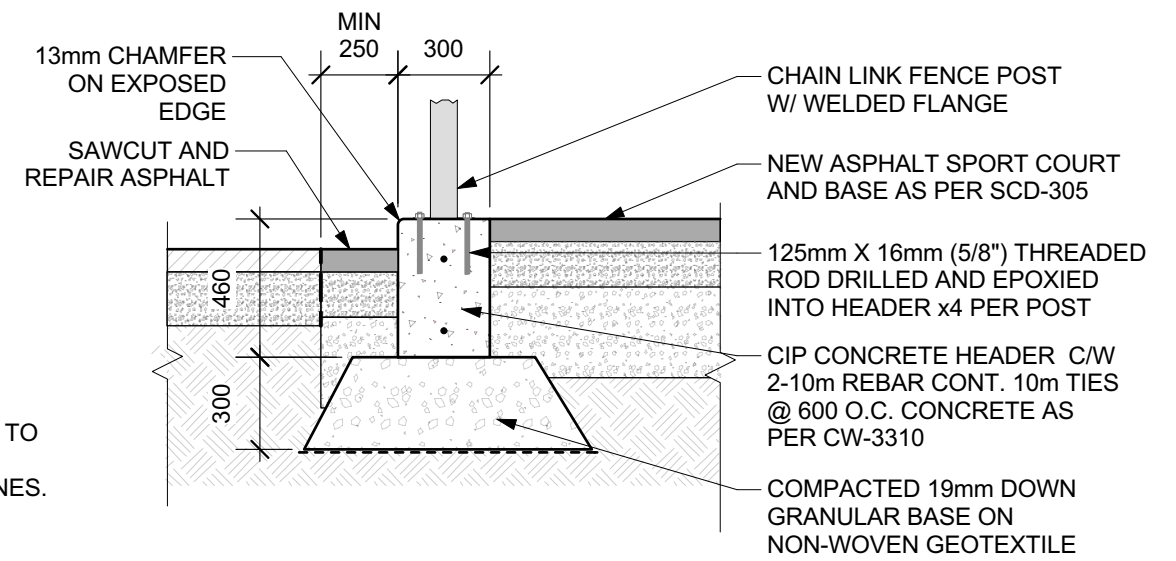

**2 CIP CONCRETE HEADER SECTION**  
Scale: 1:25

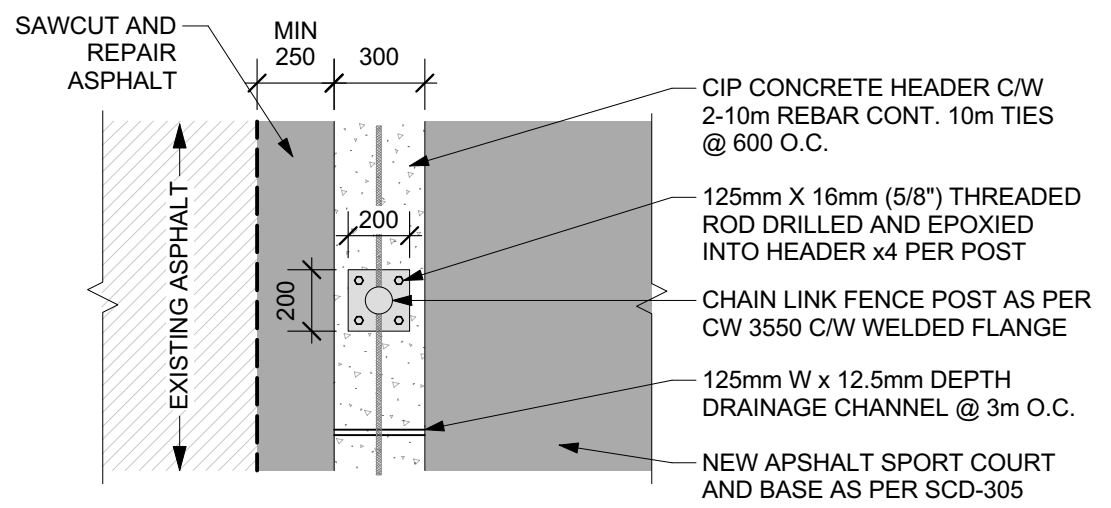

**3 CIP CONCRETE HEADER PLAN**  
Scale: 1:25

CONTRACTOR TO CONFIRM ALL DIMENSIONS AND REPORT ANY DISCREPANCIES TO CONTRACT ADMINISTRATOR PRIOR TO CONSTRUCTION. LOCATION OF UNDERGROUND STRUCTURES AS SHOWN ARE BASED ON THE BEST INFORMATION AVAILABLE BUT NO GUARANTEE IS GIVEN THAT ALL EXISTING UTILITIES ARE SHOWN OR THAT THE GIVEN LOCATIONS ARE EXACT. CONFIRMATION OF EXISTENCE AND EXACT LOCATION OF ALL SERVICES MUST BE OBTAINED FROM THE INDIVIDUAL UTILITIES BEFORE PROCEEDING WITH CONSTRUCTION.



THE CITY OF WINNIPEG  
 Planning, Property and Development Department  
 Planning and Land Use Division  
 Unit 15 - 30 Fort Street, Winnipeg, MB, (R3C 4X5)

DESIGNED BY	CHECKED BY	MANAGER, PARK AND OPEN SPACES	DATE
DRAWN BY MG	APPROVED BY		
HORIZ. SCALE As Shown	MANAGER, PLANNING AND LAND USE DIVISION		DATE
DATE March 2024			

DRAWING TITLE  
**Woodhaven CC**  
**Sport Court Redevelopment**  
**Concept Plan**

SITE ADDRESS 200 Glendale Blvd.

DRAWING NO.  
**W.4-D4**

BID OPPORTUNITY NO.  
**302-2024**