

SWALE SECTION
1:250

GENERAL NOTES

1. ALL WORK TO CONFORM TO CURRENT CITY OF WINNIPEG STANDARD CONSTRUCTION SPECIFICATIONS AND DETAILS UNLESS OTHERWISE NOTED.
2. DIMENSIONS ARE IN METERS UNLESS OTHERWISE NOTED.
3. DO NOT SCALE DRAWING.
4. PROTECT EXISTING TREES TO REMAIN, TYP.
5. HAND DIGGING REQUIRED AROUND UNDERGROUND ELECTRICAL LINES (BLUE DASHED LINE)

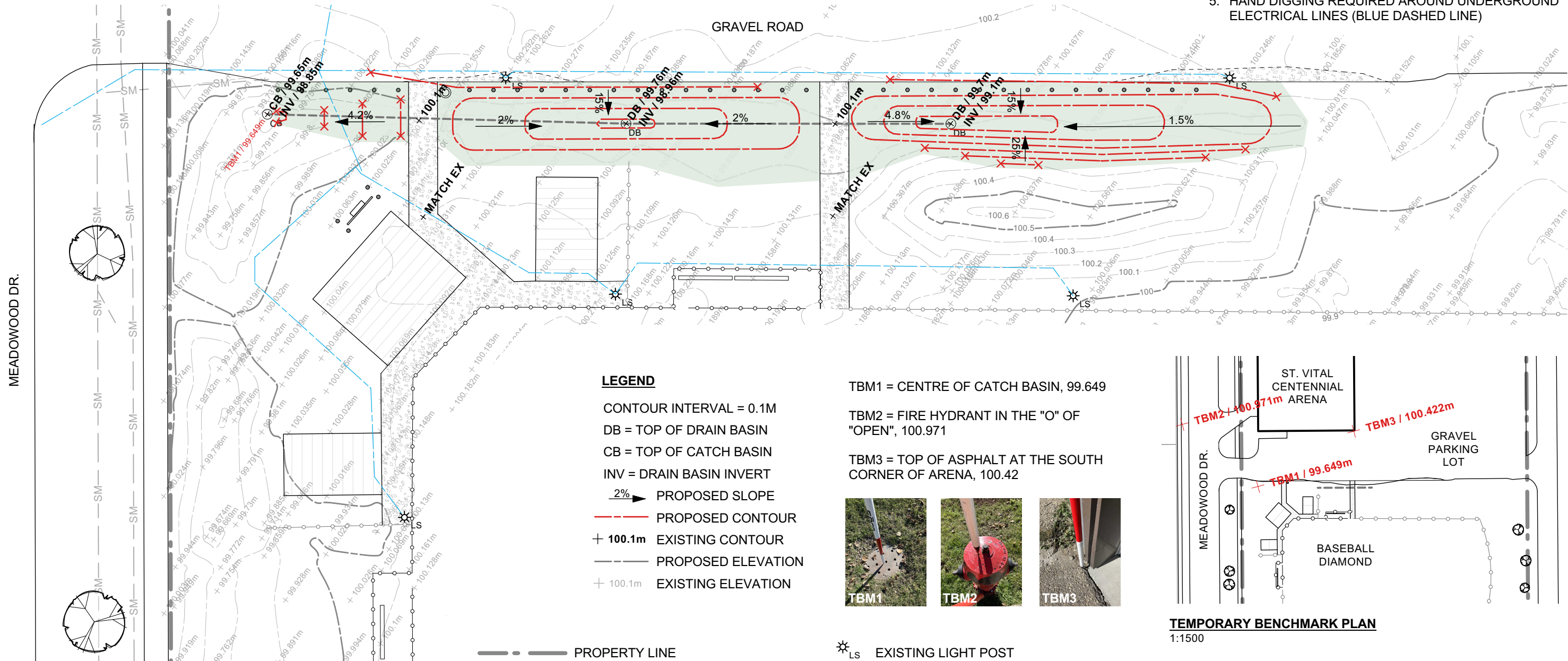

LEGEND

- CONTOUR INTERVAL = 0.1M
- DB = TOP OF DRAIN BASIN
- CB = TOP OF CATCH BASIN
- INV = DRAIN BASIN INVERT
- 2% → PROPOSED SLOPE
- PROPOSED CONTOUR
- + 100.1m EXISTING CONTOUR
- PROPOSED ELEVATION
- + 100.1m EXISTING ELEVATION

- TBM1 = CENTRE OF CATCH BASIN, 99.649
- TBM2 = FIRE HYDRANT IN THE "O" OF "OPEN", 100.971
- TBM3 = TOP OF ASPHALT AT THE SOUTH CORNER OF ARENA, 100.42

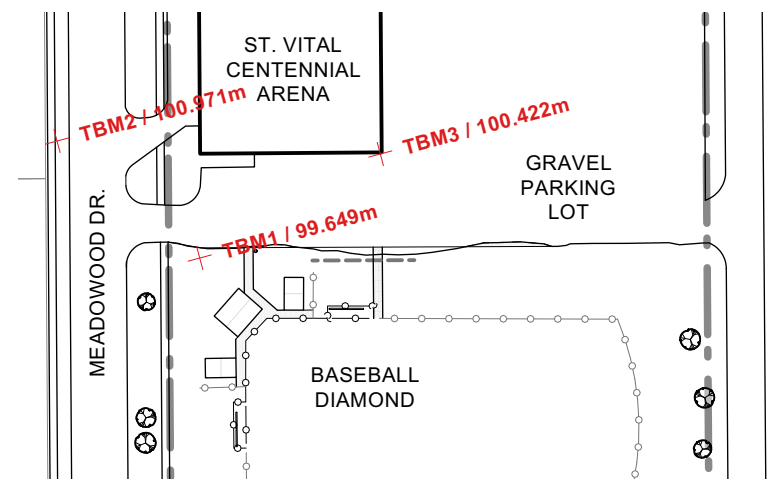

TEMPORARY BENCHMARK PLAN
1:1500

- PROPERTY LINE
- UNDERGROUND ELECTRICAL LINE
- SM --- SEWER LINE
- LS EXISTING LIGHT POST
- CB EXISTING CATCH BASIN
- EXISTING TREES

CONTRACTOR TO CONFIRM ALL DIMENSIONS AND REPORT ANY DISCREPANCIES TO CONTRACT ADMINISTRATOR PRIOR TO CONSTRUCTION. LOCATION OF UNDERGROUND STRUCTURES AS SHOWN ARE BASED ON THE BEST INFORMATION AVAILABLE BUT NO GUARANTEE IS GIVEN THAT ALL EXISTING UTILITIES ARE SHOWN OR THAT THE GIVEN LOCATIONS ARE EXACT. CONFIRMATION OF EXISTENCE AND EXACT LOCATION OF ALL SERVICES MUST BE OBTAINED FROM THE INDIVIDUAL UTILITIES BEFORE PROCEEDING WITH CONSTRUCTION.



THE CITY OF WINNIPEG
Planning, Property and Development Department
Planning and Land Use Division
Unit 15 - 30 Fort Street, Winnipeg, MB, (R3C 4X5)

DESIGNED BY	CHECKED BY	MANAGER, PARK AND OPEN SPACES	DATE
DRAWN BY MG	APPROVED BY		
HORIZ. SCALE 1:250	DATE	MANAGER, PLANNING AND LAND USE DIVISION	DATE
VERT. SCALE			
DATE March 2024			

DRAWING TITLE Riel Park Baseball Diamond Improvements Grading Plan	DRAWING NO. R.27-D3
SITE ADDRESS 580 St. Annes Road	BID OPPORTUNITY NO. 312-2024