

SITE RENOVATION PLAN LEGEND:

- NEW CONCRETE
- NEW GRAVEL
- NEW PAVER
- NEW ASPHALT
- NEW SOD

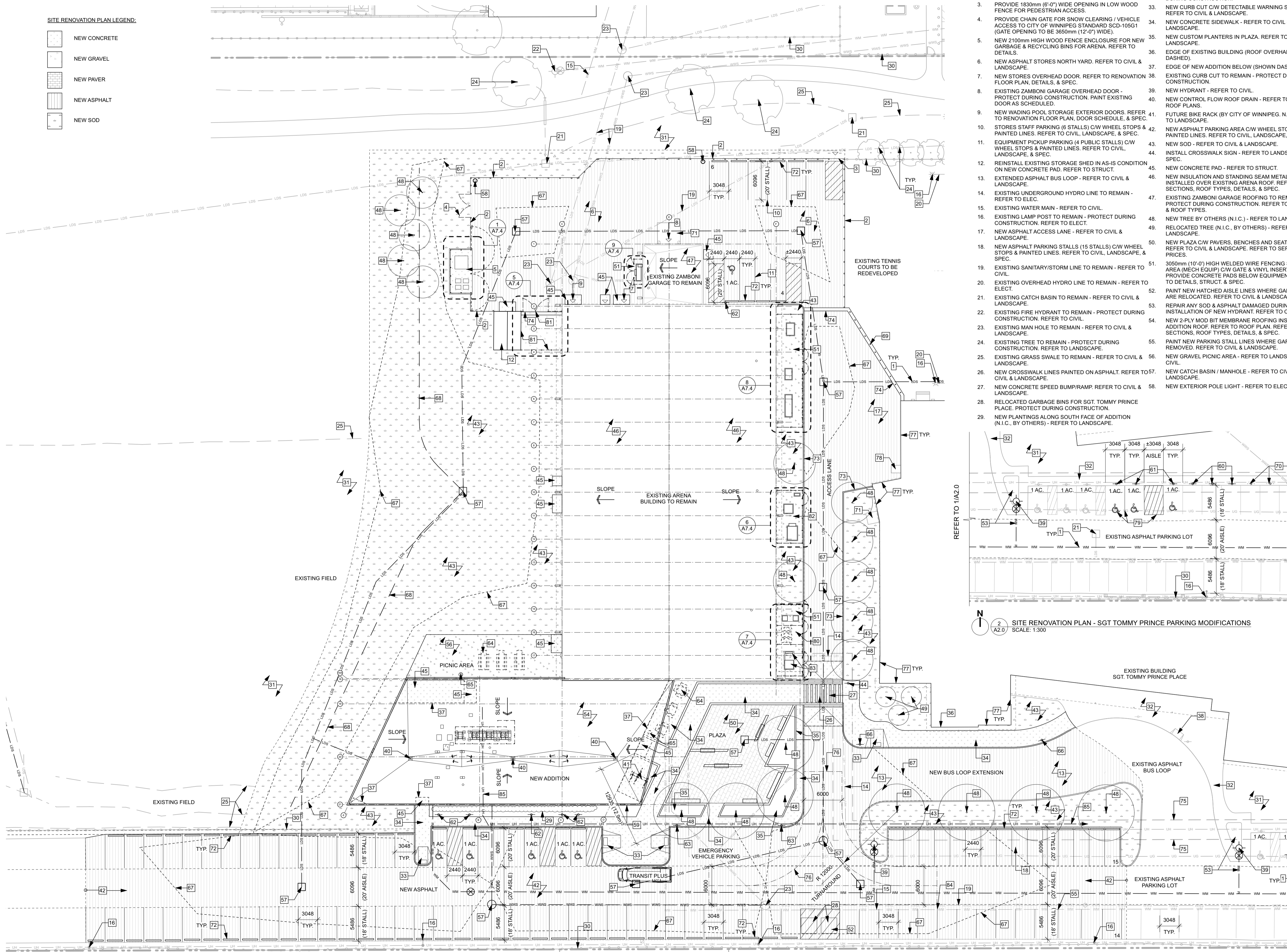

SITE RENOVATION PLAN NOTES (FOR DRAWINGS 1/A2.0 & 2/A2.0)

1. REPAIR ALL EXISTING SURFACES (SOD, ASPHALT, CONCRETE, ETC.) DAMAGED DURING INSTALLATION OF NEW SITE SERVICES TO MATCH EXISTING. REFER TO CIVIL.
2. NEW POST AND WOOD FENCING TO CITY OF WINNIPEG STANDARD SCD-105F (1220mm HIGH).
3. PROVIDE 1830mm (6'-0") WIDE OPENING IN LOW WOOD FENCE FOR PEDESTRIAN ACCESS.
4. PROVIDE CHAIN GATE FOR SNOW CLEARING / VEHICLE ACCESS TO CITY OF WINNIPEG STANDARD SCD-109G1 (GATE OPENING TO BE 3650mm (12'-0") WIDE).
5. NEW 2100mm HIGH WOOD FENCE ENCLOSURE FOR NEW GARBAGE & RECYCLING BINS FOR ARENA. REFER TO DETAILS.
6. NEW ASPHALT STORES NORTH YARD. REFER TO CIVIL & LANDSCAPE.
7. NEW STORES OVERHEAD DOOR. REFER TO RENOVATION FLOOR PLAN, DETAILS, & SPEC.
8. EXISTING ZAMBONI GARAGE OVERHEAD DOOR - PROTECT DURING CONSTRUCTION. PAINT EXISTING DOOR AS SCHEDULED.
9. NEW WADING POOL STORAGE EXTERIOR DOORS. REFER TO RENOVATION FLOOR PLAN, DOOR SCHEDULE, & SPEC.
10. STORES STAFF PARKING (8 STALLS) C/W WHEEL STOPS & PAINTED LINES. REFER TO CIVIL, LANDSCAPE, & SPEC.
11. EQUIPMENT PICKUP PARKING (4 PUBLIC STALLS) C/W WHEEL STOPS & PAINTED LINES. REFER TO CIVIL, LANDSCAPE, & SPEC.
12. REINSTALL EXISTING STORAGE SHED IN AS-IS CONDITION ON NEW CONCRETE PAD. REFER TO STRUCT.
13. EXTENDED ASPHALT BUS LOOP - REFER TO CIVIL & LANDSCAPE.
14. EXISTING UNDERGROUND HYDRO LINE TO REMAIN - REFER TO ELEC.
15. EXISTING WATER MAIN - REFER TO CIVIL.
16. EXISTING LAMP POST TO REMAIN - PROTECT DURING CONSTRUCTION. REFER TO ELEC.
17. NEW ASPHALT ACCESS LANE - REFER TO CIVIL & LANDSCAPE.
18. NEW ASPHALT PARKING STALLS (15 STALLS) C/W WHEEL STOPS & PAINTED LINES. REFER TO CIVIL, LANDSCAPE, & SPEC.
19. EXISTING SANITARY/STORM LINE TO REMAIN - REFER TO CIVIL.
20. EXISTING OVERHEAD HYDRO LINE TO REMAIN - REFER TO ELEC.
21. EXISTING CATCH BASIN TO REMAIN - REFER TO CIVIL & LANDSCAPE.
22. EXISTING FIRE HYDRANT TO REMAIN - PROTECT DURING CONSTRUCTION. REFER TO CIVIL.
23. EXISTING MAN HOLE TO REMAIN - REFER TO CIVIL & LANDSCAPE.
24. EXISTING TREE TO REMAIN - PROTECT DURING CONSTRUCTION. REFER TO LANDSCAPE.
25. EXISTING GRASS SWALE TO REMAIN - REFER TO CIVIL & LANDSCAPE.
26. NEW CROSSWALK LINES PAINTED ON ASPHALT. REFER TO CIVIL & LANDSCAPE.
27. NEW CONCRETE SPEED BUMP/RAMP. REFER TO CIVIL & LANDSCAPE.
28. RELOCATED GARBAGE BINS FOR SGT. TOMMY PRINCE PLAZA. PROTECT DURING CONSTRUCTION.
29. NEW PLANTINGS ALONG SOUTH FACE OF ADDITION (N.I.C., BY OTHERS) - REFER TO LANDSCAPE.
30. EXISTING FENCE TO REMAIN - PROTECT DURING CONSTRUCTION.
31. EXISTING SOD TO REMAIN - PROTECT DURING CONSTRUCTION.
32. EXISTING CONCRETE SIDEWALK TO REMAIN - PROTECT DURING CONSTRUCTION.
33. NEW CURB CUT C/W DETECTABLE WARNING STRIP - REFER TO CIVIL & LANDSCAPE.
34. NEW CONCRETE SIDEWALK - REFER TO CIVIL & LANDSCAPE.
35. NEW CUSTOM PLANTERS IN PLAZA. REFER TO LANDSCAPE.
36. EDGE OF EXISTING BUILDING (ROOF OVERHANG SHOWN DASHED).
37. EDGE OF NEW ADDITION BELOW (SHOWN DASHED).
38. EXISTING CURB CUT TO REMAIN - PROTECT DURING CONSTRUCTION.
39. NEW HYDRANT - REFER TO CIVIL.
40. NEW CONTROL FLOW ROOF DRAIN - REFER TO MECH & ROOF PLANS.
41. FUTURE BIKE RACK (BY CITY OF WINNIPEG, N.I.C.) REFER TO LANDSCAPE.
42. NEW ASPHALT PARKING AREA C/W WHEEL STOPS & PAINTED LINES. REFER TO CIVIL, LANDSCAPE, & SPEC.
43. NEW SOD - REFER TO CIVIL & LANDSCAPE.
44. INSTALL CROSSWALK SIGN - REFER TO LANDSCAPE & SPEC.
45. NEW CONCRETE PAD - REFER TO STRUCT.
46. NEW INSULATION AND STANDING SEAM METAL ROOFING INSTALLED OVER EXISTING ARENA ROOF. REFER TO WALL SECTIONS, ROOF TYPES, DETAILS, & SPEC.
47. EXISTING ZAMBONI GARAGE ROOFING TO REMAIN. PROTECT DURING CONSTRUCTION. REFER TO SECTIONS & ROOF TYPES.
48. NEW TREE BY OTHERS (N.I.C.) - REFER TO LANDSCAPE.
49. RELOCATED TREE (N.I.C., BY OTHERS) - REFER TO LANDSCAPE.
50. NEW PLAZA C/W PAVERS, BENCHES AND SEATING - REFER TO CIVIL & LANDSCAPE. REFER TO SEPARATE PRICES.
51. 3050mm (10'-0") HIGH WELDED WIRE FENCING STORAGE AREA C/W GATE & VINYL INSERTS. PROVIDE CONCRETE PADS BELOW EQUIPMENT. REFER TO DETAILS, STRUCT, & SPEC.
52. PAINT NEW HATCHED AISLE LINES WHERE GARBAGE BINS ARE RELOCATED. REFER TO CIVIL & LANDSCAPE.
53. REPAIR ANY SOD & ASPHALT DAMAGED DURING INSTALLATION OF NEW HYDRANT. REFER TO CIVIL.
54. NEW 2-PLY MOD BIT MEMBRANE ROOFING INSTALLED AT ADDITION ROOF. REFER TO ROOF PLAN. REFER TO WALL SECTIONS, ROOF TYPES, DETAILS, & SPEC.
55. PAINT NEW PARKING STALL LINES WHERE GARBAGE BINS REMOVED. REFER TO CIVIL & LANDSCAPE.
56. NEW GRAVEL PICNIC AREA - REFER TO LANDSCAPE & CIVIL.
57. NEW CATCH BASIN / MANHOLE - REFER TO CIVIL & LANDSCAPE.
58. NEW EXTERIOR POLE LIGHT - REFER TO ELECTRICAL.
59. APPROX. LOCATION OF FIRE DEPARTMENT CONNECTION - REFER TO MECH & CIVIL.
60. INSTALL RELOCATED CAR POOL SIGNS. PROTECT DURING CONSTRUCTION.
61. INSTALL RELOCATED ACCESSIBLE PARKING SIGNS. PROTECT DURING CONSTRUCTION.
62. INSTALL NEW ACCESSIBLE PARKING SIGNS. REFER TO LANDSCAPE AND SPEC.
63. INSTALL FIRE LANE PARKING SIGNS. REFER TO LANDSCAPE & SPEC.
64. NEW PICNIC TABLES (N.I.C., BY OTHERS). REFER TO LANDSCAPE.
65. WASTE RECEPTACLE - REFER TO LANDSCAPE & SPEC.
66. INSTALL DROP OFF/PICK UP SIGNS - REFER TO LANDSCAPE & SPEC.
67. NEW PONDING AREA LIMITS - REFER TO CIVIL.
68. NEW GRASS SWALE - REFER TO CIVIL & LANDSCAPE.
69. PROVIDE SAFETY BOLLARDS INCLUDING 1 COLLAPSIBLE BOLLARD - REFER TO LANDSCAPE.
70. FUTURE PEG-CITY CAR CO-OP STALLS (SIGNAGE BY OTHERS, N.I.C.)
71. EXISTING CONCRETE PAD TO REMAIN - PROTECT DURING CONSTRUCTION.
72. NEW PRECAST CONC. WHEELSTOP - REFER TO SPEC.
73. NEW PINNED CONCRETE CURB - REFER TO CIVIL & LANDSCAPE.
74. CONCRETE CURB - REFER TO LANDSCAPE.
75. UTILITY EASEMENT - REFER TO CIVIL & SURVEY.
76. FIRE DEPARTMENT TURNAROUND (6m WIDE, 12m CENTERLINE RADIUS).
77. PROVIDE PARINGS AT EXISTING BUILDING FOUNDATION AS REQ'D WHERE EXISTING GRADE HAS BEEN LOWERED & EXPOSED INSULATION IS PRESENT.
78. EXISTING CRAWLSPACE ACCESS DOORS TO REMAIN - PROTECT DURING CONSTRUCTION.
79. PAINT NEW STALL LINES, UNIVERSAL SYMBOLS, AND AISLES WHERE ACCESSIBLE STALLS ARE RELOCATED. REFER TO LANDSCAPE & CIVIL.
80. 3050mm (10'-0") HIGH WELDED WIRE FENCING STORAGE AREA (WASAC BBO STORAGE) C/W GATE & VINYL INSERTS. PROVIDE GRAVEL WITHIN STORAGE AREA. REFER TO DETAILS & SPEC.
81. 3050mm (10'-0") HIGH WELDED WIRE FENCING STORAGE AREA C/W GATE & VINYL INSERTS. PROVIDE GRAVEL WITHIN STORAGE AREA. REFER TO DETAILS & SPEC.
82. 3050mm (10'-0") HIGH WELDED WIRE FENCING STORAGE AREA (TRANSFORMER & MECH EQUIP) C/W GATE & VINYL INSERTS. PROVIDE GRAVEL WITHIN STORAGE AREA. PROVIDE CONCRETE PADS BELOW EQUIPMENT. REFER TO DETAILS, STRUCT, & SPEC.
83. 3050mm (10'-0") HIGH WELDED WIRE FENCING STORAGE AREA (TRANSFORMER & CSTE) C/W GATE & VINYL INSERTS. PROVIDE GRAVEL WITHIN STORAGE AREA. PROVIDE NEW CONCRETE PAD BELOW RELOCATED TRANSFORMER & FIBREGLASS PAD BELOW CSTE. REFER TO DETAILS, STRUCT, & SPEC.
84. NEW ASPHALT PARKING STALLS (14 STALLS) C/W PAINTED LINES. REFER TO CIVIL, LANDSCAPE, & SPEC.
85. APPROX. LOCATION OF NEW UNDERGROUND COMMUNICATIONS LINE/CONDUIT. LINE TO RUN TO PEDESTAL ON SINCLAIR STREET. COORDINATE FINAL LOCATION WITH UTILITY PROVIDER & G.C. REFER TO ELEC. REPAIR ALL EXISTING SURFACES (SOD, ASPHALT, CONCRETE, ETC.) DAMAGED DURING INSTALLATION.

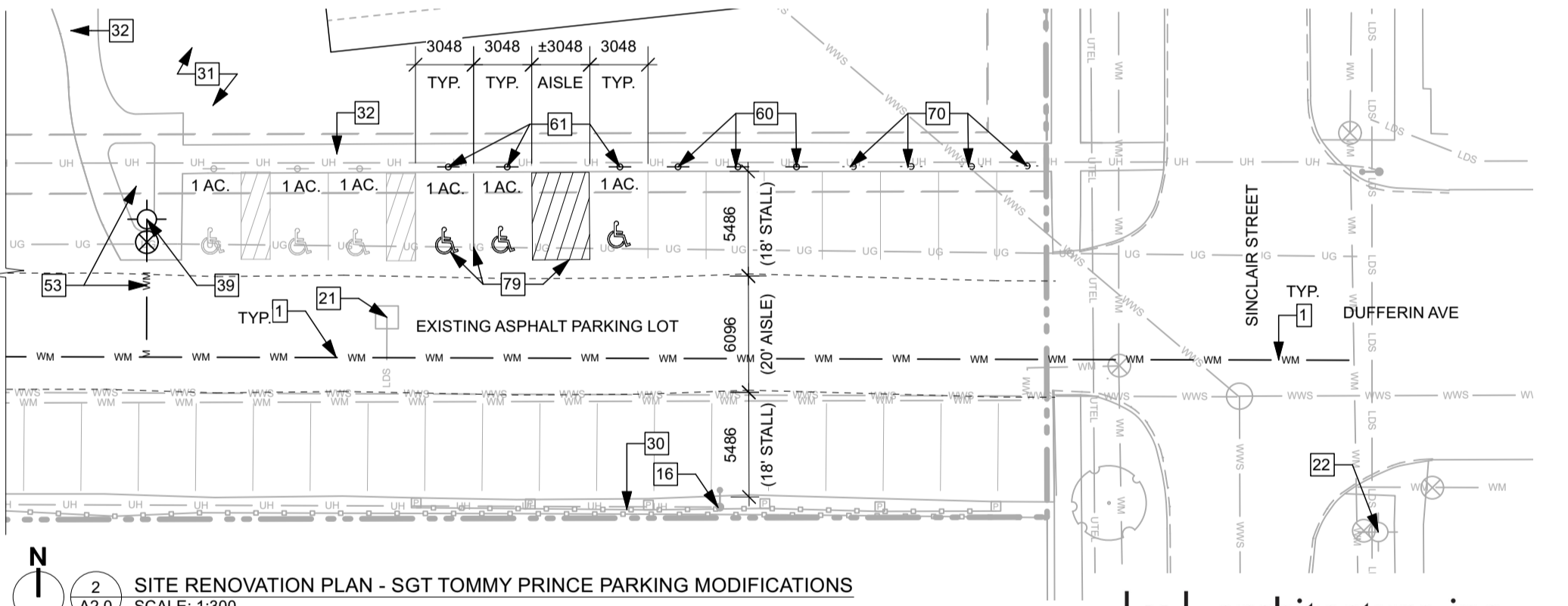

- NOTES:
59. APPROX. LOCATION OF FIRE DEPARTMENT CONNECTION - REFER TO MECH & CIVIL.
 60. INSTALL RELOCATED CAR POOL SIGNS. PROTECT DURING CONSTRUCTION.
 61. INSTALL RELOCATED ACCESSIBLE PARKING SIGNS. PROTECT DURING CONSTRUCTION.
 62. INSTALL NEW ACCESSIBLE PARKING SIGNS. REFER TO LANDSCAPE AND SPEC.
 63. INSTALL FIRE LANE PARKING SIGNS. REFER TO LANDSCAPE & SPEC.
 64. NEW PICNIC TABLES (N.I.C., BY OTHERS). REFER TO LANDSCAPE.
 65. WASTE RECEPTACLE - REFER TO LANDSCAPE & SPEC.
 66. INSTALL DROP OFF/PICK UP SIGNS - REFER TO LANDSCAPE & SPEC.
 67. NEW PONDING AREA LIMITS - REFER TO CIVIL.
 68. NEW GRASS SWALE - REFER TO CIVIL & LANDSCAPE.
 69. PROVIDE SAFETY BOLLARDS INCLUDING 1 COLLAPSIBLE BOLLARD - REFER TO LANDSCAPE.
 70. FUTURE PEG-CITY CAR CO-OP STALLS (SIGNAGE BY OTHERS, N.I.C.)
 71. EXISTING CONCRETE PAD TO REMAIN - PROTECT DURING CONSTRUCTION.
 72. NEW PRECAST CONC. WHEELSTOP - REFER TO SPEC.
 73. NEW PINNED CONCRETE CURB - REFER TO CIVIL & LANDSCAPE.
 74. CONCRETE CURB - REFER TO LANDSCAPE.
 75. UTILITY EASEMENT - REFER TO CIVIL & SURVEY.
 76. FIRE DEPARTMENT TURNAROUND (6m WIDE, 12m CENTERLINE RADIUS).
 77. PROVIDE PARINGS AT EXISTING BUILDING FOUNDATION AS REQ'D WHERE EXISTING GRADE HAS BEEN LOWERED & EXPOSED INSULATION IS PRESENT.
 78. EXISTING CRAWLSPACE ACCESS DOORS TO REMAIN - PROTECT DURING CONSTRUCTION.
 79. PAINT NEW STALL LINES, UNIVERSAL SYMBOLS, AND AISLES WHERE ACCESSIBLE STALLS ARE RELOCATED. REFER TO LANDSCAPE & CIVIL.
 80. 3050mm (10'-0") HIGH WELDED WIRE FENCING STORAGE AREA (WASAC BBO STORAGE) C/W GATE & VINYL INSERTS. PROVIDE GRAVEL WITHIN STORAGE AREA. REFER TO DETAILS & SPEC.
 81. 3050mm (10'-0") HIGH WELDED WIRE FENCING STORAGE AREA C/W GATE & VINYL INSERTS. PROVIDE GRAVEL WITHIN STORAGE AREA. REFER TO DETAILS & SPEC.
 82. 3050mm (10'-0") HIGH WELDED WIRE FENCING STORAGE AREA (TRANSFORMER & MECH EQUIP) C/W GATE & VINYL INSERTS. PROVIDE GRAVEL WITHIN STORAGE AREA. PROVIDE CONCRETE PADS BELOW EQUIPMENT. REFER TO DETAILS, STRUCT, & SPEC.
 83. 3050mm (10'-0") HIGH WELDED WIRE FENCING STORAGE AREA (TRANSFORMER & CSTE) C/W GATE & VINYL INSERTS. PROVIDE GRAVEL WITHIN STORAGE AREA. PROVIDE NEW CONCRETE PAD BELOW RELOCATED TRANSFORMER & FIBREGLASS PAD BELOW CSTE. REFER TO DETAILS, STRUCT, & SPEC.
 84. NEW ASPHALT PARKING STALLS (14 STALLS) C/W PAINTED LINES. REFER TO CIVIL, LANDSCAPE, & SPEC.
 85. APPROX. LOCATION OF NEW UNDERGROUND COMMUNICATIONS LINE/CONDUIT. LINE TO RUN TO PEDESTAL ON SINCLAIR STREET. COORDINATE FINAL LOCATION WITH UTILITY PROVIDER & G.C. REFER TO ELEC. REPAIR ALL EXISTING SURFACES (SOD, ASPHALT, CONCRETE, ETC.) DAMAGED DURING INSTALLATION.

architecture inc.

No.	REVISION/DESCRIPTION	BY	DATE

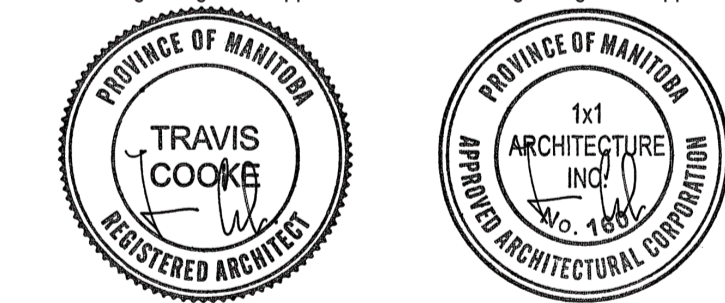

DATE	USER	APPROVAL	DATE	USER	APPROVAL
2024.12.18	HC		2024.12.18	TC	
2024.12.18					

THE CITY OF WINNIPEG
ASSETS AND PROJECT MANAGEMENT
DEPARTMENT
MUNICIPAL ACCOMMODATIONS
DIVISION

PROJECT
**REDEVELOPMENT OF THE
OLD EXHIBITION ARENA
ISSUED FOR CONSTRUCTION**
80 SINCLAIR STREET

SHEET TITLE
SITE RENOVATION PLAN

SCALE	PROJECT No:	SHEET No:
AS SHOWN	2020-136	A2.0

DRAWING SHEET SIZE: A1 (841mm x 594mm) PLOT 1:1

1 SITE RENOVATION & ROOF PLAN
A2.0 SCALE: 1:300