

SPECIFIC ELECTRICAL NOTES

- 1 EXISTING PARKING LOT LIGHTING TO REMAIN. REFEED EXISTING LIGHTING TO REMAIN AS REQUIRED. PROVIDE NEW 15A-1P CIRCUIT BREAKER IN NEAREST AVAILABLE PANEL. MAX WATTAGE PER CIRCUIT TO BE 900W.
- 2 APPROXIMATE LOCATION OF NEW PAD MOUNTED OSTE. COORDINATE EXACT LOCATION WITH MB HYDRO PREFERRED LOCATION PRIOR TO ROUGH-IN.
- 3 APPROXIMATE LOCATION OF HYDRO TRANSFORMER. COORDINATE FINAL LOCATION WITH MB HYDRO. COORDINATE FINAL LOCATION WITH ARCHITECTURAL, MECHANICAL UNITS AND FENCING.
- 4 LOWER/REPAIR EXISTING EXPOSED CONDUIT. COORDINATE SITE WORK WITH G.C. PRIOR TO COMMENCEMENT OF WORK. COORDINATE FINAL LOCATION WITH ARCHITECTURAL, MECHANICAL UNITS AND FENCING.
- 5 PROVIDE A 2" PVC CONDUIT BETWEEN DEMARCATION LOCATION IN ELEC./IT 118 AND COMMUNICATIONS PEDESTAL LOCATED ON SINCLAIR ST. COORDINATE SITE WORK WITH BELL/MTS.

ELECTRICAL SPECIAL-PURPOSE NOTES

- D1 EXISTING LAMP STANDARD TO BE DEMOLISHED IN ITS ENTIRETY TO ALLOW FOR NEW SITE WORK. REFEED EXISTING LIGHTING TO REMAIN AS REQUIRED. PROVIDE NEW 15A-1P CIRCUIT BREAKER IN NEAREST AVAILABLE PANEL. MAX WATTAGE PER CIRCUIT TO BE 900W.
- D2 DISCONNECT AND REMOVE EXISTING OVERHEAD MTS COMMUNICATIONS LINK FROM ADJACENT BUILDING.

SITE LUMINAIRE SCHEDULE				
TYPE	DESCRIPTION	MOUNTING	CATALOG NUMBER	LAMPS
S1A	POLE MOUNTED LUMINAIRE	20' POLE MOUNTED PRAIRIE POLE 4RD-20-SW-0 (FINISH TO MATCH LUMINAIRE)	LITHONIA LIGHTING - DSX1 LED P1 40K 80CRI BLC4 MVOLT RPA NLTAIR2 PIRHN EGSR DBLXD	51W LED
S1B	POLE MOUNTED LUMINAIRE	20' POLE MOUNTED PRAIRIE POLE 4RD-20-SW-0 (FINISH TO MATCH LUMINAIRE)	LITHONIA LIGHTING - DSX1 LED P1 40K 80CRI LCCO MVOLT RPA NLTAIR2 PIRHN GSR DBLXD C/W	51W LED

LUMINAIRE SCHEDULE NOTES:
 1. UNLESS OTHERWISE NOTED, ALL LEDS TO BE 4000K & 80 CRI.
 2. PROVIDE PHOTOCELL CONTROL FOR ALL OUTDOOR LUMINAIRES.
 3. FOR FURTHER LUMINAIRE SCHEDULE DETAILS CONTACT ANDY KENNETT AT RD SALES. (Ph: (204)480-0679 E: akennett@rdsales.ca)

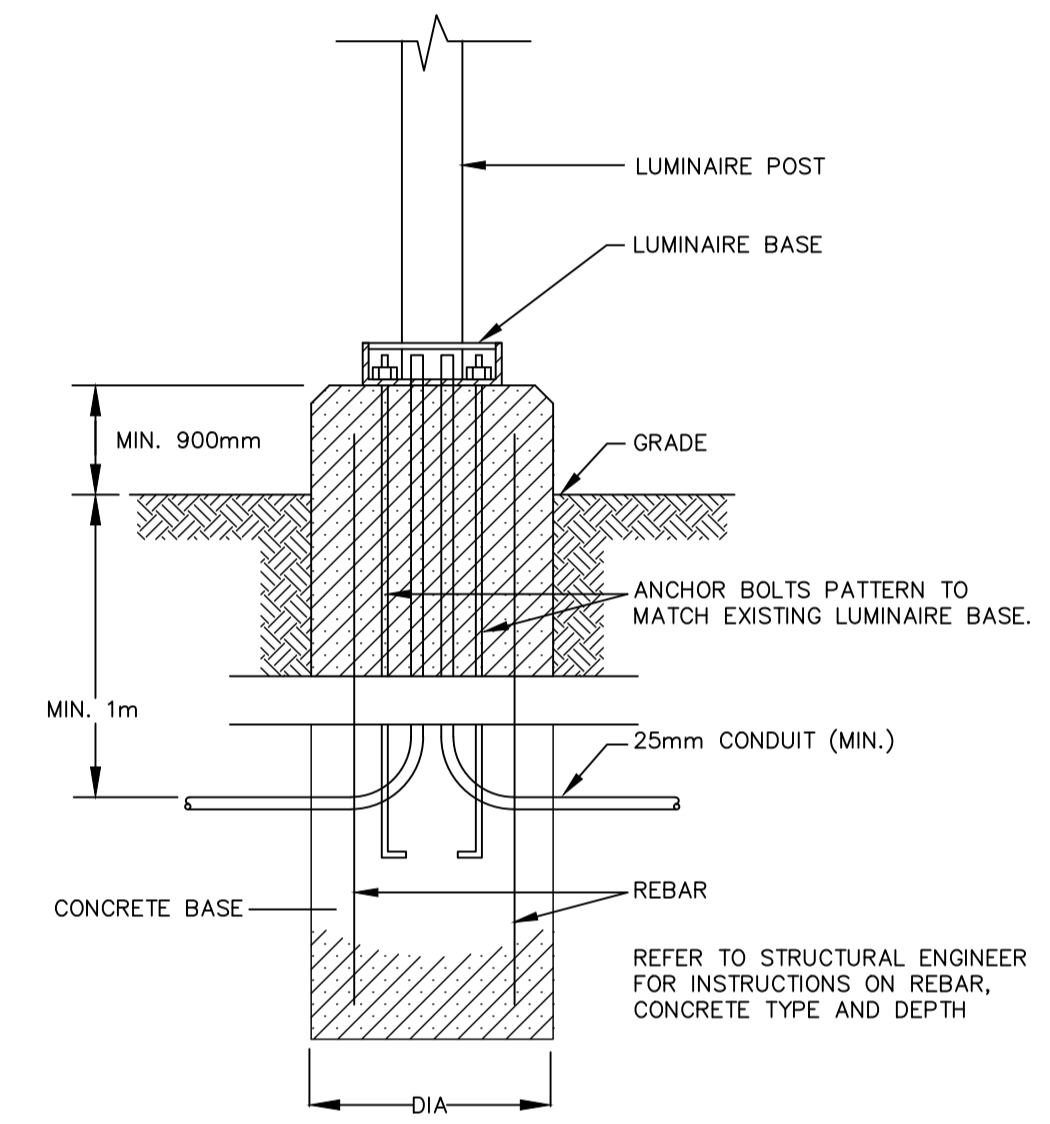

LUMINAIRE BASE DETAIL
 N.T.S.

NOTE: CONCRETE DIMENSIONS AND TYPE TO BE SPECIFIED BY STRUCTURAL ENGINEER AND BASED ON AVAILABLE SOIL CONDITIONS.

NOVA 3 ENGINEERING LTD.
 PROFESSIONAL ENGINEERS
 201-120 FORT STREET TEL: (204) 943-6142
 WINNIPEG, MANITOBA R3C 1C7 FAX: (204) 942-1276
 WWW.NOVA3.CA JN: 41-193
 THIS DRAWING IS THE EXCLUSIVE PROPERTY OF NOVA 3 ENGINEERING LTD. AND MAY ONLY BE REPRODUCED WITH THE WRITTEN PERMISSION OF NOVA 3 ENGINEERING LTD.
 THE CONCEPT AND DESIGN INCORPORATED INTO THIS DRAWING ARE BASED ON INFORMATION PROVIDED BY THE CLIENT AND OTHER RELATED SOURCES. PROFESSIONAL ENGINEER ACCEPTS NO RESPONSIBILITY FOR DRAWING AND DESIGN UNLESS DRAWING IS ACCOMPANIED BY ORIGINAL SEALED LETTER OF INTENT OR EQUIVALENT ACCEPTABLE FACSIMILE. PROFESSIONAL ENGINEER ACCEPTS NO RESPONSIBILITY FOR FINAL INSTALLATION CONFORMANCE WITHOUT ORIGINAL SEALED CERTIFICATE OF INSPECTION OR EQUIVALENT ACCEPTABLE FACSIMILE.

0	ISSUED FOR CONSTRUCTION	AM	2024.12.12
No.	REVISION/DESCRIPTION	BY	DATE



DRAWN	CHECKED	DESIGNED	APPROVED
DATE	DATE	DATE	DATE
AM	DZ	AM	AM
2024.12.12	2024.12.12		

THE CITY OF WINNIPEG
 ASSETS AND PROJECT MANAGEMENT
 DEPARTMENT
 MUNICIPAL ACCOMMODATIONS DIVISION
 3-65 GARRY STREET, R3C 4K4

PROJECT
**REDEVELOPMENT OF THE OLD
 EXHIBITION ARENA**

80 SINCLAIR STREET
 SHEET TITLE

**ELECTRICAL
 SITE PLAN**

SCALE PROJECT No: SHEET No:
 AS SHOWN 2020-136 E1.1

