

NOTES:

ROOF DRAINAGE CALCULATIONS

ROOF DRAIN CALCULATIONS/DESIGN TO MEET NBC 2020 - APPENDIX C - CLIMATIC AND SEISMIC INFORMATION FOR BUILDING DESIGN IN CANADA, AND NPC - 2020 - NATIONAL PLUMBING CODE, AND MBC - MANITOBA PLUMBING CODE.

ALL CONTROL FLOW ROOF DRAIN AREAS SHALL BE EQUIPPED WITH SCUPPERS SIZED, LOCATED AND INSTALLED PER ARCHITECTURAL DRAWINGS AND SPECIFICATIONS; SCUPPERS INSTALLED BY GENERAL CONTRACTOR. ROOF AND SCUPPERS SHALL BE DESIGNED TO ENSURE THE MAXIMUM DEPTH OF CONTROLLED WATER IS LIMITED TO 6" (150MM) PER NPC-2020, SECTION 2.4.10.4.

ROOF DRAIN SELECTION AND PERFORMANCE BASED ON MAXIMUM 6" ROOF SLOPE, SIZED PER MANUFACTURERS DATA.

CONTROL FLOW ROOF AREA #1: 9,706 SQ.FT. (901.8 SQ.M.)

3 - 3" DRAINS AT 3240 SQ.FT. (301SQ.M.) EACH
1 NOTCH PER DRAIN
5.0 HR DRAIN DOWN TIME
20.5 GPM (77.6 LPM) EACH
4.1" (104.1MM) WATER DEPTH

DRAWING NOTES

- CONTROL FLOW ROOF DRAINS; EXTEND INSULATED R/WL DOWN THRU TO U/S OF SLAB. REFER TO MAIN FLOOR PLAN FOR CONTINUATION.
- STAND MOUNT VARIABLE REFRIGERANT FLOW HEAT PUMPS; ROUTE INSULATED/ALUMINUM JACKETED REFRIGERANT PIPING FROM HEAT PUMPS ACROSS AND DOWN THRU ROOF WITHIN PITCH BOX TO FAN COILS. STAND TO BE MINIMUM 600MM ABOVE ROOF LEVEL TO ALLOW FOR CONDENSATE DRAINAGE/BUILD UP DURING WINTER MONTHS. REFER TO VRF SCHEMATIC. REFRIGERANT PIPING SHALL NOT BE RUN BENEATH THE EQUIPMENT HEAT PUMPS.
- ROOF MOUNT AIR COOLED CONDENSING UNIT AFFIXED TO A PERMANENT BASE, PROVIDE C-PORT/JUNISTRUT ROOF SUPPORTS. ROUTE INSULATED/ALUMINUM JACKETED REFRIGERATION PIPING DOWN WITHIN PITCH BOX TO RESPECTIVE HRV DX COOLING COIL.
- ROOF MOUNTED IT ROOM AIR COOLED CONDENSING UNITS ON STAND; ROUTE INSULATED/ALUMINUM JACKETED REFRIGERATION PIPING DOWN WITHIN PITCH BOX TO RESPECTIVE INDOOR AIR CONDITIONING UNIT.
- INTAKE/EXHAUST HOODS C/W BIRDSCREENS UP THRU ROOF CURB, MINIMUM 30" ABOVE FINISHED ROOF LEVEL.

FILE NAME:

DATE:

SHEET TITLE:

PROJECT No.:

ADDRESS:

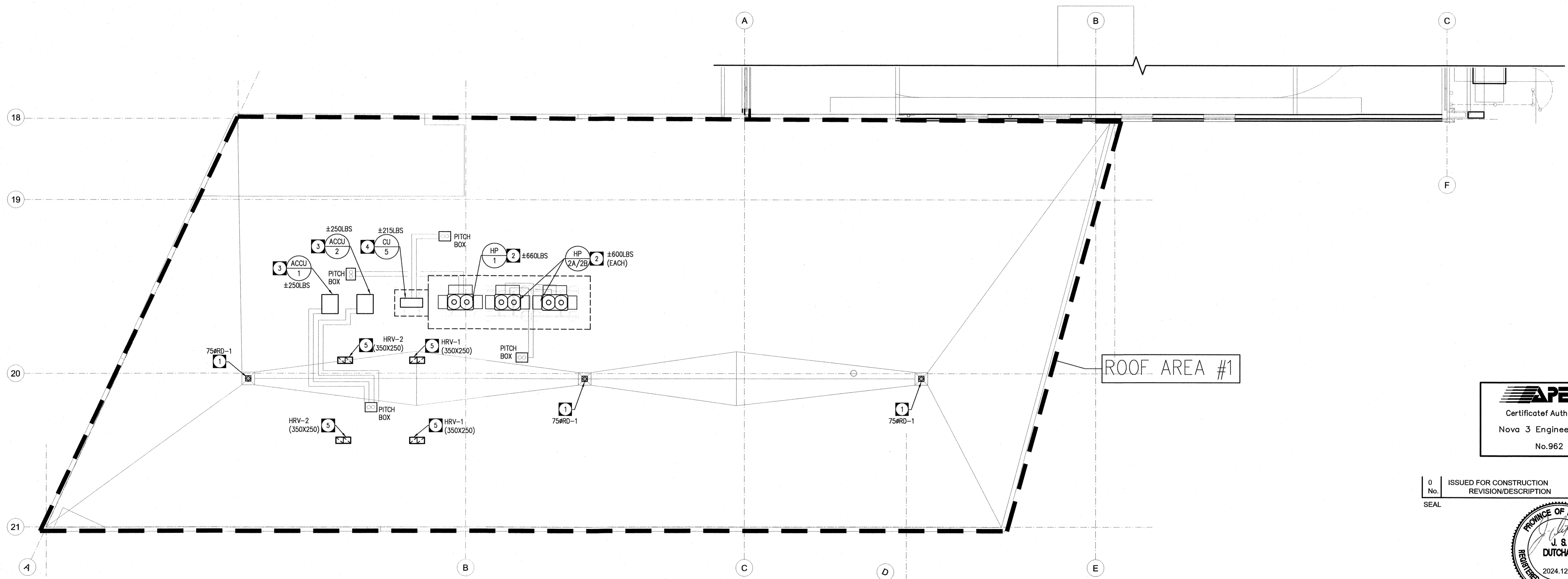

RENOVATION ROOF PLAN - MECHANICAL (SOUTH)
SCALE: 1:100



0	ISSUED FOR CONSTRUCTION	JSD	2024.12.11
No.	REVISION/DESCRIPTION	BY	DATE



CT/JSD	JSD	JSD	JSD
DRAWN	CHECKED	DESIGNED	APPROVED
DATE: 04.20	USER	TC	
	APPROVAL		

THE CITY OF WINNIPEG
ASSETS and PROJECT MANAGEMENT
DEPARTMENT
MUNICIPAL ACCOMMODATIONS
DIVISION
PROJECT 3-65 GARRY STREET, R3C 4K4
**REDEVELOPMENT OF THE
OLD EXHIBITION ARENA
ISSUED FOR CONSTRUCTION**

80 SINCLAIR STREET
SHEET TITLE

**ROOF PLAN - HVAC
(SOUTH)**

SCALE	PROJECT No.:	SHEET No.:
AS SHOWN	2020-136	M3.2

DRAWING SHEET SIZE: A1 (841mm x 594mm) PLOT 1:1

NOVA 3 NOVA 3 ENGINEERING LTD.
PROFESSIONAL ENGINEERS
201-120 FORT STREET TEL: (204) 943-6142
WINNIPEG, MANITOBA R3C 1C7 FAX: (204) 942-1276
WWW.NOVA3.CA JN: 41-193

THIS DRAWING IS THE EXCLUSIVE PROPERTY OF NOVA 3 ENGINEERING LTD. AND MAY ONLY BE REPRODUCED WITH THE WRITTEN PERMISSION OF NOVA 3 ENGINEERING LTD.
THE CONCEPT AND DESIGN INCORPORATED INTO THIS DRAWING ARE BASED ON INFORMATION PROVIDED BY THE CLIENT AND OTHER RELATED SOURCES. PROFESSIONAL ENGINEER ACCEPTS NO RESPONSIBILITY FOR DRAWING AND DESIGN UNLESS DRAWING IS ACCOMPANIED BY ORIGINAL SEALED LETTER OF INTENT OR EQUIVALENT ACCEPTABLE FACSIMILE. PROFESSIONAL ENGINEER ACCEPTS NO RESPONSIBILITY FOR FINAL INSTALLATION CONFORMANCE WITHOUT ORIGINAL SEALED CERTIFICATE OF INSPECTION OR EQUIVALENT ACCEPTABLE FACSIMILE.