

**SEWER JUNCTION INFORMATION FROM SEWER VIDEO INSPECTION**

SEWER ID S-MA20019475		
DISTANCE FROM S-MH20017468		
DISTANCE	DIAMETER	CLOCK
2.3	150	10:00
4.8	150	2:00
9.9	150	10:00
10.1	150	2:00
19.4	150	10:00
19.8	150	2:00
28.3	150	10:00
28.3	150	2:00
30.1	250	11:00
31.7	150	11:00
35.6	150	10:00
38.0	150	10:00
38.0	150	2:00
44.6	150	2:00
47.5	150	9:00
47.5	150	3:00
58.3	150	11:00
64.1	150	11:00
75.1	150	9:00
82.3	900	9:00
83.8	150	9:00
87.0	1450x1875	9:00

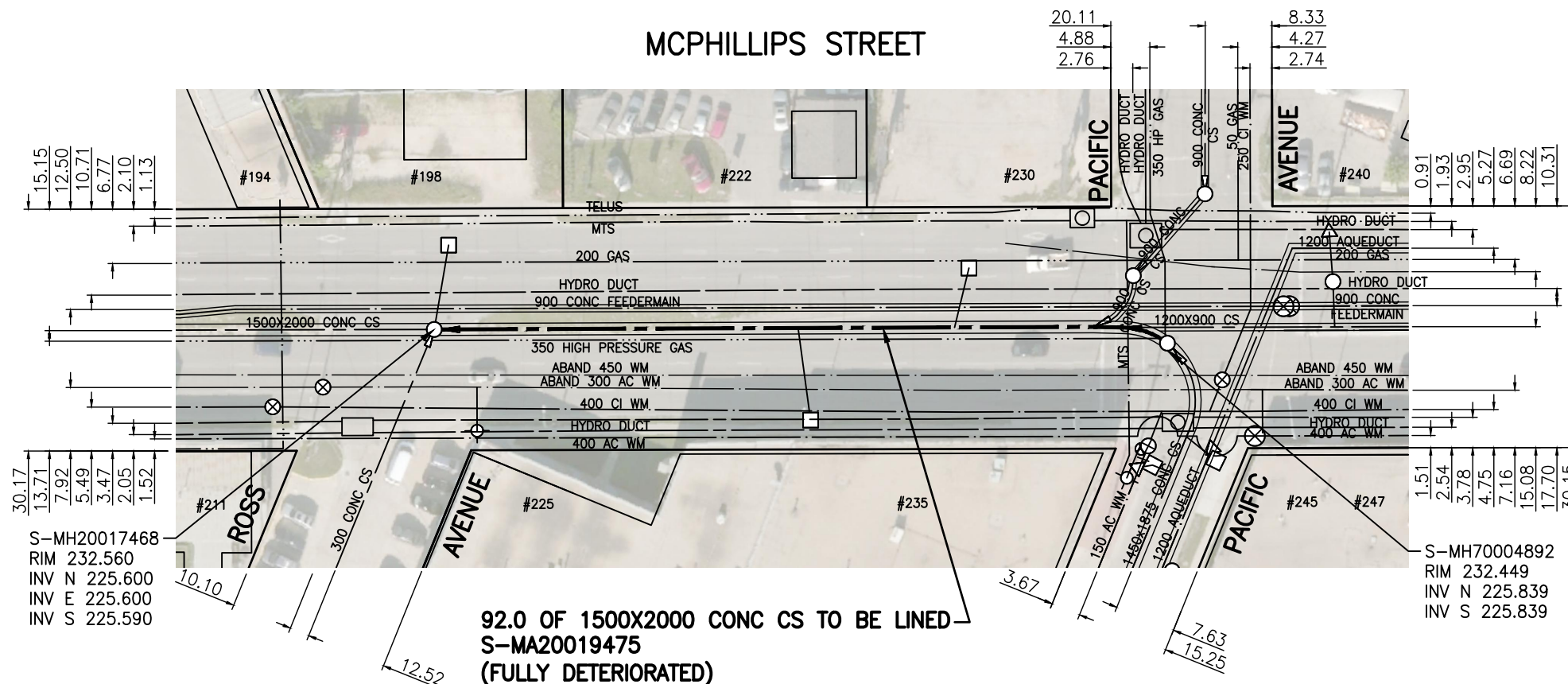

S-MH20017468  
RIM 232.560  
INV N 225.600  
INV E 225.600  
INV S 225.590

S-MH70004892  
RIM 232.449  
INV N 225.839  
INV S 225.839

**CAUTION: S-MA20019475 IS IN CLOSE PROXIMITY TO 900 FEEDERMAIN AND 350 HIGH PRESSURE GAS ACCESS SHAFT TO FACILITATE CIPP LINER INSTALLATION MAY NEED TO BE ON 1450x1875 ON PACIFIC AVENUE. EXCAVATION IN CLOSE PROXIMITY TO AQUEDUCT TO BE IN ACCORDANCE WITH SPECIFICATIONS**

**WARNING**

IF POWER EQUIPMENT OR EXPLOSIVES ARE TO BE USED FOR EXCAVATION ON THIS PROJECT THE CONTRACTOR MUST:

- 1) NOTIFY THE GAS COMPANY OF THE PROPOSED LOCATION OF EXCAVATION.
- 2) TAKE PRECAUTION TO AVOID DAMAGE TO GAS COMPANY INSTALLATIONS.

SEE PROVINCIAL REGULATION 140/92 FOR DETAILS



Certificate of Authorization  
Stantec Consulting Ltd.  
No. 1301

**METRIC**

WHOLE NUMBERS INDICATE MILLIMETRES  
DECIMALIZED NUMBERS INDICATE METRES



TENDER NO. 371-2024

FOR INDEX SEE  
13322

**LOCATION APPROVED UNDERGROUND STRUCTURES**

SUPV. U/G STRUCTURES COMMITTEE DATE

**NOTE:**  
LOCATION OF UNDERGROUND STRUCTURES AS SHOWN ARE BASED ON THE BEST INFORMATION AVAILABLE BUT NO GUARANTEE IS GIVEN THAT ALL EXISTING UTILITIES ARE SHOWN OR THAT THE GIVEN LOCATIONS ARE EXACT. CONFIRMATION OF EXISTENCE AND EXACT LOCATION OF ALL SERVICES MUST BE OBTAINED FROM THE INDIVIDUAL UTILITIES BEFORE PROCEEDING WITH CONSTRUCTION.

B.M.	ELEV.	NO.	REVISIONS	DATE	BY
00	ISSUED FOR TENDER	24.04.22	RS		



311 Portage Avenue, Winnipeg, Manitoba  
Tel 204-489-5900 Fax 204-453-9012

DESIGNED BY	RS	CHECKED BY	WB
DRAWN BY	ZA/OS	APPROVED BY	RS
HOR. SCALE:	1:750	RELEASED FOR CONSTRUCTION:	SC
VERTICAL:		DATE	24.04.17
DATE	23.03.02		

ENGINEER'S SEAL

CONSULTANT DRAWING NO.  
**C-102**



**THE CITY OF WINNIPEG**  
**WATER AND WASTE DEPARTMENT**

**2024 SEWER RENEWALS BY CIPP LINING (LARGE DIAMETER)**  
CONTRACT 5  
**MCPHILLIPS STREET**  
MH AT ROSS AVENUE TO  
MH AT PACIFIC AVENUE

SHEET	OF
<b>04</b>	<b>08</b>
CAD FILE DRAWING NUMBER <b>20787c-101-105.dwg</b>	
CITY DRAWING NUMBER <b>13324</b>	

V:\112\active\11220787\0300\_drawing\0302\_sheet\_files\02\_civil\20787c-101-105.dwg