

- NOTES:**
1. INSPECT EXISTING 1350# CONC CS FROM MANHOLE S-MH70079782 TO CS TEE AT HECTOR AVE./ HECTOR BAY WEST (EAST LEG) PRIOR TO AND AFTER INSTALLATION OF THE NEW LDS PIPE TO DETERMINE IF ANY DAMAGE IS CAUSED TO THE EXISTING CS DURING THE LDS INSTALLATION DUE TO ITS CLOSE PROXIMITY.

NOTE: CHAINAGES SHOWN ARE ALONG SOUTH R HECTOR AVENUE

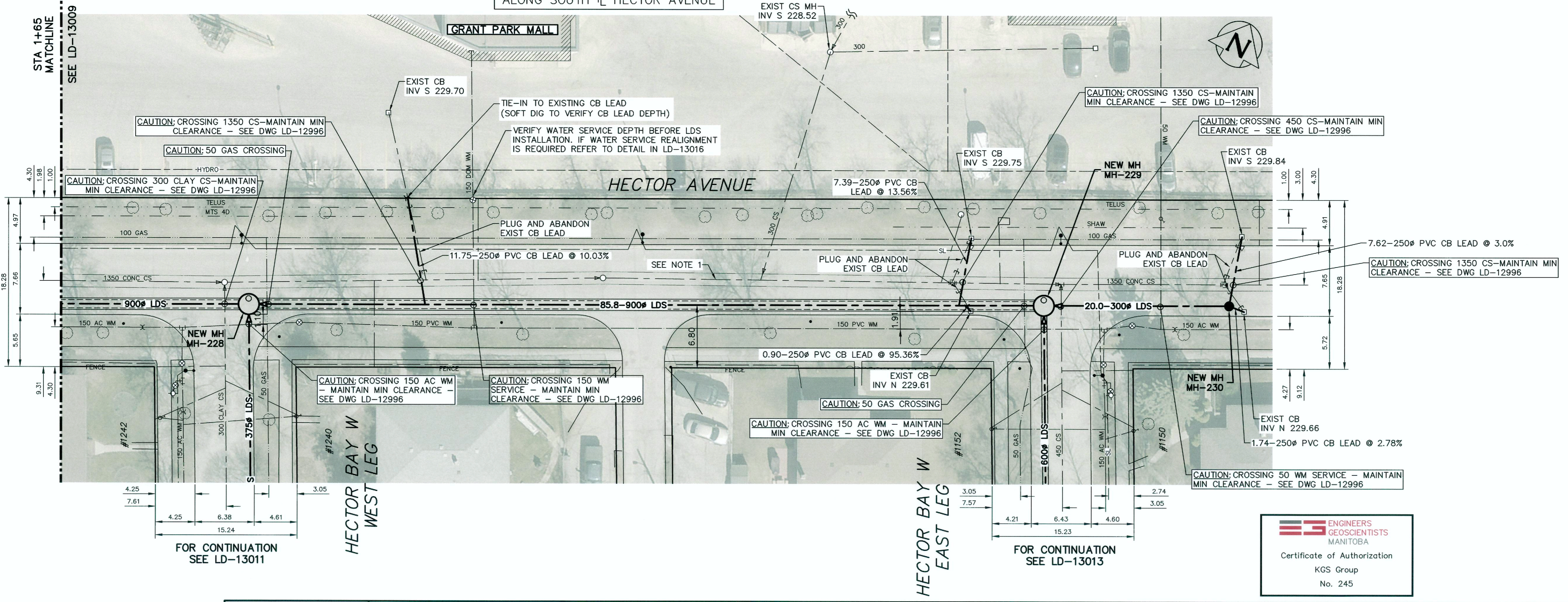

FOR INDEX SEE LD-12996

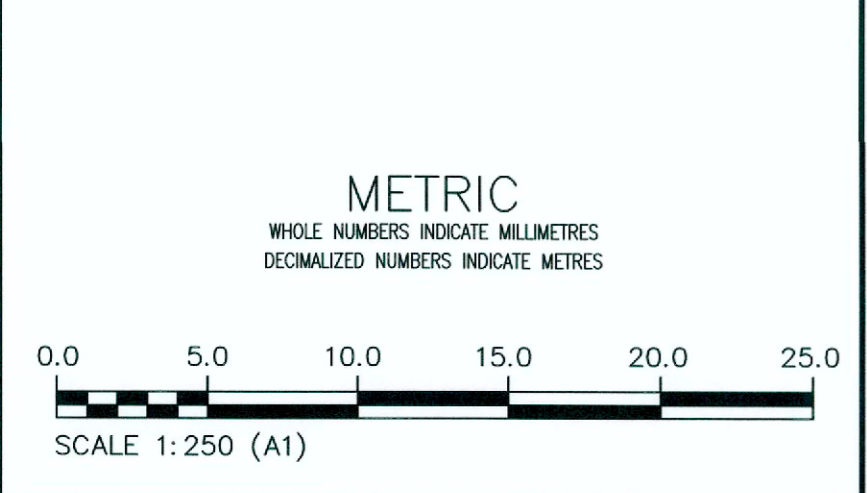

PROPERTY LIMITS DELINEATION
DELINEATION OF PROPERTY LIMITS AS SHOWN ON THIS DWG DOES NOT REPRESENT A "LEGAL SURVEY". KGS GROUP MAKES NO REPRESENTATION OR WARRANTY AS TO THE ACCURACY OF PROPERTY LIMITS DELINEATED ON THIS DWG, NOR ON THE DIMENSIONAL ACCURACY OF DWG FEATURES RELATIVE TO THOSE PROPERTY LIMITS.

WARNING
IF POWER EQUIPMENT OR EXPLOSIVES ARE TO BE USED FOR EXCAVATION ON THIS PROJECT THE CONTRACTOR MUST:
1) NOTIFY THE GAS COMPANY OF THE PROPOSED LOCATION OF EXCAVATION.
2) TAKE PRECAUTION TO AVOID DAMAGE TO GAS COMPANY INSTALLATIONS.
SEE PROVINCIAL REGULATION 210/72 FOR DETAILS

LOCATION APPROVED UNDERGROUND STRUCTURES
DATE _____
DATE _____
DATE _____
DATE _____
DATE _____
DATE _____
DATE _____
DATE _____
DATE _____
DATE _____

NOTE:
LOCATION OF UNDERGROUND STRUCTURES AS SHOWN ARE BASED ON THE BEST INFORMATION AVAILABLE BUT NO GUARANTEE IS GIVEN THAT ALL EXISTING UTILITIES ARE SHOWN OR THAT THE GIVEN LOCATIONS ARE EXACT. CONFIRMATION OF EXISTENCE AND EXACT LOCATION OF ALL SERVICES MUST BE OBTAINED FROM THE INDIVIDUAL UTILITIES BEFORE PROCEEDING WITH CONSTRUCTION.

B.M. ELEV.	NO.	ISSUED FOR CONSTRUCTION	DATE	BY
	0	ISSUED FOR CONSTRUCTION	2024/06/18	MID

KGS GROUP

DESIGNED BY: MID
DRAWN BY: MID
SCALE: HORIZONTAL 1:250, VERTICAL 1:50
DATE: 2024 06 18

CHECKED BY: [Signature]
APPROVED BY: [Signature]
RELEASED FOR CONSTRUCTION: [Signature]
DATE: 29/06/20

ENGINEER'S SEAL
CONSULTANT DRAWING NUMBER: 11-0107-18-C13-2_C09
CONTRACT NUMBER: 13

THE CITY OF WINNIPEG
WATER AND WASTE DEPARTMENT
ENGINEERING DIVISION

COCKBURN & CALROSSIE SEWER RELIEF WORKS
CONTRACT 13
HECTOR AVENUE
NATHANIEL STREET TO HECTOR BAY W - EAST LEG
STA 1+65 TO HECTOR BAY W - EAST LEG

SHEET 16 OF 22
CITY DRAWING NUMBER LD-13010