

BEARING REPLACEMENT WORK PLAN AT PIER 6:

1. MOBILIZE PERSONNEL, EQUIPMENT AND MATERIALS TO THE WORK SITE VIA THE EXISTING ACCESS ROADS FROM THE WEST STAGING AND LAYDOWN AREA. USE THE ACCESS ROAD BETWEEN FG06 AND FG07.
2. TRACK FG07 WOULD BE LOCKED OUT.
3. THE BEARING REPLACEMENT WORKS AT PIER 4 WILL REQUIRE 6 DAYS WITH 6 HOUR TRACK BLOCKS PER DAY TO COMPLETE.
4. EQUIPMENT WILL BE LEFT AT THE PIER LOCATION, SUCH THAT RAIL OPERATIONS CAN RECOMMENCE, THROUGH COORDINATION WITH THE FLAGGING PERSONNEL.
5. SPECIFIC PERSONNEL AND EQUIPMENT WILL BE DETERMINED BY THE CONTRACTOR.

1 EXISTING TRUSS - BOTTOM FRAMING PLAN
 1 : 200
 EXISTING INTERNAL DECKING STEEL NOT SHOWN FOR CLARITY

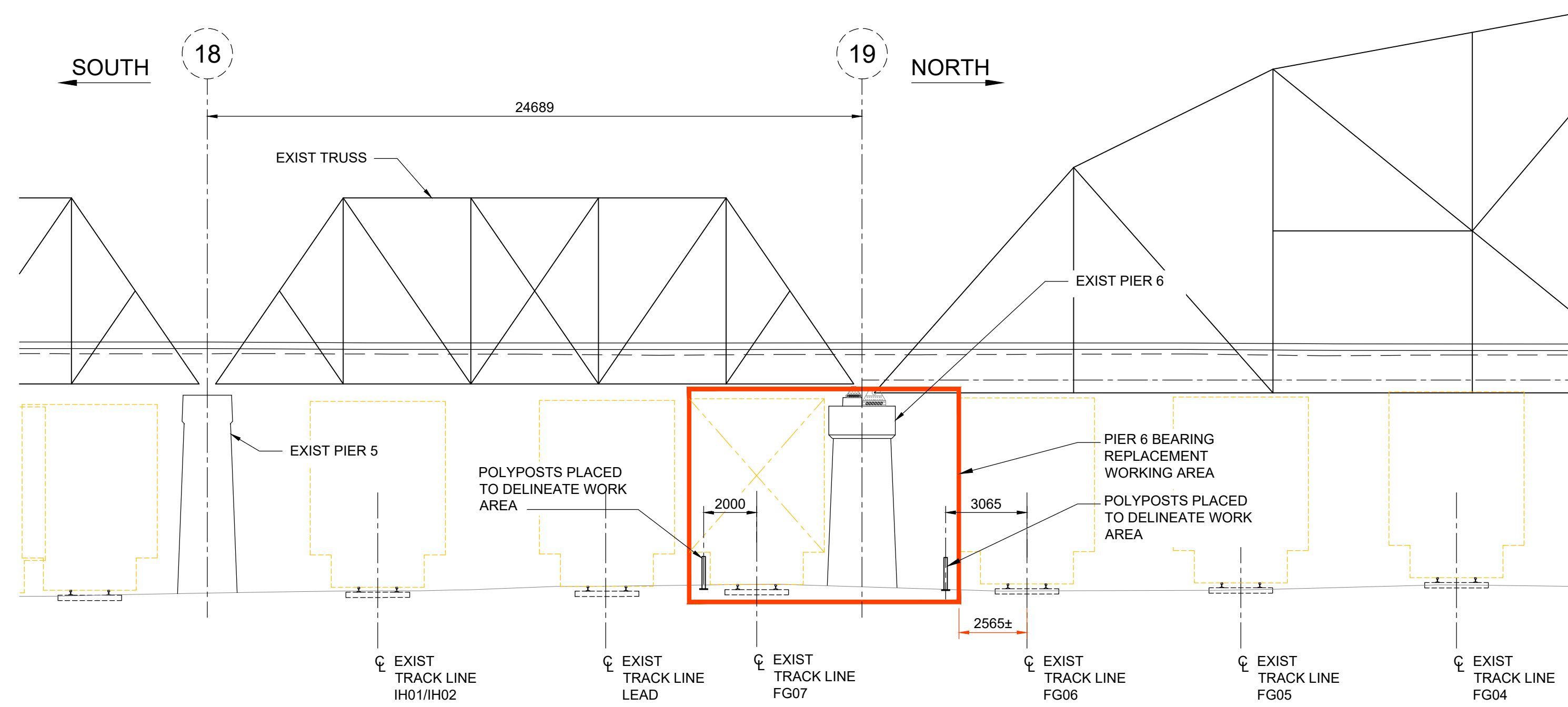

2 EAST ELEVATION VIEW
 1 : 150

DISCLAIMER
 THE PROPOSED DESIGN COMPLETED BY TETRA TECH CANADA INC IS BASED ON COMPETENT STEEL AND CONCRETE MEMBERS AND CONNECTIONS WITH LIGHT CORROSION. TETRA TECH CANADA INC CANNOT GUARANTEE THAT THERE ARE ADDITIONAL STRUCTURAL STEEL OR CONCRETE DEFECTS, NOT EVIDENT DURING TETRA TECH CANADA INC 2023 INSPECTION, THAT MAY IMPACT THE DESIGNED BEARING REPLACEMENT. THE DESIGNED BEARING REPLACEMENT DOES NOT ENSURE PUBLIC SAFETY, RATHER PROVIDES SOME LEVEL OF COMFORT THAT THE PRATT TRUSS EXPANSION AND CONTRACTION IS NOT OBSTRUCTED.



NO.	REVISIONS	DATE	BY
00	ISSUED FOR TENDER	24.05.14	MJB

TETRA TECH	
DESIGNED BY: KA	REVIEWED BY: MJB
DRAWN BY: EV	APPROVED BY: MJB
SCALE: AS NOTED	ACCEPTED BY: DATE
	ORIGINAL SIGNED
	MOHAMED MAMY, PH.D., P.ENG. BRIDGE PLANNING & OPERATIONS ENGINEER

ORIGINAL DRAWING REVISION "00" SEALED BY M.J. BOISSONNEAULT 24.05.14
CONSULTANT DRAWING NO. 734-230070400-DWG-S1306

THE CITY OF WINNIPEG
 PUBLIC WORKS DEPARTMENT

ARLINGTON BRIDGE REHABILITATION
 BEARING REPLACEMENT

CITY DRAWING NUMBER: B106-24-13
 SHEET 6 OF 7

BEARING REPLACEMENT TRUSS BOTTOM PLAN AND EAST ELEVATION
 PIER 6

6