

Drawings and specifications as instruments of service, are the property of the Landscape Architect, the copyright in the same being reserved to him / her. No reproductions may be made without the permission of the Landscape Architect and when made, must bear his / her name. All prints to be returned to the Landscape Architect on request.

This drawing shall not be used for building purposes until countersigned by the Landscape Architect.

The contractor shall check all dimensions and other data on site and report any discrepancies to the Landscape Architect.

Figured dimensions to be taken in preference to scaled dimensions.

If in doubt please ask.

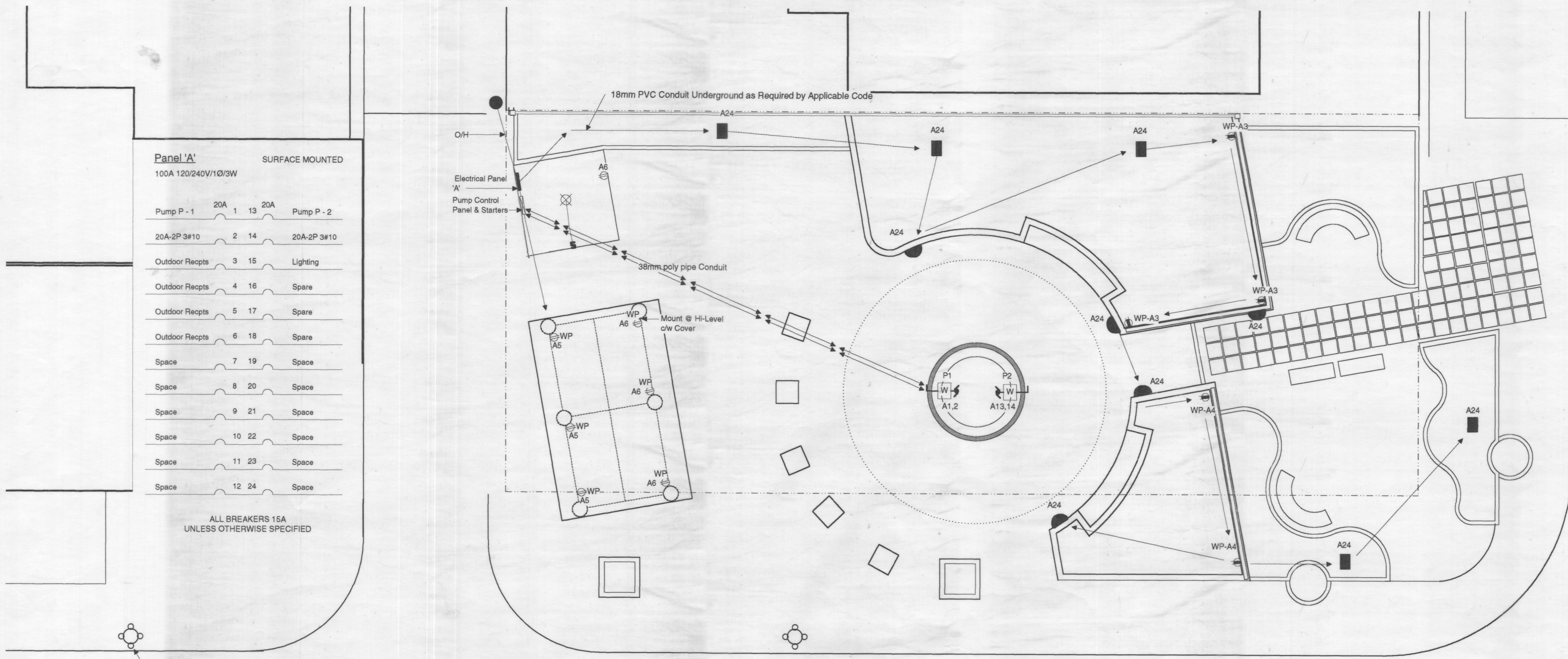

Panel 'A' SURFACE MOUNTED
100A 120/240V/1Ø/3W

Pump P - 1	20A	1	13	20A	Pump P - 2
20A-2P 3#10	2	14		20A-2P 3#10	
Outdoor Recpts	3	15		Lighting	
Outdoor Recpts	4	16		Spare	
Outdoor Recpts	5	17		Spare	
Outdoor Recpts	6	18		Spare	
Space	7	19		Space	
Space	8	20		Space	
Space	9	21		Space	
Space	10	22		Space	
Space	11	23		Space	
Space	12	24		Space	

ALL BREAKERS 15A UNLESS OTHERWISE SPECIFIED

1 Layout Plan
E1 1:100

The Fountain / Decorative Pool is subject to the requirements of Section 68 of the Electrical Bylaw. As such, all electrical equipment within 3 metres of the pool, including pumps, receptacles, and light fixtures, shall be protected by a Ground Fault Circuit Interrupter of the Class A type.

- Notes
- ☒ Porcelain Lamp Holder c/w 1 - 100 W Bulb
 - Hydrel 9000 Series Floodlights: 5 units - Supplier Mid-Can Agencies: Spec. Ref. 9100 - B - MH 100/120 Volts/MLF/34/100W
 - Hydrel 9600 Series Recessed Wall Lights: 5 units - Supplier Mid-Can Agencies: Spec. Ref. 9600 - B - MH 50/120 Volts/50W/FWL/BZ, c/w Rough in Section & 246 Lamp Module.
 - ⊖ - dup - recp
 - ⊖ - GFI recp
 - WP Weather Proof c/w Cover
 - Motor
 - W Weather Proof Disconnect (Lockable) Location: Site Determined
 - P-1 & P-2: 1 hp pump.
 - To Winnipeg Hydro Pole
 - 3 # 3 AWG in 38 Ø EMT.
 - 100A - 2P Breaker
 - Panel 'A'

Connected Load

Pumps:	4KW
Lighting:	1KW
Recpts:	2KW
Misc.:	1KW
Total:	8KW
	33 Amps @ 240 VAC

*** SPECIAL NOTE ***

WALL MOUNT LIGHTS MUST BE FORMED INTO THE WALL DURING FRAMING. OBTAIN APPROVAL OF CONTRACT ADMINISTRATOR PRIOR TO PLACEMENT OF CONCRETE.

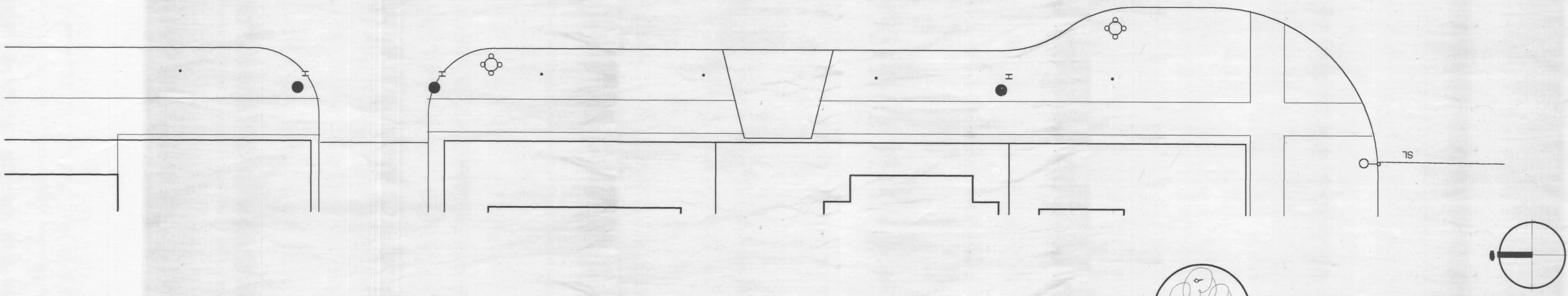

WATERMAIN	HYDRANT	VALVE	LAND DRAINAGE SEWER	WASTE WATER SEWER	MANHOLE	CATCH BASIN	CURB INLET	PARKING METER	STEAMHEAT	GAS	EXISTING	LEGEND - PLAN	PROPOSED	EXISTING	LEGEND - PLAN	PROPOSED	EXISTING	LEGEND - PROFILE	PROPOSED
---	+	⊕	---	---	○	□	△	?	---	---	---	---	---	---	---	---	---	---	---
---	---	---	---	---	---	---	---	---	---	---	---	---	---	---	---	---	---	---	---
---	---	---	---	---	---	---	---	---	---	---	---	---	---	---	---	---	---	---	---
---	---	---	---	---	---	---	---	---	---	---	---	---	---	---	---	---	---	---	---
---	---	---	---	---	---	---	---	---	---	---	---	---	---	---	---	---	---	---	---
---	---	---	---	---	---	---	---	---	---	---	---	---	---	---	---	---	---	---	---
---	---	---	---	---	---	---	---	---	---	---	---	---	---	---	---	---	---	---	---
---	---	---	---	---	---	---	---	---	---	---	---	---	---	---	---	---	---	---	---
---	---	---	---	---	---	---	---	---	---	---	---	---	---	---	---	---	---	---	---
---	---	---	---	---	---	---	---	---	---	---	---	---	---	---	---	---	---	---	---
---	---	---	---	---	---	---	---	---	---	---	---	---	---	---	---	---	---	---	---

LOCATION APPROVED UNDERGROUND STRUCTURES

SUPV. U/G STRUCTURES DATE COMMITTEE

NOTE:
LOCATION OF UNDERGROUND STRUCTURES AS SHOWN ARE BASED ON THE BEST INFORMATION AVAILABLE BUT NO GUARANTEE IS GIVEN THAT ALL EXISTING UTILITIES ARE SHOWN OR THAT THE GIVEN LOCATIONS ARE EXACT. CONFIRMATION OF EXISTENCE AND EXACT LOCATION OF ALL SERVICES MUST BE OBTAINED FROM THE INDIVIDUAL UTILITIES BEFORE PROCEEDING WITH CONSTRUCTION.

B.M. ELEV.			
1	additions/deletions	9.7.95	D.W.
2	additions/deletions	10.26.95	LLW
3	AS BUILT	11.06.96	LLW
NO. REVISIONS		DATE	BY

David Wagner Associates Inc.
4 - 430 River Avenue Winnipeg, Manitoba. R3L 0C6 (204) 452-2426
LANDSCAPE ARCHITECTURE • URBAN DESIGN • GOLF COURSE ARCHITECTURE

DESIGNED BY	M.M./D.W.	CHECKED BY	
DRAWN BY	D.W.	APPROVED BY	
HOR. SCALE	As Shown	RELEASED FOR CONSTRUCTION	
VERT. SCALE	Not Applicable		
DATE	08 / 95	DATE	

M2 Engineering: Electrical & Mechanical
639 Centennial Street
Winnipeg, MB.
R2N 1R3
(204) 488-1924

DAVID WAGNER
member no. 333

CONSULTANT DRAWING NO. CAD9509(E1)

CORYDON AVE. BIZ STREET ENHANCEMENT COMMITTEE / CORYDON VILLAGE RESIDENTS ASSOCIATION

Corydon Ave. / Hugo St. Piazza

Electrical Plan

CITY DRAWING NO. SHEET 10 OF 10

E1