

- DRAWING KEYNOTE LEGEND**
- ◇ CONSTRUCTION KEYNOTES
- HARDSCAPING**
1. ASPHALT HARD TOP, REFER TO CW 3410 AND CW DETAIL SCD-648
 2. RUBBER TRACK SURFACING C/W ASPHALT UNDERLAY, SEE DETAIL ON THIS SHEET, SPEC AND CW 3410
 3. CONCRETE CURB, REFER TO DETAIL 5 ON THIS SHEET AND GRADING PLAN ON L3.1 FOR TOC/BOC AND CW 3310-R18.
 4. REINSTALL GATE AND ROLLER ONCE GRADING WORKS COMPLETE. RELEASE WOOD MATERIAL, HINGES, SLIDING AND LOCKING HARDWARE. INSTALL NEW POSTS. DIMENSIONS AND FUNCTION OF REINSTALLED FENCE AND GATE TO MATCH EXISTING FENCE AND GATE
- SOFTSCAPING**
- 2.2. EXISTING TREES TO REMAIN. REFER TO DASHED LINE FOR TREE PROTECTION ZONE, REFER TO SPEC
 - 2.3. SODDING, REFER TO CW 3510-R10
- SITE FURNISHING & PRE-MANUFACTURED SPECIALTIES**
- 3.1. SOCCER GOAL POSTS, REFER TO SPEC AND SCD-302 (DIRECT BURY OPTION)
- CIVIL**
- 4.1. LANDSCAPE DRAIN, REFER TO CIVIL

- DRAWING PATTERNS**
- ◇ ASPHALT HARD TOP
 - ◇ RUBBER TRACK SURFACING
 - ◇ SODDING

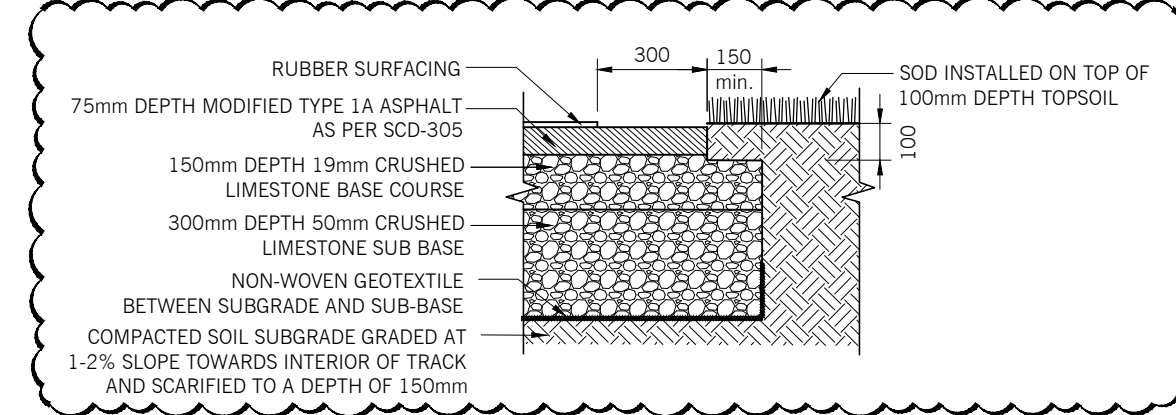

2 RUBBER TRACK SURFACING C/W ASPHALT UNDERLAY
L2.1 1:20

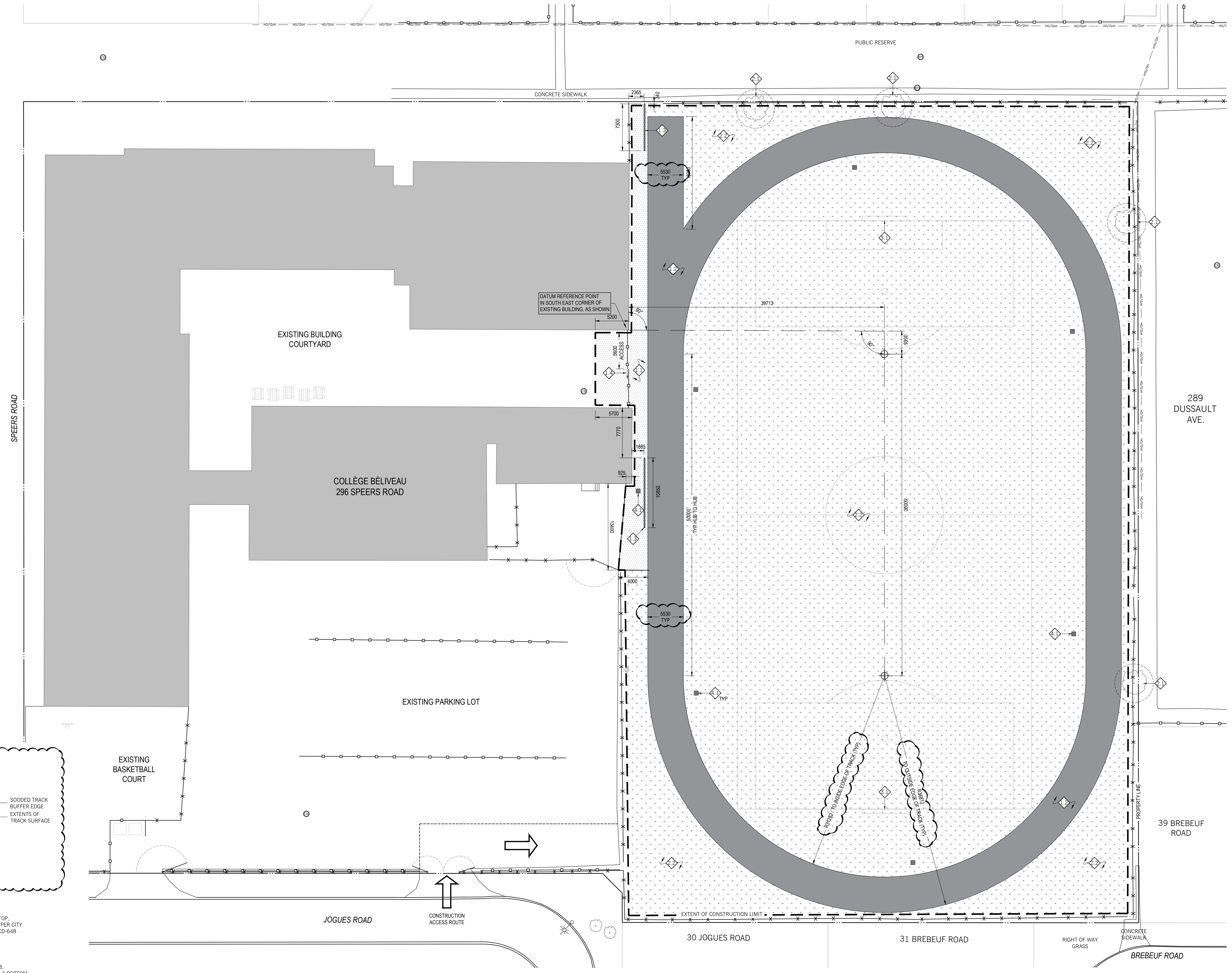
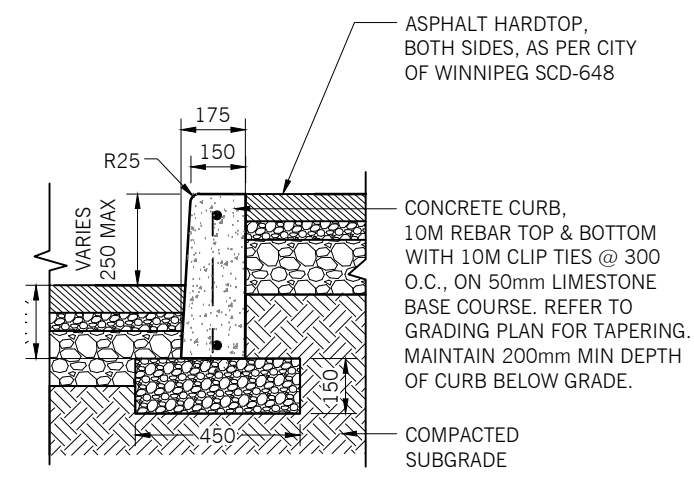
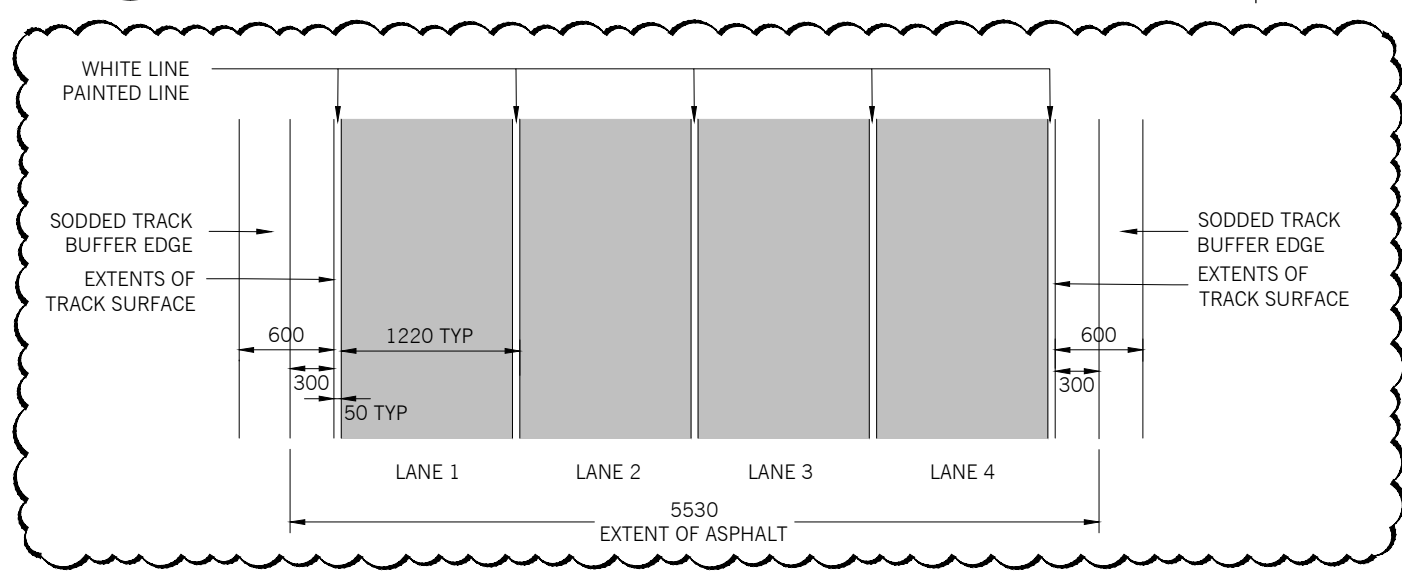
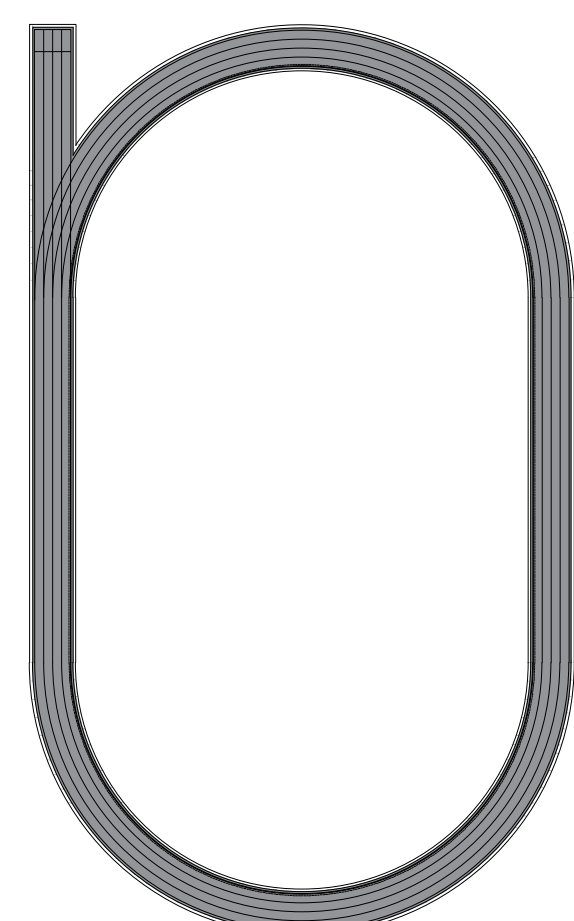

- ISSUES / REVISIONS**
- 1 2024/06/13 ISSUED FOR CONSTRUCTION
 - 2 2024/06/18 ADDENDUM 2
 - 3 2024/06/25 ADDENDUM 3

Drawings and specifications, as instruments of service are the property of the architect. The copyright in the same being reserved to him. No reproduction may be made without the permission of the architect. The contractor shall verify dimensions and data noted herein with conditions on the site and is held responsible for reporting any discrepancy to the architect for adjustment. This drawing shall not be used for building purposes until countersigned by:

SUBCONSULTANTS

SEALS

ft3
Architecture
Landscape
Interior Design

Suite 200, 300 Waterfront Drive
Winnipeg, MB Canada R3B 0G5
t. 204-885-9323

PROJECT NO.	490-2024/24.755
DATE	2024 06 18
DRAWN BY	KS/BG
CHECKED BY	CA
DESIGNED BY	KS/BG
CLIENT	CITY OF WINNIPEG ASSETS AND PROJECT MANAGEMENT

COLLÈGE BÉLIVEAU TRACK REFURBISHMENT

CONTENTS

LANDSCAPE SITE PLAN AND LAYOUT PLAN

L2.1