

Drawings and specifications, as instruments of service are the property of the architect, the copyright in the same being reserved to him. No reproduction may be made without the permission of the architect and when made, must bear his name. All prints to be returned to the architect. The contractor shall verify dimensions and data noted herein with conditions on the site and is held responsible for reporting any discrepancy to the architect for adjustment. This drawing shall not be used for building purposes until countersigned by:

SUBCONSULTANTS

SEALS



Suite 200, 300 Waterfront Drive  
Winnipeg, MB Canada R3B 0G5  
t. 204.865.9323

PROJECT NO.	490-2024/24.755
DATE	2024 06 13
DRAWN BY	KS/BG
CHECKED BY	CA
DESIGNED BY	KS/BG
CLIENT	

CITY OF WINNIPEG  
ASSETS AND PROJECT  
MANAGEMENT

PROJECT TITLE  
COLLÈGE BÉLIVEAU  
TRACK REFURBISHMENT

CONTENTS  
GENERAL NOTES AND  
DRAWING LIST

DRAWING

L0.1

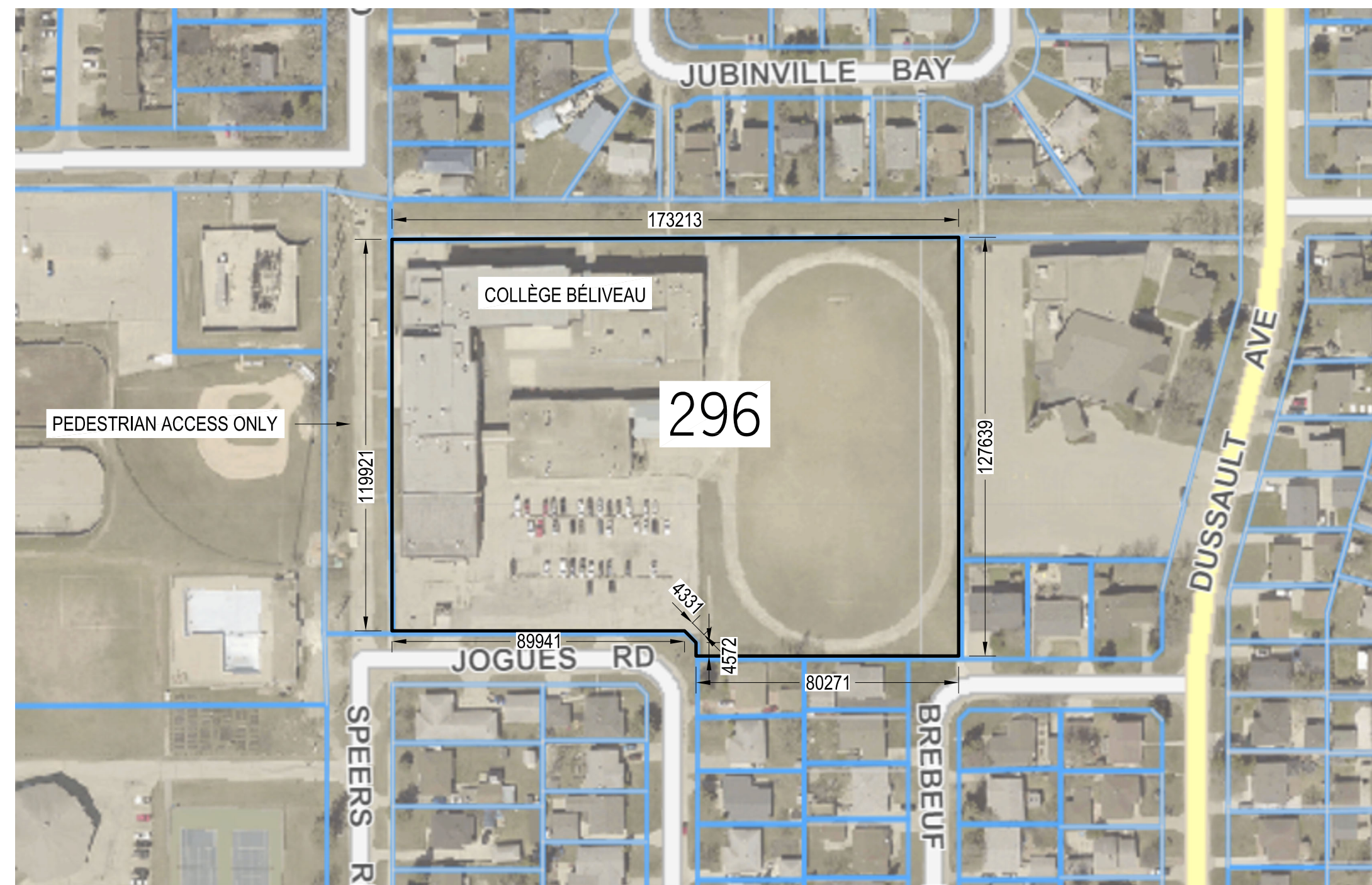

1 CONTEXT PLAN  
L0.1 NTS

PROPERTY INFORMATION	
ADDRESS:	296 SPEERS RD
PROPERTY USE:	SCHOOL
LAND AREA:	5.3 ACRES

DRAWING LIST	
LANDSCAPE	GENERAL NOTES AND DRAWING LIST
L0.1	EXISTING CONDITIONS AND SITE DEMOLITION PLAN
L1.1	LANDSCAPE SITE PLAN AND LAYOUT PLAN
L2.1	GRADING PLAN
L3.1	
CIVIL	EXISTING SITE TOPOLOGICAL SURVEY PLAN
C1.0	SITE SERVICING PLAN
C1.1	

NOTES	
<b>GENERAL LANDSCAPE DRAWINGS:</b>	
1.	DRAWINGS SHALL BE READ IN CONJUNCTION WITH THE PROJECT MANUAL.
2.	ALL WORK SHALL BE PERFORMED IN ACCORDANCE WITH APPLICABLE CODES AND ORDINANCES AS ADOPTED BY THE LOCAL JURISDICTION HAVING AUTHORITY.
3.	DO NOT SCALE DRAWINGS.
4.	ALL DIMENSIONS ARE SHOWN IN METRIC (MM) UNLESS OTHERWISE NOTED.
5.	REPORT ANY DISCREPANCIES WITH THE DRAWINGS AND UNEXPECTED CONDITIONS TO THE CONTRACTOR ADMINISTRATOR.
6.	ALL SHOWN SITE FEATURES AND UTILITIES HAVE BEEN LOCATED FROM A SURVEY DRAWING BY SISON BLACKBURN CONSULTING INC. PREPARED ON APRIL 11, 2024. THESE HAVE BEEN SHOWN FOR DIAGRAMMATIC PURPOSE ONLY AND ARE APPROXIMATE IN LOCATION. EXACT LOCATIONS OF ALL UTILITIES TO BE VERIFIED AND CONFIRMED BY CONTRACTOR ON SITE.
7.	CONTRACTOR TO ENSURE THAT ALL UNDERGROUND UTILITIES ARE IDENTIFIED AND MARKED PRIOR TO EXCAVATION ACTIVITIES.
8.	CONTRACTOR TO REPAIR ANY DAMAGE TO UNDERGROUND LINES CAUSED BY CONSTRUCTION ACTIVITIES INCLUDING BUT NOT LIMITED TO IRRIGATION AND UTILITIES.
9.	CONSTRUCTION BOUNDARY FENCE TO BE INSTALLED PRIOR TO DEMOLITION AND CONSTRUCTION WORK. REFER TO PROJECT MANUAL.
10.	SNOW FENCE BARRIERS AND SIGNAGE, IF SHOWN, TO BE INSTALLED TO PREVENT VEHICULAR ACCESS AND DAMAGE TO AREAS DESIGNATED FOR PROTECTION.
11.	CONTRACTOR TO PROTECT ALL EXISTING ITEMS AND ENSURE THEY REMAIN AS PER SPECIFICATIONS AND AS NOTED ON DRAWINGS. AREAS DAMAGED DURING CONSTRUCTION NEED TO BE REPAIRED TO THE SATISFACTION OF CONTRACT ADMINISTRATOR AT THE CONTRACTOR'S COST.
12.	ALL DISTURBED AREAS OUTSIDE THE CONSTRUCTION LIMIT AND PROPERTY LINE (INCLUDING LAYDOWN AREA) ARE TO BE RESTORED TO THEIR ORIGINAL CONDITION AT THE CONTRACTOR'S EXPENSE.
13.	TREE PROTECTION BARRIERS TO REMAIN DURING ALL STAGES OF CONSTRUCTION. REFER TO PROJECT MANUAL.
14.	INSTALL ALL MANUFACTURED ITEMS IN ACCORDANCE WITH WRITTEN INSTRUCTIONS AND RECOMMENDATIONS.
15.	PRIOR TO REMOVAL OF EXISTING ASPHALT, COORDINATE WITH LANDSCAPE ARCHITECT TO DETERMINE EXTENTS.
<b>LAYOUT DRAWINGS:</b>	
1.	TICK MARKS HAVE BEEN PROVIDED TO SHOW THE EXTENT OF ARC.
2.	ALL DIMENSION GUIDES (SHOWN AS DASHED LINE) ARE AT 90° ANGLES UNLESS OTHERWISE NOTED.
3.	WHERE ARC RADII ARE NOT PROVIDED, ENSURE THAT ARC LAYOUT IS SMOOTH AND CONTINUOUS TO MEET CONNECTING POINTS.
4.	UNLESS OTHERWISE NOTED, ALL DIMENSIONS PERTAINING TO CURBS ARE TAKEN TO THE FRONT FACE OF CURB.
5.	HARD SURFACES TO BE INSTALLED PRIOR TO SOFTSCAPING UNLESS OTHERWISE AUTHORIZED BY CONTRACT ADMINISTRATOR.
<b>GRADING DRAWINGS:</b>	
1.	CONTRACTOR TO SITE VERIFY EXISTING ELEVATIONS AND DIMENSIONS TO ENSURE THAT DESIGN INTENT CAN BE MET AS SHOWN. IF DISCREPANCIES ARISE, CONTRACTOR TO CONTACT CONTRACT ADMINISTRATOR IMMEDIATELY.
2.	MAINTAIN EXISTING GRADES AT ALL BUILDING EDGES AND PROPERTY LINES UNLESS OTHERWISE NOTED. ENSURE POSITIVE DRAINAGE AWAY FROM BUILDING.
3.	ALL ELEVATIONS ARE IN METERS AND DECIMALS OF A METER. EXISTING ELEVATIONS ARE TAKEN FROM A SURVEY. SEE GENERAL NOTES FOR DATE OF SURVEY.
4.	GEODETTIC SPOT ELEVATIONS ARE SHOWN IN METERS AND DECIMALS OF A METER.

REFERENCE THE FOLLOWING CITY OF WINNIPEG CONSTRUCTION SPECIFICATIONS:		
1.	CW 3110 – R33 SUBGRADE, SUB-BASE AND BASE COURSE CONSTRUCTION	
2.	CW 3130 – R5 SUPPLY AND INSTALLATION OF GEOTEXTILE FABRICS	
3.	CW 3410 – ASPHALTIC CONCRETE PAVEMENT WORKS	
4.	CW 3510 – R10 SODDING	
5.	CW 3540 – TOPSOIL AND FINISH GRADING FOR ESTABLISHMENT OF TURF AREAS	
6.	CW 3310 – R18 PORTLAND CEMENT CONCRETE PAVEMENT WORKS	
AMENDMENTS TO CW3410 - ASPHALTIC CONCRETE PAVEMENT WORKS		
5.5.1	PRIME COAT	THE PRIMER FOR APPLICATION ON CRUSHED STONE BASE UNDER LAYERS (PRIME COAT) SHALL BE MC-1.
5.5.2	TACK COAT	THE PRIMER FOR APPLICATION ON ASPHALT SURFACES (TACK COAT) SHALL BE RC-1.
9.7	REQUIREMENTS AFTER FINAL ROLLING.	ON COMPLETION OF PLACEMENT AND COMPACTION, PAVEMENT COURSES SHALL COMPLY WITH THE FOLLOWING TOLERANCES:
TOP COAT	LEVEL	+2mm/-2mm FROM DESIGN LEVELS
	THICKNESS	+5mm/-0mm FROM DESIGN THICKNESS
	FLATNESS	3mm MAX. DEPARTURE FROM 3m STRAIGHT EDGE IN ALL DIRECTIONS
BINDER COURSE	LEVEL	+4mm/-4mm FROM DESIGN LEVELS
	THICKNESS	+5mm/-0mm FROM DESIGN THICKNESS
	FLATNESS	4mm MAX. DEPARTURE FROM 3m STRAIGHT EDGE IN ALL DIRECTIONS
ANY REQUIRED REPAIRS ARE ONLY TO BE MADE BY RE-HEATING AND RE-ROLLING OF THE ASPHALT. NO CUTTING OF THE ASPHALT WILL BE ALLOWED FOR REPAIRING AND NO SLURRY COAT APPLICATION WILL BE ALLOWED FOR REPAIRING.		
THE CONTRACTOR IS REQUIRED TO HAVE ALL AREAS THAT ARE FOUND OUT OF TOLERANCE BY MORE THAN THE ABOVE NOTED TOLERANCES, WHICH CANNOT BE REPAIRED BY HEATING AND RE-ROLLING, TO BE FILLED WITH SYNTHETIC RUNNING TRACK MATERIAL BY THE SYNTHETIC SURFACING CONTRACTOR. THE CONTRACTOR SHALL PAY THE SYNTHETIC SURFACING CONTRACTOR FOR THE REPAIRS. CONTRACTORS ARE ENCOURAGED TO REQUEST PRICING FROM DIFFERENT SYNTHETIC TRACK CONTRACTORS TO BETTER EVALUATE THE POTENTIAL VALUE OF THE TOLERANCE REPAIRS (SELF-LEVELLING COMPOUND), SAW CUTTING AND REMOVAL AND REPLACEMENT IS NOT ALLOWED AS A PROCEDURE FOR ASPHALT OUT OF TOLERANCE REPAIRS.		
ANY SUBSEQUENT VISITS REQUIRED BY THE SYNTHETIC SURFACING INSTALLER TO RE-INSPECT INCORRECT INSTALLATIONS WILL BE AT THE COST OF THE CONTRACTOR.		
9.8	OPENING TO TRAFFIC	THE ASPHALT WILL NEED TO CURE FOR 28 DAYS PRIOR TO THE INSTALLATION OF THE SYNTHETIC SURFACING. ENSURE THAT CONSTRUCTION FENCING PREVENTS TRESPASSING ACROSS THE CONSTRUCTION SITE AND PROTECTS THE RUNNING TRACK FROM DAMAGE OR MOVEMENT.
10.6	QUALITY ASSURANCE	COPIES OF TEST RESULTS TO BE SENT TO CONTRACT ADMINISTRATOR.
AMENDMENTS TO CW311-R33 SUB-GRADE, SUB-BASE AND BASE COURSE CONSTRUCTION:		
3.6	PLACEMENT OF BASE COURSE	THE GRANULAR BASE MATERIAL SHOULD BE COMPACTED TO A MINIMUM 98 PERCENT OF THE STANDARD PROCTOR MAXIMUM DRY DENSITY (SPMDD) AT THE OPTIMUM MOISTURE CONTENT.
ON COMPLETION OF PLACEMENT AND COMPACTION, BASE COURSES SHALL COMPLY WITH THE FOLLOWING TOLERANCES:		
BASE	LEVEL	+5mm/-5mm
	STRAIGHTNESS	6mm MAXIMUM DEVIATION FROM 4m STRAIGHT-EDGE IN ALL DIRECTIONS
	THICKNESS	+15mm/-15mm
SUB-BASE	LEVEL	+10mm/-10mm
	THICKNESS	+30mm/-30mm
ENSURE THAT CONSTRUCTION FENCING PREVENTS TRESPASSING ACROSS THE CONSTRUCTION SITE AND PROTECTS THE RUNNING TRACK FROM DAMAGE OR MOVEMENT.		