

Drawings and specifications, as instruments of service are the property of the architect. The copyright in the same being reserved to him. No reproduction may be made without the permission of the architect and when made, must bear his name. All prints to be returned to the architect. The contractor shall verify dimensions and data noted herein with conditions on the site and is held responsible for reporting any discrepancy to the architect for adjustment. This drawing shall not be used for building purposes until countersigned by:

SUBCONSULTANTS

SEALS

ft3
Architecture
Landscape
Interior Design

Suite 200, 300 Waterfront Drive
Winnipeg, MB Canada R3B 0G5
T. 204.865.9323

PROJECT NO.	490-2024/24.755
DATE	2024 06 13
DRAWN BY	KS/BG
CHECKED BY	CA
DESIGNED BY	KS/BG
CLIENT	

CITY OF WINNIPEG
ASSETS AND PROJECT
MANAGEMENT

PROJECT TITLE
COLLÈGE BÉLIVEAU
TRACK REFURBISHMENT

CONTENTS
GRADING PLAN

DRAWING

L3.1

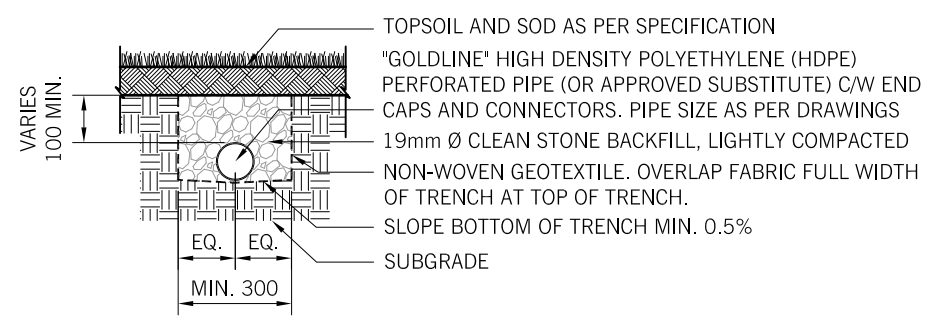
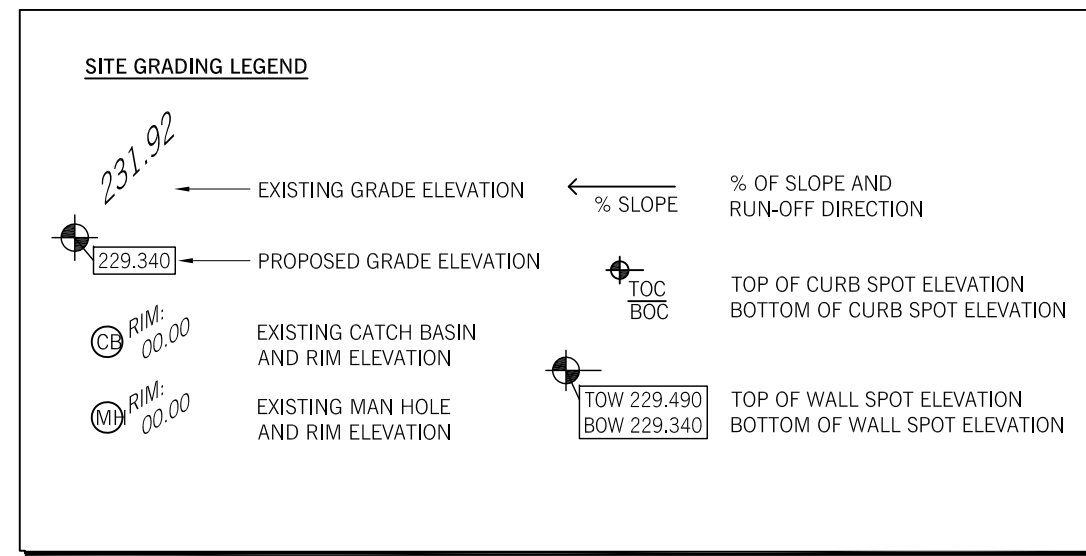
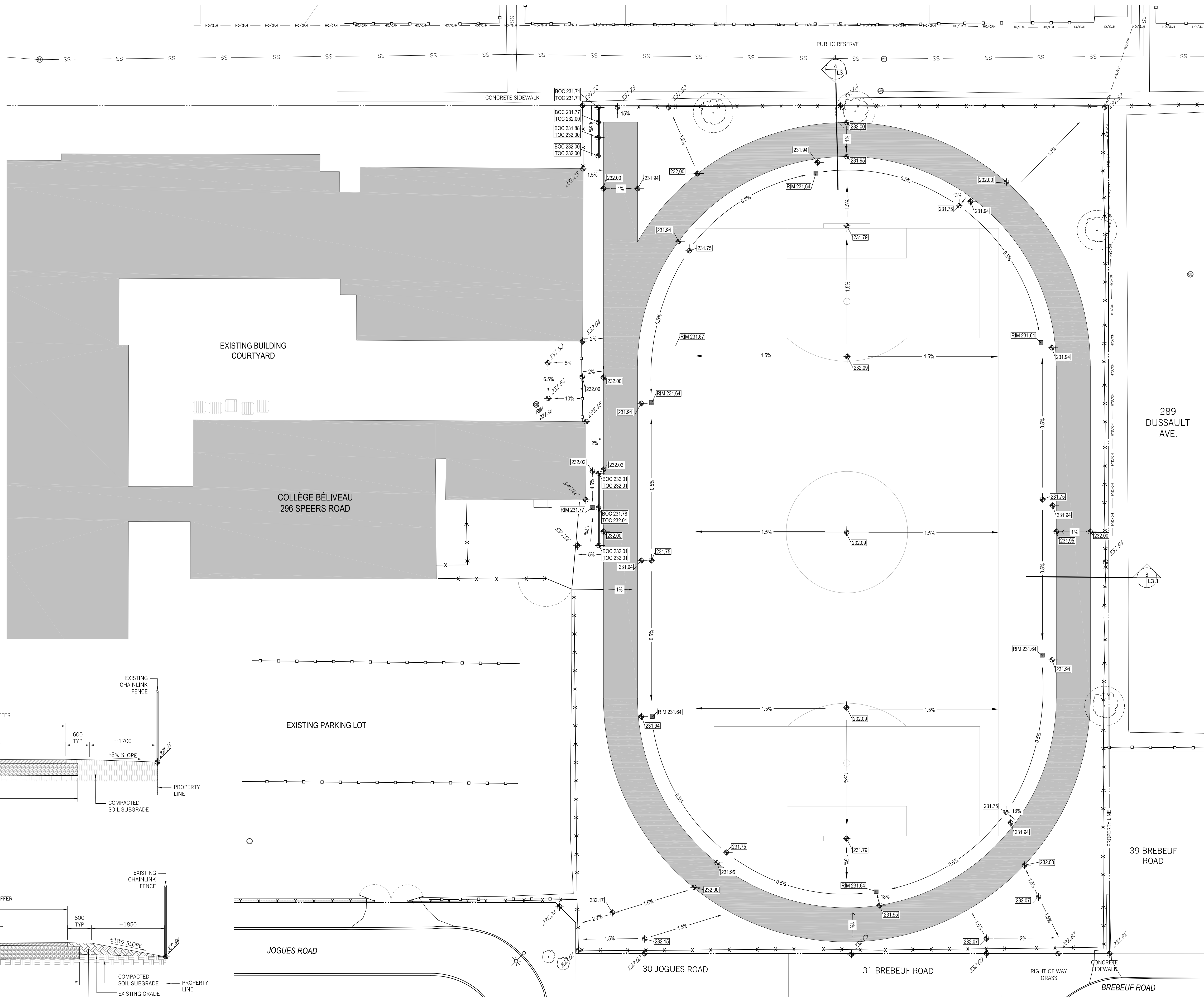

2 PERFORATED PIPE W/ FILTER CLOTH DRAINAGE SYSTEM
L3.1 1:20

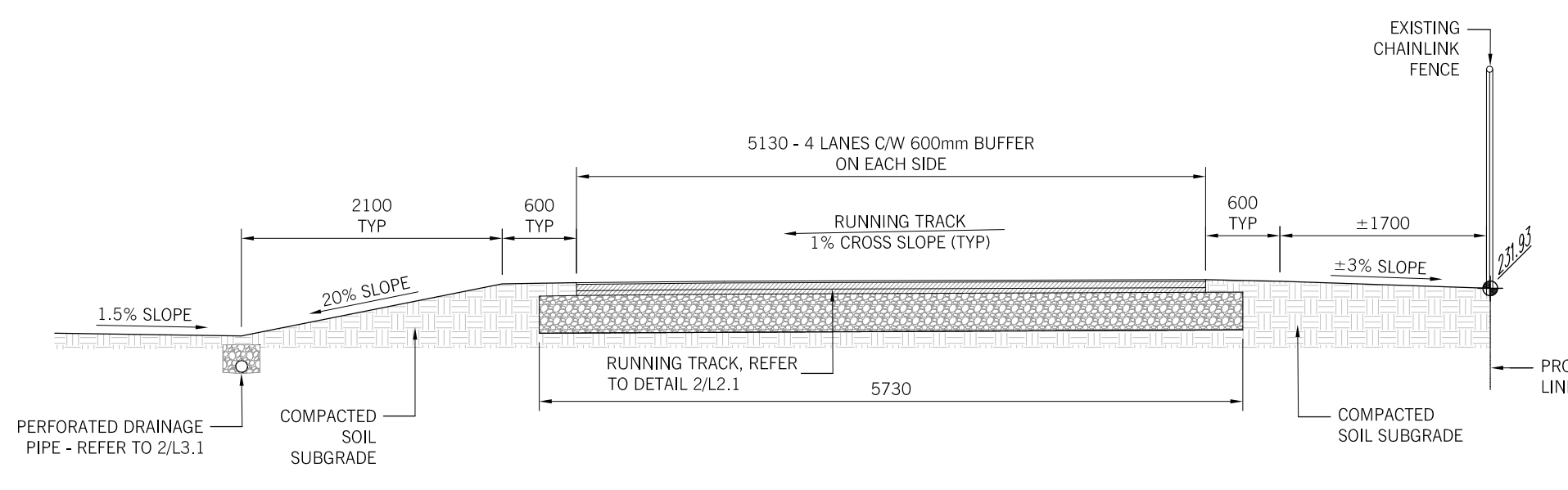

3 SECTION THROUGH TRACK - EAST SIDE
L3.1 1:50

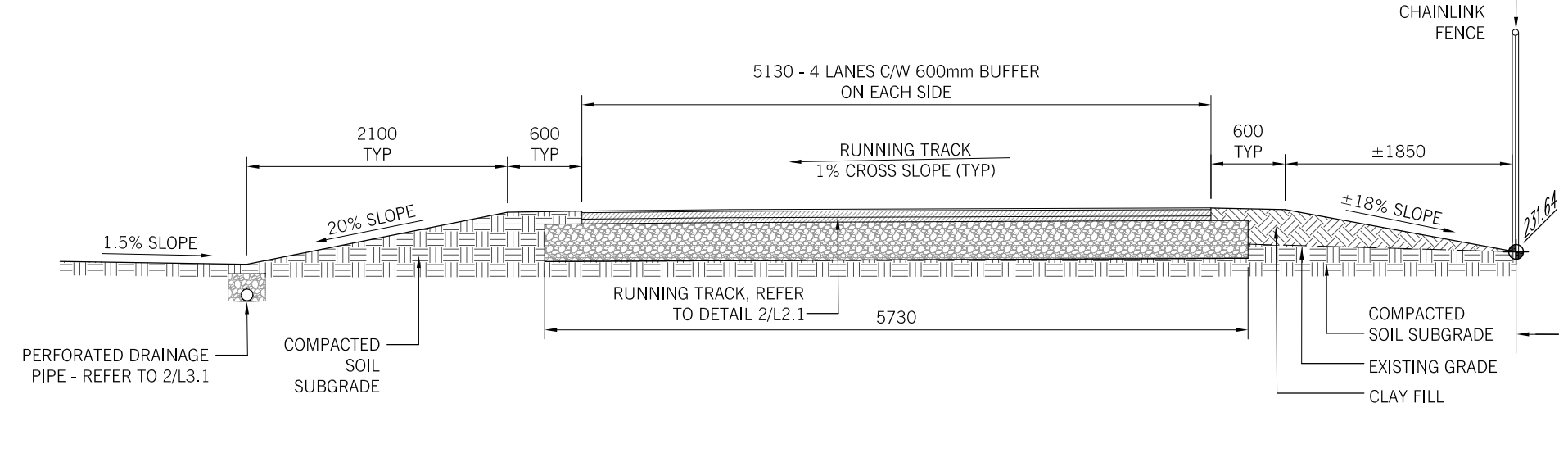

4 SECTION THROUGH TRACK - NORTH SIDE
L3.1 1:50

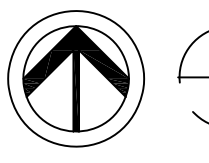
 **1 GRADING PLAN**
L3.1 1:300