

E			
D			
C			
B			
A	ISSUED FOR CONSTRUCTION	IR	BF 2024.06.28
Issued		By	Appd. YY.MM.DD
File Name:	21015-101	VF/IR	BC BF 24.06.28
		Dwn.	Chkd. Dsgn. YY.MM.DD



**ENGINEERS
 GEOSCIENTISTS
 MANITOBA**
 Certificate of Authorization
 Stantec Consulting Ltd.
 No. 1301

Winnipeg CITY OF WINNIPEG
**ROOF REPLACEMENT
 AT 210 PORTAGE AVENUE**
 Winnipeg, Manitoba

DEMOLITION ROOF PLAN

Project No. 115421015 Scale AS NOTED

Drawing No. Sheet of Revision

S-101 of 0

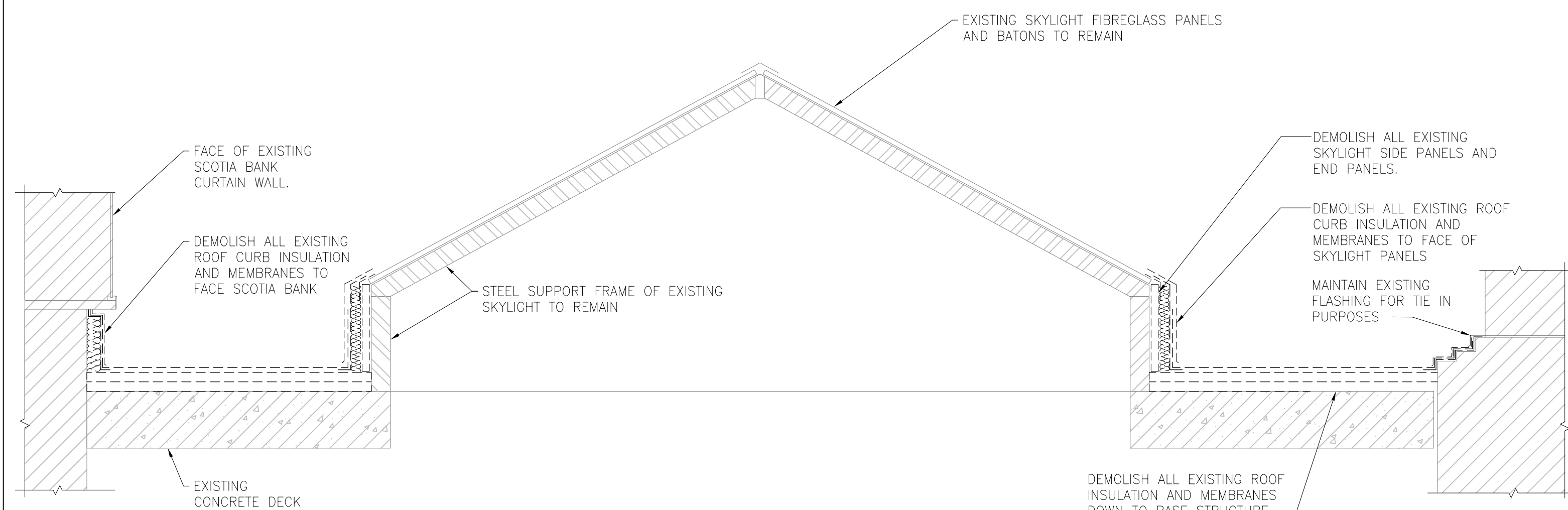

1 ROOF DEMOLITION
 S101 SCALE: 1:20

EXISTING ROOFING AND SKYLIGHT LINES ARE DIAGRAMMATIC AND ALL DETAILS MUST BE SITE CONFIRMED.

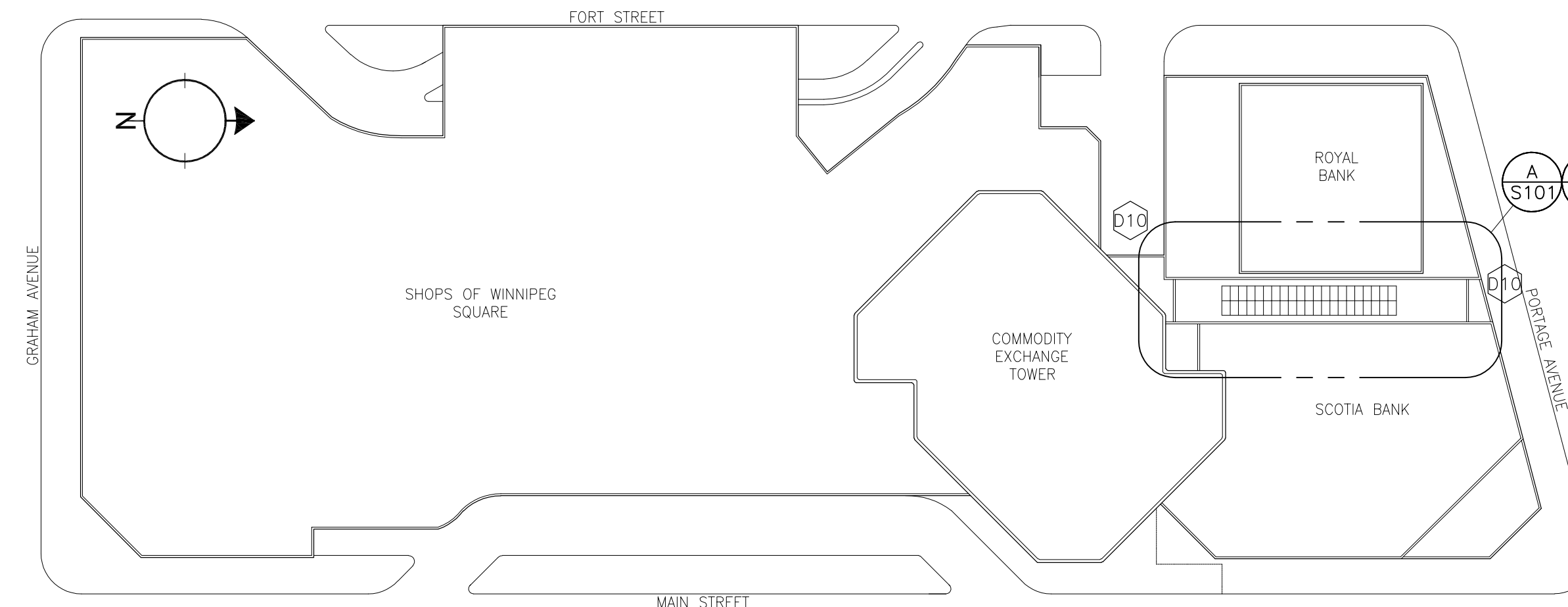

KEY PLAN
 N.T.S.

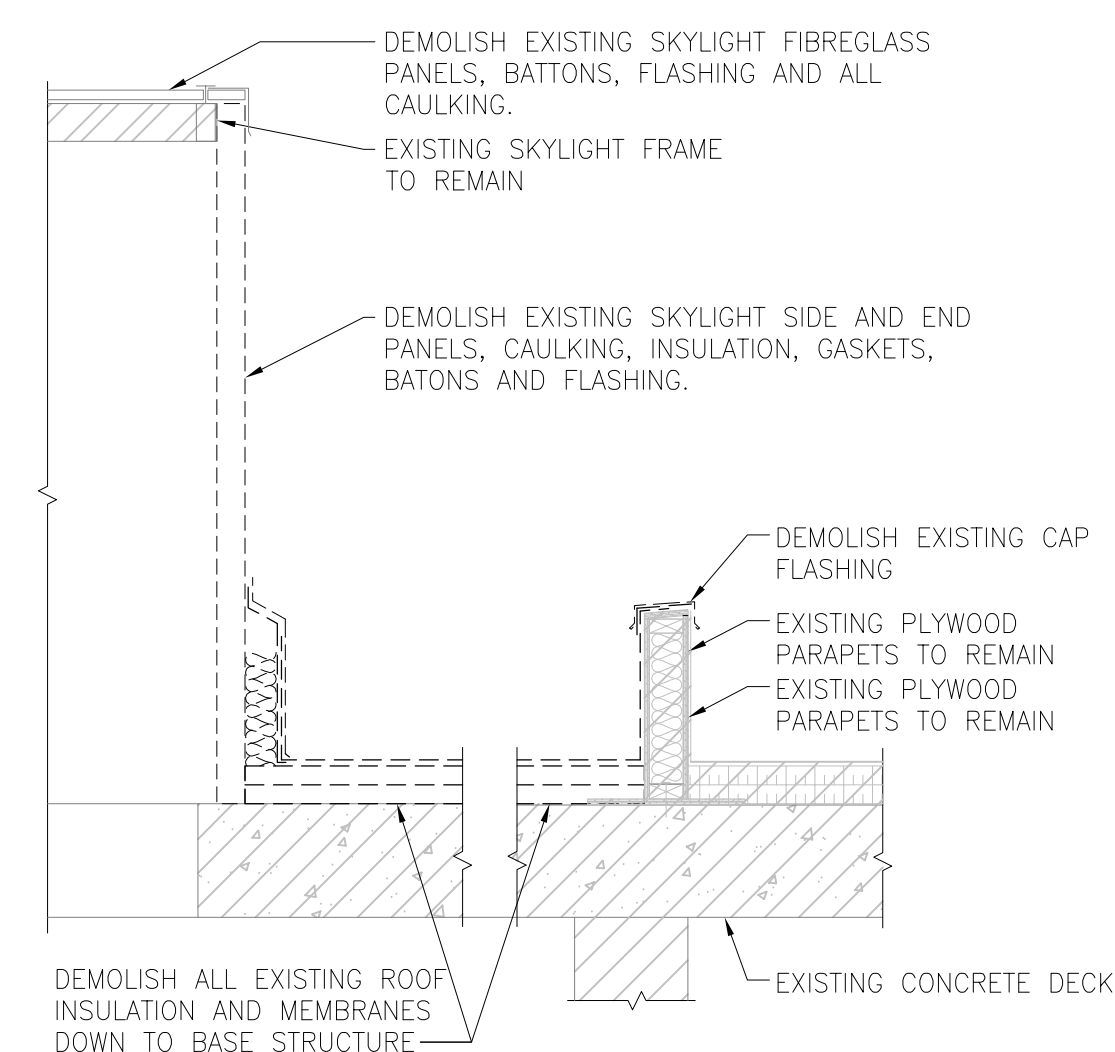

2 ROOF DEMOLITION
 S101 SCALE: 1:20

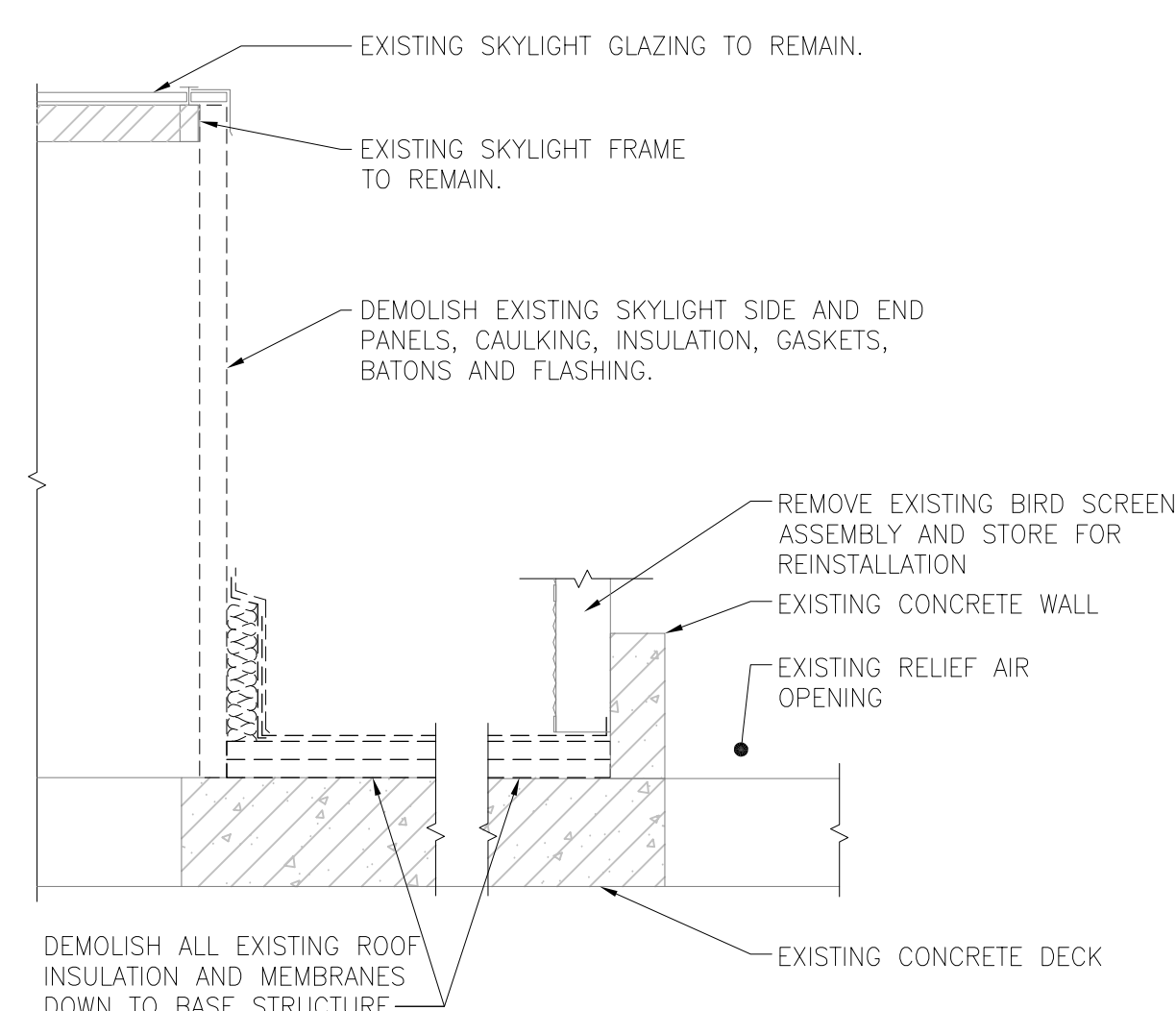

3 ROOF DEMOLITION
 S101 SCALE: 1:20

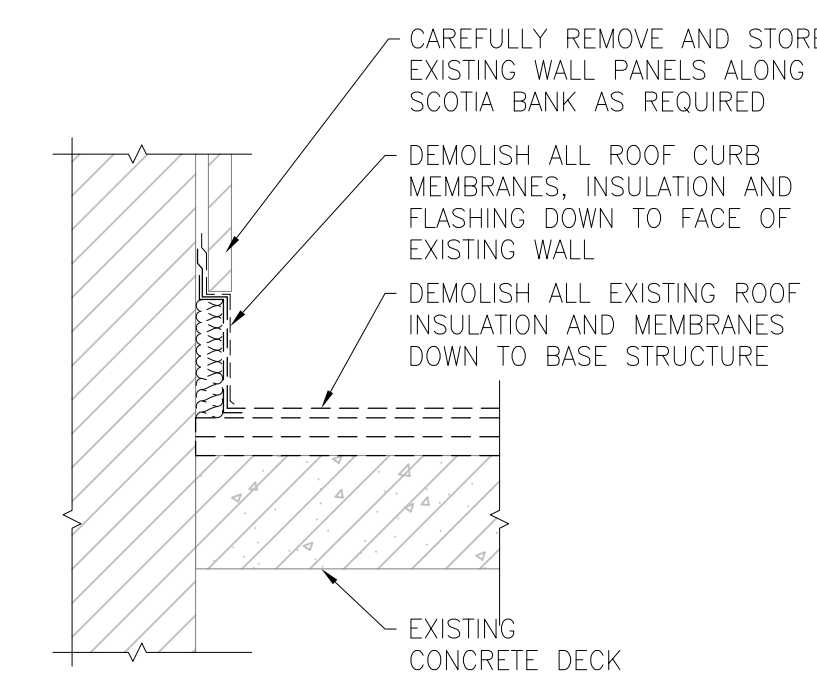

5 ROOF DEMOLITION
 S101 SCALE: 1:20

DEMOLITION KEY NOTES

- D1 EXISTING BULKHEAD TO REMAIN. DEMOLISH EXISTING CAP FLASHING.
- D2 STRIP AND REMOVE ROOF CURB ASSEMBLY TO FACE OF PARAPET.
- D3 STRIP AND REMOVE ROOF CURB ASSEMBLY AND SIDE PANELS OF SKYLIGHT.
- D4 STRIP AND REMOVE ROOFING ASSEMBLY DOWN TO CONCRETE DECK. INSPECT CONCRETE SURFACE FOR DELAMINATIONS OR CRACKING. REPAIR CRACKS AND DELAM'S PER DETAILS ON SHEET S-102.
- D5 DEMOLISH ROOF DRAIN. PIPING TO BE INSPECTED AND TO REMAIN IF ACCEPTABLE. PROVIDE NEW ROOF DRAIN PER DRAWING S-102.
- D6 REMOVE ALL EXISTING FLASHING AROUND BASE OF SKYLIGHT
- D7 INSULATION AND TRANSLUCENT FIBREGLASS PANES FROM EXISTING STEEL FRAME OF SKYLIGHT TO REMAIN
- D8 EXISTING AIR RELIEF HOOD TO REMAIN. TEMPORARILY REMOVE BIRD SCREEN AND STORE FOR REINSTALLATION
- D9 EXISTING CURTAIN WALL ABOVE TO REMAIN
- D10 APPROXIMATE LOCATION OF ROOF ACCESS FOR PERSONNEL AND MATERIALS. CONTRACTOR TO UTILIZE SCAFFOLDING AS REQUIRED. COORDINATE ACCESS w/ CITY. REFER TO SPECIFICATIONS.
- D11 PROVIDE SECURE FENCING AT SIDEWALK LEVEL AS REQUIRED TO RESTRICT ACCESS TO BUILDING ROOF. CONTRACTOR TO ACQUIRE ANY REQUIRED PERMITS TO TEMPORARY SIDEWALK OBSTRUCTION.

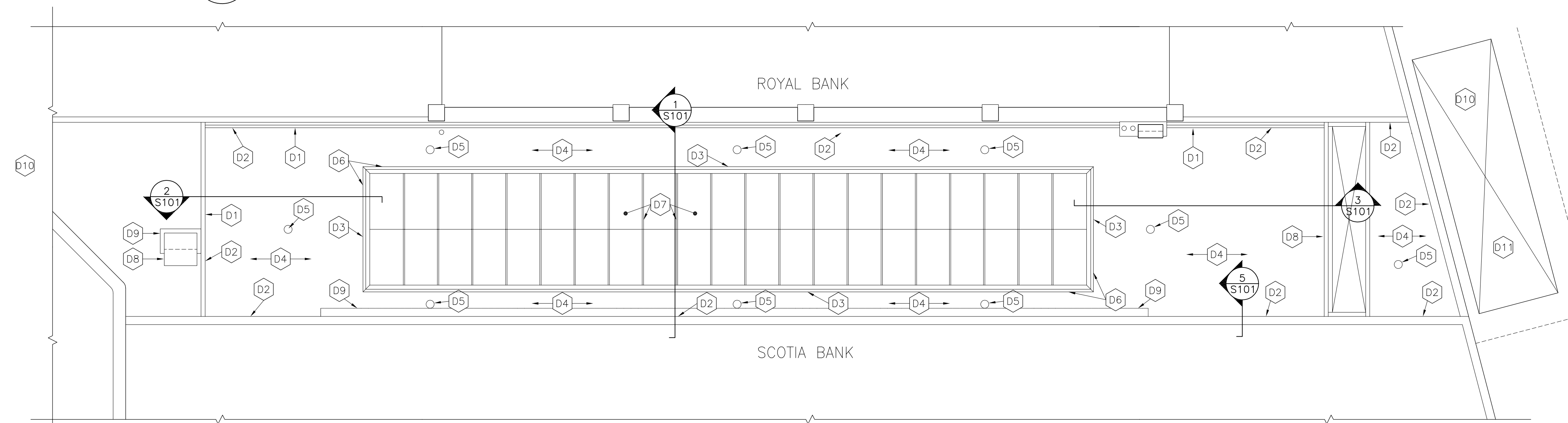

DEMOLITION PARTIAL ROOF PLAN
 A S-101 SCALE: 1:100