

REMOVE EX CURB INLET. INSTALL CATCH PIT AS PER SD-023 c/w BARRIER CURB & GUTTER FRAME & COVER. CONNECT TO EX CATCH BASIN w/ 2.9m OF DRAINAGE PIPE. RIM: 232.820; INV: 231.920

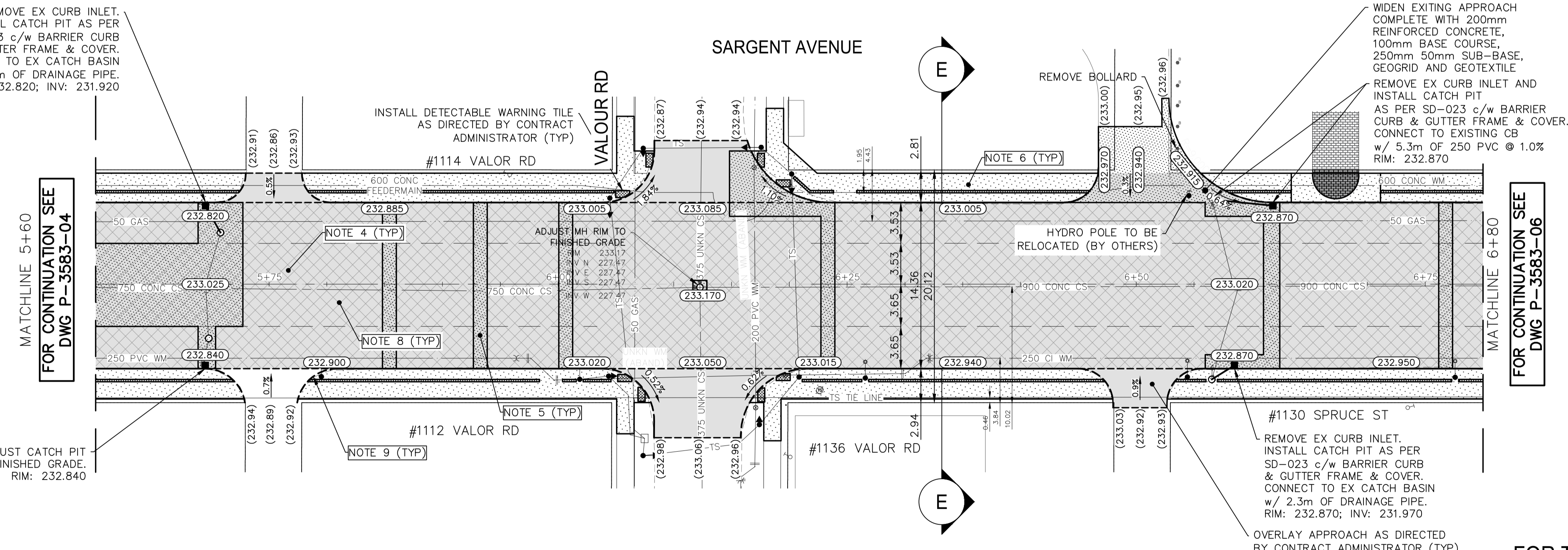

- NOTES:
- ALL WORK AND MATERIALS TO BE IN ACCORDANCE WITH THE LATEST REVISION OF THE CITY OF WINNIPEG STANDARD CONSTRUCTION SPECIFICATIONS.
  - CONTRACTOR TO CONFIRM THE LOCATION OF ALL UTILITIES/SERVICES IN THE FIELD PRIOR TO CONSTRUCTION.
  - ALL ROADWAY DIMENSIONS SHOWN ARE TO BACK OF CURB.
  - EXISTING ASPHALT TO BE PLANED AS SHOWN OR AS DIRECTED BY CONTRACT ADMINISTRATOR.
  - 200mm PARTIAL CONCRETE SLAB PATCHES SHOWN ARE ONLY A REPRESENTATIVE APPROXIMATION OF THE TENDERED QUANTITIES.
  - CONSTRUCT MONOLITHIC CURB AND SIDEWALK WITH BLOCKOUTS AS PER SD-228B, DETAIL 'A' AND AS DIRECTED BY CONTRACT ADMINISTRATOR.
  - ALL PRIVATE WALKWAYS TO BE ADJUSTED TO NEW SIDEWALK OR TOP OF CURB ELEVATION, AS DIRECTED BY THE CONTRACT ADMINISTRATOR.
  - PAVEMENT REPAIR FABRIC TO BE INSTALLED AS SHOWN OR AS DIRECTED BY CONTRACT ADMINISTRATOR.
  - MODIFIED BARRIER CURB TO BE CONSTRUCTED AT ALL INTERSECTION RADII AND ALLEY RADII.
  - CONTRACTORS TO TAKE PRECAUTIONARY STEPS TO PROTECT EXISTING TREES WITHIN THE LIMITS OF CONSTRUCTION FROM DAMAGE FROM CONSTRUCTION ACTIVITIES AS OUTLINED IN THE SPECIFICATIONS.
  - LAMP STANDARDS, HYDRO POLES, AND ANCHORS THAT REQUIRE TEMPORARY SUPPORT, REMOVAL OR REPLACEMENT, TO BE DONE SO AT THE EXPENSE OF THE CONTRACTOR AS NECESSARY.
  - ADJUST ALL WATER VALVES, HYDRANTS, MANHOLES, AND CATCH BASINS IN WORK AREA TO GRADE.

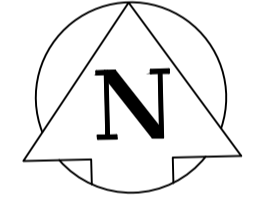

MATCHLINE 5+60  
FOR CONTINUATION SEE DWG P-3583-04

MATCHLINE 6+80  
FOR CONTINUATION SEE DWG P-3583-06

**METRIC**  
WHOLE NUMBERS INDICATE MILLIMETRES  
DECIMALIZED NUMBERS INDICATE METRES

**ENGINEERS GEOSCIENTISTS MANITOBA**  
Certificate of Authorization  
WSP Canada Inc.  
No. 5750

FOR TENDER PURPOSES ONLY  
NOT FOR CONSTRUCTION

EXISTING	LEGEND-PLAN	PROPOSED	EXISTING	LEGEND-PLAN	PROPOSED	EXISTING	LEGEND-PLAN	PROPOSED
---	WATER MAIN	---	⊗	VALVE	⊗	---	EDGE OF SIDEWALK	---
---	LAND DRAINAGE SEWER	---	⊕	CURB STOP	⊕	---	EDGE OF ASPHALT	---
---	WASTE WATER SEWER	---	⊖	HYDRO POLE & LIGHT STANDARD	⊖	---	EDGE OF CONCRETE	---
---	HYDRO	---	⊙	LIGHT STANDARD OR TRAFFIC SIGNAL	⊙	---	MODIFIED BARRIER CURB	---
---	GAS	---	⊚	HYDRO POLE / ANCHOR	⊚	---	BARRIER CURB	---
---	COMMUNICATIONS	---	⊛	FENCE	⊛	---	BARRIER CURB AND GUTTER	---
---	SIGNALS	---	⊜	PROPERTY LINE	⊜	---	PAVING STONE	---
○	MANHOLE	●	⊞	TEST HOLE / PAVEMENT CORE	⊞	---	CONCRETE SIDEWALK	---
□	CATCH BASIN/CATCH PIT	■	⊟	ELEVATIONS	⊟	---	CONCRETE SLAB	---
△	CURB INLET	▽	⊠	CURB RAMP	⊠	---	ASPHALT	---
◇	UTILITIES ADJUSTED	◇	⊡	DETECTABLE WARNING SURFACE TILE	⊡	---	MILLED SURFACE	---
⊕	HYDRANT	⊕	⊢			---	PAVEMENT REPAIR FABRIC	---
---	EXISTING	---	---			---		---

**LOCATIONS APPROVED UNDERGROUND STRUCTURES**

SIGNED BY: \_\_\_\_\_ DATE: \_\_\_\_\_

NO. REVISIONS

NO.	REVISIONS	DATE	BY
7			
6			
5			
4			
3			
2			
1			
0	ISSUED FOR TENDER	20250109	R.H.

G.M. TOH AT EMPRESS ST.  
ELEV. 235.046

**wsp**

DESIGNED BY: N.T.  
DRAWN BY: N.T. / R.H.

WSP Canada Inc.  
1600 Buffalo Place  
Winnipeg, MB R3T 6B8  
t. 204.477.6650  
f. 204.474.2864  
www.wsp.com

CHECKED BY: R.H.  
APPROVED BY: V.M.

HOR. SCALE: 1:250  
VERTICAL: 1:10

RELEASED FOR CONSTRUCTION

DATE: MARCH 2024

ENGINEER'S SEAL

CONSULTANT ACAD DWG. NO.  
CA0022819.5515-15

**THE CITY OF WINNIPEG**  
PUBLIC WORKS DEPARTMENT  
ENGINEERING SERVICES DIVISION

2025 PAVEMENT RENEWALS - SARGENT AVENUE  
MAJOR REHABILITATION  
STA. 5+60 TO STA. 6+80

CITY DRAWING NUMBER: P-3583-05  
SHEET 05 OF 08

TENDER NO. 504-2024

Jan 09, 2025 11:44pm P:\2024\CA0022819.5515 - Pavement Renewals Sargent, Elice V02 Drawings\03\_Work\_Dwg\CA0022819.5515\_Sargent\_Ave\_Plan&Profile.dwg -tab:504-2024\_Drawing\_P-3583-05-R0