

Jan 10, 2025 - 2:59pm
 P:\2024\CA0022819_5515 - Pavement Renewals Sargent, Elice\02 Drawings\03_Work_Dwg\CA0022819_5515_Sargent_Ave_Plan&Profile.dwg -tab:504-2024_Drawing_P-3583-08-00

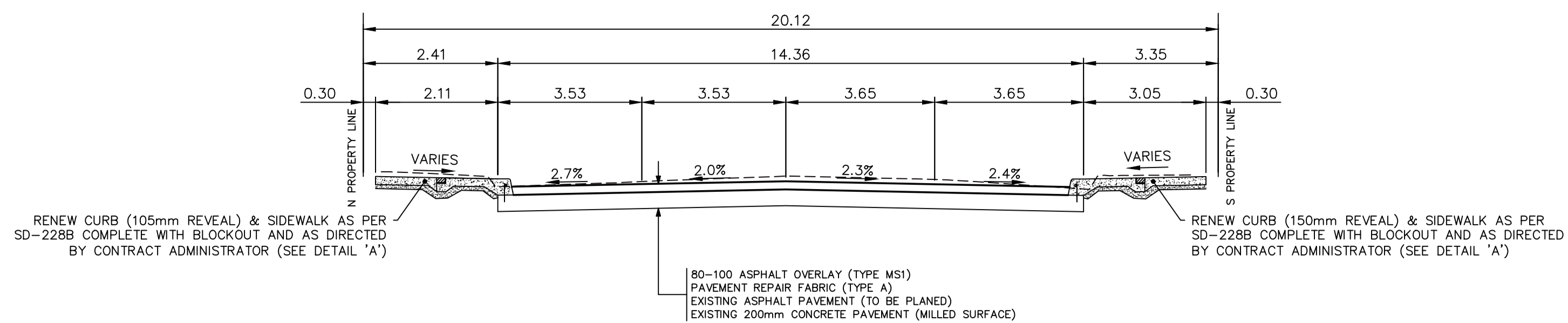

CROSS-SECTION 'A-A'
N.T.S.

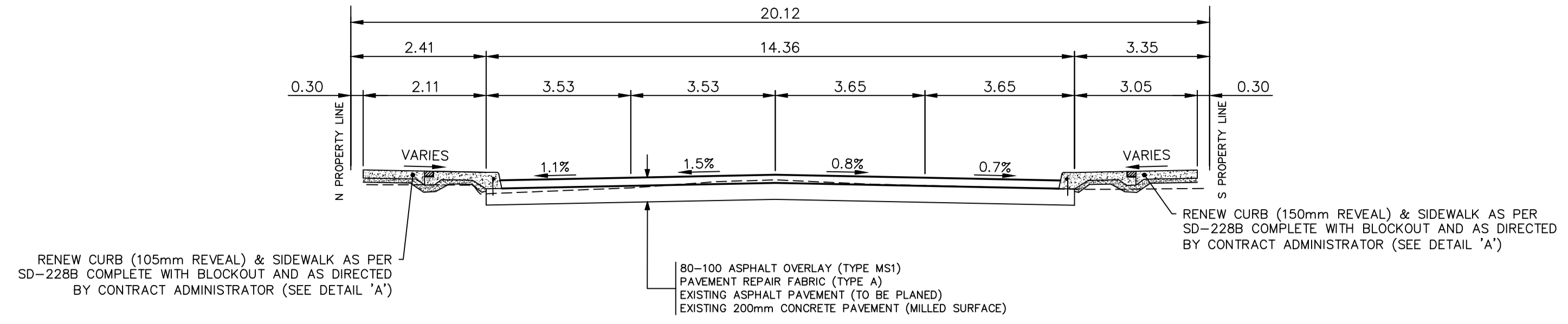

CROSS-SECTION 'B-B'
N.T.S.

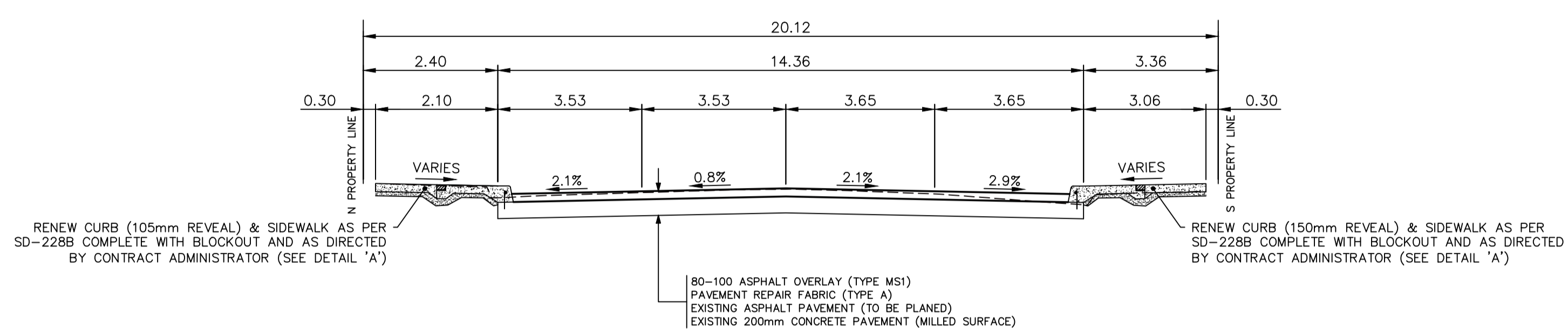

CROSS-SECTION 'C-C'
N.T.S.

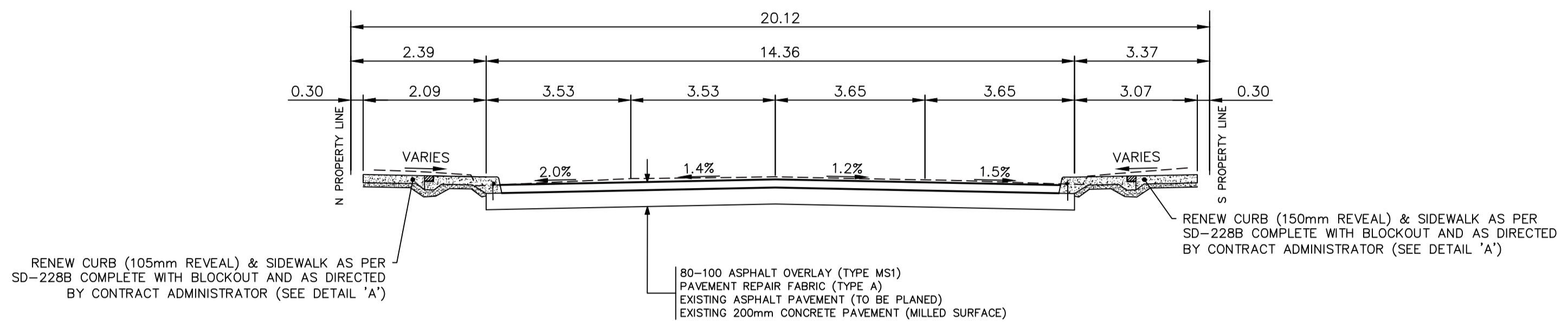

CROSS-SECTION 'D-D'
N.T.S.

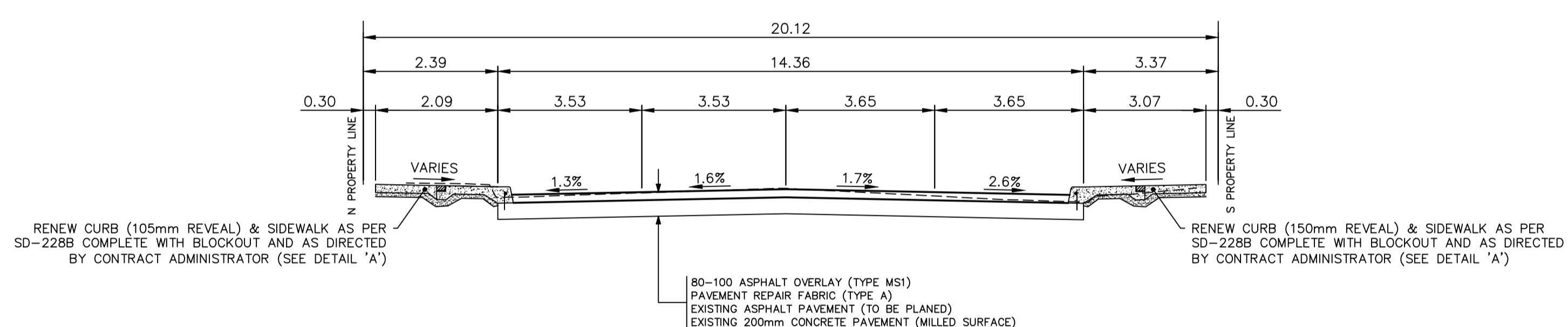

CROSS-SECTION 'E-E'
N.T.S.

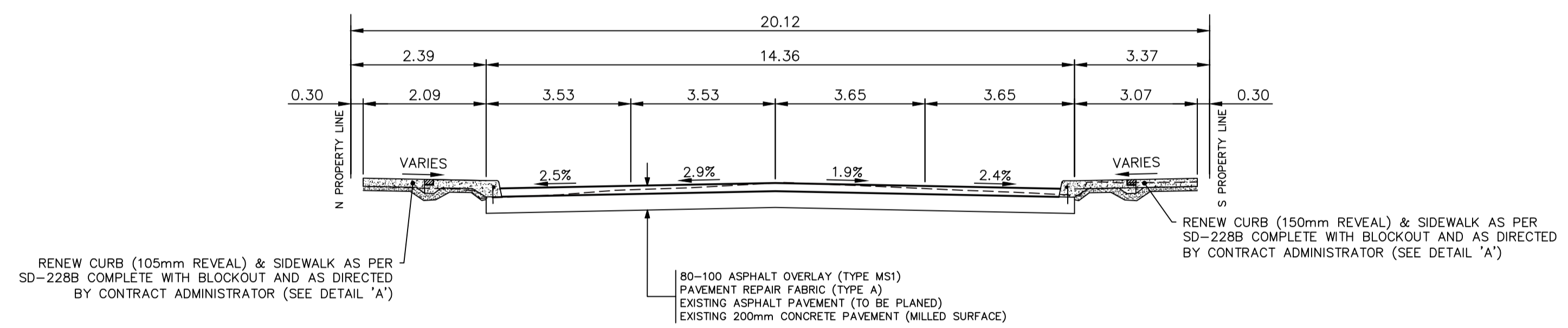

CROSS-SECTION 'F-F'
N.T.S.

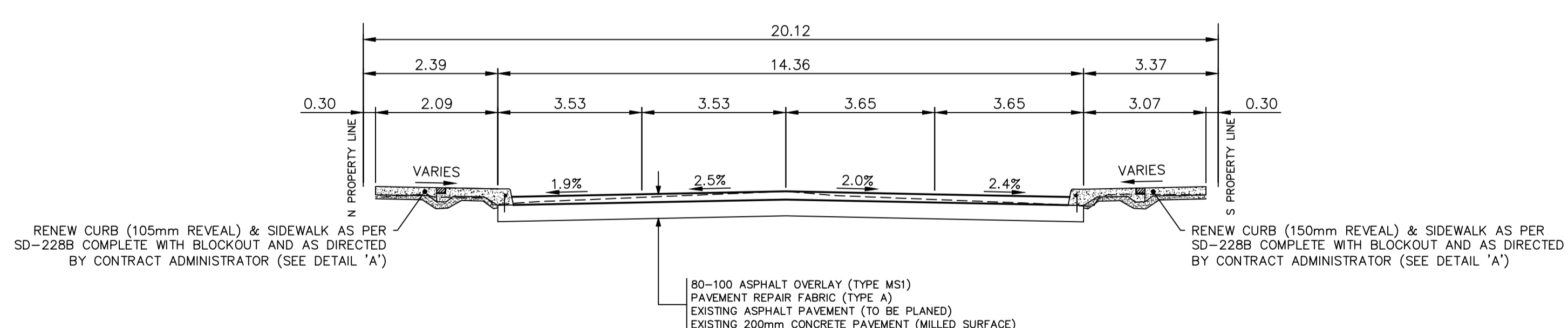

CROSS-SECTION 'G-G'
N.T.S.

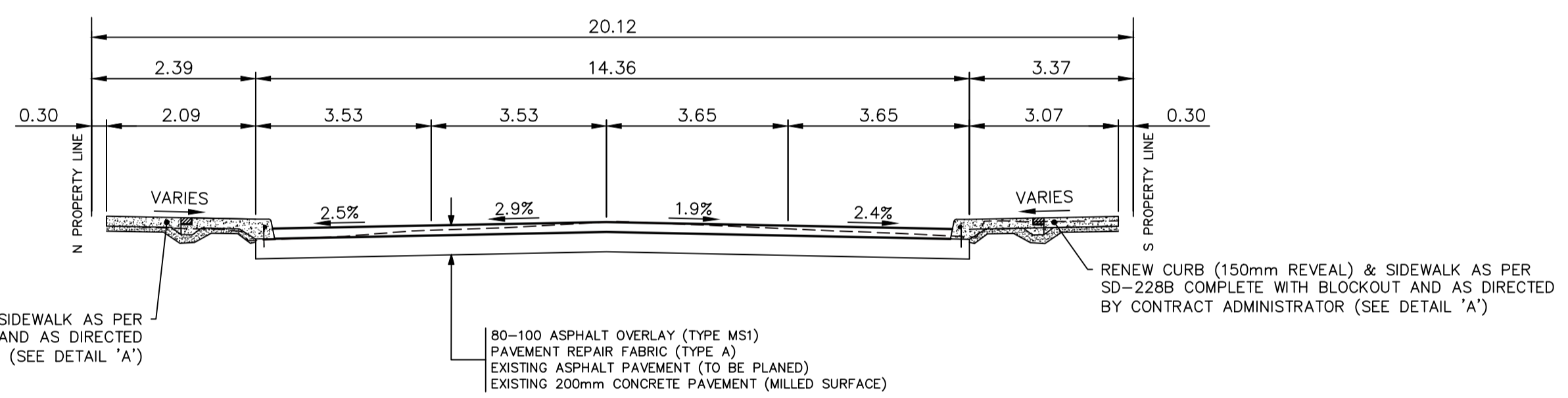

CROSS-SECTION 'H-H'
N.T.S.

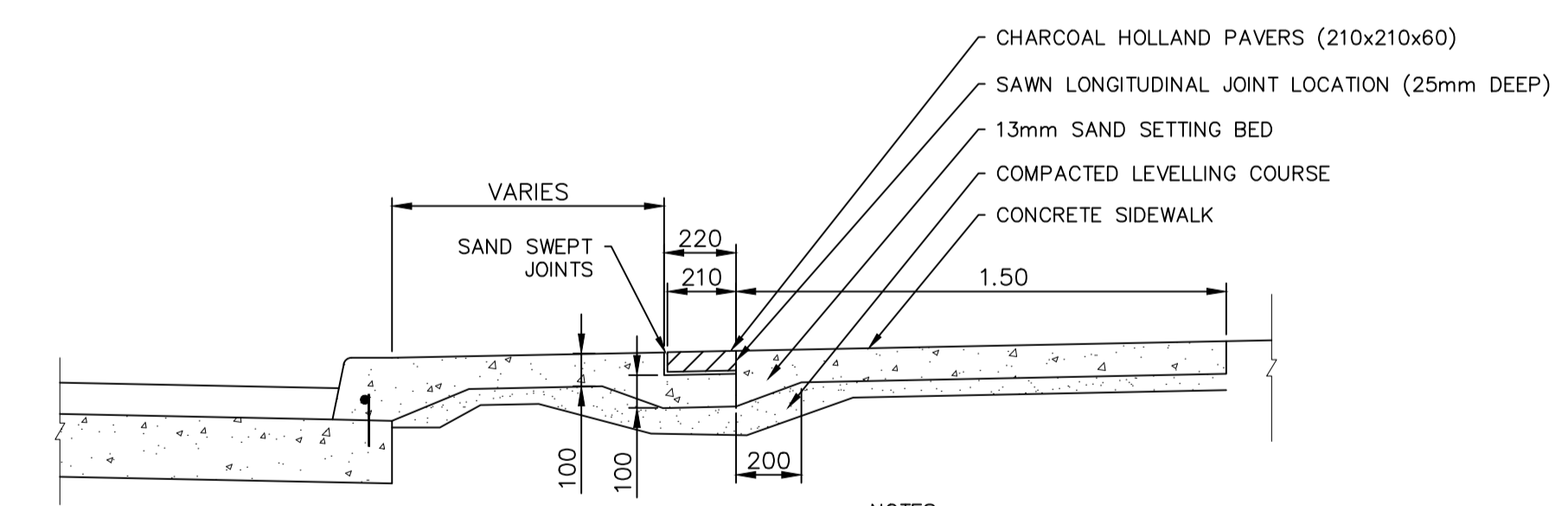

DETAIL 'A'
MONOLITHIC CURB & SIDEWALK
WITH BLOCKOUT
N.T.S.

- NOTES:**
- A 2.0m GAP IS REQUIRED AT ALL TRANSIT STOP HEADS
 - CONCRETE PLACED BELOW PAVERS FOR BLOCKOUTS TO BE FINISHED SMOOTH
 - PAVING BAND TO STOP 100mm SHORT OF ALL REQUIRED ISOLATIONS AND TERMINUS AT CURB LINES

METRIC
WHOLE NUMBERS INDICATE MILLIMETRES
DECIMALIZED NUMBERS INDICATE METRES

ENGINEERS GEOSCIENTISTS MANITOBA
Certificate of Authorization
WSP Canada Inc.
No. 5750

FOR TENDER PURPOSES ONLY
NOT FOR CONSTRUCTION

EXISTING	LEGEND-PLAN	PROPOSED	EXISTING	LEGEND-PLAN	PROPOSED	EXISTING	LEGEND-PLAN	PROPOSED
---	WATER MAIN	---	⊗	VALVE	⊗	---	EDGE OF SIDEWALK	---
---	LAND DRAINAGE SEWER	---	⊕	CURB STOP	⊕	---	EDGE OF ASPHALT	---
---	WASTE WATER SEWER	---	⊙	HYDRO POLE & LIGHT STANDARD	⊙	---	EDGE OF CONCRETE	---
---	HYDRO	---	⊙	LIGHT STANDARD OR TRAFFIC SIGNAL	⊙	---	MODIFIED BARRIER CURB	---
---	GAS	---	⊙	HYDRO POLE / ANCHOR	⊙	---	BARRIER CURB	---
---	COMMUNICATIONS	---	⊙	FENCE	⊙	---	BARRIER CURB AND GUTTER	---
---	SIGNALS	---	---	PROPERTY LINE	---	---	PAVING STONE	---
○	MANHOLE	●	⊕	TEST HOLE / PAVEMENT CORE	⊕	---	CONCRETE SIDEWALK	---
□	CATCH BASIN/CATCH PIT	■	⊕	ELEVATIONS	(231.000)	---	CONCRETE SLAB	---
△	CURB INLET	▼	⊕	CURB RAMP	⊕	---	ASPHALT	---
◇	UTILITIES ADJUSTED	△	⊕	DETECTABLE WARNING SURFACE TILE	⊕	---	MILLED SURFACE	---
⊕	HYDRANT	⊕	⊕			---	PAVEMENT REPAIR FABRIC	---

LOCATIONS APPROVED UNDERGROUND STRUCTURES

SIGNED BY: _____ DATE: _____

SUPV UG STRUCTURES

LOCATION OF UNDERGROUND STRUCTURES AS SHOWN ARE BASED ON THE BEST INFORMATION AVAILABLE BUT NO GUARANTEE IS GIVEN THAT ALL EXISTING UTILITIES ARE SHOWN OR THAT THE GIVEN LOCATIONS ARE EXACT CONFIRMATION OF EXISTENCE AND EXACT LOCATION OF ALL SERVICES MUST BE OBTAINED FROM THE INDIVIDUAL UTILITIES BEFORE PROCEEDING

NO.	REVISIONS	DATE	BY
7			
6			
5			
4			
3			
2			
1			
0	ISSUED FOR TENDER	2025-01-09	R.H.

wsp

DESIGNED BY: N.T.
DRAWN BY: N.T. / R.H.
HORIZ. SCALE: 1:250
VERTICAL SCALE: 1:10

DATE: MARCH 2024

WSP Canada Inc.
1600 Buffalo Place
Winnipeg, MB R3T 6B8
t. 204.477.6650
f. 204.474.2864
www.wsp.com

ENGINEER'S SEAL

S.C. MINY
REGISTERED PROFESSIONAL ENGINEER
2025-01-13

CONSULTANT ACAD DWG. NO.
CA0022819.5515-18

THE CITY OF WINNIPEG
PUBLIC WORKS DEPARTMENT
ENGINEERING SERVICES DIVISION

2025 PAVEMENT RENEWALS - SARGENT AVENUE
MAJOR REHABILITATION SECTIONS AND DETAILS

CITY DRAWING NUMBER: P-3583-08
SHEET 08 OF 08
TENDER NO. 504-2024