

Jan 09, 2025 - 2:02pm
F:\2024\CA0022819.5515 - Pavement Renewals Sargent, Ellice\02 Drawings\08_Sketches\Sargent_Ave_Traffic Management.dwg - tab: SIGNAGE PLAN_3

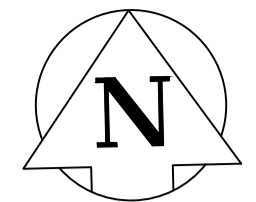
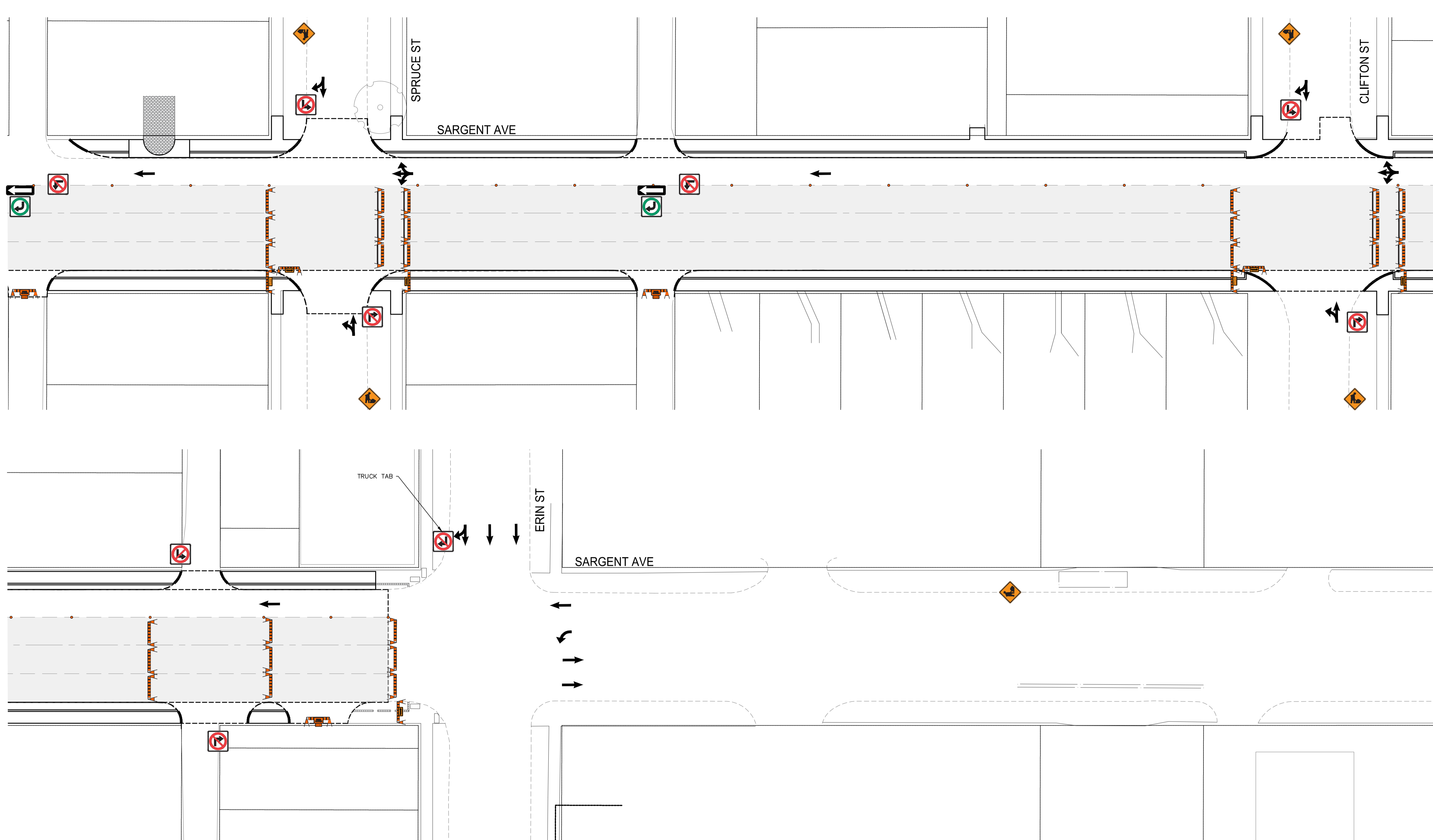

METRIC
WHOLE NUMBERS INDICATE MILLIMETRES
DECIMALIZED NUMBERS INDICATE METRES

FOR INFORMATION ONLY

**ENGINEERS
GEOSCIENTISTS
MANITOBA**
Certificate of Authorization
WSP Canada Inc.
No. 5750

NOTES:

1. ALL TRAFFIC SIGNAGE AND TEMPORARY TRAFFIC CONTROL TO CONFORM WITH THE LATEST REVISION OF THE CITY OF WINNIPEG MANUAL OF TEMPORARY TRAFFIC CONTROL ON CITY STREETS
2. CONTRACTOR SHALL MAINTAIN SAFE PEDESTRIAN ACCESS AND CROSSINGS. WHERE SIDEWALKS ARE LOCATED ON BOTH SIDES OF THE STREET, CONTRACTOR MUST MAINTAIN PEDESTRIAN ACCESS ON ONE SIDE AT ALL TIME.
3. CONSTRUCTION IS TO BE DONE LANE AT A TIME WITH TRAFFIC TO BE MAINTAINED IN THE EASTBOUND DIRECTION. TRAFFIC IN THE WESTBOUND DIRECTION IS TO BE CLOSED FOR THE DURATION OF THE PROJECT. WHEN CONSTRUCTION IS COMPLETED IN FIRST LANE, TRAFFIC WILL BE MOVED TO THE COMPLETED LANE AND TRAFFIC CONTROL WILL BE MIRRORED.
4. PARKING TO BE REMOVED AT THE TIME OF CONSTRUCTION



WSP Canada Inc.
1600 Buffalo Place
Winnipeg, MB R3T 6B8
t. 204.477.6650
f. 204.474.2864
www.wsp.com

CITY DRAWING NUMBER P-3583-11

SHEET 11 OF 15



THE CITY OF WINNIPEG
PUBLIC WORKS DEPARTMENT
ENGINEERING SERVICES DIVISION

2025 PAVEMENT RENEWALS - SARGENT AVENUE

TRAFFIC MANAGEMENT PLAN

SIGNAGE INDEX