

C:\Users\vas\OneDrive - Crosier Kilgour\General - 2024-0410 - Portage & Main Pedestrian Reopening\06 Drawings\2024-0410_PORTAGE-MAIN.dwg

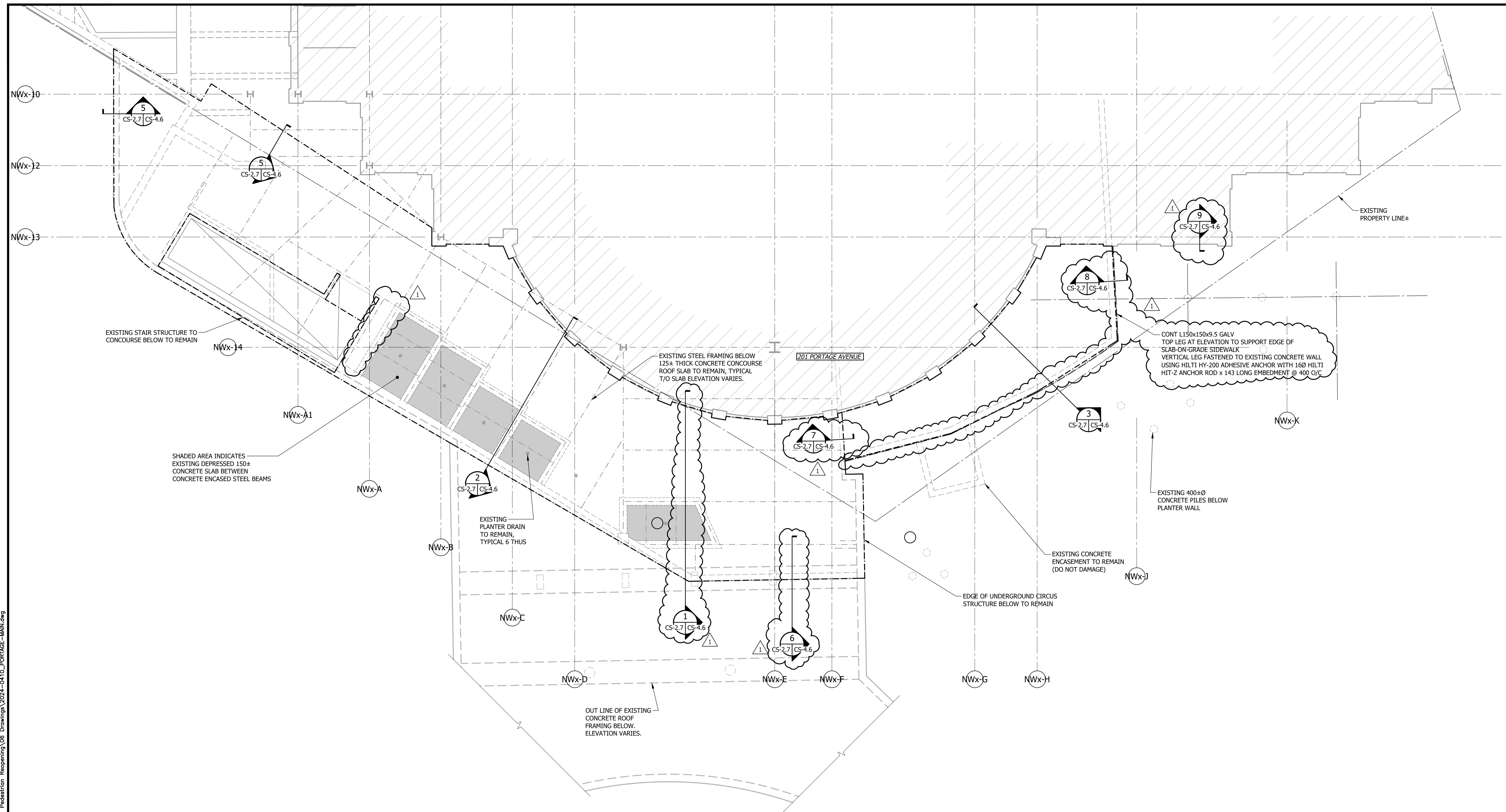

LEGEND

MARK	DESCRIPTION
---	APPROXIMATE EXTENT OF WATERPROOFING



NORTHWEST CORNER - WATERPROOFING PLAN

1:100

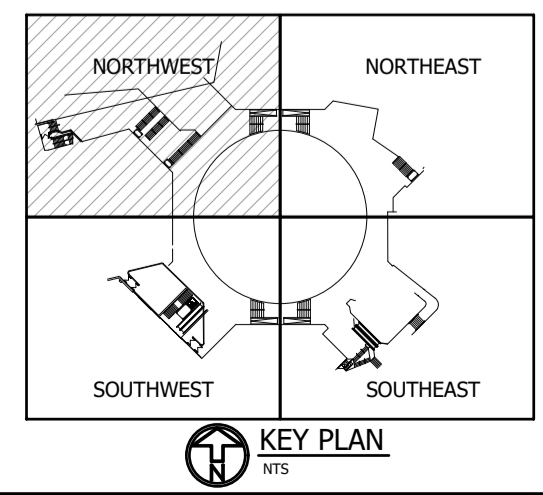

B.M. ELEV.	DESIGNED BY	DATE	BY
	SMC/DJM	24-09-27	SMC
	DRAWN BY	24-09-09	SMC
	CHECKED BY		
	APPROVED BY		
	HOR. SCALE		
	VERTICAL		
	DATE	2024-09-27	

NO.	REVISIONS	DATE	BY
1	ADDENDUM 01	24-09-27	SMC
0	ISSUED FOR TENDER	24-09-09	SMC

Crosier Kilgour
Structural Engineering & Building Performance

RELEASED FOR CONSTRUCTION

DATE

ENGINEER'S SEAL
CONSULTANT PROJECT NUMBER
2024-0410

THE CITY OF WINNIPEG
PUBLIC WORKS DEPARTMENT

PORTAGE & MAIN PEDESTRIAN OPENING

NORTHWEST CORNER WATERPROOFING PLAN

CITY DRAWING NUMBER

SHEET **CS-08** OF **25**

CONSULTANT DRAWING NUMBER

CS-2.7