

- 2' HDPE CORRUGATED CONDUIT
- 1) INSTALL SHALLOW ABOVE BEAMS
 - 2) DRILL DIRECTLY INTO SIDE OF PIT
 - 3) TIGHT BEND RADIUS INTO POLE (ENSURE CONDUIT DOES NOT KINK)
 - 4) MECHANICAL (STEEL PLATE) PROTECTION REQUIRED

UNDERGROUND ROOF FRAMING
 UNDERGROUND BEAM APPROXIMATELY 150mm BELOW SIDEWALK (TYP.)
 OUTLINE OF DEPRESSED ROOF SLAB BETWEEN UNDERGROUND BEAMS
 UNDERGROUND STRUCTURAL WALL
 UNDERGROUND CONCOURSE OUTLINE (TYP.)
 300 W.M. (ABAND.)
 HYDRO (ABAND.)
 150 GAS (ABAND.)

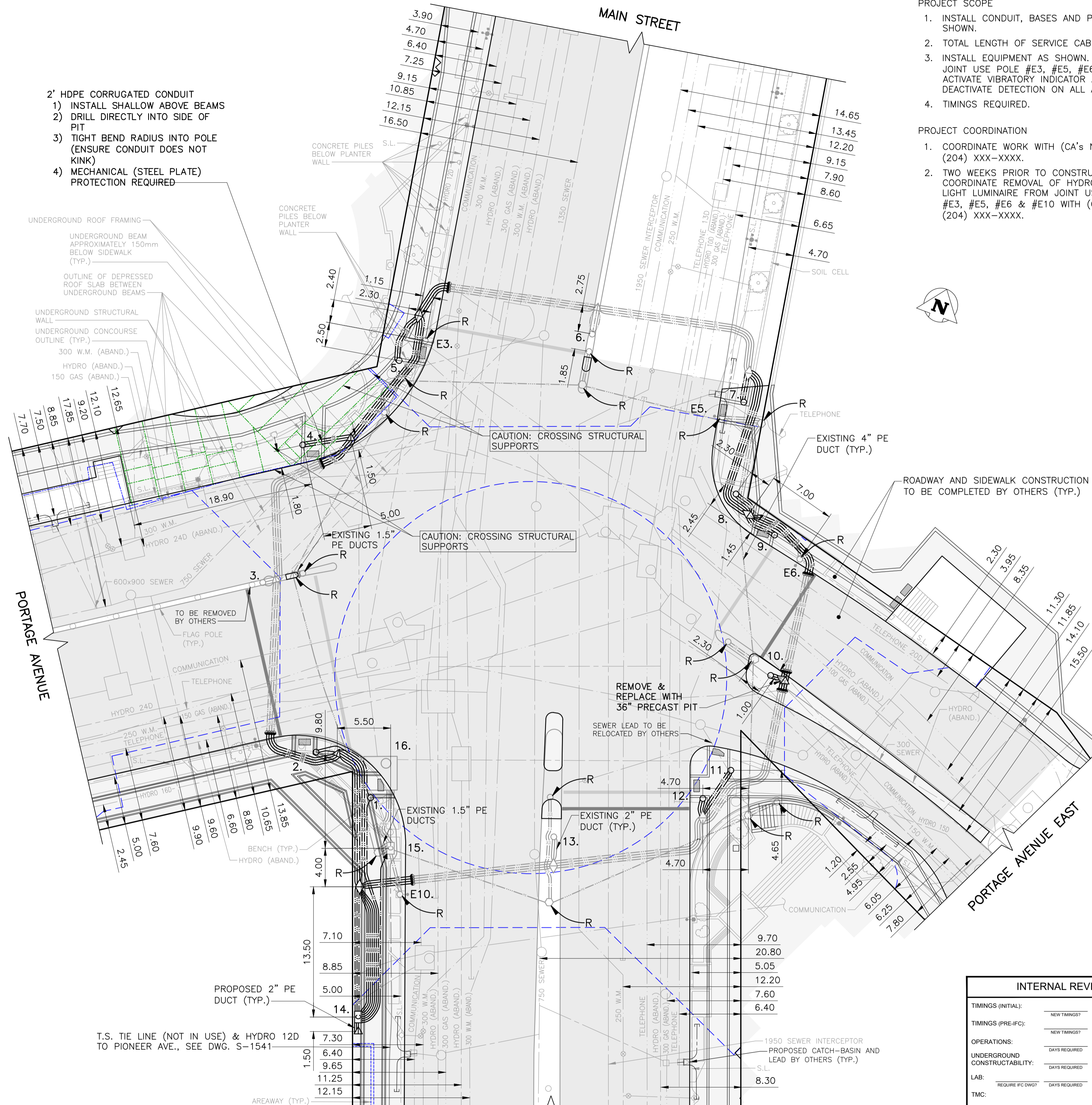

PLAN VIEW: UNDERGROUND CONSTRUCTION
 1:250

CONSTRUCTION NOTES:

- PROJECT SCOPE**
1. INSTALL CONDUIT, BASES AND PITS AS SHOWN.
 2. TOTAL LENGTH OF SERVICE CABLE: 35m.
 3. INSTALL EQUIPMENT AS SHOWN, REMOVE JOINT USE POLE #E3, #E5, #E6 & #E10. ACTIVATE VIBRATORY INDICATOR AND DEACTIVATE DETECTION ON ALL APBs.
 4. TIMINGS REQUIRED.
- PROJECT COORDINATION**
1. COORDINATE WORK WITH (CA'S NAME), (204) XXX-XXXX.
 2. TWO WEEKS PRIOR TO CONSTRUCTION, COORDINATE REMOVAL OF HYDRO STREET LIGHT LUMINAIRE FROM JOINT USE POLE #E3, #E5, #E6 & #E10 WITH (CA'S NAME), (204) XXX-XXXX.

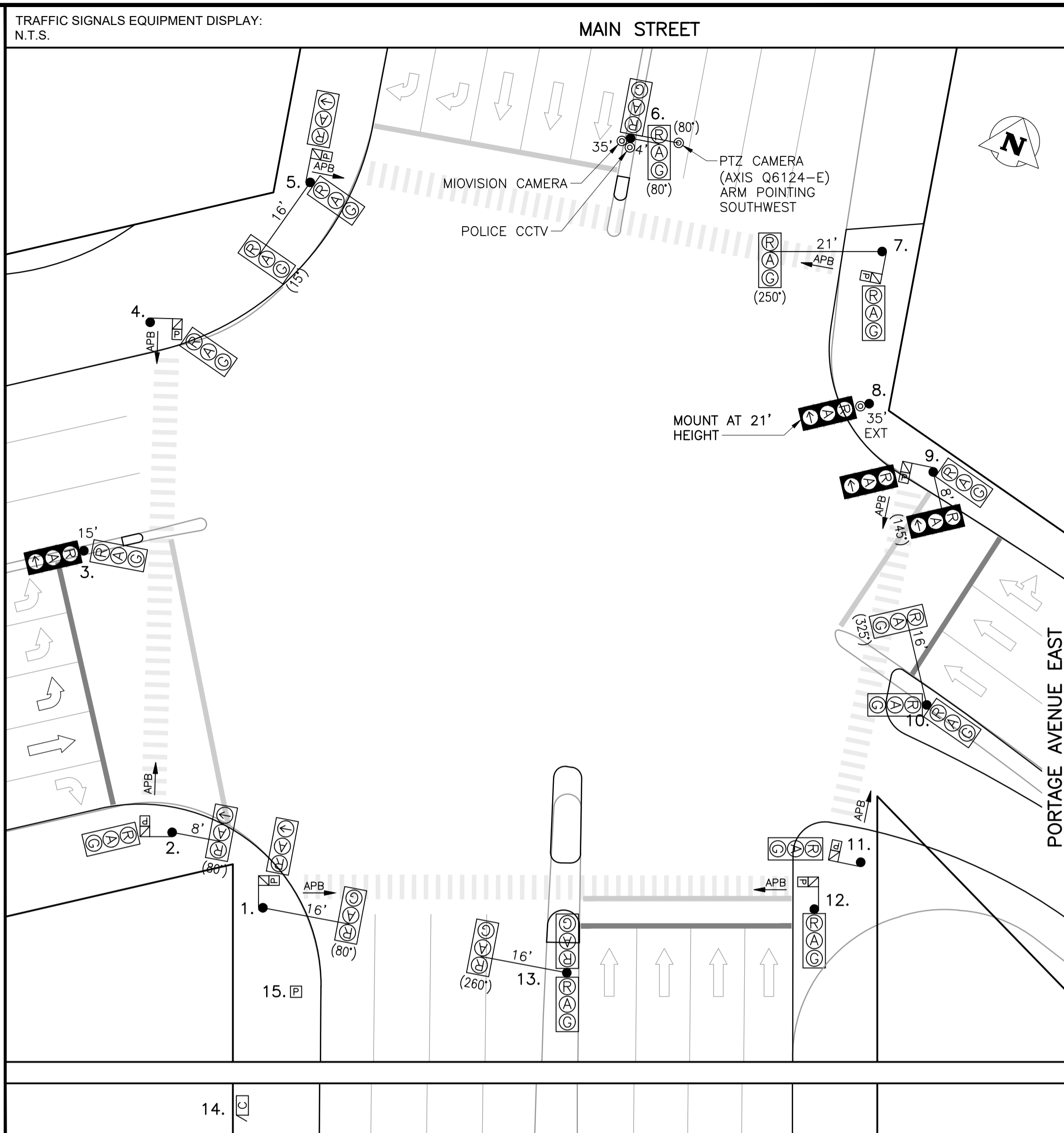

EQUIPMENT DISPLAY LEGEND				EQUIPMENT LIST				EQUIPMENT LIST			
EXISTING	PROPOSED (AS SHOWN BELOW)	NO.	EQUIPMENT LIST	ARM	BASE	B.B.	NO.	EQUIPMENT LIST	ARM	BASE	B.B.
PEDESTRIAN HEAD WITH PCS	PEDESTRIAN CORRIDOR BOX	1.	CANTILEVER W/ PEDESTRIAN LIGHTING *CUSTOM BASE TO BE DESIGNED	16'	COD*	DC	9.	CANTILEVER W/ PEDESTRIAN LIGHTING *CUSTOM BASE TO BE DESIGNED	8'	COD*	DC
RRFB (PHASE 'W' OR 'E')	VEHICLE DETECTION AREA	2.	CANTILEVER W/ PEDESTRIAN LIGHTING *CUSTOM BASE TO BE DESIGNED	8'	COD*	DC	10.	CANTILEVER W/ PEDESTRIAN LIGHTING *CUSTOM BASE TO BE DESIGNED	16'	COD*	DC
APB SINGLE DIRECTION	APB DUAL DIRECTION (2 SEPARATE SPEAKERS)	3.	15' SIGNAL		G	G	11.	CANTILEVER W/ PEDESTRIAN LIGHTING *CUSTOM BASE TO BE DESIGNED		COD*	DC
TRAFFIC SIGNAL HEAD	TRAFFIC SIGNAL POLE	4.	CANTILEVER W/ PEDESTRIAN LIGHTING *CUSTOM BASE TO BE DESIGNED		COD*	DC	12.	CANTILEVER W/ PEDESTRIAN LIGHTING *CUSTOM BASE TO BE DESIGNED		COD*	DC
WOOD POST	ELECTRONIC DISPLAY	5.	CANTILEVER W/ PEDESTRIAN LIGHTING	16'	OD	DC	13.	CANTILEVER	16'	OD	DC
RED FLASHER	RED FLASHER	6.	35' SIGNAL FOR PTZ CAMERA, POLICE CCTV AND MIOVISION CAMERA	4'	G	GD	14.	332 CABINET/2070 CONTROLLER UPS SIDEMOUNT S6 CABINET			
AMBER FLASHER (CIRCUIT NUMBER)	AMBER FLASHER (CIRCUIT NUMBER)	7.	CANTILEVER W/ PEDESTRIAN LIGHTING	21'	OD	FIXED	15.	DISCONNECT PEDESTAL			
LUMINAIRE	LUMINAIRE	8.	CANTILEVER W/ 35' VERTICAL EXTENSION FOR DCSP CCTV *CUSTOM BASE TO BE DESIGNED		COD*	DC	16.	HYDRO MH No. MN-49 SERVICE: T.S. TIE LINE SOUTH			
CAMERA	CAMERA	E3.	35' SIGNAL (TO BE REMOVED)		OTHER	-	E3.	35' SIGNAL (TO BE REMOVED)		OTHER	-
LOW ARM (SHOWN FROM CENTRE)	LOW ARM (SHOWN FROM CENTRE)	E5.	35' SIGNAL (TO BE REMOVED)		OTHER	-	E5.	35' SIGNAL (TO BE REMOVED)		OTHER	-
HIGH ARM (SHOWN FROM SIDE)	HIGH ARM (SHOWN FROM SIDE)	E6.	35' SIGNAL (TO BE REMOVED)		OTHER	-	E6.	35' SIGNAL (TO BE REMOVED)		OTHER	-
		E10.	35' SIGNAL (TO BE REMOVED)		OTHER	-	E10.	35' SIGNAL (TO BE REMOVED)		OTHER	-

TRAFFIC SIGNALS UNDERGROUND LEGEND				SIGNAL BASE BOLT SQUARE TYPES			
EXISTING	ABANDONED	PROPOSED (AS SHOWN BELOW)	DISCONNECTED (LOOPS ONLY)	BOLT SQUARE (B.S.) DIA.			
1 1/2" PE CONDUIT		POLE BASE		TYPE "A" - 8 1/8"			
2" PE CONDUIT		WOOD POST		TYPE "B" - 8 3/4"			
4" PVC CONDUIT		CONTROLLER BASE		TYPE "C" - 8 1/8" SCREW TYPE			
AERIAL / BURIED CABLE		PEDESTAL BASE		TYPE "D" - 12 3/4", 1 1/4" DIA. BOLTS, 24" DIA.			
CONDUIT STUB		TERMINAL BASE		TYPE "OD" - 12 3/4", 1 1/4" DIA. BOLTS, 28" DIA.			
BREAK-IN		SERVICE BOX (PIT)		TYPE "POD" - 12 3/4", PRECAST, 1 1/4" DIA. BOLTS, 28" DIA.			
SPICE		24" PRECAST PIT		TYPE "E" - 9 9/16" SCREW TYPE			
SAW-CUT LOOPS		30" PRECAST PIT		TYPE "F" - 9 9/16"			
PERFORMED LOOPS		36" PRECAST PIT		TYPE "G" - 8 1/8", 1 1/4" DIA. BOLTS, 89mm PROJ.			
		REMOVAL		TYPE "GS" - 8 1/8", 1 1/4" DIA. BOLTS, 76mm PROJ.			
				TYPE "H" - 9 7/8" SCREW TYPE			
				TYPE "I" - 7 3/4"			
				TYPE "J" - 10 5/8", 1 1/4" DIA. BOLTS			
				TYPE "K" - 10 5/8", PRECAST, 1 1/4" DIA. BOLTS			
				TYPE "L" - 6", 5/8" DIA. BOLTS			
				TYPE "PM" - 8 1/8", PRECAST, 5/8" DIA. BOLTS			

INTERNAL REVIEW			
TIMINGS (INITIAL):	NEW TIMINGS?	DATE	INITIALS
TIMINGS (PRE-FCI):	NEW TIMINGS?	DATE	INITIALS
OPERATIONS:	DAYS REQUIRED	DATE	INITIALS
UNDERGROUND CONSTRUCTABILITY:	DAYS REQUIRED	DATE	INITIALS
LAB:	REQUIRE PCD/DWG?	DAYS REQUIRED	DATE
TMC:		DATE	INITIALS
STREET LIGHTING:		DATE	INITIALS
TRAFFIC MANAGEMENT:		DATE	INITIALS

EXISTING	LEGEND	PROPOSED	EXISTING	LEGEND	PROPOSED	EXISTING	LEGEND	PROPOSED
150 W.M.	WATERMAIN	150 W.M.	PROPERTY LINE	TELEPHONE	TELEPHONE	TELEPHONE	TELEPHONE	TELEPHONE
HYDRANT	HYDRANT	SHUTOFF VALVE	ROADWAY	COMMUNICATION	COMMUNICATION	COMMUNICATION	COMMUNICATION	COMMUNICATION
VALVE	VALVE	SEWER	SIDEWALK					
300 SEWER	SEWER	MANHOLE	CURB & CURB RAMP					
MANHOLE	MANHOLE	CATCH BASIN	WARNING TILE					
CATCH BASIN	CATCH BASIN	CURB INLET	BUILDING					
CURB INLET	CURB INLET	HYDRO	TREE					
HYDRO	HYDRO	100 GAS	GAS					
100 GAS	100 GAS							

UNDERGROUND STRUCTURES	
PENDING	DATE (YYYY/MM/DD)
PENDING	
WATER & WASTE REVIEW ID	

CONSTRUCTION REVISIONS			
1	ISSUED FOR ADDENDUM 02	2024/09/19	R.S.
NO.	REVISION	DATE (YYYY/MM/DD)	BY

ACCOUNTS:	
WT PENDING	
DESIGNED BY	R.S.
DRAWN BY	C.H.
CHECKED BY	

PRELIMINARY
 NOT FOR CONSTRUCTION

THE CITY OF WINNIPEG
 PUBLIC WORKS DEPARTMENT
 TRANSPORTATION DIVISION

TRAFFIC SIGNALS
 MAIN ST. & PORTAGE AVE.

UNITS: ALL DIMENSIONS ARE IN METERS UNLESS OTHERWISE NOTED
 DRAWING NUMBER: S-1109