

ISO A1 - 594mm x 841mm
U:\11250007\409_CAD\McGregor\7_Sheets\2303678-McGregor-PP.dwg
Last Saved: 1/7/2025 11:02 AM by kberand
Plotted: 1/7/2025 1:27 PM by Barand, Kevin

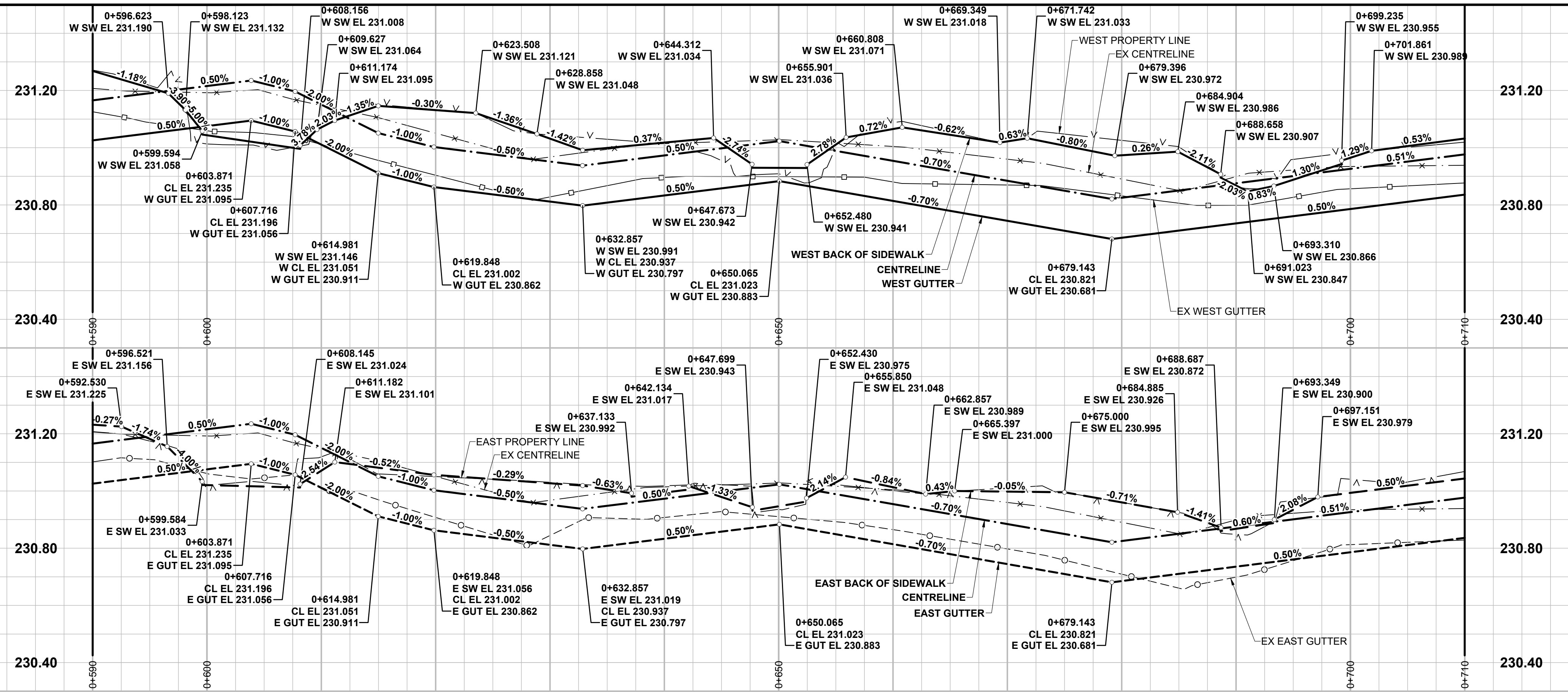

- NOTES**
- ADJUST MH AND CB RIMS TO NEW GRADES.
 - LAMP STANDARDS, HYDRO POLES, AND ANCHORS THAT REQUIRE TEMPORARY SUPPORT, REMOVAL OR REPLACEMENT, TO BE DONE SO AT THE EXPENSE OF THE CONTRACTOR AS NECESSARY.
 - CONTRACTOR TO REGRADE/RENEW EXISTING PRIVATE SIDEWALKS TO LIMITS AS SHOWN. SIDEWALKS TO BE RENEWED WITH CONCRETE UNLESS NOTED OTHERWISE.
 - CONTRACTOR TO TAKE PRECAUTIONARY STEPS TO PROTECT EXISTING TREES WITHIN THE LIMITS OF CONSTRUCTION FROM DAMAGE FROM CONSTRUCTION ACTIVITIES AS OUTLINED IN THE SPECIFICATIONS.
 - CONTRACTOR TO CONFIRM THE LOCATION OF ALL UTILITIES/SERVICES IN THE FIELD PRIOR TO CONSTRUCTION.
 - SD-024 OFFSETS ARE DIMENSIONED TO BOC.
 - IN GENERAL, PAVEMENT AND SIDEWALK AREAS TO BE REMOVED. MATCH RECONSTRUCTION LIMITS.
 - REFER TO TENDER FOR DETAILS REGARDING TRAFFIC MANAGEMENT.
 - EXISTING LONG WATER SERVICES TO BE INSULATED (SD-018). REFER TO TENDER FOR FURTHER REQUIREMENTS AND AS NOTED IN PLAN.
 - ALL COSTS, MATERIALS AND LABOR ASSOCIATED WITH THE RESTORATION OF THE CATHODIC PROTECTED WATERMAIN WILL BE RESPONSIBILITY OF THE CONTRACTOR.
 - ADD 200.000 m TO ABBREVIATED ELEVATIONS TO OBTAIN GEODETIC ELEVATIONS.

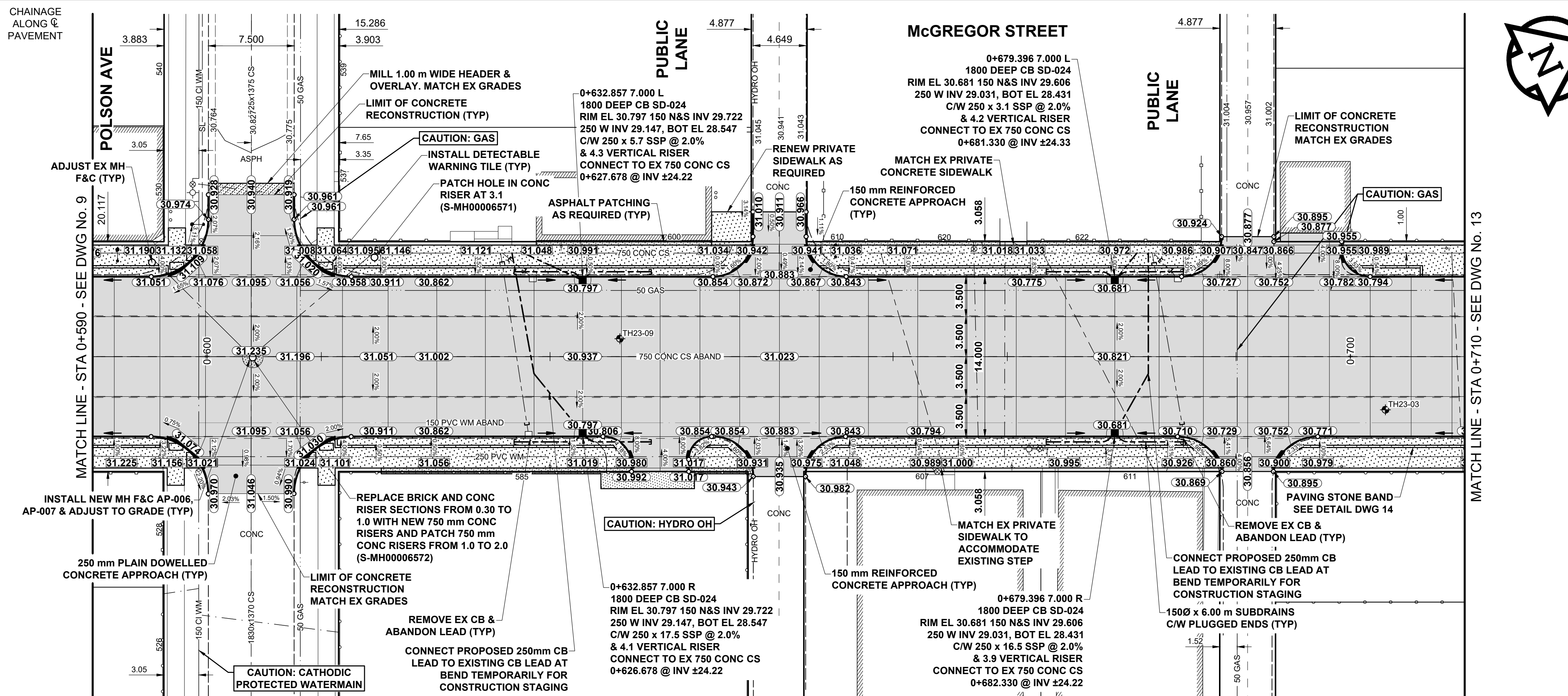

METRIC
WHOLE NUMBERS INDICATE MILLIMETRES
DECIMALIZED NUMBERS INDICATE METRES
SCALE: 1:250

EXISTING	LEGEND - PLAN	PROPOSED	EXISTING	LEGEND - PLAN	PROPOSED	EXISTING	LEGEND - PLAN	PROPOSED
⊕	HYDRANT	⊕	---	LDS / WWS	---	▒	CONCRETE	▒
⊙	VALVE	⊙	---	WATER MAIN	---	▒	CONC SIDEWALK / MEDIAN	▒
⊖	CURB STOP	⊖	---	GAS	---	▒	ASPHALT	▒
○	MANHOLE	○	---	TRAFFIC SIGNALS	---	▒	PAVING STONE	▒
□	CATCH BASIN / CATCH PIT	□	---	HYDRO / STREET LIGHT	---	▒	GRAVEL	▒
△	CURB INLET	△	---	COMMUNICATIONS	---	▒	PLANING / REMOVAL	▒
•	POLE	•	---	CURB RENEWAL	---	▒	DITCH FLOW	▒
•	LIGHT STANDARD	•	---	PROPERTY LINE	---	▒	TOP OF SLOPE	▒
•	TRAFFIC SIGNAL POLE	•	---	RAMP CURB	---	▒	CULVERT	▒
+	SURVEY BAR	+	---	ELEVATIONS	---	▒	SEWER FLOW DIRECTION	▒
+	TEST HOLE / CORE HOLE	+	---	TREE / TREELINE	---	▒		

LOCATION APPROVED UNDERGROUND STRUCTURES

DATE: _____

NOTE: LOCATION OF UNDERGROUND STRUCTURES AS SHOWN ARE BASED ON THE BEST INFORMATION AVAILABLE BUT NO GUARANTEE IS GIVEN THAT ALL EXISTING UTILITIES ARE SHOWN OR THAT THE GIVEN LOCATIONS ARE EXACT. CONFIRMATION OF EXISTENCE AND EXACT LOCATION OF ALL SERVICES MUST BE OBTAINED FROM THE INDIVIDUAL UTILITIES BEFORE PROCEEDING WITH CONSTRUCTION.

BM 26-03
ELEV 230.992 m
Bolt in 14.3 m Conc. pile, 2.2 m S. of N.L. of Inlander Blvd., and on W.L. of Atkins St.

Stantec
500 - 311 Portage Avenue, Winnipeg MB Canada R3B 2B9
Tel. 204.489.5900 Fax. 204.453.9012 www.stantec.com

DESIGNED BY: ASM
CHECKED BY: GFC
DRAWN BY: KMB
APPROVED BY: RPB
RELEASED FOR CONSTRUCTION

HOR SCALE: 1:250
VERT SCALE: 1:10
DATE: JANUARY 7, 2025

PROFESSIONAL'S SEAL
G.F. COOLIDGE
Member 24465
REGISTERED PROFESSIONAL ENGINEER

CONSULTANT FILE NAME
2303678-McGregor-PP.dwg

THE CITY OF WINNIPEG
PUBLIC WORKS DEPARTMENT
ENGINEERING DIVISION

2025 REGIONAL STREET RENEWAL

McGREGOR STREET
CHURCH AVENUE TO McADAM AVENUE
PAVING AND GRADING
STA 0+590 TO STA 0+710

CITY DRAWING NUMBER: P-3587-10
SHEET 10 OF 14
DRAWING NUMBER: 10

TENDER No. 728-2024