

DETECTION CONNECTION DETAILS			
SENSOR NO.	POLE NO.	DETECTION LOCATION	NOTES
MATRIX 1	4	NB LANES	
MATRIX 2	9	SB LANES	

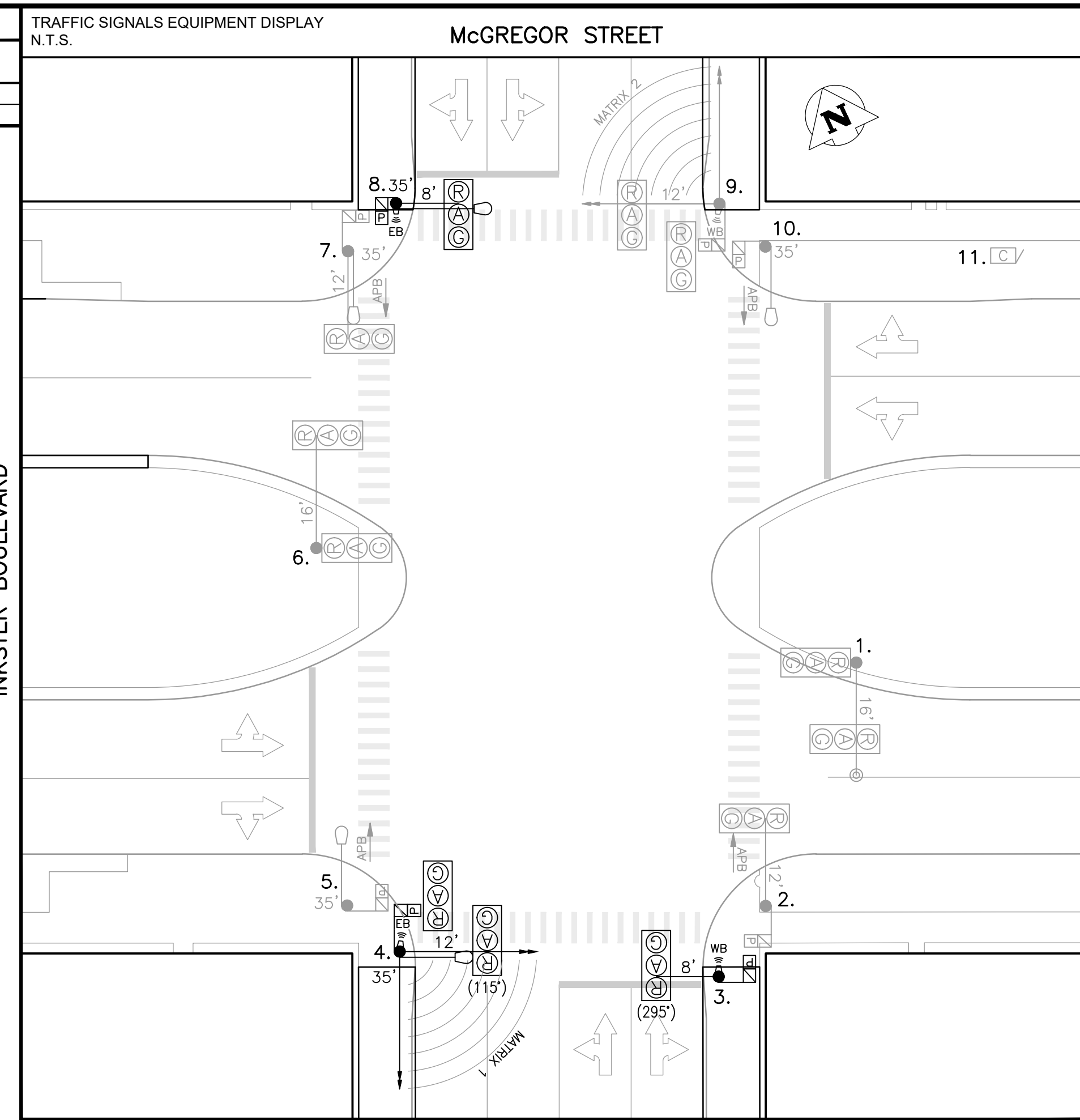

**CONSTRUCTION NOTES:**

- PROJECT SCOPE**
1. INSTALL CONDUIT AND BASES AS SHOWN. REMOVE ABANDONED PIT AS SHOWN.
  2. INSTALL EQUIPMENT AS SHOWN.
- PROJECT COORDINATION**
1. COORDINATE WORK WITH (CA's NAME), (204) XXX-XXXX.

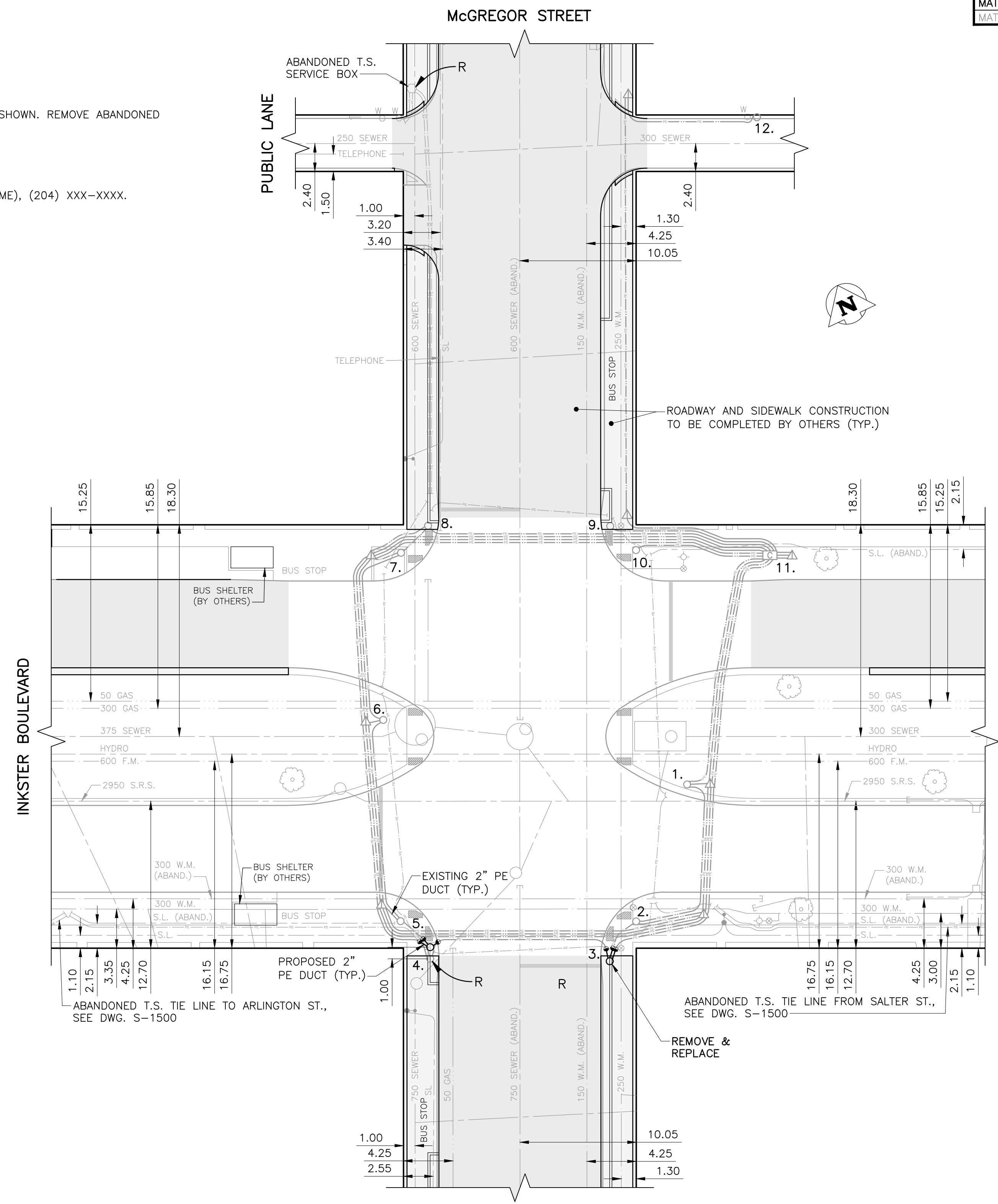

**EQUIPMENT DISPLAY LEGEND**

EXISTING	PROPOSED (AS SHOWN BELOW)	DESCRIPTION
[Symbol]	[Symbol]	PEDESTRIAN HEAD WITH PCS
[Symbol]	[Symbol]	VEHICLE DETECTION AREA
[Symbol]	[Symbol]	TRAFFIC SIGNAL HEAD
[Symbol]	[Symbol]	LOW ARM (SHOWN FROM CENTRE) HIGH ARM (SHOWN FROM SIDE)
[Symbol]	[Symbol]	PEDESTRIAN CORRIDOR BOX
[Symbol]	[Symbol]	TRAFFIC SIGNAL POLE
[Symbol]	[Symbol]	APS SINGLE DIRECTION
[Symbol]	[Symbol]	PUSH BUTTON & DIRECTION (APB = AUDIBLE PB)
[Symbol]	[Symbol]	RED FLASHER
[Symbol]	[Symbol]	LUMINAIRE
[Symbol]	[Symbol]	RFB (PHASE 'A' OR 'B')
[Symbol]	[Symbol]	WOOD POST
[Symbol]	[Symbol]	APS DUAL DIRECTION (SEPARATE CIRCUIT NUMBER)
[Symbol]	[Symbol]	ELECTRONIC DISPLAY
[Symbol]	[Symbol]	AMBER FLASHER (1224 = CIRCUIT NUMBER)
[Symbol]	[Symbol]	CAMERA

NO.	EQUIPMENT LIST	ARM	BASE	B.B.	NO.	EQUIPMENT LIST	ARM	BASE	B.B.
1.	CANTILEVER FOR PTZ CAMERA	16'	OD	DC	9.	CANTILEVER	12'	OD	DC
2.	CANTILEVER	12'	OD	DC	10.	35' SIGNAL FOR 150 WATT (15000 LUMEN) LUMINAIRE		OD	DD
3.	CANTILEVER	8'	OD	DC	11.	332 CABINET/2070 CONTROLLER			
4.	35' SIGNAL FOR 240 WATT (20000 LUMEN) LUMINAIRE	12'	OD	DD	12.	HYDRO WOOD #1113028 SERVICE			
5.	35' SIGNAL FOR 150 WATT (15000 LUMEN) LUMINAIRE		OD	DD					
6.	CANTILEVER	16'	OD	DC					
7.	35' SIGNAL FOR 90 WATT (9000 LUMEN) LUMINAIRE	12'	OD	DD					
8.	35' SIGNAL FOR 240 WATT (20000 LUMEN) LUMINAIRE	8'	OD	DD					

**TRAFFIC SIGNALS UNDERGROUND LEGEND**

EXISTING	PROPOSED (AS SHOWN BELOW)	DESCRIPTION
[Symbol]	[Symbol]	1 1/2" PE CONDUIT
[Symbol]	[Symbol]	2" PE CONDUIT
[Symbol]	[Symbol]	4" PVC CONDUIT
[Symbol]	[Symbol]	AERIAL / BURIED CABLE
[Symbol]	[Symbol]	CONDUIT STUB
[Symbol]	[Symbol]	BREAK-IN
[Symbol]	[Symbol]	SPLICE
[Symbol]	[Symbol]	SAW-CUT LOOPS
[Symbol]	[Symbol]	PERFORMED LOOPS
[Symbol]	[Symbol]	POLE BASE
[Symbol]	[Symbol]	WOOD POST
[Symbol]	[Symbol]	CONTROLLER BASE
[Symbol]	[Symbol]	PEDESTAL BASE
[Symbol]	[Symbol]	TERMINAL BASE
[Symbol]	[Symbol]	SERVICE BOX (PIT)
[Symbol]	[Symbol]	24" PRECAST PIT
[Symbol]	[Symbol]	30" PRECAST PIT
[Symbol]	[Symbol]	36" PRECAST PIT
[Symbol]	[Symbol]	REMOVAL

**SIGNAL BASE BOLT SQUARE TYPES**

BOLT SQUARE (B.S.)	DIA.
TYPE "A" - 8 1/8"	
TYPE "B" - 6 3/4"	
TYPE "C" - 8 1/8" SCREW TYPE	
TYPE "D" - 12 3/4" x 1 1/4" DIA. BOLTS, 24" DIA.	
TYPE "E" - 12 3/4" x 1 1/4" DIA. BOLTS, 28" DIA.	
TYPE "F" - 12 3/4" PRECAST, 1 1/4" DIA. BOLTS, 28" DIA.	
TYPE "G" - 9 9/16" SCREW TYPE	
TYPE "H" - 8 1/8" x 1 1/4" DIA. BOLTS, 89mm PROJ.	
TYPE "I" - 8 1/8" x 1 1/4" DIA. BOLTS, 76mm PROJ.	
TYPE "J" - 8 1/8" PRECAST, 1 1/4" DIA. BOLTS	
TYPE "K" - 8 1/8" x 1 1/4" DIA. BOLTS	
TYPE "L" - 6" x 5/8" DIA. BOLTS	
TYPE "M" - 8 1/8" x 5/8" DIA. BOLTS	
TYPE "N" - 8 1/8" x 5/8" DIA. BOLTS	

**INTERNAL REVIEW**

TIMINGS (INITIAL):	NEW TIMINGS?	DATE	INITIALS
TIMINGS (PRE-FCI):	NEW TIMINGS?	DATE	INITIALS
OPERATIONS:	DAYS REQUIRED	DATE	INITIALS
UNDERGROUND CONSTRUCTABILITY:	DAYS REQUIRED	DATE	INITIALS
LAB:	REQUIRE IFC DWG?	DAYS REQUIRED	DATE
TMC:		DATE	INITIALS
STREET LIGHTING:		DATE	INITIALS
TRAFFIC MANAGEMENT:		DATE	INITIALS

**PLAN VIEW: UNDERGROUND CONSTRUCTION**  
1:250

EXISTING	LEGEND	PROPOSED	EXISTING	LEGEND	PROPOSED	EXISTING	LEGEND	PROPOSED
[Symbol]	150 W.M.	[Symbol]	[Symbol]	100 GAS	[Symbol]	[Symbol]	TELEPHONE	[Symbol]
[Symbol]	HYDRANT	[Symbol]	[Symbol]	GAS	[Symbol]	[Symbol]	TELEPHONE	[Symbol]
[Symbol]	VALVE	[Symbol]	[Symbol]	COMMUNICATION	[Symbol]	[Symbol]	COMMUNICATION	[Symbol]
[Symbol]	SHUTOFF VALVE	[Symbol]	[Symbol]	WOOD POLE	[Symbol]	[Symbol]	WOOD POLE	[Symbol]
[Symbol]	SEWER	[Symbol]	[Symbol]	STREET LIGHT	[Symbol]	[Symbol]	STREET LIGHT	[Symbol]
[Symbol]	MANHOLE	[Symbol]	[Symbol]	RAILWAY POLE	[Symbol]	[Symbol]	RAILWAY POLE	[Symbol]
[Symbol]	CATCH BASIN	[Symbol]	[Symbol]	GUY-WIRE	[Symbol]	[Symbol]	GUY-WIRE	[Symbol]
[Symbol]	CURB INLET	[Symbol]	[Symbol]	FENCE	[Symbol]	[Symbol]	FENCE	[Symbol]
[Symbol]	HYDRO	[Symbol]	[Symbol]	GUARDRAIL	[Symbol]	[Symbol]	GUARDRAIL	[Symbol]

**UNDERGROUND STRUCTURES**

UNDERGROUND STRUCTURES ID	DATE (YYYY/MM/DD)
PENDING	
PENDING	
WATER & WASTE REVIEW ID	

NOTE: LOCATIONS OF UNDERGROUND STRUCTURES AS SHOWN ARE BASED ON THE BEST INFORMATION AVAILABLE. BUT NO GUARANTEE IS GIVEN THAT ALL EXISTING UTILITIES ARE SHOWN OR THAT THE GIVEN LOCATIONS ARE EXACT. CONFIRMATION OF EXISTENCE AND EXACT LOCATION OF ALL SERVICES MUST BE OBTAINED FROM THE INDIVIDUAL UTILITIES BEFORE PROCEEDING WITH CONSTRUCTION.

**CONSTRUCTION REVISIONS**

NO.	REVISION	DATE (YYYY/MM/DD)	BY	APPROVED BY
A	ISSUED FOR INTERNAL REVIEW	2024/11/27	R.S.	

**ACCOUNTS:**

WT PENDING
------------

**LIABILITY DISCLAIMER NOTICE:**  
THE DIGITAL INFORMATION PROVIDED FOR YOUR CONVENIENCE HEREIN IS FOR USE AT YOUR OWN RISK. THE CITY OF WINNIPEG, PUBLIC WORKS DEPARTMENT, SHALL ASSUME NO RESPONSIBILITY FOR THE INFORMATION AND IT SHOULD NOT BE CONSTRUED AS ASSULT INFORMATION. THE INFORMATION SHOULD BE USED FOR PLANNING PURPOSES ONLY AND SHOULD BE VERIFIED BY SURVEY. THE DEPARTMENT SHALL NOT IN ANY WAY SUFFER ANY LIABILITY WHATSOEVER TO ANY PARTY FOR INJURY, LOSS OR DAMAGES SUFFERED BY SUCH PARTY ARISING FROM THEIR USE OF, OR RELIANCE UPON, THIS INFORMATION.

PRELIMINARY  
NOT FOR CONSTRUCTION

**THE CITY OF WINNIPEG**  
PUBLIC WORKS DEPARTMENT  
TRANSPORTATION DIVISION

**TRAFFIC SIGNALS**  
INKSTER BLVD. & MCGREGOR ST.

UNITS: ALL DIMENSIONS ARE IN METERS UNLESS OTHERWISE NOTED  
DRAWING NUMBER: S-1197