

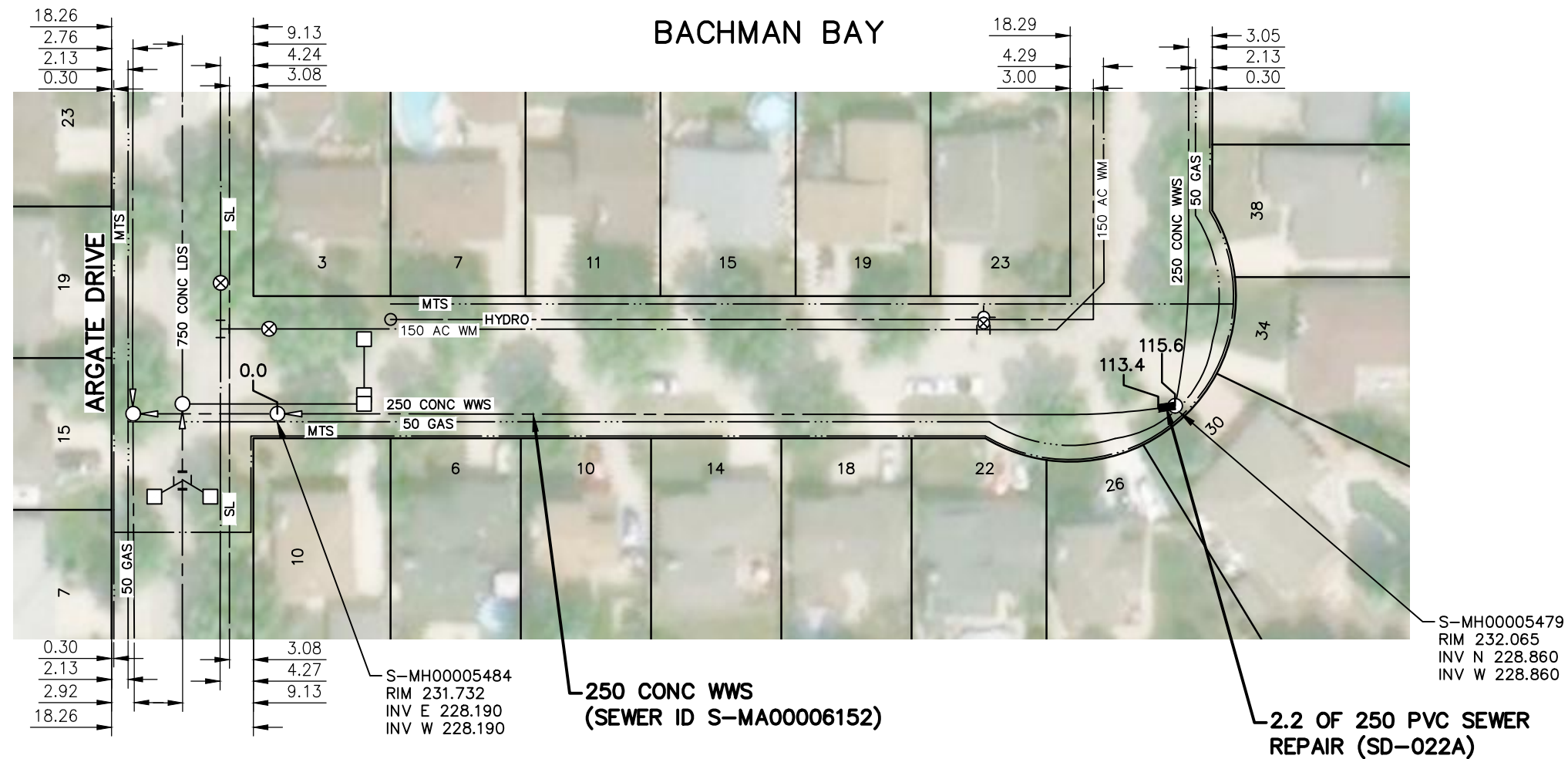

SEWER JUNCTION INFORMATION FROM SEWER VIDEO INSPECTION		
SEWER ID S-MA00006152		
DISTANCE FROM S-MH00005484		
DISTANCE	DIAMETER	CLOCK
5.4	150	2:00
6.5	150	10:00
23.9	150	2:00
25.1	150	10:00
39.9	150	2:00
41.1	150	10:00
55.9	150	2:00
57.1	150	10:00
72.9	150	2:00
75.3	150	10:00
92.4	150	2:00
93.5	150	10:00
104.5	150	2:00



WARNING

IF POWER EQUIPMENT OR EXPLOSIVES ARE TO BE USED FOR EXCAVATION ON THIS PROJECT THE CONTRACTOR MUST:

- 1) NOTIFY THE GAS COMPANY OF THE PROPOSED LOCATION OF EXCAVATION.
- 2) TAKE PRECAUTION TO AVOID DAMAGE TO GAS COMPANY INSTALLATIONS.

SEE PROVINCIAL REGULATION 140/92 FOR DETAILS

**ENGINEERS
GEOSCIENTISTS
MANITOBA**

Certificate of Authorization
Stantec Consulting Ltd.
No. 1301

FOR INDEX SEE
13567

TENDER NO. 832-2024

METRIC

WHOLE NUMBERS INDICATE MILLIMETRES
DECIMALIZED NUMBERS INDICATE METRES



LOCATION APPROVED UNDERGROUND STRUCTURES

SUPV. U/G STRUCTURES DATE
COMMITTEE

NOTE:
LOCATION OF UNDERGROUND STRUCTURES AS SHOWN ARE BASED ON THE BEST INFORMATION AVAILABLE BUT NO GUARANTEE IS GIVEN THAT ALL EXISTING UTILITIES ARE SHOWN OR THAT THE GIVEN LOCATIONS ARE EXACT. CONFIRMATION OF EXISTENCE AND EXACT LOCATION OF ALL SERVICES MUST BE OBTAINED FROM THE INDIVIDUAL UTILITIES BEFORE PROCEEDING WITH CONSTRUCTION.

B.M.	ELEV.	DATE	BY
00	ISSUED FOR TENDER	24.10.01	RS
NO.	REVISIONS	DATE	BY

Stantec
311 Portage Avenue, Winnipeg, Manitoba
Tel 204-489-5900 Fax 204-453-9012

DESIGNED BY	RS	CHECKED BY	RS
DRAWN BY	MR	APPROVED BY	RS
HOR. SCALE:	1:750	RELEASED FOR CONSTRUCTION:	AD
VERTICAL:		DATE	24.10.01

ENGINEER'S SEAL

CONSULTANT DRAWING NO.
C-102

THE CITY OF WINNIPEG
WATER AND WASTE DEPARTMENT

2024 SEWER MAIN RENEWALS AND EXTERNAL POINT REPAIRS
CONTRACT 1
BACHMAN BAY
2ND MH E OF ARGATE DRIVE TO
1ST MH E OF ARGATE DRIVE

SHEET	OF
4	28
CAD FILE DRAWING NUMBER 20895c-101_109.dwg	
CITY DRAWING NUMBER 13569	

U:\11220895\0300_drawing\0302_sheet_files\02_civil\iso_11x17\20895c-101_109.dwg