

WILTON STREET

SEWER JUNCTION INFORMATION UNKNOWN.
TO BE CONFIRMED FOLLOWING INSTALLATION
OF NEW UPSTREAM MANHOLE.

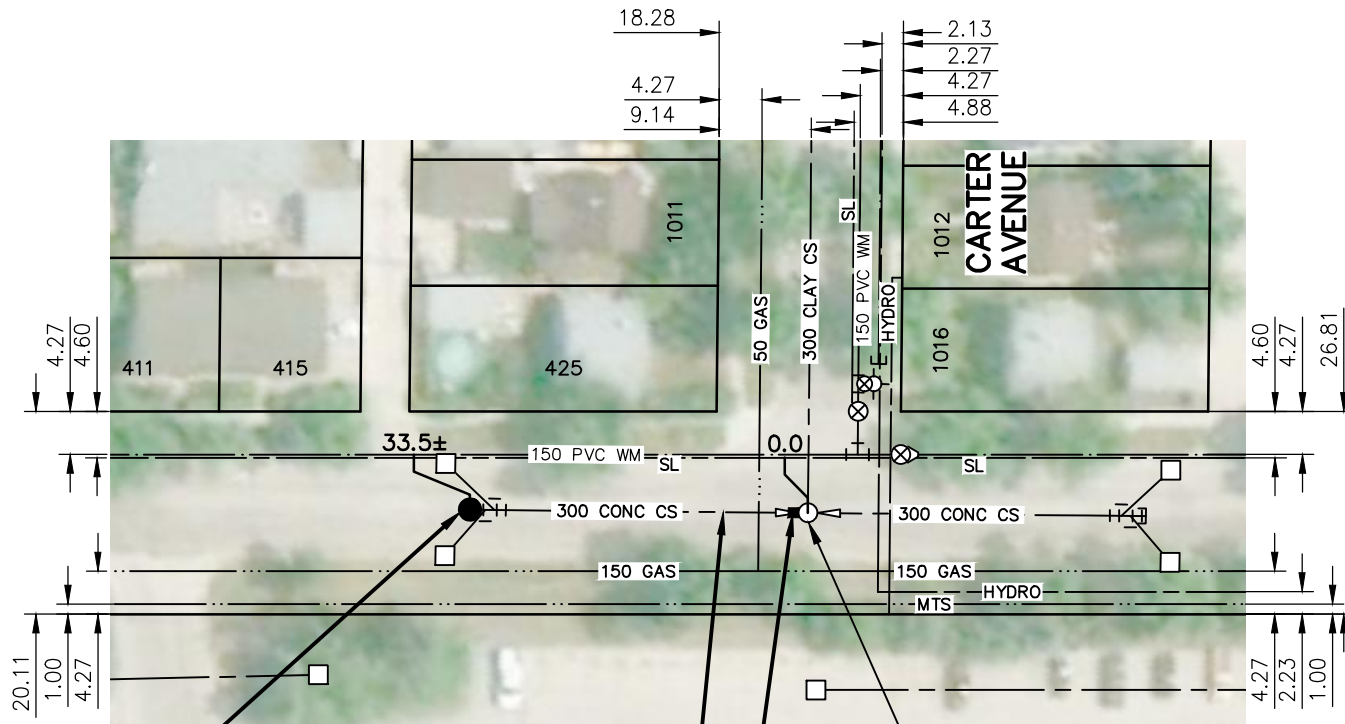

INSTALL MANHOLE ON EXISTING
300 CONC CS (SD-010)
RIM 232.310
INV 229.34±

300 CONC CS
(SEWER ID S-MA60011566)

S-MH60009809
RIM 232.360
INV N 229.176
INV S 229.176
INV E 229.274

EXISTING PIPE COLLAPSED AT DOWNSTREAM MANHOLE
CONNECTION. LENGTH OF SEWER REPAIR TO BE CONFIRMED
FOLLOWING INSTALLATION OF UPSTREAM MANHOLE. REPAIR
TO BE COMPLETED IN ACCORDANCE WITH SD-022A OR
SD-022B DEPENDING ON LENGTH REQUIRED.

WARNING

IF POWER EQUIPMENT OR EXPLOSIVES ARE TO BE USED
FOR EXCAVATION ON THIS PROJECT THE CONTRACTOR
MUST:
1) NOTIFY THE GAS COMPANY OF THE PROPOSED LOCATION
OF EXCAVATION.
2) TAKE PRECAUTION TO AVOID DAMAGE TO GAS COMPANY
INSTALLATIONS.
SEE PROVINCIAL REGULATION 140/92 FOR DETAILS

**ENGINEERS
GEOSCIENTISTS
MANITOBA**
Certificate of Authorization
Stantec Consulting Ltd.
No. 1301

FOR INDEX SEE
13567

TENDER NO. 832-2024

METRIC

WHOLE NUMBERS INDICATE MILLIMETRES
DECIMALIZED NUMBERS INDICATE METRES



U:\11220895\0300_drawing\0302_sheet_files\iso_11x17\20895c-114_120.dwg

LOCATION APPROVED UNDERGROUND STRUCTURES SUPV. U/G STRUCTURES COMMITTEE _____ DATE _____ NOTE: LOCATION OF UNDERGROUND STRUCTURES AS SHOWN ARE BASED ON THE BEST INFORMATION AVAILABLE BUT NO GUARANTEE IS GIVEN THAT ALL EXISTING UTILITIES ARE SHOWN OR THAT THE GIVEN LOCATIONS ARE EXACT. CONFIRMATION OF EXISTENCE AND EXACT LOCATION OF ALL SERVICES MUST BE OBTAINED FROM THE INDIVIDUAL UTILITIES BEFORE PROCEEDING WITH CONSTRUCTION.	B.M. ELEV.	<p>Stantec 311 Portage Avenue, Winnipeg, Manitoba Tel 204-489-5900 Fax 204-453-9012</p>	ENGINEER'S SEAL	<p>THE CITY OF WINNIPEG WATER AND WASTE DEPARTMENT</p>				
	00		ISSUED FOR TENDER		24.10.01	RS	2024 SEWER MAIN RENEWALS AND EXTERNAL POINT REPAIRS CONTRACT 1 WILTON STREET IST MH N OF CARTER AVENUE TO MH AT CARTER AVENUE	SHEET 22 OF 28
	NO.		REVISIONS		DATE	BY		CAD FILE DRAWING NUMBER 20895c-114_J20.dwg
	DATE		24.08.16		DATE	24.10.01		CITY DRAWING NUMBER 13588