

SEWER SERVICE INFORMATION

ADDRESS	SIZE (mm)	P/L DIST	JUNCTION TIE	REMARKS
381 SEMPL	-	-	-	-
382 SEMPL	-	-	-	-
385 SEMPL	-	-	-	-
386 SEMPL	-	-	-	-
389 SEMPL	-	-	-	-
370 SEMPL	-	-	-	-
371 SEMPL	-	-	-	-
373 SEMPL	-	-	-	-
374 SEMPL	-	-	-	-
376 SEMPL	-	-	-	-
378 SEMPL	-	-	-	-
381 SEMPL	-	-	-	-
382 SEMPL	-	-	-	-
385 SEMPL	-	-	-	-
388 SEMPL	-	-	-	-

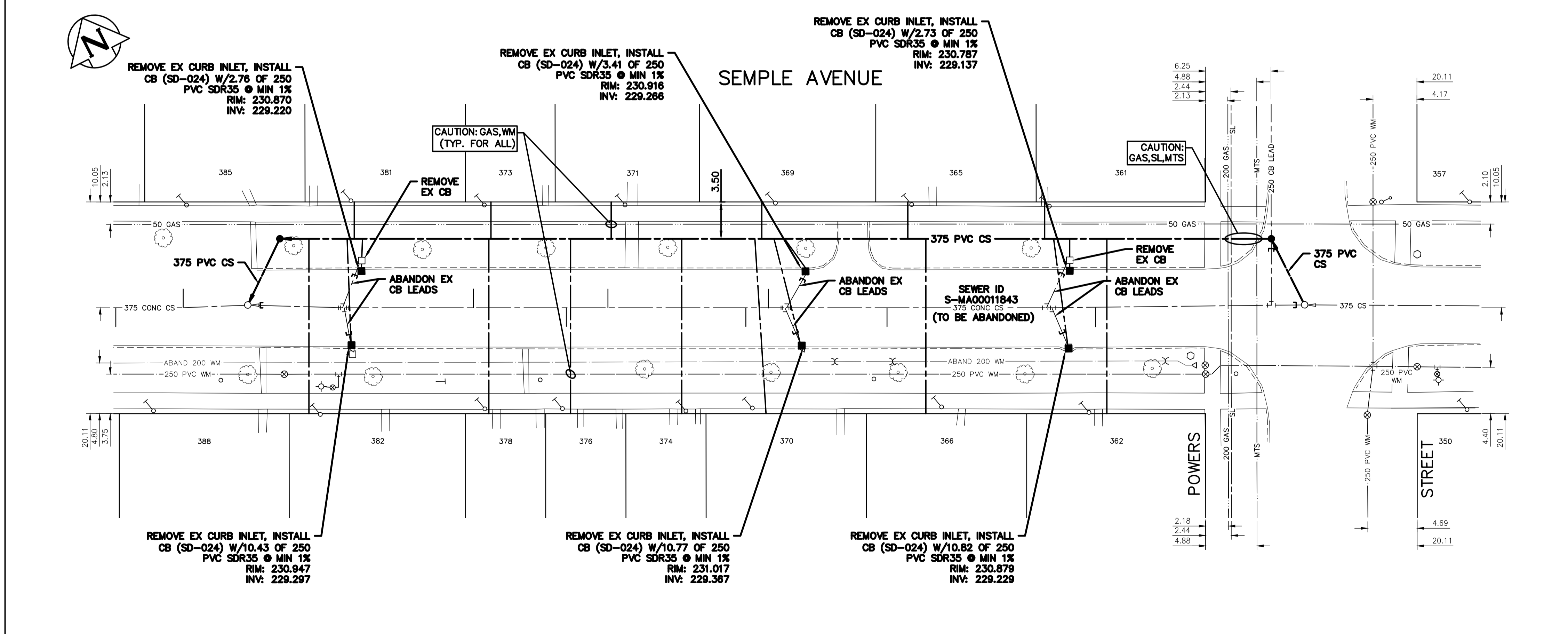

SEWER JUNCTION INFORMATION FROM SEWER VIDEO INSPECTION

DISTANCE FROM S-MH00010212	DIAMETER	CLOCK
2.30	250	2:00
2.60	100	11:00
20.30	150	11:00
21.00	150	11:00
21.90	150	1:00
22.10	150	1:00
23.30	150	11:00
25.90	150	1:00
39.70	250	1:00
40.40	150	11:00
48.00	150	11:00
49.00	150	1:00
49.70	150	2:00
51.30	150	1:00
53.60	150	11:00
63.80	150	11:00
67.00	150	1:00
70.60	150	11:00
72.10	150	11:00
79.20	150	2:00
79.20	150	1:00
80.00	150	1:00
81.60	150	11:00
88.80	250	2:00
91.20	150	10:00
91.40	150	1:00
94.30	100	11:00
96.80	150	11:00

NOTE: CHAINAGES SHOWN ARE ALONG CENTRE LINE OF ROW

FOR INDEX SEE 13567



METRIC
WHOLE NUMBERS INDICATE MILLIMETRES
DECIMALIZED NUMBERS INDICATE METRES

ENGINEERS GEOSCIENTISTS MANITOBA
Certificate of Authorization
Stantec Consulting Ltd.
No. 1301

LOCATION APPROVED UNDERGROUND STRUCTURES

SUPV. U/G STRUCTURES COMMITTEE DATE

NOTE:
LOCATION OF UNDERGROUND STRUCTURES AS SHOWN ARE BASED ON THE BEST INFORMATION AVAILABLE BUT NO GUARANTEE IS GIVEN THAT ALL EXISTING UTILITIES ARE SHOWN OR THAT THE GIVEN LOCATIONS ARE EXACT. CONFIRMATION OF EXISTENCE AND EXACT LOCATION OF ALL SERVICES MUST BE OBTAINED FROM THE INDIVIDUAL UTILITIES BEFORE PROCEEDING WITH CONSTRUCTION.

B.M. ELEV.	NO.	ISSUED FOR TENDER	DATE	BY
	00	ISSUED FOR TENDER	2024.10.04	RS

Stantec

DESIGNED BY: RS
CHECKED BY: RS
DRAWN BY: MR
APPROVED BY: RS
SCALE: HORIZONTAL 1:250, VERTICAL 1:50
DATE: 2024.07.29

ENGINEER'S SEAL

CONSULTANT DRAWING NUMBER: C-206

THE CITY OF WINNIPEG
WATER AND WASTE DEPARTMENT
ENGINEERING DIVISION

2024 SEWER MAIN RENEWALS AND EXTERNAL POINT REPAIRS

CONTRACT 1
SEMPL AVENUE
90.4 E OF ANDREWS STREET TO POWERS STREET

SHEET 28 OF 28
CITY DRAWING NUMBER: 13594