

1 PARTIAL ROOF PLAN - ELECTRICAL - DEMOLITION
 E1.2 SCALE: 1/16" = 1'-0"

GENERAL NOTES

- A. ALL EQUIPMENT, DEVICES, FIXTURES REMOVED UNDER DEMOLITION SCOPE WILL BE FIRST OFFERED TO THE CITY FOR REFUSAL FOLLOWED BY CONTRACTOR AND FINALLY TO BE LEGALLY DISPOSED OF.
- B. FOR ALL EXISTING ELECTRICAL DEVICES, EQUIPMENT, ETC. THAT ARE REMOVED, REMOVE EXISTING CONDUIT, WIRING, ETC. BACK TO SOURCE UNLESS OTHERWISE NOTED.
- C. CONTRACTOR SHALL BE RESPONSIBLE FOR COORDINATING EXACT LAYOUT, ROUTING, ETC. VERIFY EXISTING SERVICES ON SITE.
- D. VERIFY ALL EXISTING EQUIPMENT BEING RE-USED IS WORKING PRIOR TO INSTALLATION. SUPPLY NEW EQUIPMENT AS NECESSARY.
- E. CONTRACTOR TO DETERMINE EXACT CABLE ROUTES ON SITE. WHERE POSSIBLE FOLLOW EXISTING CABLE ROUTES THROUGH BUILDING. RE-USE EXISTING OPENINGS AND PENETRATIONS TO ROUTE CABLES. PROVIDE NEW PENETRATIONS WHERE EXISTING CANNOT BE RE-USED. SEAL ALL PENETRATIONS.
- F. SEAL ALL PENETRATIONS THROUGH FIRE RATED WALLS WITH FIRE STOP MATERIAL AS REQUIRED TO MAINTAIN ASSEMBLY RATING.
- G. COORDINATE FULLY WITH MECHANICAL FOR THE SEQUENCE OF DEMOLITION AND CONSTRUCTION.
- H. COORDINATE WITH THE CITY PRIOR TO SHUT DOWN OF EQUIPMENT.
- I. CONTRACTOR SHALL ENSURE COORDINATION BETWEEN ALL SUBCONTRACTORS AND CONTRACT ADMINISTRATOR, ON AND OFF SITE, AS REQUIRED FOR INSTALLATION OF ELECTRICAL EQUIPMENT.
- J. CONTRACTOR TO VISIT SITE DURING BID AND VERIFY ALL EXISTING SERVICES ON SITE PRIOR TO SUBMITTING BID. REPORT ANY DISCREPANCIES TO CONTRACT ADMINISTRATOR DURING BID PERIOD.
- K. ARRANGE AND PAY CERTIFIED ROOFING CONTRACTOR TO PROVIDE NEW ROOF PITCH BOXES. SEAL ROOF OPENINGS EXPOSED FROM REMOVAL OF EXISTING FEEDERS. REFER TO SPECIFICATION FOR ADDITIONAL DETAILS.
- L. THIS BUILDING MAY CONTAIN ASBESTOS. REFER TO FRONT END SPECIFICATION FOR FURTHER INFORMATION.

DEMOLITION KEY NOTES

- 1. DISCONNECT AND REMOVE EXISTING WIRE, CONDUIT, ETC. ASSOCIATED WITH EXISTING EXHAUST FAN BACK TO EXISTING DISTRIBUTION. COORDINATE REMOVAL WITH MECHANICAL CONTRACTOR.
- 2. EXISTING EXHAUST FAN TO REMAIN.
- 3. DISCONNECT AND REMOVE EXISTING RECEPTACLE.
- 4. DISCONNECT AND REMOVE EXISTING JUNCTION BOX AS REQUIRED TO NOT INTERFERE WITH NEW MECHANICAL EQUIPMENT (MAINTAIN ACCESSIBILITY). REMOVE ASSOCIATED WIRING/CONDUIT BACK TO A NEW WEATHERPROOF JUNCTION BOX LOCATED IN AN ACCESSIBLE CEILING SPACE ON THE UNDERSIDE OF THE ROOF WITHIN THE BUILDING. WIRE/CONDUIT TO BE EXTENDED FROM NEW JUNCTION BOX TO EXISTING OUTLETS ON ROOF THROUGH NEW PITCH BOX. REFER TO E2.1 FOR FURTHER INFORMATION.

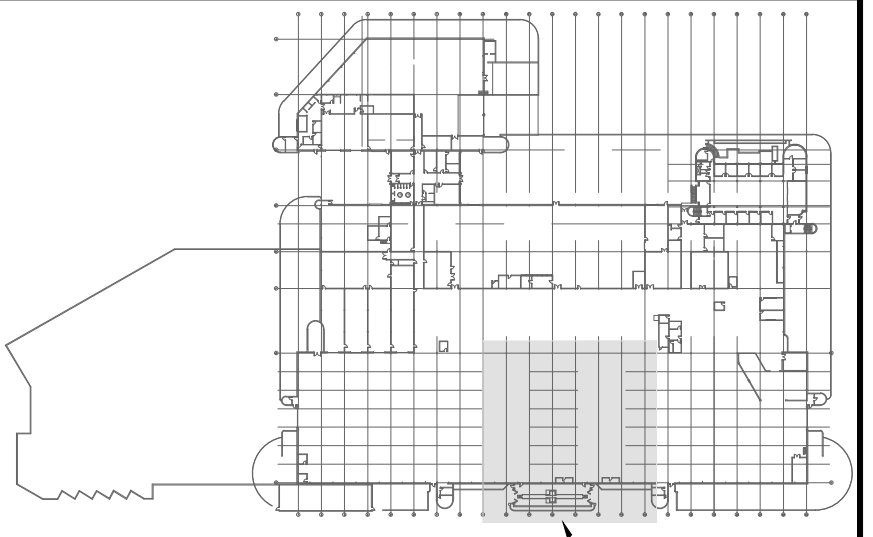

KEY PLAN
 SCALE: NTS

6			
5			
4			
3			
2			
1			
0	ISSUED FOR CONSTRUCTION	AS	23/01/25
NO.	Description	BY	DDMMYY



Project Title
TRANSIT MAINTENANCE AND REPAIR BUILDING MECHANICAL UPGRADE - CENTRE HIGH BAY
 WINNIPEG MANITOBA

Drawing Title
PARTIAL ROOF PLAN - ELECTRICAL - DEMOLITION

Drawn By	WPD	Checked By	BG	Approved By	AS
Scale	AS INDICATED	Date	DECEMBER 2024	Project No.	24-256-01
Revision Number	0	Drawing Number	E1.2	Sheet Order	2 OF 5

FILE NAME AND PATH: G:\Projects\2024\24-256 Transit Maintenance Building Phase 6 HVAC Upgrade\01 CAD - Rev\04 Electrical\E1.2_GW_P1.dwg
 LAYOUT: E1.2
 LAST SAVED BY: jgibson
 DATE PLOTTED: Thursday, April 25, 2025 10:02:23 AM