

LANE (S OF DUCHARME AVENUE)

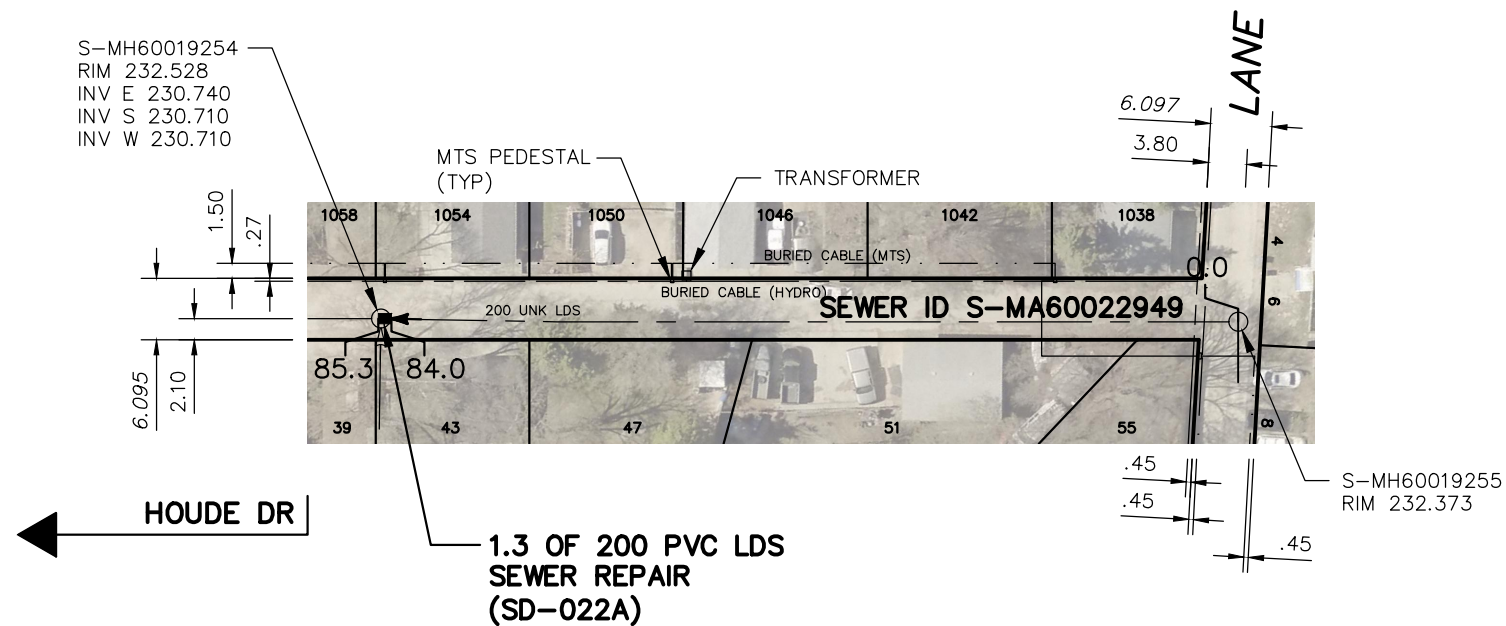

SEWER JUNCTION INFORMATION FROM SEWER VIDEO INSPECTION		
SEWER ID S-MA60022949		
DISTANCE FROM MH ID S-MH60019255		
DISTANCE	DIAMETER	CLOCK
*** NO SERVICE JUNCTIONS ***		

WARNING

IF POWER EQUIPMENT OR EXPLOSIVES ARE TO BE USED FOR EXCAVATION ON THIS PROJECT THE CONTRACTOR MUST:

- 1) NOTIFY THE GAS COMPANY OF THE PROPOSED LOCATION OF EXCAVATION.
- 2) TAKE PRECAUTION TO AVOID DAMAGE TO GAS COMPANY INSTALLATIONS.

SEE PROVINCIAL REGULATION 210/72 FOR DETAILS

FOR INDEX SEE
13387

METRIC

WHOLE NUMBERS INDICATE MILLIMETRES
DECIMALIZED NUMBERS INDICATE METRES

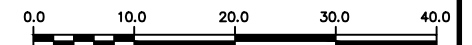

LOCATION APPROVED UNDERGROUND STRUCTURES

SUPV. U/G STRUCTURES COMMITTEE	DATE

NOTE:
LOCATION OF UNDERGROUND STRUCTURES AS SHOWN ARE BASED ON THE BEST INFORMATION AVAILABLE BUT NO GUARANTEE IS GIVEN THAT ALL EXISTING UTILITIES ARE SHOWN OR THAT THE GIVEN LOCATIONS ARE EXACT. CONFIRMATION OF EXISTENCE AND EXACT LOCATION OF ALL SERVICES MUST BE OBTAINED FROM THE INDIVIDUAL UTILITIES BEFORE PROCEEDING WITH CONSTRUCTION.

B.M. ELEV.	NO.	ISSUED FOR TENDER	DATE	SC

DESIGNED BY	RG	CHECKED BY	SC
DRAWN BY	AOM	APPROVED BY	SC
SCALE:		RELEASED FOR CONSTRUCTION	
HORIZONTAL	1:750		
VERTICAL			
DATE	2024 11 28	DATE	

PROVINCE OF MANITOBA
S.R.J. COURNOYER
Member
22699
2024-11-29
REGISTERED PROFESSIONAL ENGINEER
Digitally signed by Stacy Cournoyer, P. Eng
CONSULTANT DRAWING NUMBER
-



THE CITY OF WINNIPEG WATER AND WASTE DEPARTMENT ENGINEERING DIVISION

2024 SEWER RENEWALS
and EXTERNAL POINT REPAIRS
LANE (SOUTH OF DUCHARME AVENUE)
1ST MH E OF HOUE DR (E-LEG) TO
MH AT HOUE DRVE (E-LEG)

SHEET 18 OF 33
CITY DRAWING NUMBER
13404

PLOT DATE: 2024 11 28

BID OPPORTUNITY: 968-2024
CONTRACT NUMBER: 7

FILE PATH: R:\DRAWINGS\SEWER\2024 RENEWALS\968-2024 Cont #7\CONSTRUCTION DWGS\
FILE NAME: LANE (S OF DUCHAME)_S-MA60022949.dwg